

FIRST FLOOR PLAN.
SCALE 1:50

MASIYANISE T.I.

REGISTERED ARCHITECT
Architects, Interior Designers, Planning Consultants, Landscaping
Flat no8 AvonFriars, 7Oxford Road Avondale
Tel: (04) 339746, (M) 0772 344 907, e-mail:masiarch@zoi.co.zw

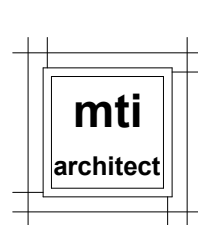

PROJECT : MCAZ LABORATORY
PROPOSED REFURBISHMENT

TENDER DRAWINGS

SITE

TITLE

CLIENT

106 BAINES AVENUE, HARARE.

FLOOR PLAN

MCAZ

NOTES:
-ALL DIMENSIONS AND LEVELS TO BE VERIFIED ON SITE PRIOR TO COMMENCING.
-SETTING OUT, WORKSHOP DRAWINGS OR CONSTRUCTION.
-DO NOT SCALE, FOLLOW ONLY WRITTEN DIMENSIONS.
-DISCREPANCIES, ERRORS, OMISSIONS, TO BE BROUGHT TO THE ARCHITECTS
ATTENTION IMMEDIATELY AFTER BEING EVIDENT.
-SHOP DRAWINGS TO BE SUBMITTED FOR APPROVAL PRIOR TO MANUFACTURE
-THIS DRAWING IS COPYRIGHT OF MASIYANISE T.I. REGISTERED ARCHITECT AND
MAY NOT BE USED EXCEPT WITH WRITTEN PERMISSION OF THE ARCHITECT

AMENDMENTS

DESIGNED

MTI

DATE

26/01/2017

DRAWN

MG

SCALE

AS SHOWN

CHECKED

ITM

DWG NO.

WD/W1523/01

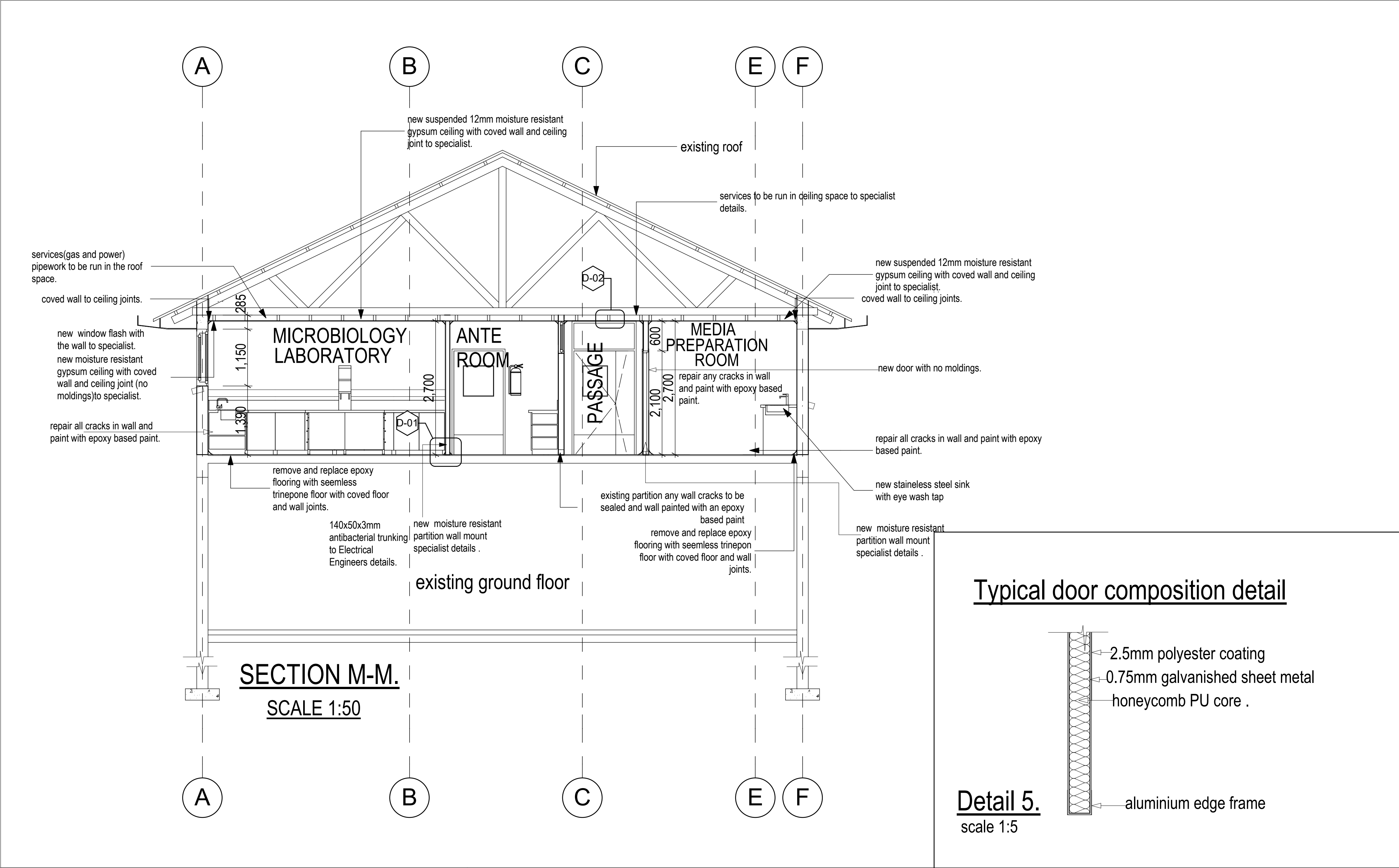

Typical door composition detail

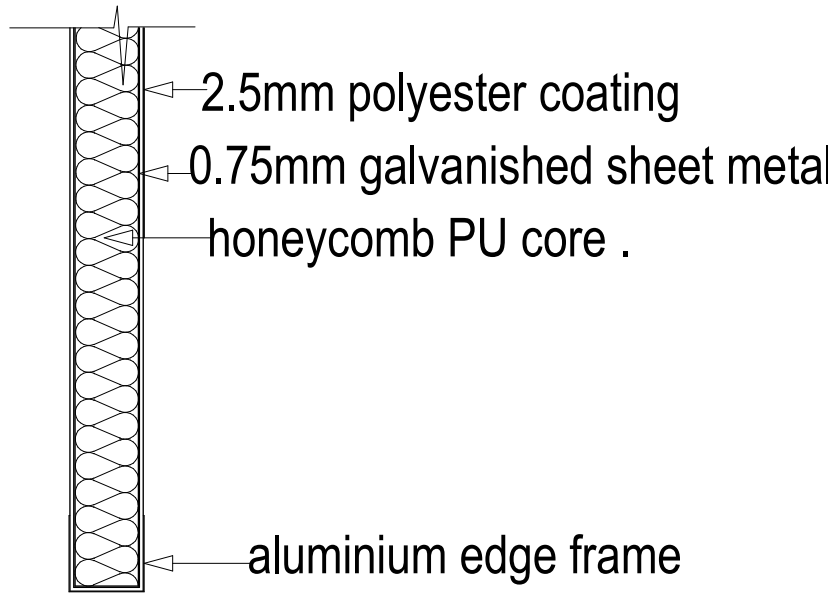

Typical door frame plan detail

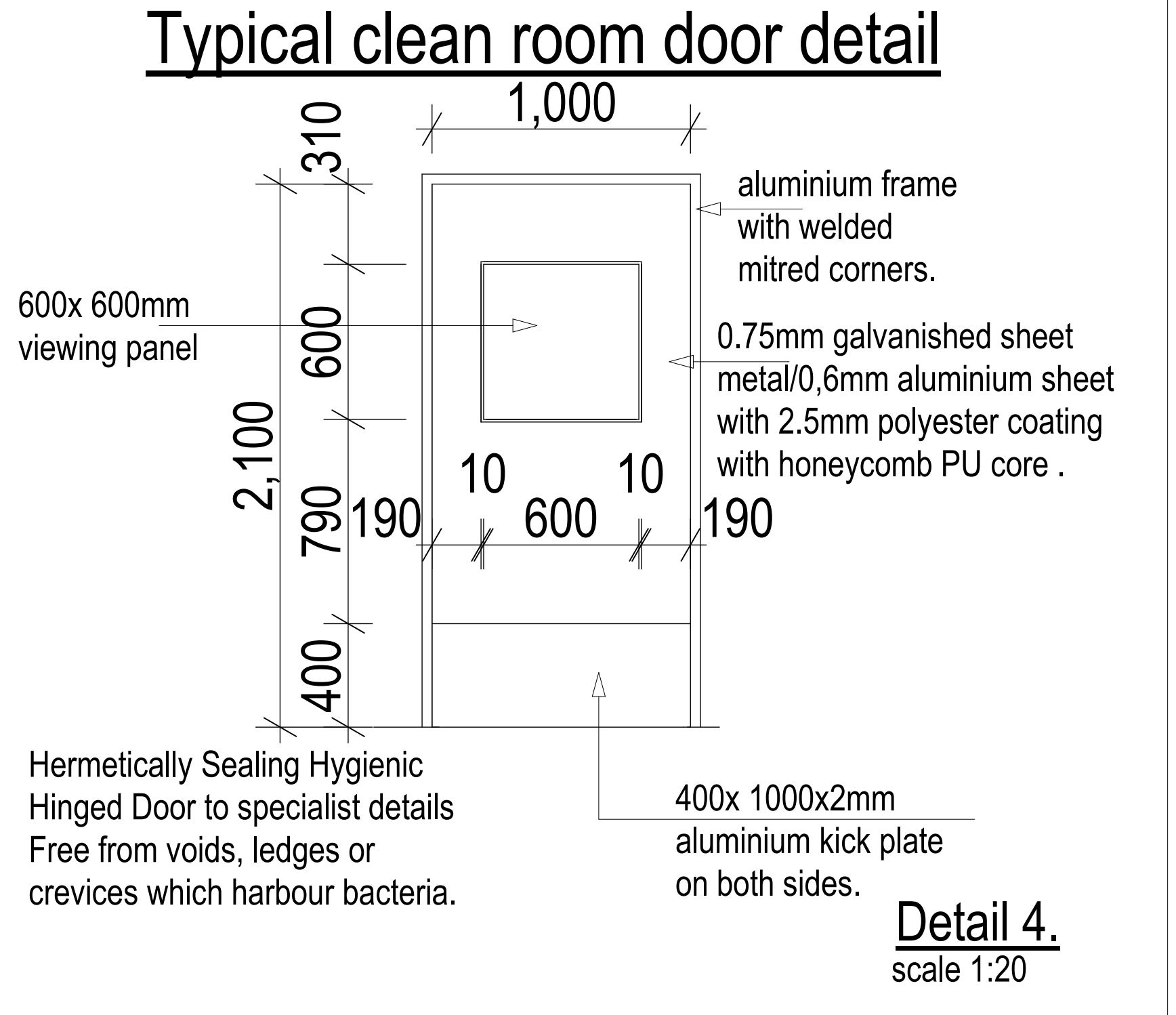
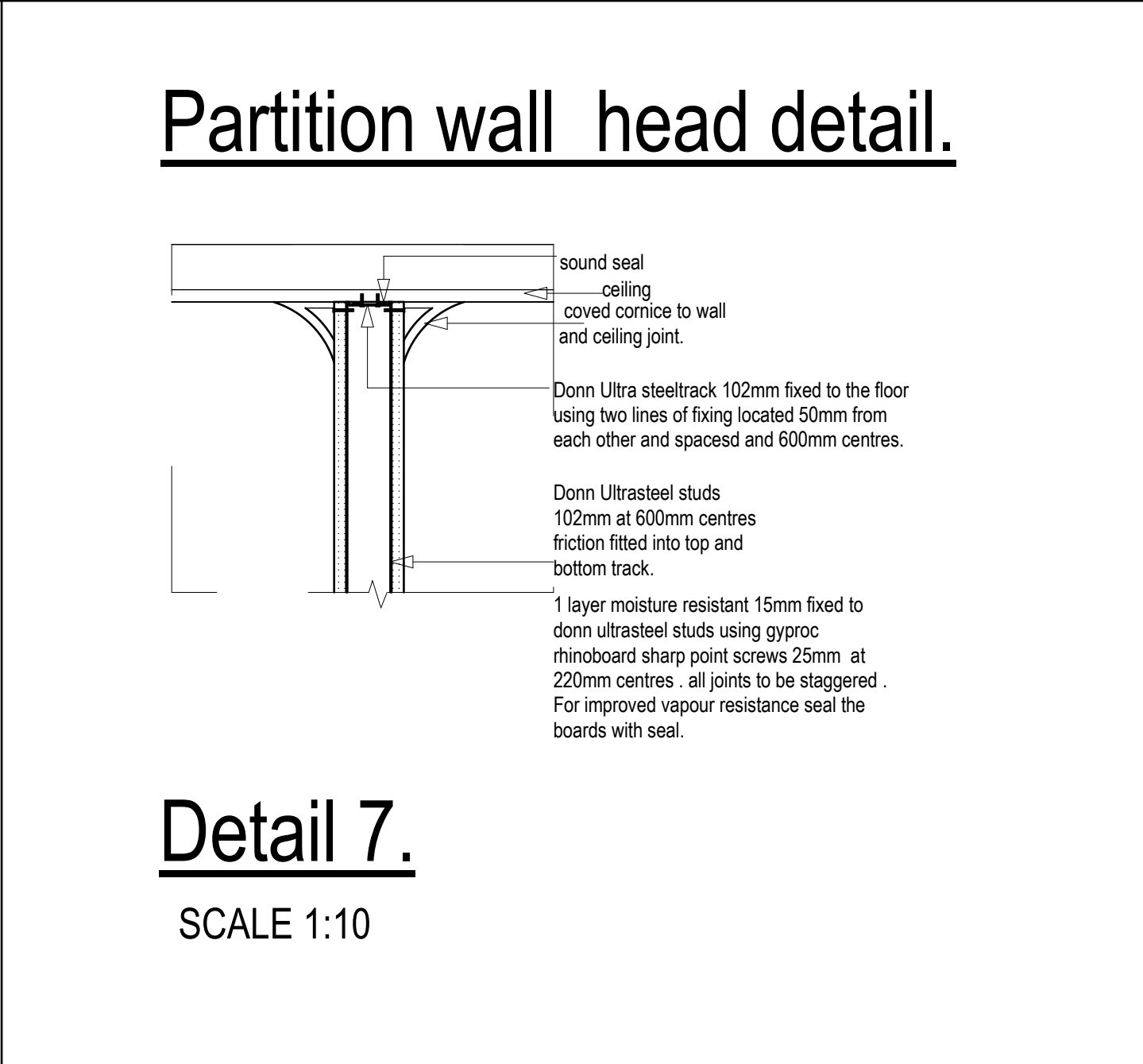
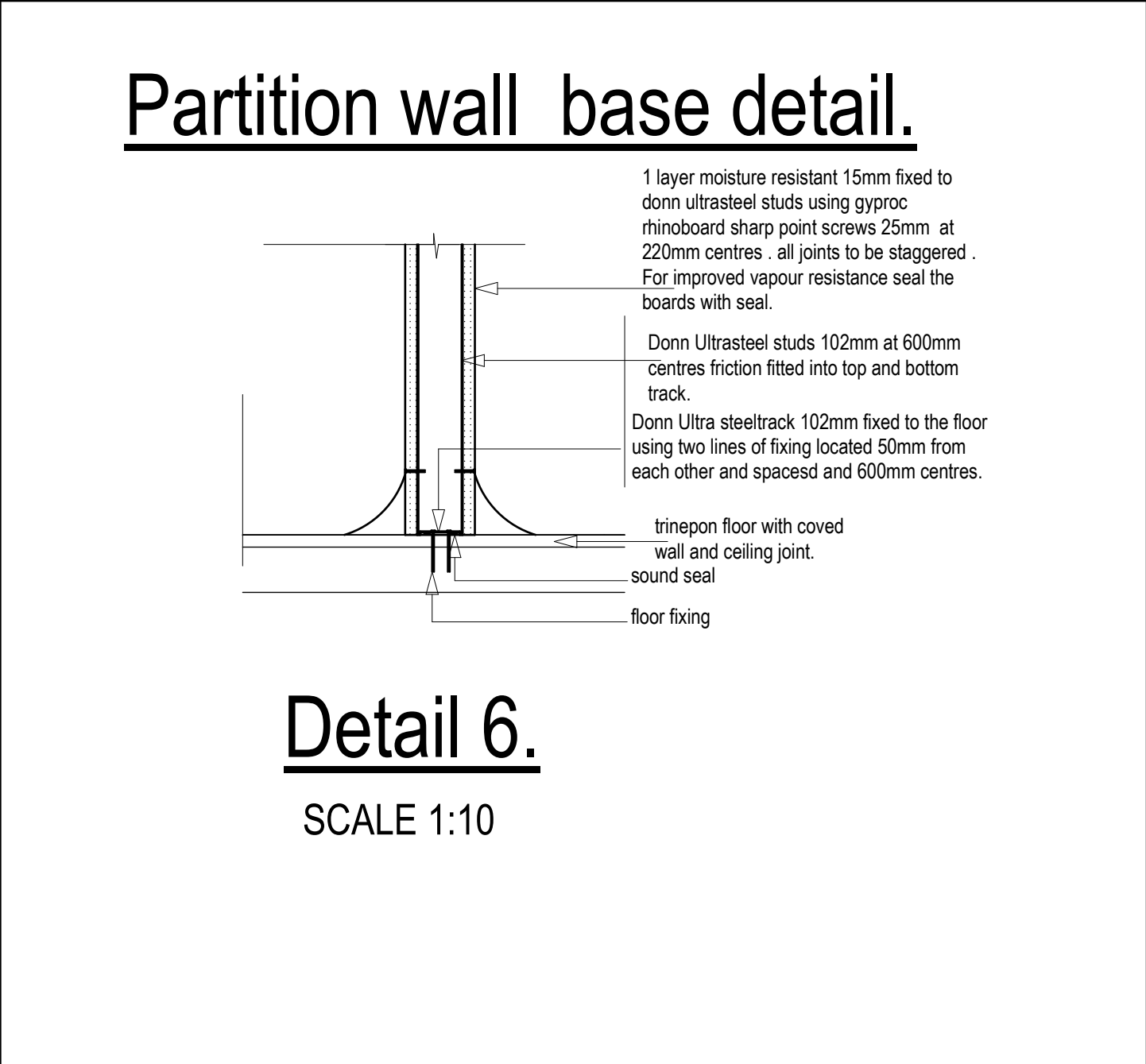
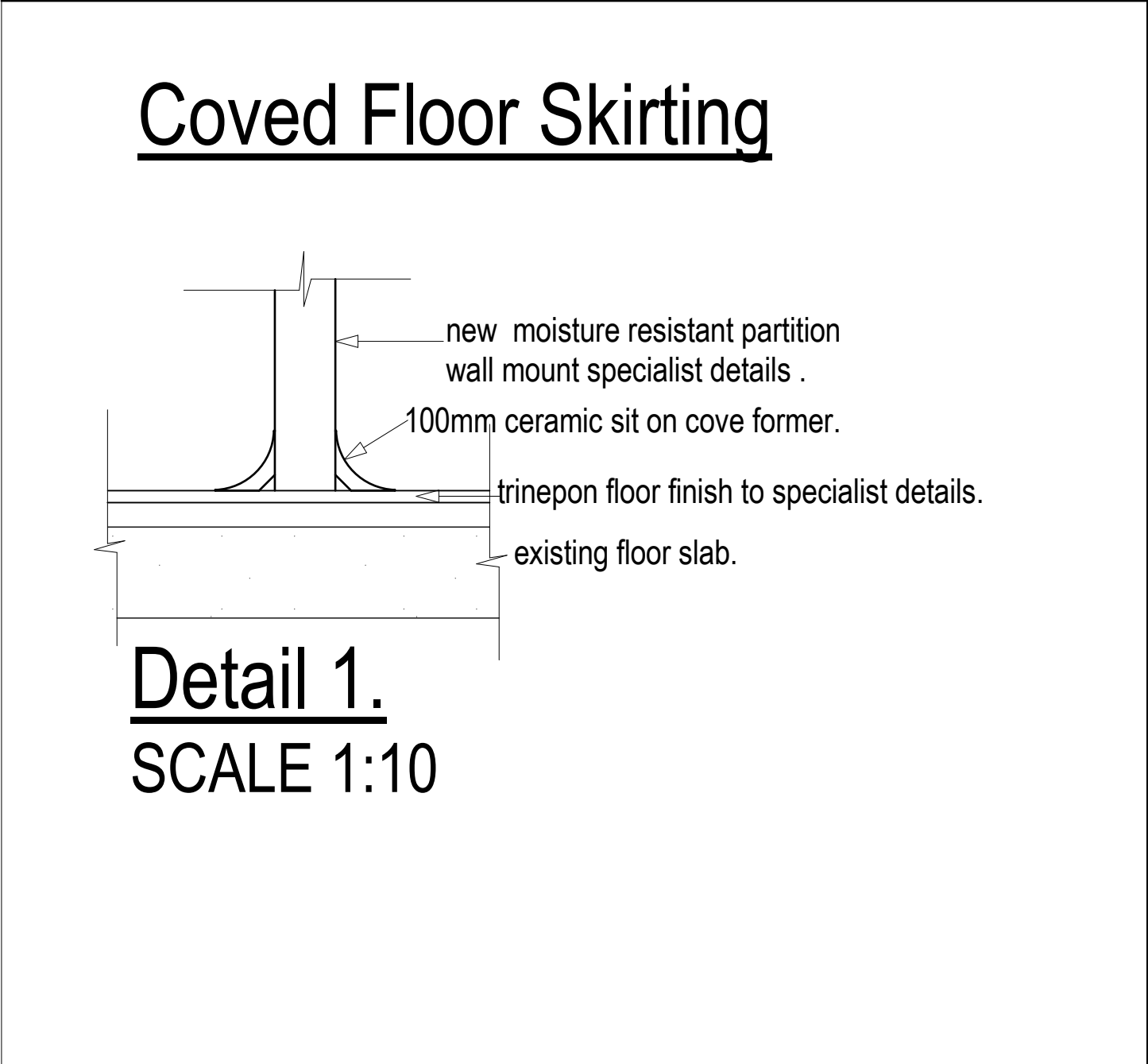
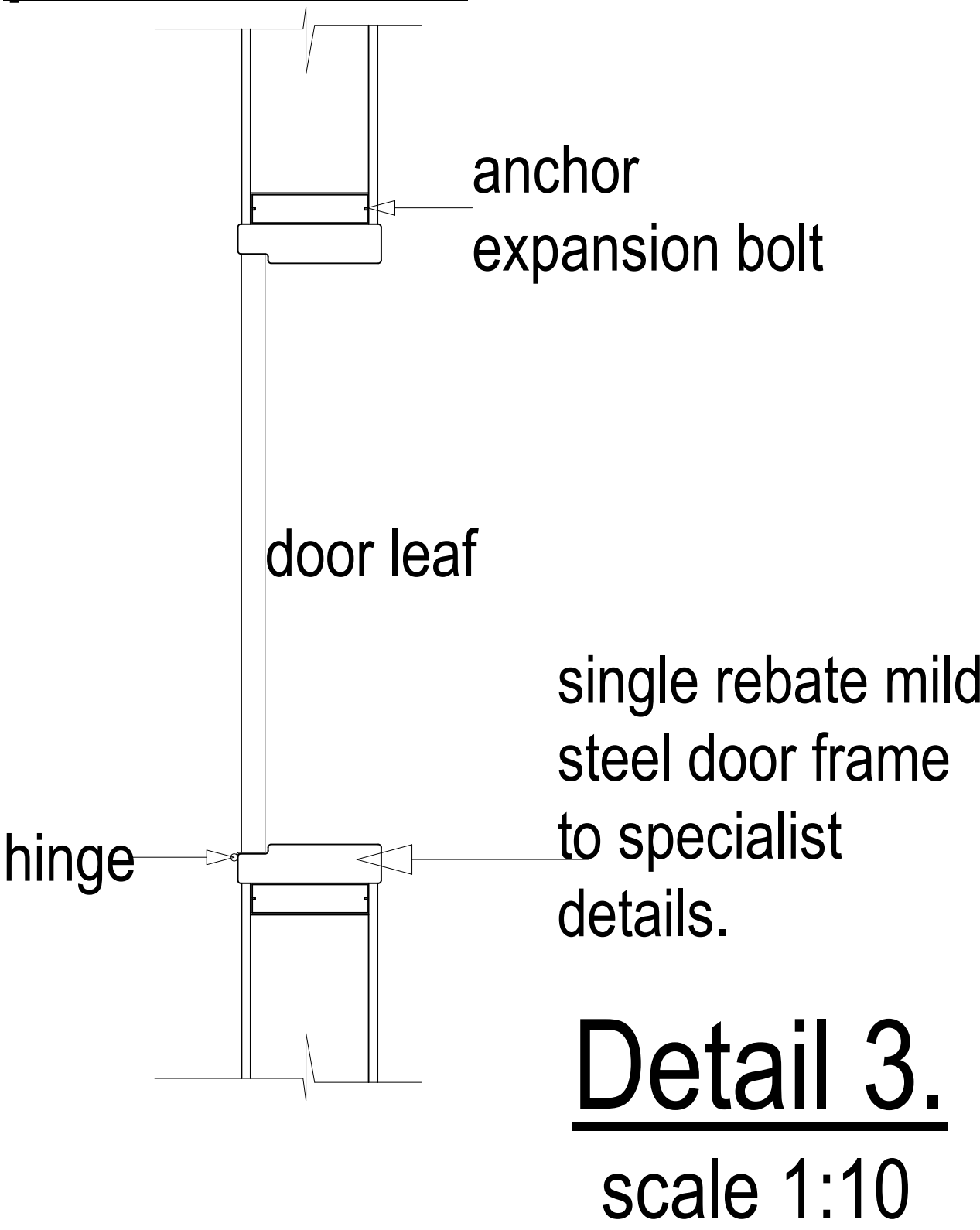

<div><div>MASIYANISE T.I.</div><div>REGISTERED ARCHITECT</div><div>Architects, Interior Designers, Planning Consultants, Landscaping</div><div>Flat no8 AvonFriars ,70xford Road Avondale</div><div>Tel: (04) 339746, (M) 0772 344 907, e-mail:masiarch@zol.co.zw</div></div>	<div><div>mti</div><div>architect</div></div>	PROJECT : MCAZ LABORATORY	SITE	106 BAINES AVENUE,HARARE.	<div>NOTES:</div> <div>-ALL DIMENSIONS AND LEVELS TO BE VERIFIED ON SITE PRIOR TO COMMENCING.</div> <div>-SETTING OUT, WORKSHOP DRAWINGS OR CONSTRUCTION.</div> <div>-DO NOT SCALE, FOLLOW ONLY WRITTEN DIMENSIONS.</div> <div>-DISCREPANCIES, ERRORS, OMMISIONS, TO BE BROUGHT TO THE ARCHITECTS ATTENTION IMMEDIATELY AFTER BEING EVIDENT.</div> <div>-SHOP DRAWINGS TO BE SUBMITTED FOR APPROVAL PRIOR TO MANUFACTURE</div> <div>-THIS DRAWING IS COPYRIGHT OF MASIYANISE T.I. REGISTERED ARCHITECT AND MAY NOT BE USED EXCEPT WITH WRITTEN PERMISSION OF THE ARCHITECT</div>	AMENDMENTS	DESIGNED	MTI	DATE	26/01/2017
		PROPOSED REFURBISHMENT	TITLE	SECTION AND DETAILS			DRAWN	MG	SCALE	AS SHOWN
		TENDER DRAWINGS	CLIENT	MCAZ			CHECKED	ITM	DWG NO.	WD/W1523/02

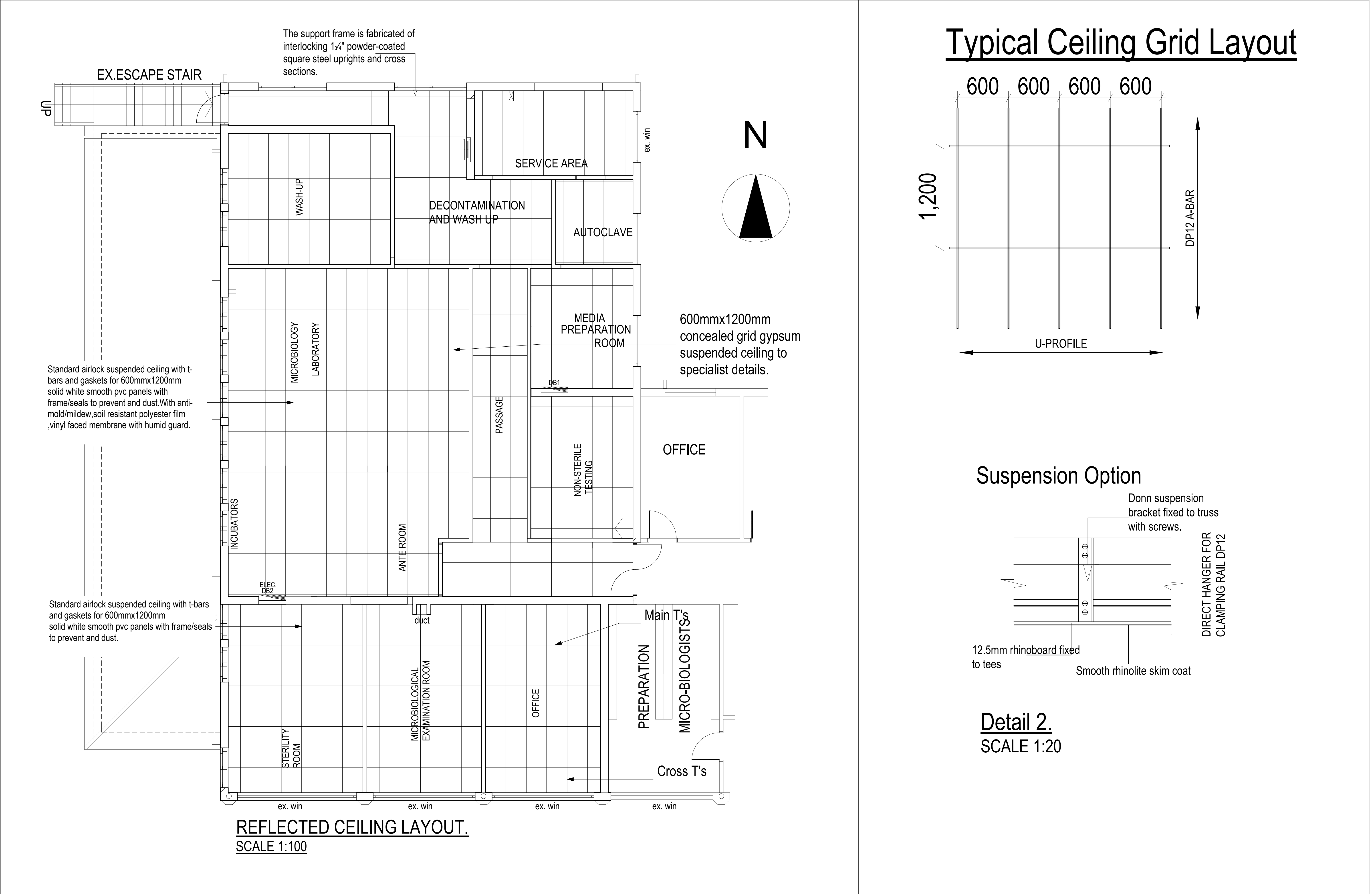

MASIYANISE T.I.

REGISTERED ARCHITECT
Architects, Interior Designers, Planning Consultants, Landscaping
Flat no8 AvonFriars ,7Oxford Road Avondale
Tel: (04) 339746, (M) 0772 344 907, e-mail:masiarch@zol.co.zw

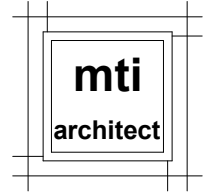

PROJECT : MCAZ LABORATORY
PROPOSED REFURBISHMENT

TENDER DRAWINGS

SITE

106 BAINES AVENUE,HARARE.

TITLE

CEILING DETAIL

CLIENT

MCAZ

NOTES:
-ALL DIMENSIONS AND LEVELS TO BE VERIFIED ON SITE PRIOR TO COMMENCING.
-SETTING OUT, WORKSHOP DRAWINGS OR CONSTRUCTION.
-DO NOT SCALE, FOLLOW ONLY WRITTEN DIMENSIONS.
-DISCREPANCIES, ERRORS, OMISSIONS, TO BE BROUGHT TO THE ARCHITECTS
ATTENTION IMMEDIATELY AFTER BEING EVIDENT.
-SHOP DRAWINGS TO BE SUBMITTED FOR APPROVAL PRIOR TO MANUFACTURE
-THIS DRAWING IS COPYRIGHT OF MASIYANISE T.I. REGISTERED ARCHITECT AND
MAY NOT BE USED EXCEPT WITH WRITTEN PERMISSION OF THE ARCHITECT

AMENDMENTS

DESIGNED

MTI

DATE

26/01/2017

DRAWN

MG

SCALE

AS SHOWN

CHECKED

ITM

DWG NO.

WD/W1523/03

Door schedule								Accessories				
Ref	Door Type	Description	Frame	230mm	100mm	115mm	Qty	door control	door holder	door lever.	lockset.	location.
D1		Hermetically Sealing Hygienic Hinged Door to specialist details Door: Single leaf with hermetic seal. Door Blade: POLYURETHANE CORE faced both sides with 0.75mm galvanised sheet metal/0.6mm aluminium sheet with 2.5mm polyester coating with honeycomb PU core OR SIMILAR. With anodised aluminium profile. Moisture absorption zero. Colour: white Door leaf: 48mm thick. Glazing: Double glazed with laminate safety glass or acrylic finished flush with both faces of door	Anodised (aluminium) steel or powder coated or anodised aluminium to suit wall thickness Hinges: Flush mortised hinges (standard or highload) D1 to be supplied and fit with appropriate hardware to specialist fitting the polycarbonate skin structure.		3		3	- door closer with integrated concealed mounting plate suitable for fire and smoke prevention -can be used for left and right hand door -color: silver. -thermodynamic valves for consistent performance. -guide rail height -adjustable to 14mm. -opening angle up to 170 degrees.	- Stainless steel floor mounted door stop.		Automated sensor control to specialist detail	-Sterility room
D2		Hermetically Sealing Hygienic Hinged Door to specialist details Free from voids, ledges or crevices which harbour bacteria Door: Single leaf with hermetic seal. Door Blade: POLYURETHANE CORE faced both sides with 0.75mm galvanised sheet metal/0.6mm aluminium sheet with 2.5mm polyester coating with honeycomb PU core OR SIMILAR. With anodised aluminium profile. Moisture absorption zero. Colour: white Door leaf: 48mm thick. Glazing: Double glazed with laminate safety glass or acrylic finished flush with both faces of door	Anodised (aluminium) steel or powder coated or anodised aluminium to suit wall thickness Hinges: Flush mortised hinges (standard or highload)	1			1	-can be used for left and right hand door -color: silver. -thermodynamic valves for consistent performance. -guide rail height -adjustable to 14mm. -opening angle up to 170 degrees.	Stainless steel mounted door stop. - finish stainless steel		Automated biometric access control to specialist detail linked IT.	-Main Entrance door
D3		Hermetically Sealing Hygienic Hinged Door to specialist details Door: Single leaf with hermetic seal. Door Blade: POLYURETHANE CORE faced both sides with 0.75mm galvanised sheet metal/0.6mm aluminium sheet with 2.5mm polyester coating with honeycomb PU core OR SIMILAR. With anodised aluminium profile. Moisture absorption zero. Colour: white Door leaf: 48mm thick. Glazing: Double glazed with laminate safety glass or acrylic finished flush with both faces of door	Anodised (aluminium) steel or powder coated or anodised aluminium to suit wall thickness Hinges: Flush mortised hinges (standard or highload)	1		1	2		Stainless steel mounted door stop. - finish stainless steel	ALUMINIUM backplate 152x76x3mm	key control system with double cylinder 66mm classic keying standard.	-Anteroom -Media examination
D4		Solid core timber door with aluminium finish with rubber lining. Colour: white Door leaf: 48mm thick. Glazing: Double glazed with laminate safety glass or acrylic finished flush with both faces of door	Mild steel frame prime and painted with a chemical resistant and washable paint Hinges: Flush mortised hinges (standard or highload)			1	1	-can be used for left and right hand door -color: silver. -thermodynamic valves for consistent performance. -guide rail height -adjustable to 14mm. -opening angle up to 170 degrees.	Stainless steel mounted door stop. - finish stainless steel	ALUMINIUM backplate 152x76x3mm for Europrofile cylinder locks (pair)	key control system with double cylinder 66mm classic keying standard.	-Passage 1
D5		Solid core timber door with aluminium finish with rubber lining. Colour: white Door leaf: 48mm thick. Glazing: Triple glazed with laminate safety glass outer panes finished flush with both faces of door, centre pane Georgian wired or ceramic glass, (3/4 & 60 min doors only) or Triple glazed with laminate safety glass outer panes finished with 2mm stainless steel frame, centre pane ceramic glass.	Mild steel frame prime and painted with a chemical resistant and washable paint Hinges: Flush mortised hinges (standard or highload)	1			1	--	Stainless steel mounted door stop. - finish stainless steel	ALUMINIUM backplate 152x76x3mm for Europrofile cylinder locks (pair)	key control system with double cylinder 66mm classic keying standard.	-Service area
D6		Hermetically Sealing Hygienic Hinged Door to specialist details Door: Single leaf with hermetic seal. Door Blade: POLYURETHANE CORE faced both sides with 0.75mm galvanised sheet metal/0.6mm aluminium sheet with 2.5mm polyester coating with honeycomb PU core OR SIMILAR. With anodised aluminium profile. Moisture absorption zero. Colour: white Door leaf: 48mm thick. Glazing: Double glazed with laminate safety glass or acrylic finished flush with both faces of door	Anodised (aluminium) steel or powder coated or anodised aluminium to suit wall thickness Hinges: Flush mortised hinges (standard or highload)		2		2		Stainless steel mounted door stop. - finish stainless steel	ALUMINIUM backplate 152x76x3mm for Europrofile cylinder locks (pair)	key control system with double cylinder 66mm classic keying standard.	-Incubators -Microbiology laboratory.
D7		Solid core timber door with aluminium finish with rubber lining. Colour: white Door leaf: 48mm thick.	Mild steel frame prime and painted with a chemical resistant and washable paint Hinges: Flush mortised hinges (standard or highload)	1			1	--	--	ALUMINIUM backplate 152x76x3mm for Europrofile cylinder locks (pair)	key control system with double cylinder 66mm classic keying standard.	-Service area
D8		Solid core timber door with aluminium finish with rubber lining. Colour: white Door leaf: 48mm thick.	Mild steel frame prime and painted with a chemical resistant and washable paint Hinges: Flush mortised hinges (standard or highload)	1			1	--	--	--	2 point or 3 point for single doors. 2 no vertical rods with latch pullman latches +1 no central latch.	-fire escape
D9		Hermetically Sealing Hygienic Hinged Door to specialist details Door: Single leaf with hermetic seal. Door Blade: POLYURETHANE CORE faced both sides with 0.75mm galvanised sheet metal/0.6mm aluminium sheet with 2.5mm polyester coating with honeycomb PU core OR SIMILAR. With anodised aluminium profile. Moisture absorption zero. Colour: white Door leaf: 48mm thick. Glazing: Double glazed with laminate safety glass or acrylic finished flush with both faces of door	Mild steel frame prime and painted with a chemical resistant and washable paint Hinges: Flush mortised hinges (standard or highload)			1	1	With pivot.	Stainless steel mounted door stop. - finish stainless steel	ALUMINIUM backplate 152x76x3mm	key control system with double cylinder 66mm classic keying standard.	-Ante room
D10		Solid core timber door with aluminium finish with rubber lining. Colour: white Door leaf: 48mm thick. Glazing: Double glazed with laminate safety glass or acrylic finished flush with both faces of door	Mild steel frame prime and painted with a chemical resistant and washable paint Hinges: Flush mortised hinges (standard or highload)	1	2		3	--	Stainless steel mounted door stop. - finish stainless steel	ALUMINIUM backplate 152x76x3mm for Europrofile cylinder locks (pair)	key control system with double cylinder 66mm classic keying standard.	-Office -Wash up -Autoclave
D11		Solid core timber door painted with chemical resistant washable paint. OR Better Colour: white Door leaf: 48mm thick. Glazing: Double glazed with laminate safety glass or acrylic finished flush with both faces of door	Anodised (aluminium) steel or powder coated or anodised aluminium to suit wall thickness Hinges: Flush mortised hinges (standard or highload)		1		1	--	Stainless steel mounted door stop. - finish stainless steel	ALUMINIUM backplate 152x76x3mm	key control system with double cylinder 66mm classic keying standard.	-Media preparation
D12		Solid core timber door painted with chemical resistant washable paint. OR Better Colour: white Door leaf: 48mm thick. Glazing: Double glazed with laminate safety glass or acrylic finished flush with both faces of door	36mm Anodised (aluminium) steel or powder coated or anodised aluminium shortgrain frame to suit wall thickness Hinges: Flush mortised hinges (standard or highload)		1		1	--	Stainless steel mounted door stop. - finish stainless steel	ALUMINIUM backplate 152x76x3mm	key control system with double cylinder 66mm classic keying standard.	-Non-sterile testing
						Total	18					NB:all window and door sizes to be verified on site by supplier before manufacture and installation of product.

GENERAL CONSTRUCTION DETAILS:

Cabinets:
Cabinets shall be constructed of prime 18 gauge steel for the sides, backs, and toe space.
1" X 18 gauge steel tubing shall be used for the top front and back rails. Each front joint is to be welded and ground flush to provide a smooth surface. A 4" high X 3" deep toe space shall be standard. Four corners are to be fitted with a stamped and welded 14 gauge leveling gusset plate, and a plated leveling screw. Leveling screws are provided with a slot for easy adjustment, and non marking nylon glides. Removable back panels shall be furnished on all cabinets. Cabinet bottom will be pinned up to contain spills and removable for easy cleaning and maintenance.
Doors - Base Cabinet Doors:
Doors shall be double pan construction, with insulating material fastened to the inside for sound deadening, and strength, to prevent panining and bending. Hinges are five knuckle gauge stainless steel, fastened to both the door and cabinet frame with zinc plated steel screws. Door catches plated.
Drawers:
Drawer bodies shall be one piece 20 gauge construction, fully coved on all four sides horizontally and formed out of one sheet of steel.
Drawer Suspension:
Drawers shall operate on full extension, ball bearing, zinc plated, drawer suspension rated to withstand 10,000 cycles at 100 lbs.
Shelves:
Shelves shall be constructed of 18 gauge steel, with channels formed on both the front and back edges. K & V shelf clips are made from 14 gauge steel, and are to be adjustable vertically in 1" increments. Sliding shelves shall use the same ball bearing slides as drawer units.

LABORATORY CASEWORK

Wall Cabinets:
Wall Cabinets shall be made to the same quality standards as base units. Shelf hangers are to be constructed of 14 gauge steel, and to easily adjust vertically in one inch increments. Shelves are to be constructed with channel type fronts and backs, as well as flanged ends with nylon button glides. Wall units to have open fronts, and swinging steel and glass doors as specified. Glass is plate, ground on all exposed.
Floor Units:
Floor Units shall be made to the same quality standards as base units.
Shelves and shelf hanger construction, same as wall units.
Floor units to be furnished with the same front and door configurations as the above described wall units.
2.04 FINISH:
A. All surfaces shall be painted or plated, whether they are exposed or not. Paint is to Be a chemically resistant baked on epoxy powder coat enamel.
CASEWORK MATERIALS
Galvanized Sheet Steel/sheet steel:
Mild steel, cold rolled furniture grade to requirements of ASTM A1008/A1008M, Grade C or higher, with smooth surfaces to furniture quality.
Glass:
Clear float, 6mm and 3mm thick, conforming to CAN2-12.3-MTFS, glazing quality. Laminated glass: CAN/CSGS-12-1-M80, Type 1 with clear PVB interlayer. Total nominal thickness of laminated glass: 6 mm.
Cabinet Hardware:
1. Pulls: Provide handles for drawers and hinged doors in 100mm (4") satin finish aluminium.
2. Door Hinges: Provide five knuckle type barrel door hinges of 1.5mm (1/16") Gal steel screwed into door and fastened to cabinet side stile with two counter sunk #8-32 zinc plated machine screws & captive serrated tooth washer nuts. Standard hinge finish shall be bright chrome.
3. Locks:
a) Removable core, 5 disc tumbler with 229 key changes on a single cut key complete with master key.
b) [Optional when required] removable core, 5 disc tumbler with a double cut key containing over 1800 key changes and complete with master key.

COLOR:
Steel cabinets casework- Snow White
Corian for clean room-Modern white
Grey granite for other rooms

Window schedule						
Ref	Window Type	Description	Frame	230mm	115mm	location.
W1		6.38mm clear glazing fixed pane.	28mm natural powder coated Aluminium frame section to specialist detail.	6		-Microbiology laboratory. -Wash up -Sterility room -Incubators.
W2		6.38mm clear glazing fixed panes.	28mm natural powder coated Aluminium frame section to specialist detail.	1		-Sterility room
W3		6.38mm clear glazing fixed panes.	36mm natural powder coated Aluminium frame section to specialist detail.	1		-Sterility room
W4		6.38mm clear glazing fixed panes.	28mm natural powder coated Aluminium frame section to specialist detail.	2		-Passage 2
W5		6.38mm clear glazing fixed panes.	36mm natural powder coated Aluminium frame section to specialist detail.	3		-Autoclave -Media Prep Room -Service Room
W6		NB:all window and door sizes to be verified on site by supplier before manufacture and installation of product. 6.38mm clear double glazing fixed panes.	36mm natural powder coated Aluminium framesection to specialist detail.		1	-Passage 1
W7		6.38mm clear glazing fixed panes.	36mm natural powder coated Aluminium framesection to specialist detail.	1		-Microbiological exam room

Finishes notes

Interior Finishes	
Walls	Remove existing paint and apply epoxy primer and tuffcoote enamel(white) or similar to wall surfaces.
Floors	Monolithic seamless chemical resistant Triponex floor finish(grey) flooring with integral coved base.
Ceiling	Moister resistant gypsum ceiling to specialist details.
Plumbing and Piping <i>General</i>	Sink with hot and cold water supply and clinical solvent drain; sinks to be acid resistant self-rimming sinks; faucets to have wrist lever and goose neck spout. Fixtures, fittings, and connections to acid waste and vent, with polypropylene piping all piping to collect to existing drainage system.
Fire Protection <i>Fire and Smoke Detection</i>	Fire alarm and smoke detectors to mechanical engineers details.
Laboratory Module	Hand-held chemical emergency fire extinguisher in all rooms were needed to mechanical engineers details.
Telephone and Communication <i>Outlets</i>	Intercom or communication systems should be designed to allow hands-free use, or their design should facilitate disinfection to Electrical engineers detail.
Equipment	No DESCRIPTION OF ACTIVITY 5 x Incubators 2 x Biosafety cabinets with stainless steel stands 3 x 2 Combination Scientific fridge/freezer with accessories 4 x 1 Water Purifier 5 x 1 Automated Temperature Monitoring System with CPU and monitor (to be installed in the entire laboratory) 6 x 1 Microplate Reader with CPU and monitor 7 x 1 Thermo mixer with accessories 8 x 1 UV-Vis Spectrophotometer with accessories, CPU & monitor 9 x 1 Particle Counter with accessories 10 x 2 x Refurbishment of the existing Munchen Wall Mounted Autoclaves
CLEAN ROOMS FITTINGS AND SURFACES	All fittings, such as power outlets and light fittings should be flush with the wall or ceiling surfaces and sealed to prevent entrainment of unclean air. Surfaces should be smooth and impervious to the cleaning agents used.

MASIYANISE T.I.

REGISTERED ARCHITECT
Architects, Interior Designers, Planning Consultants, Landscaping
Flat no8 AvonFriars ,7Oxford Road Avondale
Tel: (04) 339746, (M) 0772 344 907, e-mail:masiarch@zol.co.zw

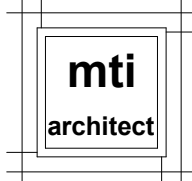

PROJECT : MCAZ LABORATORY
PROPOSED REFURBISHMENT

TENDER DRAWINGS

SITE

106 BAINES AVENUE,HARARE.

TITLE

DOORS AND WINDOW SCHEDULES

CLIENT

MCAZ

NOTES:

-ALL DIMENSIONS AND LEVELS TO BE VERIFIED ON SITE PRIOR TO COMMENCING.
-SETTING OUT, WORKSHOP DRAWINGS OR CONSTRUCTION.
-DO NOT SCALE, FOLLOW ONLY WRITTEN DIMENSIONS.
-DISCREPANCIES, ERRORS, OMISSIONS, TO BE BROUGHT TO THE ARCHITECTS ATTENTION IMMEDIATELY AFTER BEING EVIDENT.
-SHOP DRAWINGS TO BE SUBMITTED FOR APPROVAL PRIOR TO MANUFACTURE
-THIS DRAWING IS COPYRIGHT OF MASIYANISE T.I. REGISTERED ARCHITECT AND MAY NOT BE USED EXCEPT WITH WRITTEN PERMISSION OF THE ARCHITECT

AMENDMENTS

DESIGNED

MTI

DATE

26/01/2017

DRAWN

MG

SCALE

AS SHOWN

CHECKED

ITM

DWG NO.

WD/W1523/04

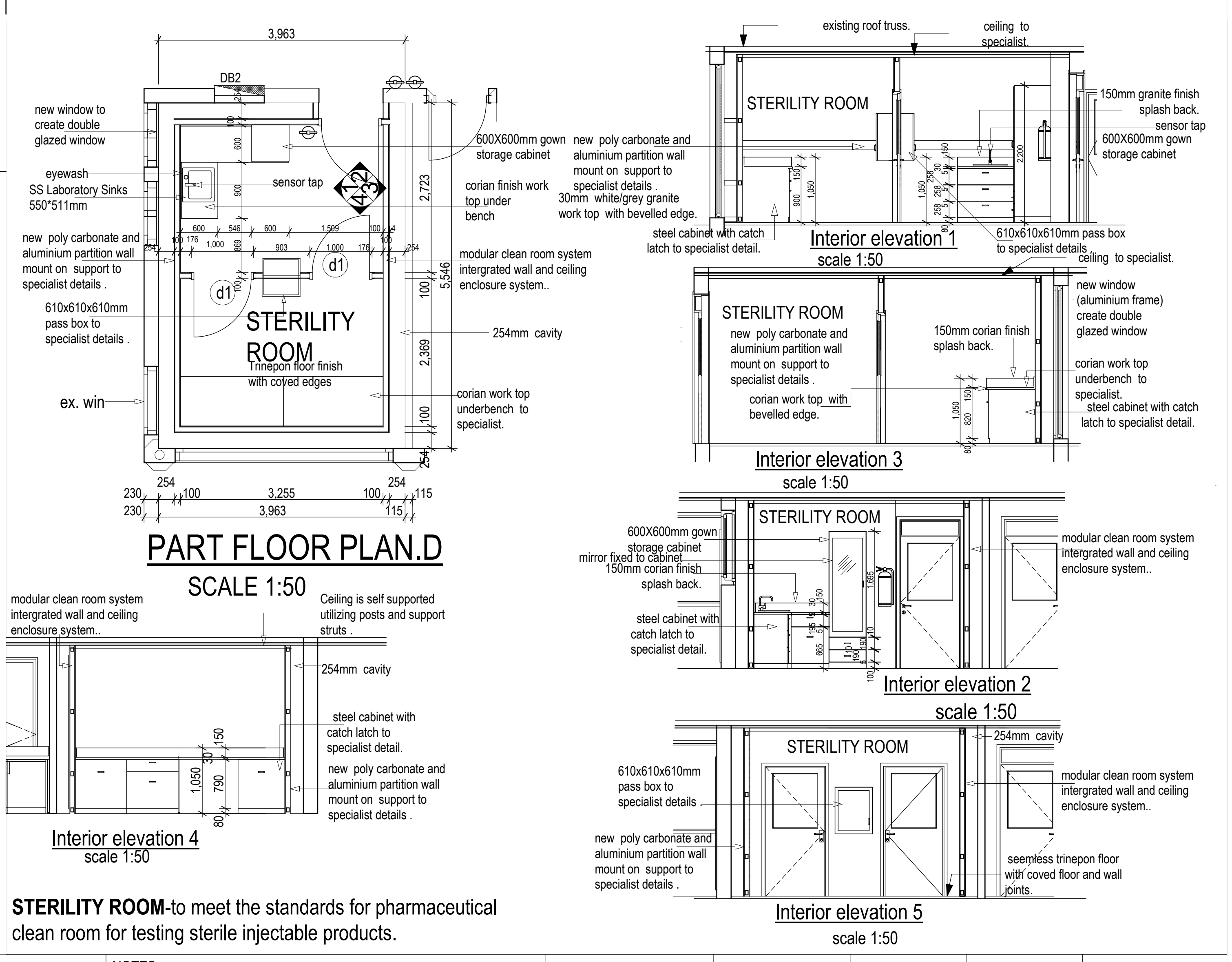
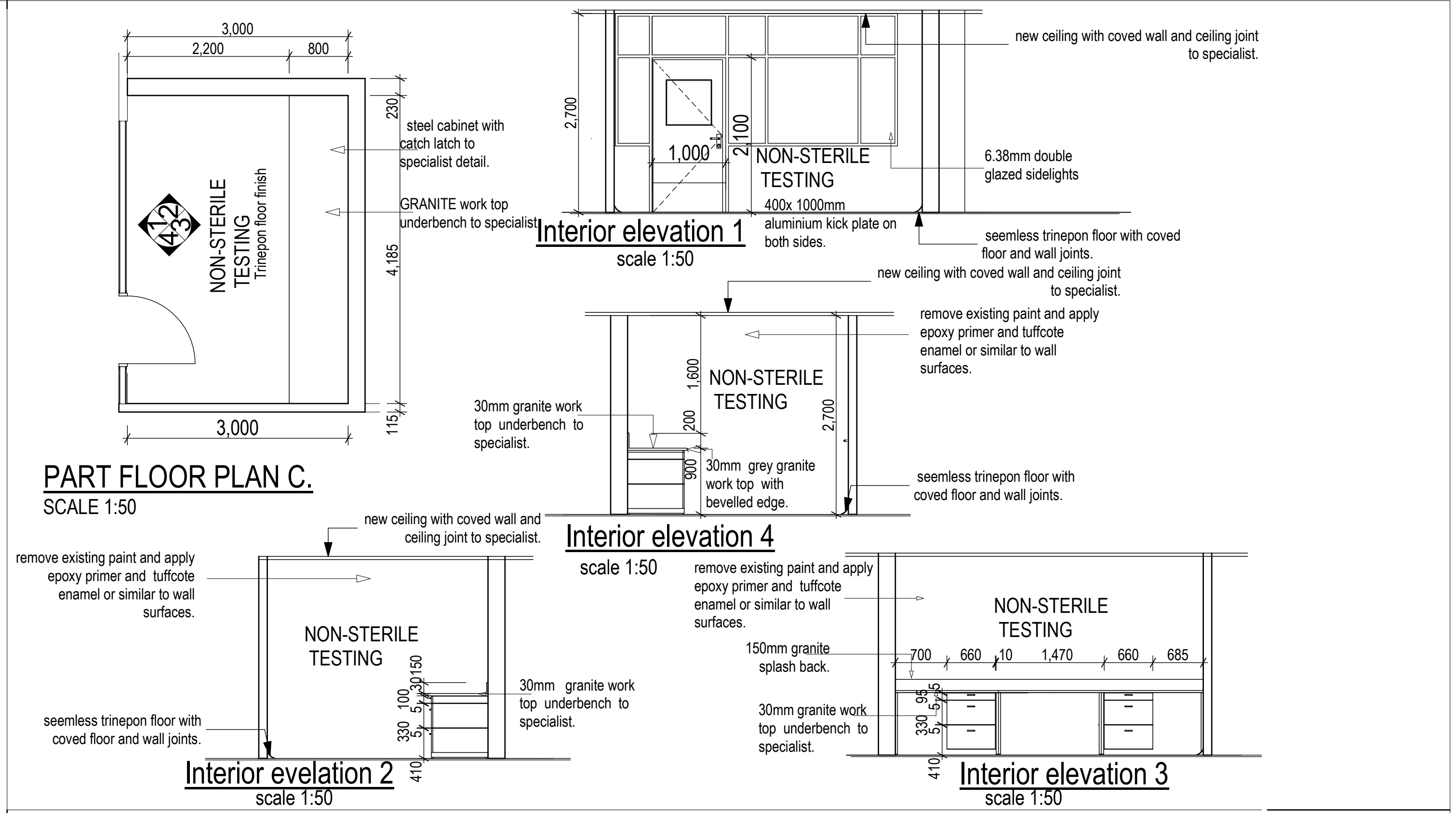
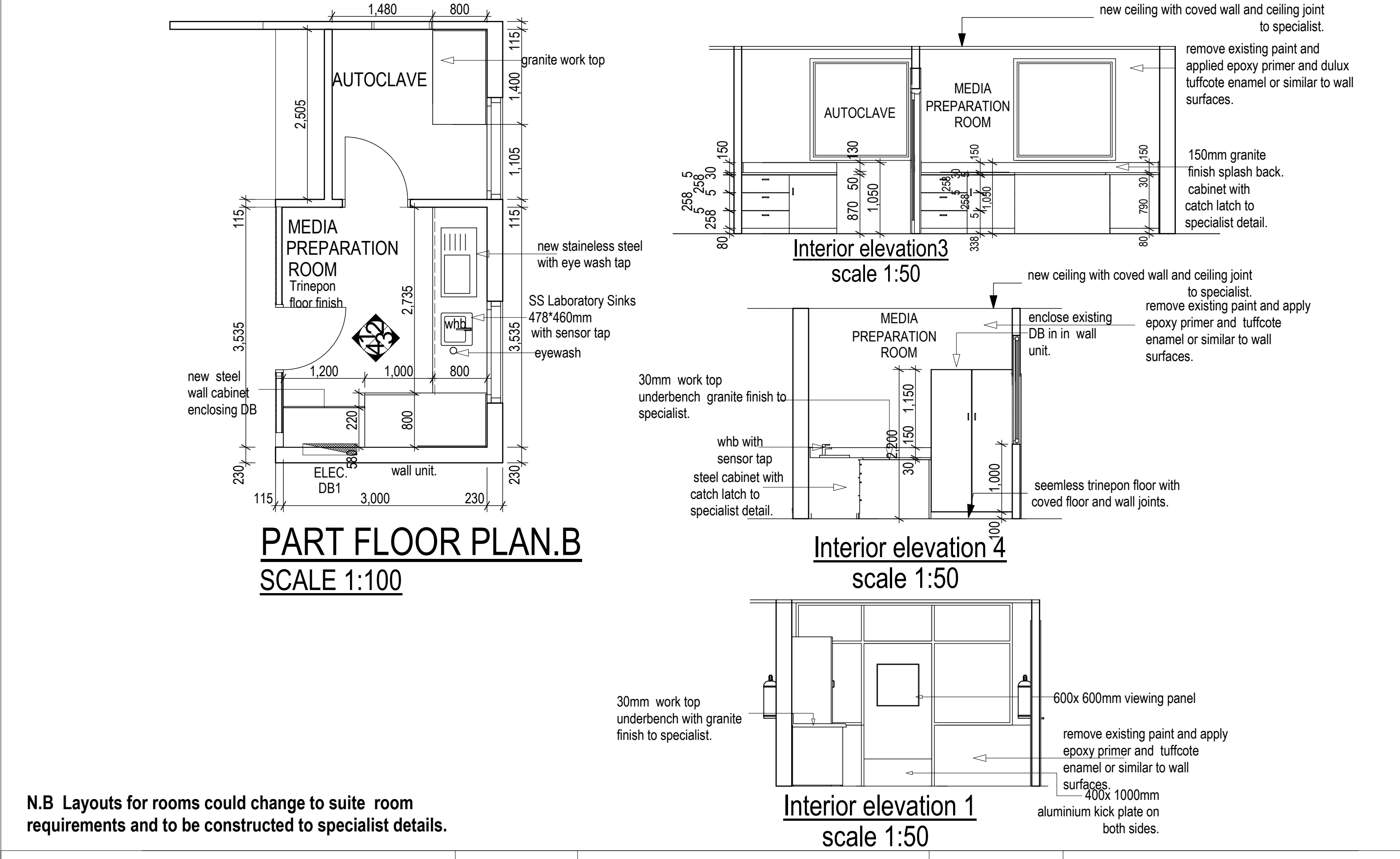
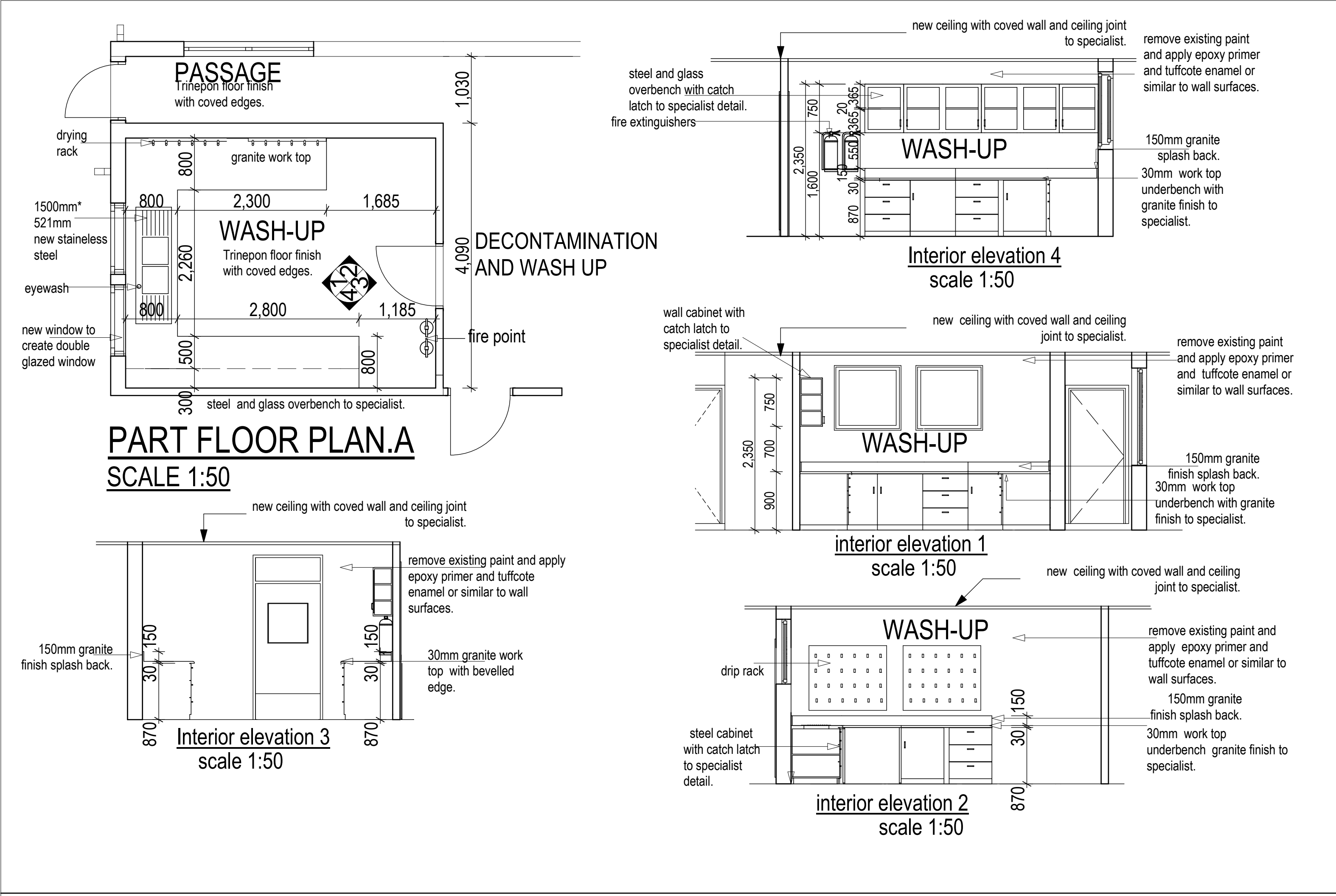

<div>MASIYANISE T.I.</div> <div>REGISTERED ARCHITECT</div> <div>Architects, Interior Designers, Planning Consultants, Landscaping</div> <div>Flat no8 AvonFriars .7Oxford Road Avondale</div> <div>Tel: (04) 339746, (M) 0772 344 907. e-mail:masiarch@zoi.co.zw</div>		PROJECT : MCAZ LABORATORY	SITE	106 BAINES AVENUE,HARARE.	<div>NOTES:</div> <div>-ALL DIMENSIONS AND LEVELS TO BE VERIFIED ON SITE PRIOR TO COMMENCING.</div> <div>-SETTING OUT, WORKSHOP DRAWINGS OR CONSTRUCTION.</div> <div>-DO NOT SCALE, FOLLOW ONLY WRITTEN DIMENSIONS.</div> <div>-DISCREPANCIES, ERRORS, OMISSIONS, TO BE BROUGHT TO THE ARCHITECTS ATTENTION IMMEDIATELY AFTER BEING EVIDENT.</div> <div>-SHOP DRAWINGS TO BE SUBMITTED FOR APPROVAL PRIOR TO MANUFACTURE</div> <div>-THIS DRAWING IS COPYRIGHT OF MASIYANISE T.I. REGISTERED ARCHITECT AND MAY NOT BE USED EXCEPT WITH WRITTEN PERMISSION OF THE ARCHITECT</div>	AMENDMENTS	DESIGNED	MTI	DATE	26/01/2017
		PROPOSED REFURBISHMENT	TITLE	ROOM FURNITURE LAYOUTS (Sheet 1 of 2)			DRAWN	MG	SCALE	AS SHOWN
		TENDER DRAWINGS	CLIENT	MCAZ			CHECKED	ITM	DWG NO.	WD/W1523/05

PART FLOOR PLAN.E
SCALE 1:50

Interior elevation 1
scale 1:50

Interior elevation 3
scale 1:50

Interior elevation 4
scale 1:50

Interior elevation 1
scale 1:50

Interior elevation 1

scale 1:50

PART FLOOR PLAN.F
SCALE 1:50

Interior elevation 2
scale 1:50

Interior elevation 1
scale 1:50

Interior elevation 4
scale 1:50

PART FLOOR PLAN.G
SCALE 1:50

Interior elevation 1
scale 1:50

Interior elevation 2
scale 1:50