

notes

1. All dimensions are in millimetres unless otherwise stated
2. Figured dimensions are to be taken in preference to scaling
3. Any errors, ambiguities or queries relating to this drawing are to be referred to the architect for clarifications before commencing work.
4. This drawing is to be read in conjunction with all other relevant drawings.

No. Revision Date

CLIENT:



MINISTRY OF HEALTH

MEDICAL STORES

UNDP

JOB TITLE:

MSL PHARMACEUTICAL
DISTRIBUTION CENTER

DISCRIPTION:

CONSULTANCY SERVICES TO
DEVELOP A NEW MASTER PLAN

DRAWING TITLE

SITE PLAN FOR PROPOSED
DEMOLITIONS

Scale: 1:500

Date: JUL, 2015

Dwg No.: MWT/02

Drawn:
MICHELO MIYOBA

Checked By:
SEBASTIAN MAZAKAZA

[Rev A: Alteration to the section

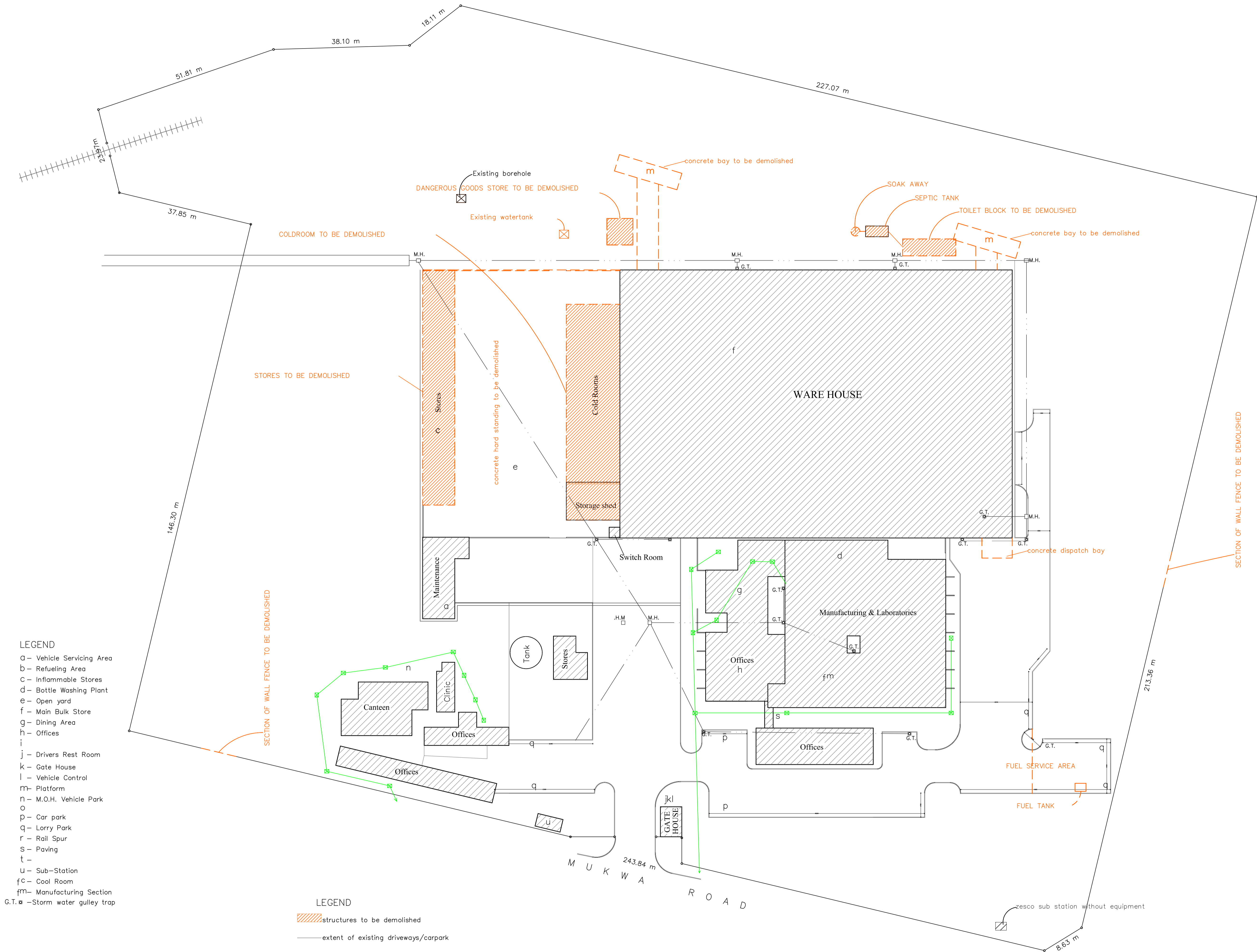

LEGEND

- a - Vehicle Servicing Area
- b - Refueling Area
- c - Inflammable Stores
- d - Bottle Washing Plant
- e - Open yard
- f - Main Bulk Store
- g - Dining Area
- h - Offices
- i - Drivers Rest Room
- j - Gate House
- l - Vehicle Control
- m - Platform
- n - M.O.H. Vehicle Park
- o - Car park
- p - Car park
- q - Lorry Park
- r - Rail Spur
- s - Paving
- t - Sub-Station
- u - Sub-Station
- fc - Cool Room
- fm - Manufacturing Section
- G.T. - Storm water gully trap

LEGEND

- structures to be demolished
- extent of existing driveways/carpark