

UN Darfur Fund

Promote Reconciliation and Coexistence for Sustainable Peace in Darfur

NORTH DARFUR MELLIT LOCALITY

COMMUNITY CENTER - STANDARD MODEL

February 2016

Bahauddin Ibrahim

+249 (0) 9 112 13 334 / +249 (0) 1 141 97 005
bahaalim@gmail.com

محطة
كالتق



FINISHING SCHEDULE

CEILING FINISHES	
1	US ZINC SHEET (0.5MM)
2	OIL PAINT
3	FABRIC TEXTILE SHEETS
WALL FINISHES	
1	CERAMIC TILES
2	MARBLE TILES
3	3 COATS OF POMASTIC ON C/S PLASTER
4	ROUGH PLASTER
SKIRTING	
1	TERAIZZO TILES
2	CERAMIC TILES
3	MARBLE TILES
4	GRANITE TILES
FLOOR FINISHES	
1	TERAIZZO TILES
2	CERAMIC TILES
3	FAIR FACE CEMENT/ SAND FINISH ON PC

CEILING FINISHES

C	W
F	S

 WALL FINISHES

FLOOR FINISHES

C	W
F	S

 SKIRTING

ELECTRICAL KEY

S	Description
W2	WALL MOUNTED KDK FAN
FR	FAN REGULATOR
SO	SOCKET OUTLET
13A	13A SOCKET OUTLET
WL	WALL MOUNTED LAMP
DS	DOUBLE ONE WAY SWITCH

UN Darfur Fund
Promote Reconciliation
and Coexistence
for Sustainable
Peace in Darfur
Foundational and Short Term Activities (FaST)

**STANDARD MODEL
COMMUNITY PEACE CENTER**

Lead Agency:
UNDP (with UN Women)

MODEL (C)

FEB
2016

Design By:
Bahauddin Ibrahim
+249 (0) 9 112 13 3547 +249 (0) 1 141 97 005
bahauddin@un.org

A1

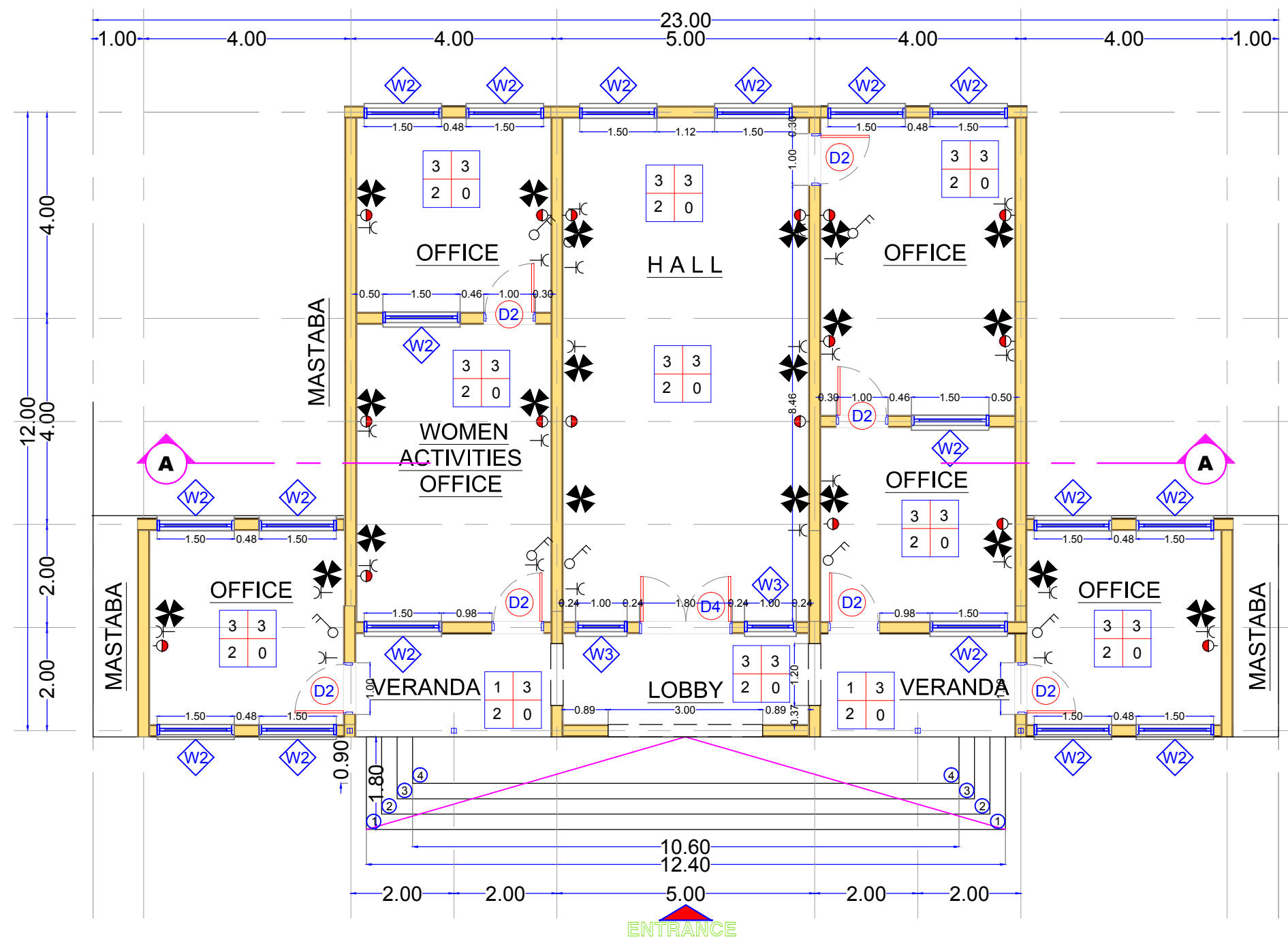

**GROUND FLOOR PLAN LAYOUT
Main Building**

Scale 1:100 A3

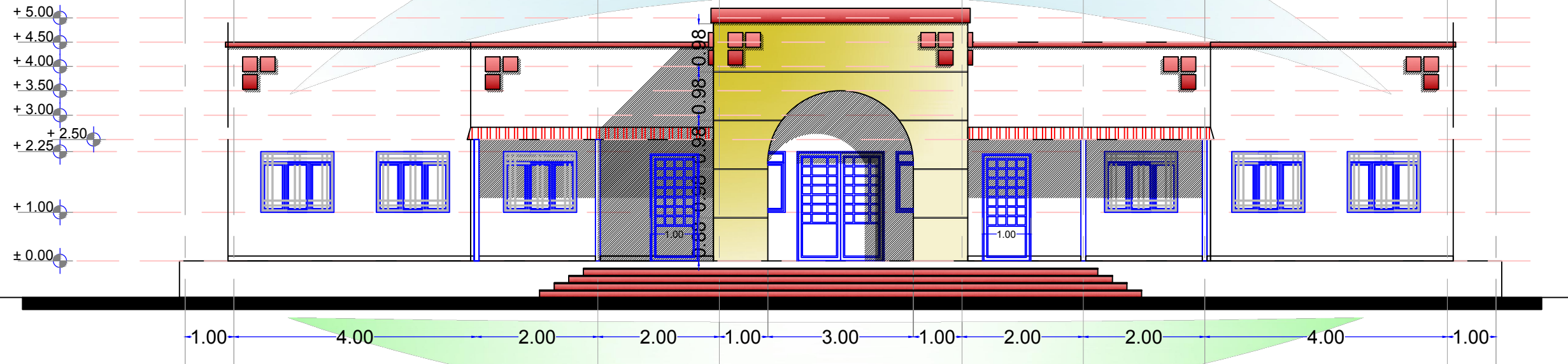
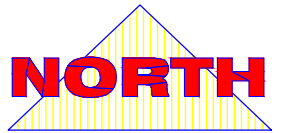

ELEVATION MAIN VIEW
Main Building

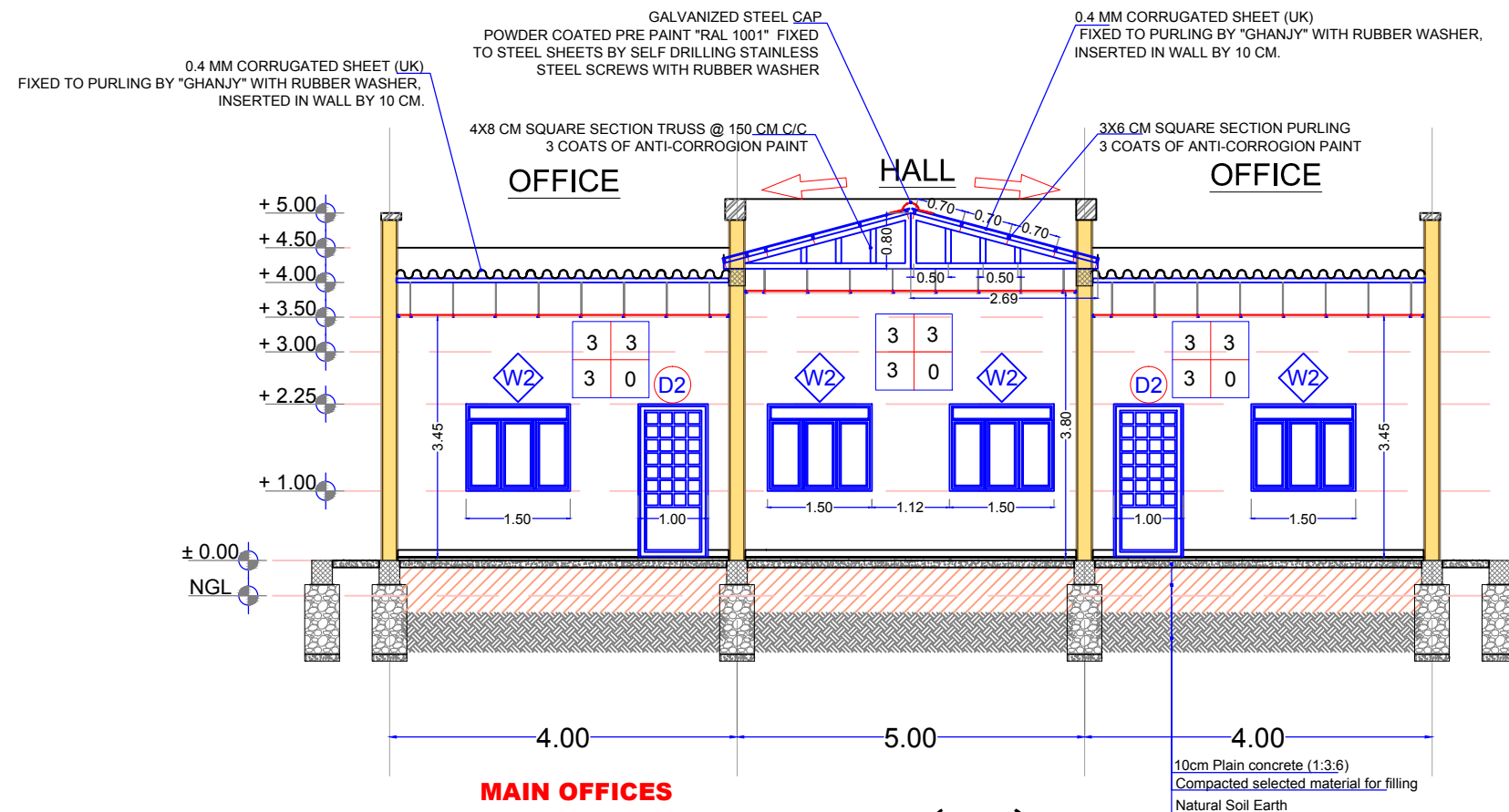

MAIN OFFICES
DETAILED SECTION (AA)

FINISHING SCHEDULE

CEILING FINISHES	
1	US ZINC SHEET (0.5MM)
2	OIL PAINT
3	FABRIC TEXTILE SHEETS
WALL FINISHES	
1	CERAMIC TILES
2	MARBLE TILES
3	3 COATS OF POMASTIC ON C/S PLASTER
4	ROUGH PLASTER
SKIRTING	
1	TERAIZZO TILES
2	CERAMIC TILES
3	MARBLE TILES
4	GRANITE TILES
FLOOR FINISHES	
1	TERAIZZO TILES
2	CERAMIC TILES
3	FAIR FACE CEMENT/ SAND FINISH ON PC

CEILING FINISHES	C	W	WALL FINISHES
FLOOR FINISHES	F	S	SKIRTING



ELECTRICAL KEY

S	Description
56	56 INCH CEILING KDK FAN
FAN REGULATOR	
SOCKET OUTLET	
13A	13A SOCKET OUTLET
WALL MOUNTED LAMP	
DOUBLE ONE WAY SWITCH	

UN Darfur Fund
Promote Reconciliation
and Coexistence
for Sustainable
Peace in Darfur
Foundational and Short Term Activities (FaST)

STANDARD MODEL
COMMUNITY PEACE CENTER

Lead Agency:
UNDP (with UN Women)

MODEL (C) FEB 2016

Design By:
Bahauddin Ibrahim
+249 (0) 9 112 13 354 / +249 (0) 1 141 97 005
bahauddinibrahim.com

A2

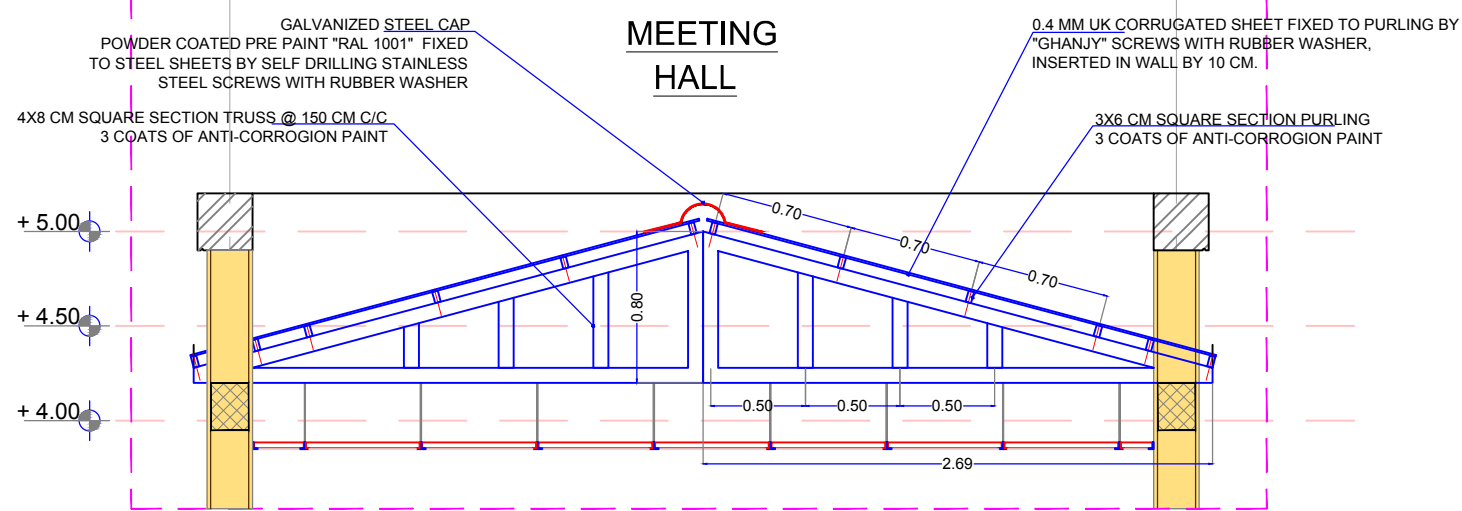

STEEL TRUSS SECTION

Scale NTS

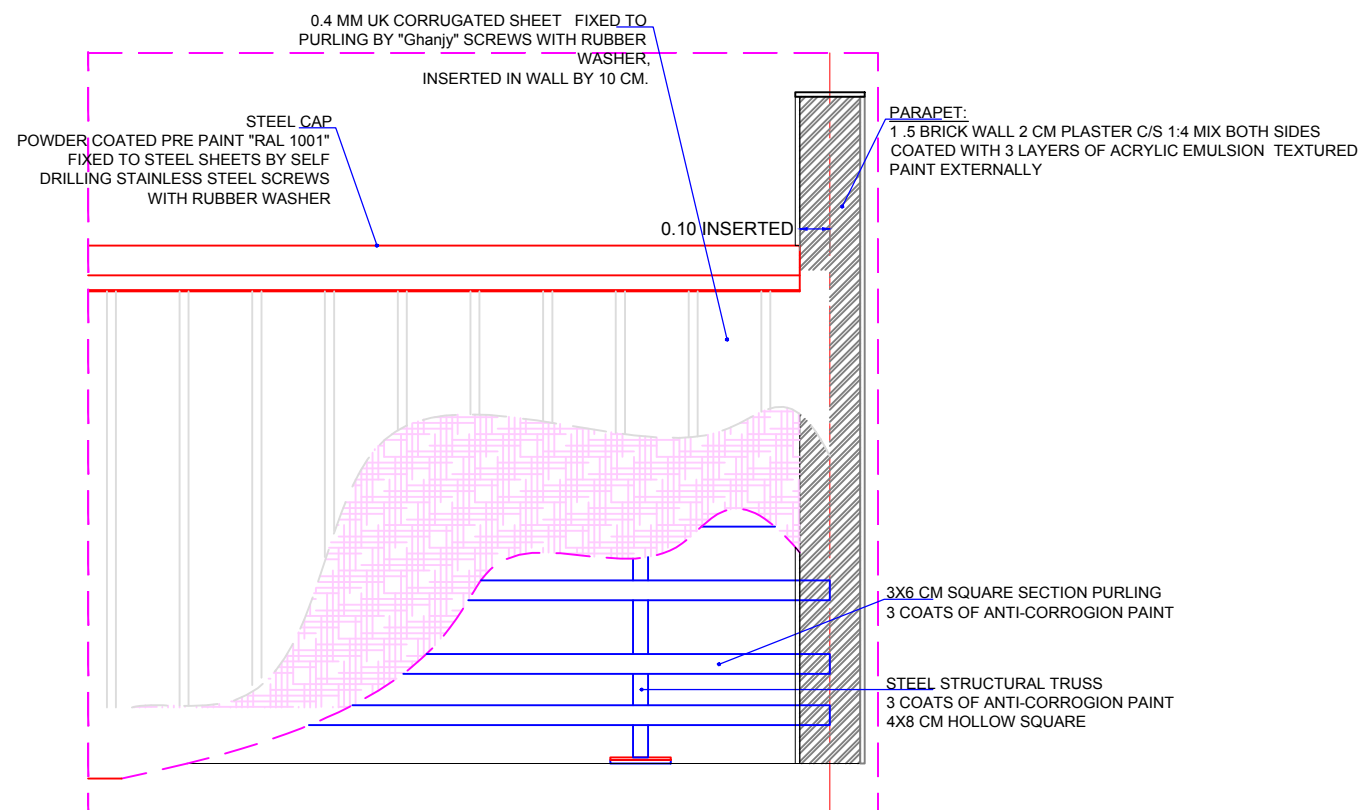

STEEL TRUSS DETAILS

Scale NTS

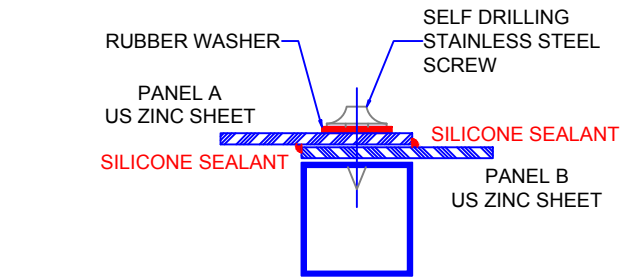

WATER TIGHT ENLARGED DETAIL

Scale NTS

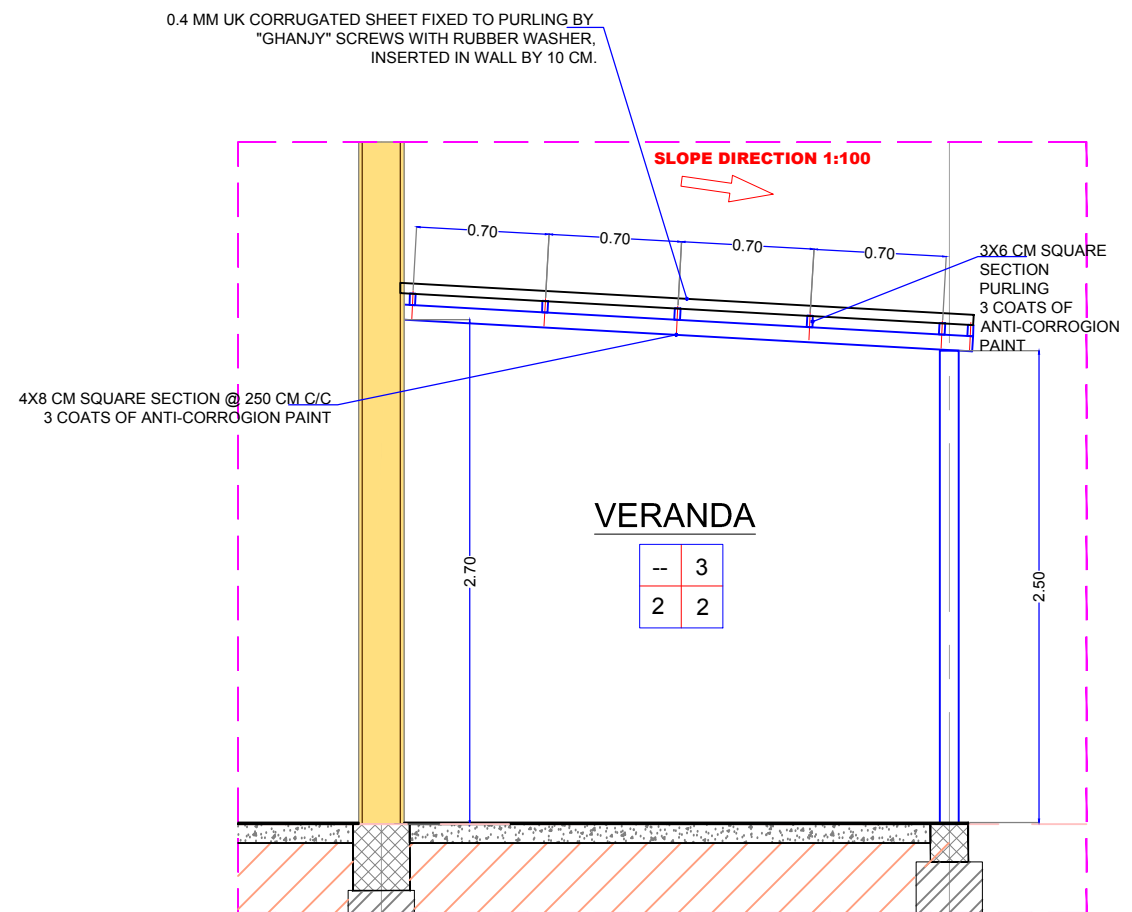

VERANDA SECTION

Scale NTS

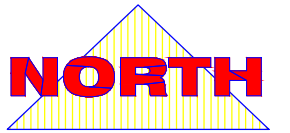

UN Darfur Fund
Promote Reconciliation
and Coexistence
for Sustainable
Peace in Darfur
Foundational and Short Term Activities (FaST)

**STANDARD MODEL
COMMUNITY PEACE CENTER**
FOR TENDERING

Lead Agency:
UNDP (with UN Women)

MODEL (C)

FEB
2016

Design By:
Bahaudin Ibrahim
+249 (0) 9 112 13 3347 +249 (0) 1 141 97 005
bahaudin@gmail.com

A4

WINDOWS

SAMPLE TO BE APPROVED.

W2 Painted Steel Width1500xH.1250mm

Hinged Window
Flyscreen Mesh
6mm Glaze
Frame (4X8 Tube)
Window Leaf (3X6 Tube)
Grill (2X2 Tube)
3Handle & 6Latch

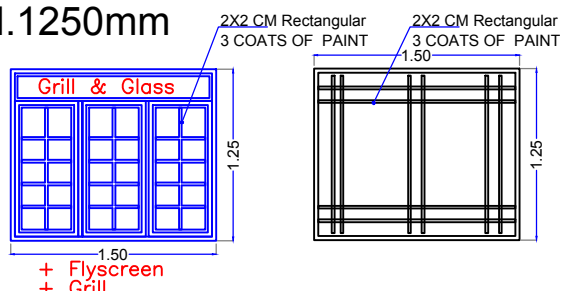

W3 Painted Steel Width1500xH.1250mm

Hinged Window
Flyscreen Mesh
6mm Glaze
Frame (4X8 Tube)
Window Leaf (3X6 Tube)
Grill (2X2 Tube)
2 Handle & 4 Latch

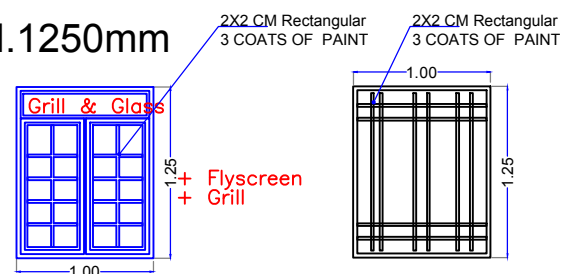

W4 Painted Steel Width800xH.500mm

Hinged Window
Grill (2X2 Tube)

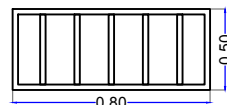

DOORS

SAMPLE TO BE APPROVED.

D1 Painted Steel Width800xH.2150mm

Hinged STEEL DOOR
NO Glaze @ Door Leaf
Frame (4X8 Tube)
Door Leaf (3X6 Tube)
3 Hinges Each Leaf
1Handle & 2 Latch

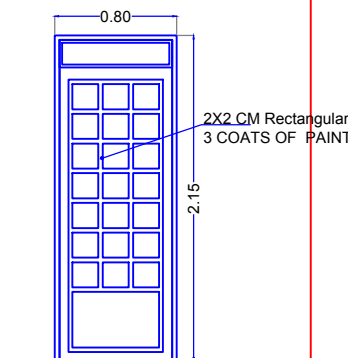

D2 Painted Steel Width1000xH.2150mm

Hinged STEEL DOOR
Glaze @ Door Leaf
Frame (4X8 Tube)
Door Leaf (3X6 Tube)
3 Hinges Each Leaf
1Handle & 2 Latch

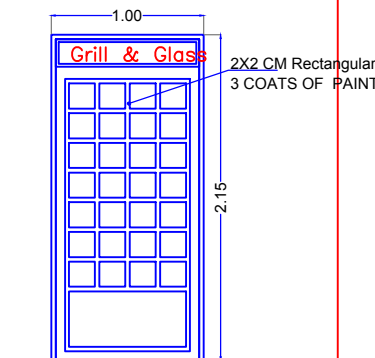

D4 Painted Steel Width1800xH.2150mm

Hinged STEEL DOOR
Glaze @ Door Leaf
Frame (4X8 Tube)
Door Leaf (3X6 Tube)
3 Hinges Each Leaf
1Handle & 2 Latch

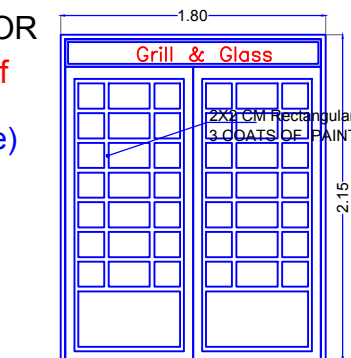

MAIN OFFICES DOORS & WINDOWS

Scale NTS

UN Darfur Fund
Promote Reconciliation
and Coexistence
for Sustainable
Peace in Darfur
Foundational and Short Term Activities (FaST)

STANDARD MODEL
COMMUNITY PEACE CENTER
FOR TENDERING

Lead Agency:
UNDP (with UN Women)

MODEL (C) FEB 2016

Design By:
Bahauddin Ibrahim
+249 (0) 9 112 13 354 / +249 (0) 1 141 97 005
bahauddin@gmail.com

A6