

Scope of Work

Rehabilitation of Psychosocial Center Front Yard Landscaping in Misrata, Libya

BACKGROUND:

The Support to Transitional Justice and Reconciliation at the Local and National Levels in Libya is a 2- year project that aims to facilitate dialogue between different parties in localized disputes and to work with the parties to identify a way to develop capacities for conflict resolution, establish transitional processes to deal with past violations and develop plans to enhance community security. The project will support key actors at the local and national levels to a) continue dialogue processes on transitional justice and return of IDPs; b) develop strategies and plans to support transitional justice measures; c) support inclusive community safety and security planning. The project will begin with the Misrata and Tawergha dialogue and will aim to replicate the approach in other communities through the course of 2016-2017.

PROJECT DESCRIPTION:

the Psychosocial Support Center Landscaping is a rehabilitation project, which is located in Misrata municipal branch Tummina 20 KM south of Misrata Center. 32°15'21.5"N 15°04'45.5"E



Location of the existing Psychosocial in Misrata:

The building has a roofed area of about 360 square meters and is located on an area of 2750 square meters consisting of the following:

- Four semesters.
- Three toilets.
- A kitchen.
- Corridors and three management rooms.

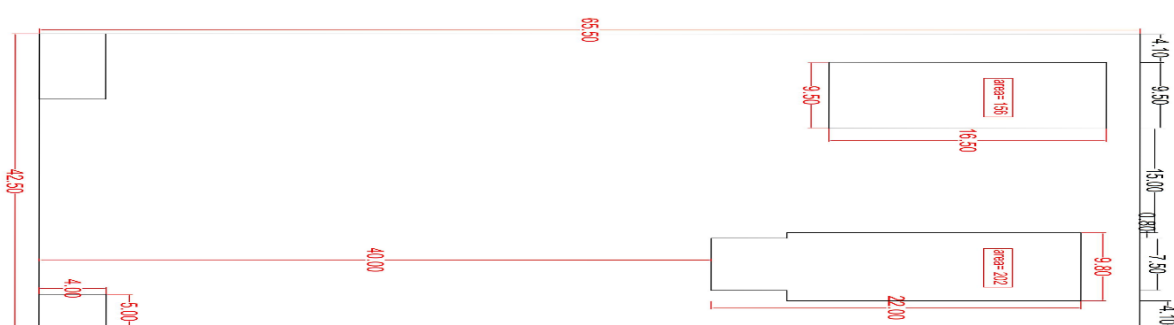

The work includes:

Required works:

- Trees Plantation and green area (Grass) works.
- Demolition and removal works of minor work in the building
- Construction of walkway and curb stones
- Soil preparation and irrigation systems
- Plastering works

