

SYMBOLS LEGEND	
Symbol	Description
	Reference to a detail drawing Upper N°: Number of detail Lower N°: Number of sheet
	Reference to a photo First N°: Number of photo Second N°: Number of sheet
	Keynote, Intervention that corresponds to Specifications and Bill of Quantities
	Height above datum
KEYNOTES - INTERVENTION CODES	
01 GENERAL 1.1.0 Summary of work, scope & limits 1.1.4 Access to the site 1.5.0 Temporary facilities, controls, utilities - staging 1.5.5 Vehicular access and parking 1.5.6 Temporary work barriers to protect the trees, tamps 1.5.8 Project identification 02 SITE CONDITIONS 2.2.0 Site inspection 2.2.2A Cutting and removal of concrete or asphalt pavement attached to wall 2.2.2B Removal of concrete skylights 2.2.2C Concrete structure over Museum roof 2.2.2D Removal of site debris 2.2.2E Concrete tank on top of Cavalier's walls 2.2.3 Gravel removal 2.2.4 Metal fixtures, embedded items, flagpoles, tubes etc. to be removed 2.2.6 Grade adjustment for drainage 2.2.7 Excavation, filling and backfilling for drainage 2.6.2 Site drainage with perforated pipe 2.6.2B Surface drainage with cast in place lime concrete 2.6.2C Drainage of top of walls- earth surfaces 2.6.2D Drainage of top of walls, parapets, embrasures- covered surfaces 2.8.2 Installation of safety fences 2.8.0 Site plants, growth of vegetation removal 2.8.5 Site encroachment 03 CRACKS 3.6.4 Injection grouting large cracks 04 MASONRY 4.4.3A Installation of new ashlar stone at base of walls 4.4.3B Installation of new ashlar stone at embrasures, walls and parapets 4.9.0 Part removal from masonry walls 4.9.2A Mortar pointing 4.9.2B Structural consolidation- collapsed retaining wall at northeast gun platform 4.9.2C Structural consolidation- deformed cavalier wall 4.9.2D Structural consolidation- collapsed parapet southern curtain wall 4.9.2E Structural consolidation of south curtain wall 4.9.5 Stone cleaning- general 4.9.6 Repair of stone built platforms & floors 05 METALS 5.1.1 Safety fence 5.1.2 Safety bars 5.1.3 Safety handrails 06 WOOD 6.1.1 Wooden blocks 6.1.2 Wooden safety pans 07 DRAINAGE 7.0.5 Drainage system at the bottom of the monument 7.0.6 Drainage system- e scuppers and drain pipes 08 DOORS & WINDOWS 8.6.3 Skylights installation 16 ELECTRICAL 16.4.0 Electrical cables on masonry 16.5.3 Emergency lighting	
United Nations Development Program Program funded by EUROPEAN UNION	
Project Designed By: MICHAEL PITTAS, SELEN AVKAN YENIADA, RAND EPPICH, ANASTASIA PITTA, KALYPSO FOTIOU, MUGE SEVKETOGLU, ARISTODEMOS ANASTASIADIS, BYRON CHRISTOU	
Project Name: PS-04-2017-97952 (code: C17948) PROJECT DESIGNS FOR CONSERVATION INTERVENTION OF Arsenal Bastion Famagusta, Cyprus Conservation and Structural	
Date	December 20, 2017
Scale	In drawing
Drawing name:	HAND/GUARD RAIL, SKYLIGHTS AND DRAINAGE DETAILS
Drawing no.:	C13

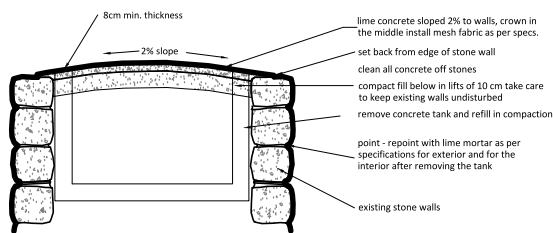

1 crown on all caliver walls
C02 scale 1:50

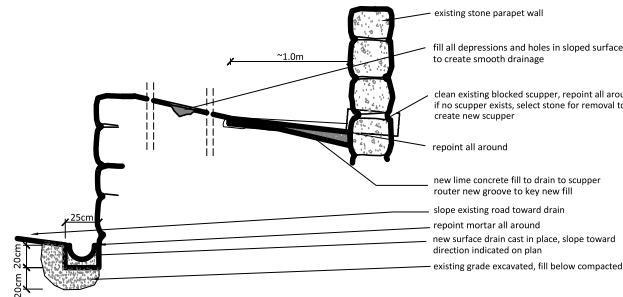

2 surface drain at parapet
C02 scale 1:20

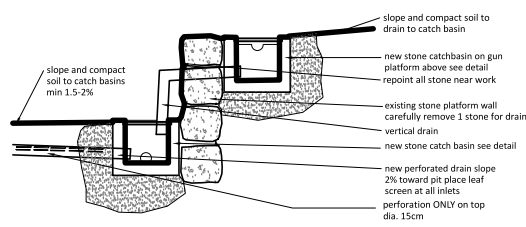

3 catch basin / perforated drain
C02 scale 1:20

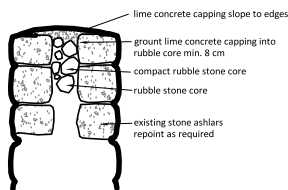

4 crown on all walls
C02 scale 1:25

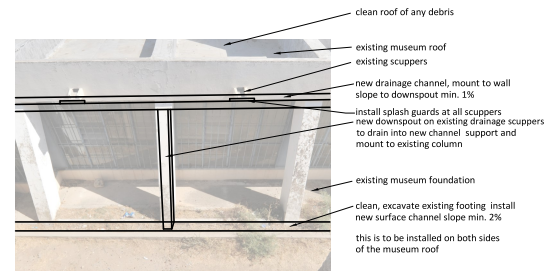

5 new downspout drain museum
C02 scale 1:20

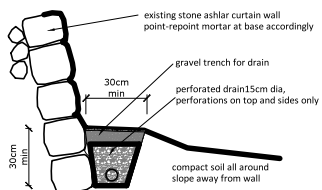

6 base of wall
C02 scale 1:20

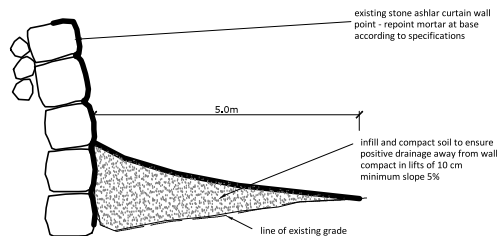

7 base of wall at ditch
C02 scale 1:50

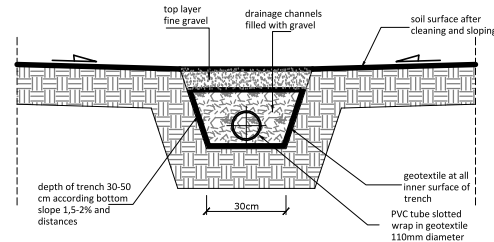

9 typical section of trench
C02 scale 1:10

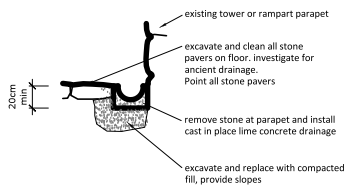

8 tower drain
C02 scale 1:20

SYMBOLS LEGEND

Symbol	Description
	Reference to a detail drawing Upper N°: Number of detail Lower N°: Number of sheet
	Reference to a photo First N°: Number of photo Second N°: Number of sheet
	Keynote, Intervention that corresponds to Specifications and Bill of Quantities
	Height above datum

KEYNOTES - INTERVENTION CODES

- 01 GENERAL
- 1.1.0 Summary of work, scope 4 limits
 - 1.1.4 Access to the site
 - 1.5.0 Temporary facilities, controls, utilities - staging
 - 1.5.5 Vehicular access and parking
 - 1.5.6 Temporary work barriers to protect the trees, trees
 - 1.5.8 Project identification
- 02 SITE CONDITIONS
- 2.2.0 Site inspection
 - 2.2.2A Cutting and removal of concrete or asphalt pavement attached to wall
 - 2.2.2B Removal of concrete skylights
 - 2.2.2C Concrete structure over Museum roof
 - 2.2.2D Removal of site debris
 - 2.2.2E Concrete tank on top of Cavalier's walls
 - 2.2.3 Graffiti removal
 - 2.2.4 Metal fixtures, embedded items, flagpoles, tubes etc. to be removed
 - 2.2.8 Grade adjustment for drainage
 - 2.3.1 Excavation, filling and backfilling for drainage
 - 2.4.2 Site drainage with perforated pipe
 - 2.4.2B Surface drainage with cast in place lime concrete
 - 2.4.2C Drainage of top of walls- earth surfaces
 - 2.4.2D Drainage of top of walls, parapets, embrasures- covered surfaces
 - 2.4.2E Installation of safety fence
 - 2.4.2F Site plants, growth of vegetation removal
 - 2.4.5 Site encroachment
- 03 CRACKS
- 3.4.4 Injection grouting large cracks
- 04 MASONRY
- 4.4.3A Installation of new ashlar stone at base of walls
 - 4.4.3B Installation of new ashlar stone at embrasures, walls and parapets
 - 4.4.3C Part removal from masonry walls
 - 4.4.3A Mortar pointing
 - 4.4.3B Structural consolidation- collapsed retaining wall at northeast gun platform
 - 4.4.3C Structural consolidation- deformed cavalier wall
 - 4.4.3D Structural consolidation- collapsed parapet southern curtain wall
 - 4.4.3E Structural consolidation of south curtain wall
 - 4.4.5 Stone cleaning- general
 - 4.4.6 Repair of stone built platforms 4 floors
- 05 METALS
- 5.1.1 Safety fence
 - 5.1.2 Safety bars
 - 5.1.3 Safety handrails
- 06 WOOD
- 6.1.1 Wooden blocks
 - 6.1.2 Wooden safety bars
- 07 DRAINAGE
- 7.0.5 Drainage system at the bottom of the monument
 - 7.0.6 Drainage system's scuppers and drain pipes
- 08 DOORS & WINDOWS
- 8.1.3 Skylights installation
- 09 ELECTRICAL
- 10.4.0 Electrical cables on masonry
 - 10.5.3 Emergency lighting



Project Designed By: MICHAEL PITTAS, SELEN AVKAN YENIADA, RAND EPPICH
ANASTASIA PITTA, KALYPSO FOTIOU, MUGE SEVKETOGLU,
ARISTODEMOS ANASTASIADES, BYRON CHRISTOU

Project Name: PS-04-2017-97952 (code: C17948)
PROJECT DESIGNS FOR CONSERVATION INTERVENTION OF
Arsenal Bastion
Famagusta, Cyprus Conservation and Structural

Date: December 20, 2017 Scale: In drawing

Drawing name: DRAINAGE DETAILS Drawing no. C14

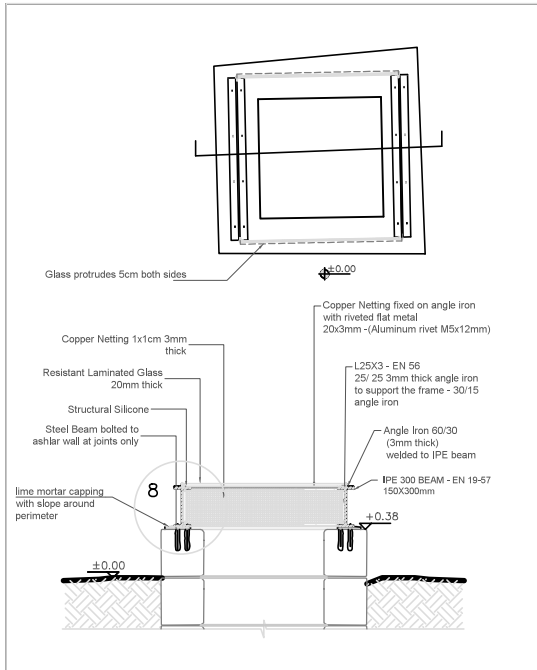

1 SKYLIGHT 1, PLAN & SECTION
Scale 1:20

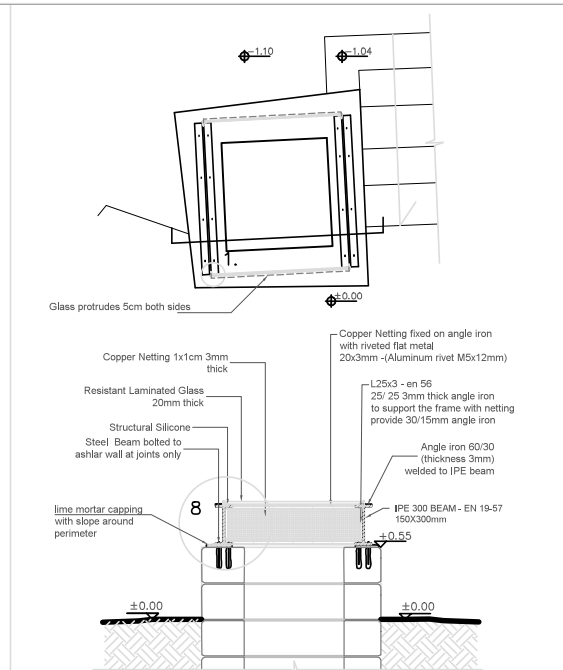

2 SKYLIGHT 2, PLAN & SECTION
Scale 1:20

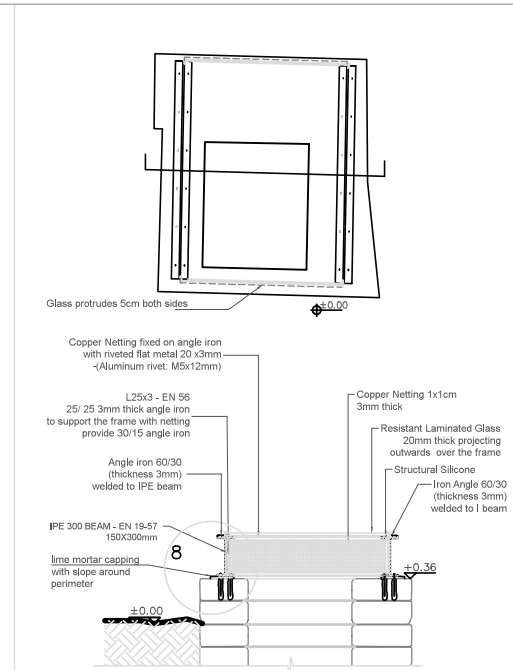

3 SKYLIGHT 3, PLAN & SECTION
Scale 1:20

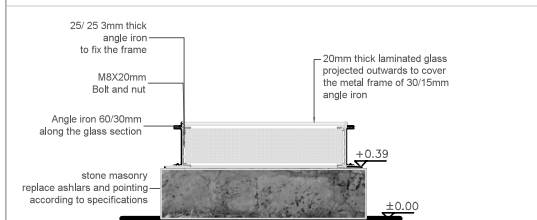

4 FRONT VIEW SKYLIGHT 1, (South East)
Scale 1:20

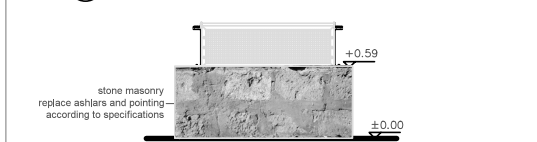

5 FRONT VIEW SKYLIGHT 2, (South East)
Scale 1:20



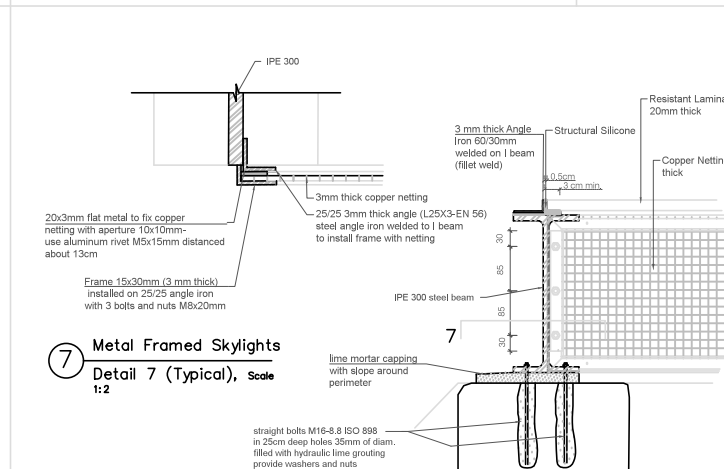

6 FRONT VIEW SKYLIGHT 3, (North West)
Scale 1:20

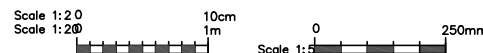

7 Metal Framed Skylights
Detail 7 (Typical), Scale 1:2

8 Metal Framed Skylights
Detail 8 (Typical), Scale 1:5



 	
United Nations Development Program Program funded by EUROPEAN UNION	
Project Designed By: MICHAEL PITTAS, SELEN AVKAN YENIADA, RAND EPPICH ANASTASIA PITTA, KALYPSO FOTIOU, MUGE SEVKETOGLOU, ARISTODEMOS ANASTASIADES, BYRON CHRISTOU	
Project Name: PS-04-2017-97952 (code: C17948) PROJECT DESIGNS FOR CONSERVATION INTERVENTION OF Arsenal Bastion Famagusta, Cyprus Conservation and Structural	
Date	December 20, 2017
Scale	In drawing
Drawing name:	Drawing no.:
DETAILS OF SKYLIGHTS	
C16	

Canbulat/Arsenal Bastion, Famagusta, Cyprus

General Conditions

The Walls of Famagusta are an important monument in the history of Cyprus and the Eastern Mediterranean Region. The monument has local as well as international stakeholders and evokes a sense of greater values given its monumental scale and symbol of the city and island.

The United Nations Development Programme (hereinafter referred to as "UNDP"), awarded The Design Team * M. Pittas, S. Avkan, R. Eppich, A. Pitta, M. Sevketoğlu, K. Fotiou, B. Christou, A. Anastasiades* a multidisciplinary team consisting of Architects, Structural Engineers, Archaeologists, Conservators, Quantity Surveyors and Land Surveyors, in September 2017, the contract reference Ref.: PS-04-2017-97952 - Project Design for the Conservation Intervention of the Canbulat (Arsenal) Bastion in Famagusta.

Conservation Philosophy - Intervention Principles

The Conservation Philosophy and Intervention Principles are written to ensure a professional, international standard for conservation. They will guide all work to conserve the aesthetics, values, historic importance of the monument. They have been drafted to align with international standards of conservation.

RESPECT FOR VALUES - Touch the monument as lightly as possible to preserve the original fabric, authenticity and values.
The proper texture, colour and appearance of the walls, stones and mortar will be respected.
Any new mortar that is applied where a significant amount of old mortar survives will be integrated in texture and appearance and colour.
Mortar will be applied smooth and depressed.
Missing stone will not be replaced unless structurally necessary. New walls will not be created.

MINIMAL INTERVENTION - Only undertake repairs where absolutely necessary structurally, for both short and long term stability and for visitor safety.
Key structural stones require replacement.
These must be identified and the causes of deterioration must be studied and understood and addressed.
Replace stones that have fallen out of place if identifiable.
Maintain reversibility in any intervention when possible.

COMPATIBLE MATERIALS - only compatible materials will be used - the proper colour and materials, proper mortar, stone from an appropriate quarry. The stone used will be indigenous to the area.
Any new materials must match in properties and colours.
Re-point mortar with an appropriate and compatible mortar. The mortar will be of the correct composition appearance and set deeply not prominently and be of the correct colour.
Traditional techniques will be used where when possible.

TESTING - Test all original materials to thoroughly understand their properties and attributes in order to understand what kind of new materials should be used. Test all new materials and any proposed treatments.

DISCERNIBLE INTERVENTION - all interventions will be discernible from the original materials. This will be marked and documented in a subtle manner. These markings will not be obtrusive.

INTERNATIONAL STANDARDS - all work will conform to all international conservation practices and charters.

MAINTAIN USE - monuments that are used and known are protected. Therefore the monument will be promoted for use as a visitor destination, local monument and national monument.
Control visitation and access to the site.
Create barriers to upper structure except in one portion.
Stabilize existing concrete stair.
Inform the public about the project and dangers in certain areas.
Repair or replace the stage for continued use as a performance space.
Upgrade facilities including handicapped access and signage.

SUSTAINABILITY - Prepare for longer term conservation work including manual for maintenance, list of priority items, protection of fragile area, etc., or
Control the water on and around the monument and site, improve drainage.
Remove harmful vegetation on the walls, roof and site particularly around drain spouts.
Design a sacrificial layer of mortar at the tops of walls and junctions to prevent water from entering the wall core. This will be shaped in a dome to shed water.
Prevent mechanical damage on the port side.
Maintenance plan. Write a maintenance and visitation plan.

KNOWLEDGE - Create records and documentation that can be easily followed and serve as a record of all works. This includes locating historic documents and the creation of a bibliography.
All work will be communicated and shared with all stakeholders.

SPECIFIC CONDITIONS

ARCHAEOLOGICAL SITE
The CANBULAT/ARSENAL is an archaeological site therefore the utmost care must be taken in working at the site. There are or may be found decorative building elements, stone or iron cannon balls, iron cannon and other such elements on site. These must be collected before any works on the site begin as per the instructions of the UNDP PFF - Supervisors.

CAUTION: IF ANY DECORATIVE ELEMENTS ARE FOUND DURING THE WORKS UNDER THE SURFACE THE WORK IN THE IMMEDIATE VICINITY MUST BE IMMEDIATELY HALTED AND THE CONSERVATION SUPERVISOR AND UNDP PFF OFFICES NOTIFIED IMMEDIATELY.
Any element(s) discovered must be protected and if possible left in place for the removal by an authorized archaeologist.

The opinions expressed are purely those of the Design Team and shall not in any circumstances be regarded as stating an official position of the United Nations Development Program and the European Commission

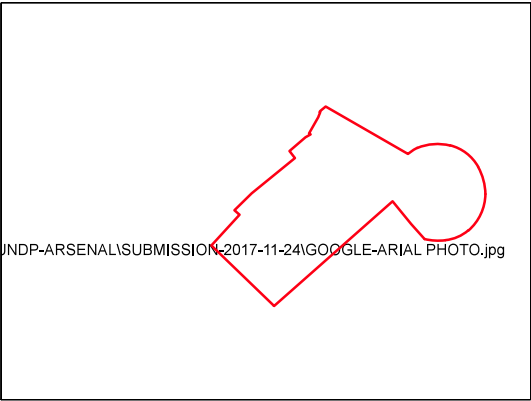
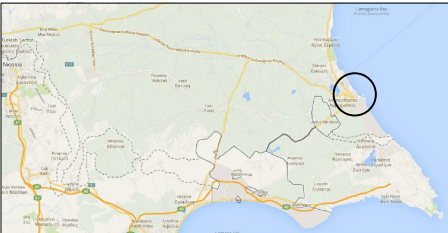

1 Vicinity Map & Areal Photo
NTS

2 Area Plan
scale 1:1000

Design Team

Michael Pittas Project coordinator Civil Engineer, Cyprus	Rand Eppich Conservation Architect Spain	Selen Avkan Yeniada Conservation Architect Cyprus
Anastasia Pitta Conservation Architect Cyprus	Muge Sevketoğlu Archaeologist Cyprus	Kalyso Fotiou Conservator Greece
Byron Christou Quantity Surveyor Cyprus	Aristodemos Anastasiades Land Surveyor - Geomaging, Cyprus	

DRAWING CATALOGUE

DWG No	TITLE
G01	GENERAL CONDITIONS, SYMBOLS DRAWING CATALOGUE
G02	SCOPE AND METHODOLOGY, REFERENCE PLAN INTERVENTIONS SCHEDULE
T01	ROOF PLAN (Land Surv.)
C01	ROOF PLAN - SITE INTERVENTIONS PLAN
C02	DRAINAGE PLAN
C03	HAND/GUARD RAIL & SKYLIGHT PLAN
C04	SECTIONS 1, 2, 3 - INTERVENTIONS
C05	SECTIONS 4, 5, 6, 7 - INTERVENTIONS
C06	ELEVATIONS 1/6, MUSEUM & CAVALIER NORTH & WEST, INTERVENTIONS
C07	ELEVATIONS 2/6, CAVALIER NORTH, RAMPART SOUTH, INTERVENTIONS
C08	ELEVATIONS 3/6, TOWER'S EAST & SOUTHEAST INTERVENTIONS
C09	ELEVATIONS 4/6, TOWER'S SOUTH & SOUTHWEST INTERVENTIONS
C10	ELEVATIONS 5/6 SOUTH CURTAIN WALL & TOWER WEST INTERVENTIONS
C11	ELEVATIONS 6/6, MUSEUM & CAVALIER - EAST & WEST INTERVENTIONS
C12	ROOF PLAN PHOTOGRAPHIC DOCUMENTATION
C13	HAND/GUARD RAIL, SKYLIGHTS & DRAINAGE DETAILS
C14	DRAINAGE DETAILS
C15	DETAIL PLAN FOR REBUILDING NORTHEAST WALLS & PLATFORM
C16	DETAILS OF SKYLIGHTS

SYMBOLS LEGEND

Symbol	Description
	Reference to a detail drawing Upper N°: Number of detail Lower N°: Number of sheet
	Reference to a photo First N°: Number of photo Second N°: Number of sheet
	Keynote. Intervention that corresponds to Specifications and Bill of Quantities
	Height above datum

The opinions expressed are purely those of the design team and shall not in any circumstances be regarded as stating an official position of the United Nations Development Programme or the European Commission.		
		United Nations Development Program
		Program funded by EUROPEAN UNION

Project Designed By: MICHAEL PITTAS, SELEN AVKAN YENIADA, RAND EPPICH
ANASTASIA PITTA, KALYPSO FOTIOU, MUGE SEVKETOĞLU,
ARISTODEMOS ANASTASIADES, BYRON CHRISTOU

Project Name: PS-04-2017-97952 (code: C17948)
PROJECT DESIGNS FOR CONSERVATION INTERVENTION OF
Arsenal Bastion
Famagusta, Cyprus *Conservation and Structural*

Date	December 20, 2017	Scale	In drawing
------	-------------------	-------	------------

Drawing name:	GENERAL CONDITIONS SYMBOLS, DWG CATALOGUE	Drawing no.:	G01
---------------	--	--------------	-----

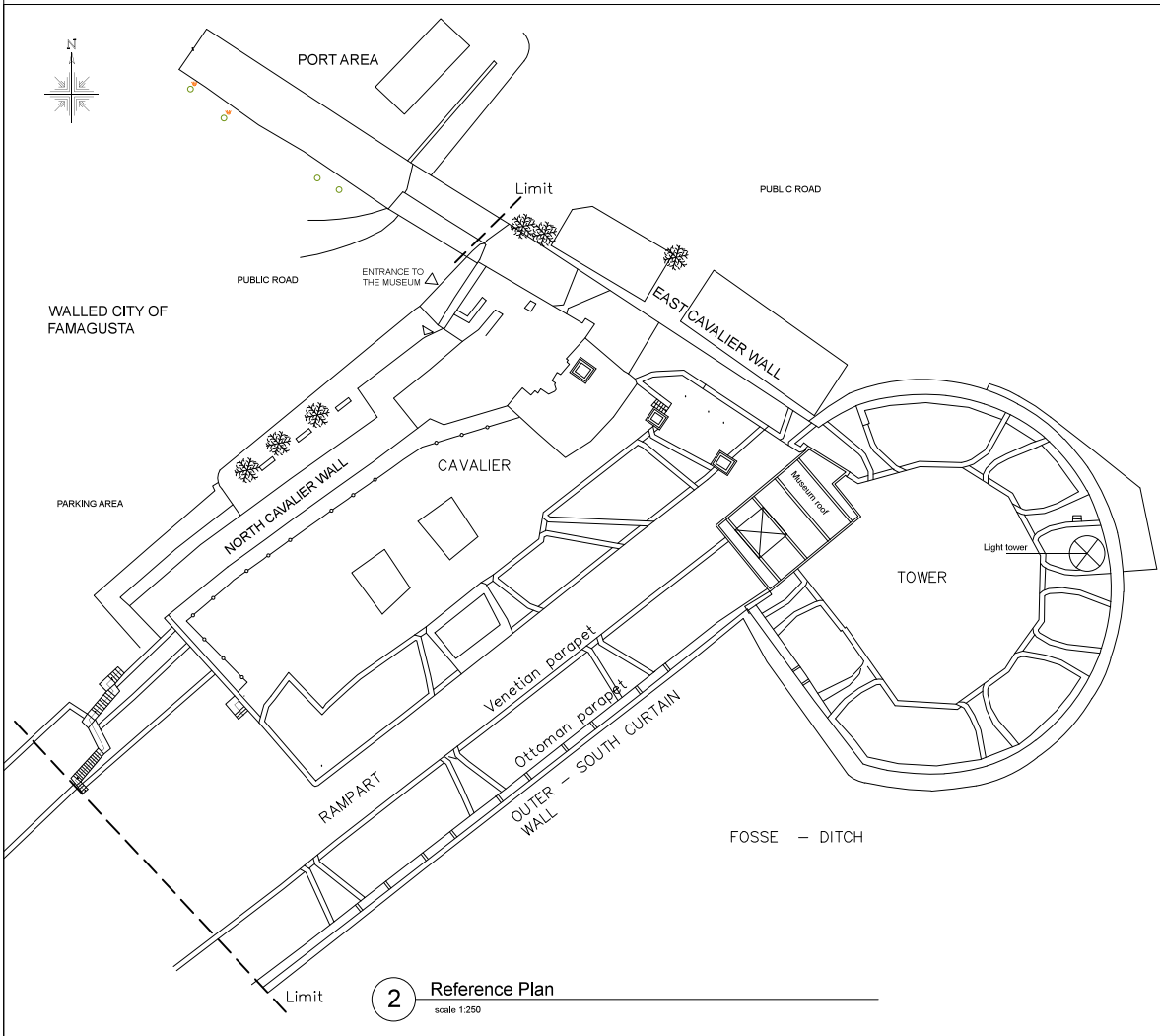

Methodology - CSI coding system

This project utilizes the CSI Construction Specification Institute's numbering. It is divided into 16 DIVISIONS for the various trades involved and necessary for the conservation works. It is sequential; however, NOT all numbers are used as it is a modular. This allows sections to be inserted (or removed) at various times without changing the sequence of numbers. It also allows standardization within and across the projects. The numbers used in the Keynotes in this drawings are the same numbers used in the Technical Specifications as well as the Bill of Quantities. The Divisions are listed below to assist the contracted party. These divisions also generally align with a project schedule beginning with General and Site Conditions and include Masonry or Visitor Control & facilities.

ANY QUESTIONS MUST BE SUBMITTED IN WRITING TO THE ENGINEER ABOUT THIS SYSTEM.

As mentioned, there are three "angles" from which to describe the required interventions of the Walls : specifications, drawings and the Bill of Quantities. This serves to tie together the different documents necessary for this description as well as the intervention portion of the project.

Division 01 — General Requirements
Division 02 — Site Construction
Division 03 — Grouting
Division 04 — Masonry
Division 05 — Metals
Division 06 — Wood
Division 07 — Thermal and Moisture Protection / Roof
Division 08 — Doors and Windows
Division 09 — Finishes
Division 10 — Specialties
Division 11 — Equipment
Division 12 — Furnishings
Division 13 — Special Construction
Division 14 — Scaffolding
Division 15 — Mechanical
Division 16 — Electrical

Project Scope

The physical limitations of the scope are as follows. It includes the Canbulat / Arsenal Bastion, which consists of the Tower, the Cavalier and a small portion of the rampart up to and including the stairs that start from the parking area at the north - northwest and end on top of the walls. It includes the roof of the abovementioned area and its walls facing the parking area, the public road and the Fosse. The scope doesn't include the museum, which includes its interior spaces, its concrete roof and its entrance. However the skylights on top of the Museum and on the Cavalier's roof are included. The scope doesn't include the light tower on top of the Bastion's Tower.

As it is a complex structure, which consists of the following main structures:

- The Tower:**
This is the approximately round structure at the southeast side of the scope's area. The access to this area is blocked by the Museum's concrete roof, but still visitors access the area consequently the scope includes safety measures for visitors. Works in this part deal with the rain water drainage, masonry works and works for the floor.
- The Rampart:**
This area is between the Tower and the Cavalier. It includes the "road" way from the cemetery on top of walls to the east end, the Venetian parapet with its embrasures and the Ottoman parapet. Access to this area is both for pedestrians and vehicles since there are the steps coming up from the north parking area and the earth ramp further to the west. The scope ends to the steps as shown on drawings.
Scope includes masonry works for the Venetian and Ottoman parapets and for the Cavalier's walls facing the Rampart. It includes also drainage of rain water and safety measures for the visitors.
- Cavalier:**
the Cavalier is the high level area on top of the Bastion and the Museum. It includes the roof with the earth and stone pavements and the walls of the embrasures.
Scope includes rebuilding the collapsed and deformed walls, masonry works on walls, drainage for the rain water and safety measures for visitors.
- Curtain Walls:**
Curtain Walls are:
 - The wall of Cavalier and Rampart facing to the north - northwest over the parking and public road
 - The wall of Cavalier and Tower facing to the east - northeast over the public road
 - the wall of the Tower and Rampart facing to the south - southeast over the FosseScope includes masonry woks, grouting cracks and works related to drainage.

All of the abovementioned works are indicated on the drawings and details and are outlined in the Specifications and Bill of Quantities.

SYMBOLS LEGEND

Symbol	Description
	Reference to a detail drawing Upper N°: Number of detail Lower N°: Number of sheet
	Reference to a photo First N°: Number of photo Second N°: Number of sheet
	Keypoint. Intervention that corresponds to Specifications and Bill of Quantities
	Height above datum

"The opinions expressed are purely those of the design team and shall not in any circumstances be regarded as stating an official position of the United Nations Development Programme or the European Commission."		
Program funded by EUROPEAN UNION		

Project Designed By	MICHAEL PITTAS, SELEN AVKAN YENIADA, RAND EPPICH ANASTASIA PITTA, KALYPSO FOTIOU, MUGE SEVKETOGLU, ARISTODEMOS ANASTASIADES, BYRON CHRISTOU
---------------------	---

Project Name	PS-04-2017-97952 (code: C17948) PROJECT DESIGNS FOR CONSERVATION INTERVENTION OF Arsenal Bastion Famagusta, Cyprus <i>Conservation and Structural</i>
--------------	--

Date	December 20, 2017	Scale	In drawing
------	-------------------	-------	------------

Drawing name:	SCOPE AND METHODOLOGY REFERENCE PLAN INTERVENTIONS SCHEDULE	Drawing no.:	G02
---------------	--	--------------	------------

Interventions Schedule (This is a summary of the intervention works that are included in the scope of this works. For detail description and specifications refer to the Drawings, Details, Specifications and Annexes)

EXTERIOR	FLOOR	WALLS, PARAPETS & FEATURES
Tower's roof	Clean rubbish and vegetation, apply herbicide. Excavate and form the open drain with lime concrete around the perimeter. Use the outlet at the west side and provide pipe through the embrasure, scupper, down pipe, catch basin and pipe to connect to evaporation pit. Clean the joints of the stone pavement and fill them with lime mortar, leading the water to the perimeter's open drain. Provide emergency lights and information panel for visitors.	Clean from vegetation and apply herbicide. New ashlars where needed as per Photo Annex. Pointing and/or re-pointing where necessary to all walls and parapets. Provide safety bars in front of embrasures. Clean top of Walls from vegetation and provide lime concrete or patch with lime mortar as per specifications and repair the water outlets on parapets. Remove metal fixtures and wooden safety bars.
Rampart roof	Clean rubbish and vegetation, apply herbicide. Grade adjustment to drain. Excavate and form the open drain along the Venetian parapet and the covered drain trenches and catch basins at the west side. Provide drain pipe to take the water to parking area. Provide safety fences. Provide emergency lights and information panel for visitors. Provide temporary fencing and staging as is required.	Clean from vegetation and apply herbicide. New ashlars where needed as per Photo Annex. Pointing, re-pointing where necessary. Provide safety bars in front of embrasures. Clean graffiti. Clean top of Walls from vegetation and provide lime concrete or patch with lime mortar as per specification and repair the water outlets on parapets. Rebuild the collapsed part for the Ottoman Parapet. Remove metal fixtures. Provide metal fencing at the corner with Museum's roof.
Cavalier roof	Clean rubbish and vegetation, apply herbicide. Grade adjustment to drain. Excavate and form the drainage trench and catch basin at the west side. Rebuild the collapsed walls and skylight at the northeast area. Rebuild missing parts of the east platform. Clean the joints of all stone platforms and fill with mortar to drain the water. Provide safety fences. Provide emergency lights and information panel for visitors.	Clean from vegetation and apply herbicide. Clean graffiti. New ashlars where needed as per Annex. Pointing, re-pointing where necessary. Dismantle and rebuild deformed walls at the southwest side. Provide safety bars in front of embrasures and west steps. Clean top of Walls from vegetation, demolish concrete tank, excavate and fill. Provide lime concrete as per specifications onto of walls. Remove metal fixtures from faces and top of walls.
Curtain and Tower Walls facing northwest, north,northeast & east.	Clean rubbish and vegetation close to the walls and apply herbicide. Excavate and form the covered trenches and catch basins along the northwest, north, northeast and east perimeter of Walls, from the Parking area to the Fosse and connect to the evaporation/percolation pits at both sides. Provide temporary site fencing and staging. Provide project identification.	Clean from vegetation and apply herbicide. Clean graffiti. Clean stones from staining, white washes and fungus, apply herbicide/biocide where necessary. Build new ashlars where needed as per Photo Annex. Pointing, re-pointing where necessary. Grouting injections of cracks. Provide safety handrails at steps going on top. Remove metal fixtures. Protect existing electrical installations.
Curtain and Tower Walls facing south, southwest & southeast	Clean rubbish and vegetation, close to the walls and apply herbicide. Grade adjustment to take the water away from walls. Provide temporary fencing and scaffolding as required. Provide project identification.	Clean from vegetation and apply herbicide. Clean graffiti. Clean stones from staining and fungus, apply herbicide/biocide where necessary. Build new ashlars and rubble built into courses where needed as per Photo Annex. Pointing, re-pointing where necessary. Grouting injections of cracks. Remove metal fixtures.

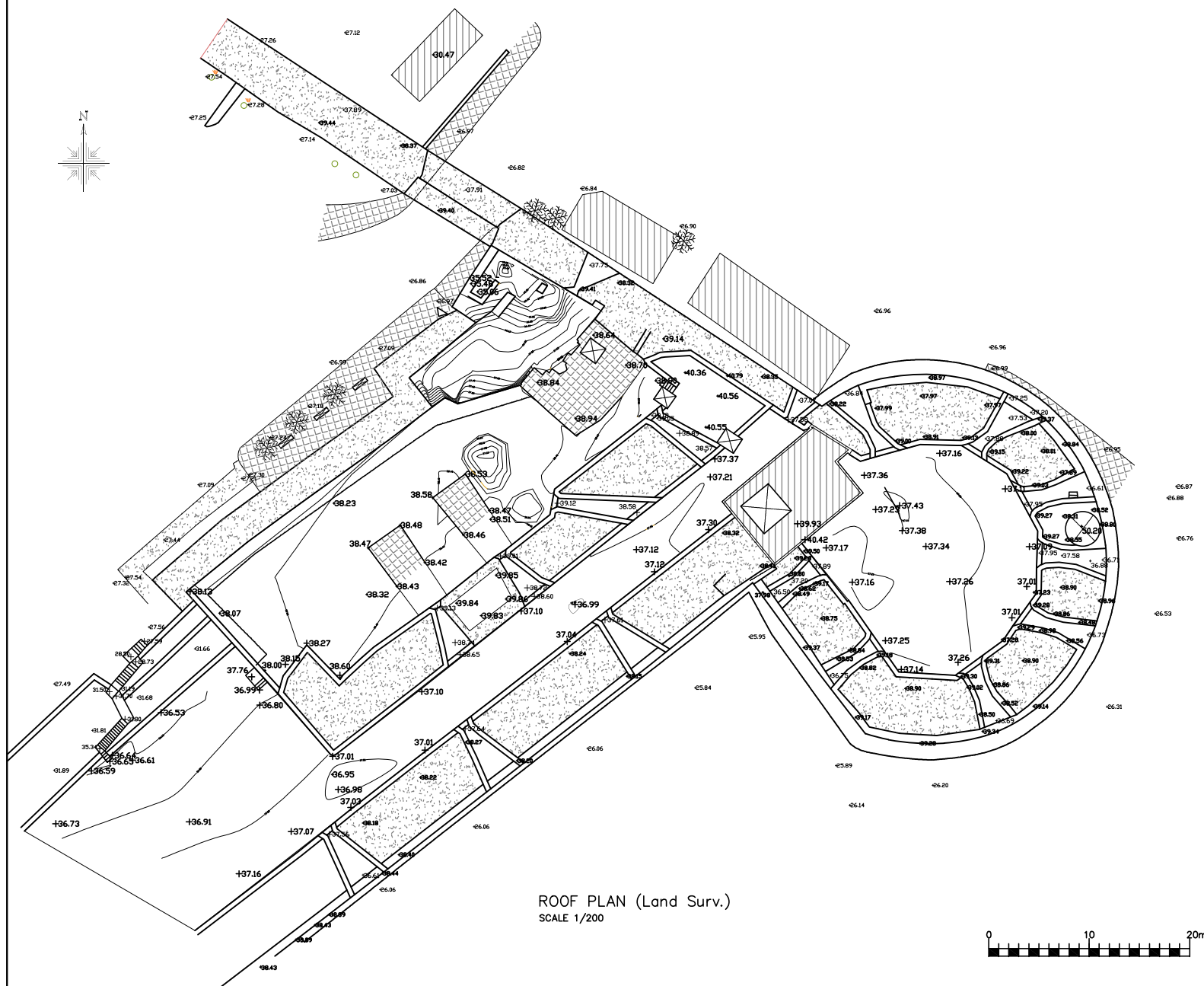

ROOF PLAN (Land Surv.)
SCALE 1/200



LEGEND

- Wall
- Gate
- Stair
- Fence
- ▨ Building
- ▨ Concrete
- ▨ Bench
- ☼ Tree
- 0.00 Ground Elevation
- 0.00 Main Wall Elevation
- 0.00 Arrow Loop Elevation
- 0.00 Roof Elevation
- ☼ Ground Lamp
- Railings
- Tank
- ▨ Pavement



Project Designed By: MICHAEL PITTAS, SELEN AVKAN YENIADA, RAND EPPICH
ANASTASIA PITTA, KALYPSO FOTIOU, MUJES SEVKETOGLU,
ARISTODEMOS ANASTASIADES, BYRON CHRISTOU

Project Name: PS-04-2017-97952 (code: C17948)
PROJECT DESIGNS FOR CONSERVATION INTERVENTION OF
Arsenal Bastion
Famagusta, Cyprus *Conservation and Structural*

Date: December 20, 2017 Scale: In drawing

Drawing name: ROOF PLAN (Land. Surv.) Drawing no.: T01