

TECHNICAL SPECIFICATION FOR  
*"FURNITURE IN THE  
MULTIFUNCTIONAL CENTER FOR  
CHILDREN WITH DISABILITIES"*

*URA VAJGURORE*

## Desk nr.1

**Dimensions :** 1800 × 950 × 720mm

pieces: 4

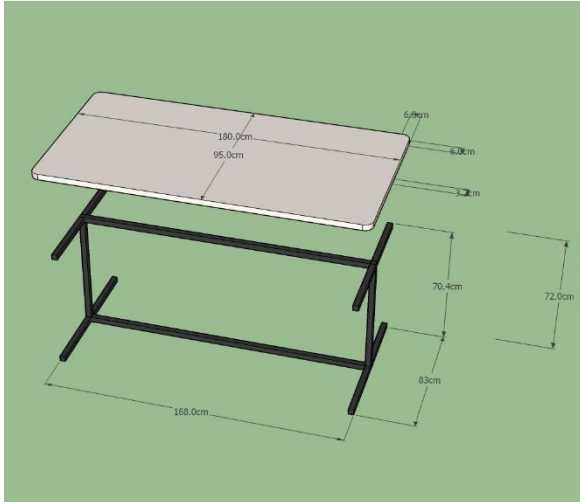

The desk is composed by:

- a) rectangle top
- b) Metallic skeleton

The top will be in laminated MDF with 32 mm width. The skeleton will be in metallic elements 30x30 mm. The perimeter of the top will be chamfered.

The connection of elements will be done with invisible accessories. The desk contact with the floor will be done with plastic tapes to avoid damages from humidity and strokes.

The color will be laminate cream. The skeleton will be in grey color. The colors and accessories will be chosen by the client authority person.

Manufacturing, Supply and Installation.

## Desk nr.2

**Dimensions :** 1200 × 550 × 720mm

pieces: 15

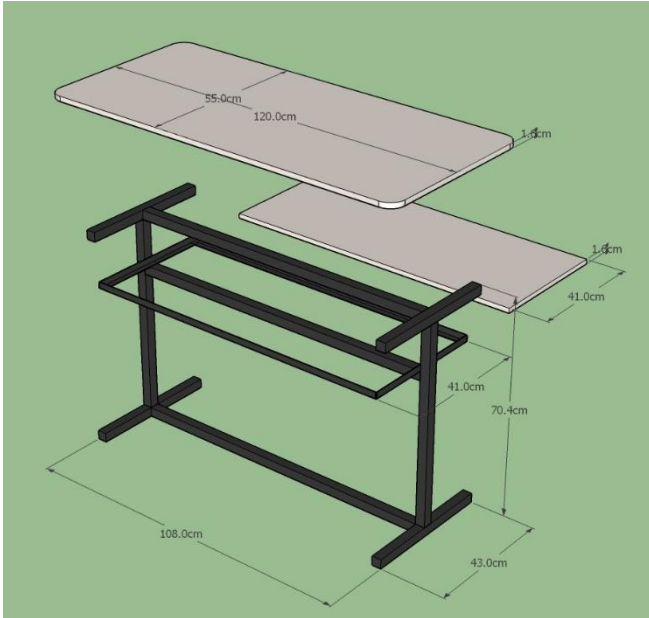

The desk is composed by:

- a) rectangle top
- b) Metallic skeleton
- c) Split rack

The top will be in laminated MDF with 32 mm width. In a distance of 150mm it will be placed a split rack. The skeleton will be in metallic elements 30x30 mm. The perimeter of the top will be chamfered.

The connection of elements will be done with welding and screws. The desk contact with the floor will be done with plastic tapes to avoid damages from humidity and strokes.

The color will be laminate cream. The skeleton will be in grey color. The colors and accessories will be chosen by the client authority person.

Manufacturing, Supply and Installation.

### Desk nr.3

**Dimensions :** 700 × 550 × 720mm

pieces: 2

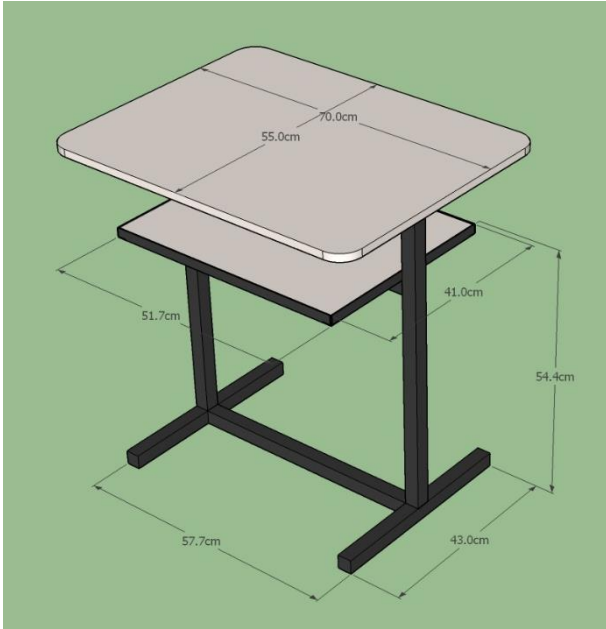

The desk is composed by:

- a) rectangle top
- b) Metallic skeleton
- c) Split rack

The top will be in laminated MDF with 32 mm width. In a distance of 150mm it will be placed a split rack. The skeleton will be in metallic elements 30x30 mm. The perimeter of the top will be chamfered.

The connection of elements will be done with welding and screws. The desk contact with the floor will be done with plastic tapes to avoid damages from humidity and strokes.

The color will be laminate cream. The skeleton will be in grey color. The colors and accessories will be chosen by the client authority person.

Manufacturing, Supply and Installation.

## Desk nr.4

**Dimensions :** 700 × 550 × 720mm

pieces: 7

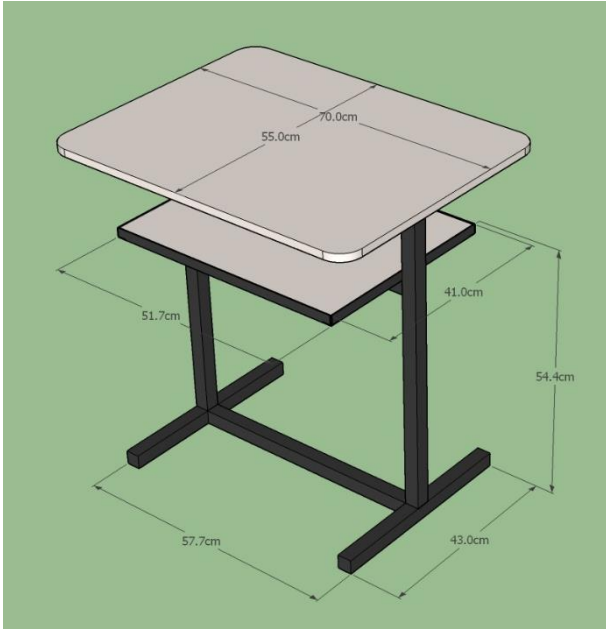

The desk is composed by:

- a) rectangle top
- b) Metallic skeleton
- c) Split rack

The top will be in laminated MDF with 32 mm width. In a distance of 150mm it will be placed a split rack. The skeleton will be in metallic elements 30x30 mm. The perimeter of the top will be chamfered.

The connection of elements will be done with welding and screws. The desk contact with the floor will be done with plastic tapes to avoid damages from humidity and strokes.

The color will be laminate cream. The skeleton will be in grey color. The colors and accessories will be chosen by the client authority person.

Manufacturing, Supply and Installation.

### Desk nr.5

**Dimensions :** 1200 × 800 × 720mm

pieces: 4

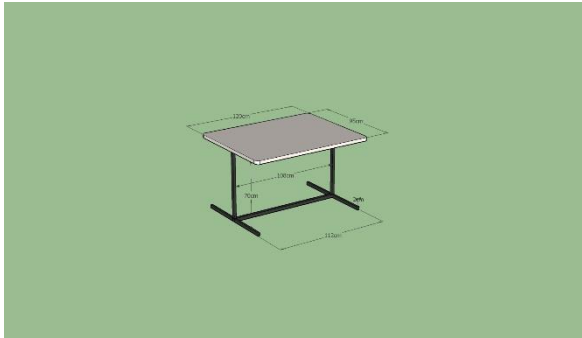

The desk is composed by:

- a) rectangle top
- b) Metallic skeleton

The top will be in laminated MDF with 32 mm width. The skeleton will be in metallic elements 30x30 mm. The perimeter of the top will be chamfered.

The connection of elements will be done with invisible accessories. The desk contact with the floor will be done with plastic tapes to avoid damages from humidity and strokes.

The color will be laminate cream. The skeleton will be in grey color. The colors and accessories will be chosen by the client authority person.

Manufacturing, Supply and Installation.

## Bed nr.6

**Dimensions :** 2000 mm × 1000 mm × 850 mm

pieces: 6

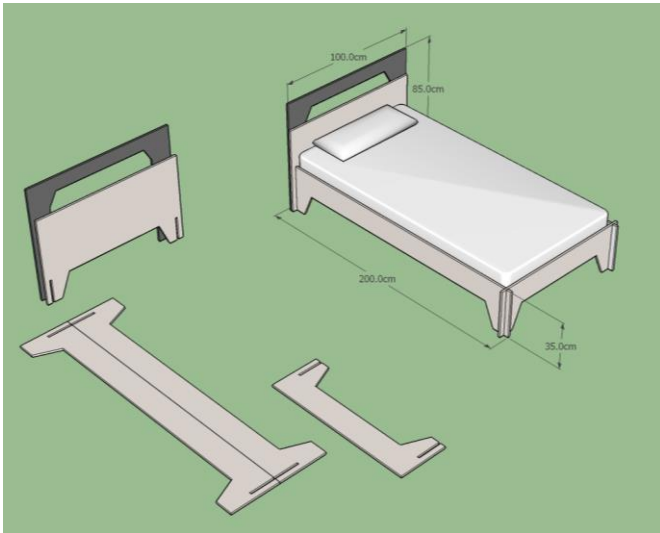

Bed consisting of:

- a) heads
- b) bottom
- c) sides
- d) base
- e) stairs

Bed is made of wooden material.

Bed specifications are given as follows.

. Union of elements such as bed side, heads and skirts made with soldering tip knitting for more security and well placed reinforcement metal or plastic angles. The contact of the bed with floor is made with plastic stoppers and upholstered furniture in case of relocation.

The color of of elements is cream will be shiny and additional element to the head of the bed will record it with gray.

Before you start production colors and accessories will be determined by the responsible person designated by investor. Output, Supply and Installation.

## Bedside nr.7

**Dimensions :** 450 mm × 450 mm × 466 mm

pieces: 8

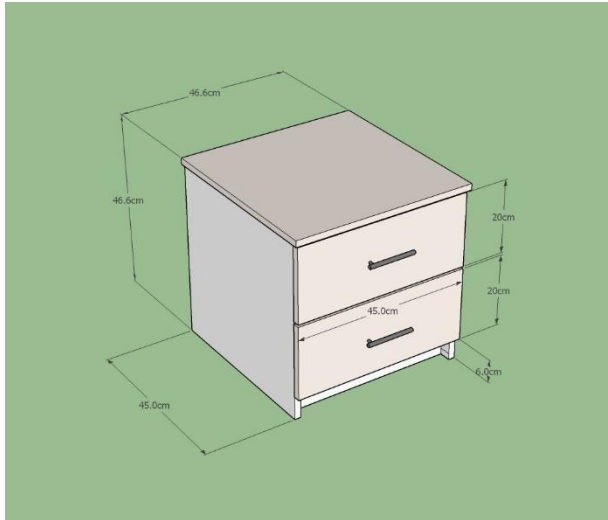

Bedside is composed of:

- a) 1 box
- c) 2 Drawer

This type of bedside is suitable for the post of environment where it is placed and its dimensions and forms did not adhere to predetermined standards and norms. Specifications are as follows:

Caps and drawer cupboard is with acrylic material. The internal structure of the material is melamine cupboard and will have the same color with the lid. Union of elements made with plastic or metal angles and screws. The structure carrying the cupboard is based on plastic corks for not damage the floor and upholstered furniture in case of relocation.

The color of the drawer will be shiny cream, the other parts will be colored with caps approximate. Before you start production colors and accessories will be determined by the responsible person designated by the investor.

Manufacturing, Supply and Installation.



### Shelf nr. 08

**Dimensions :** Bottom part.- 9400× 400 ×516 mm  
Upper part. - 9400× 300 ×1582 mm

pieces: 1

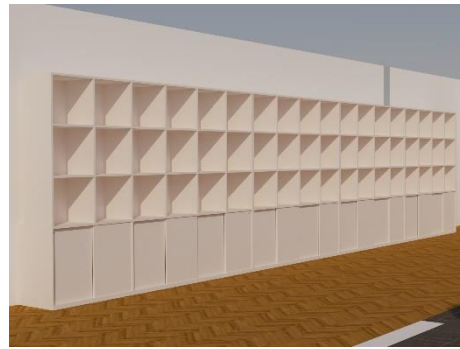
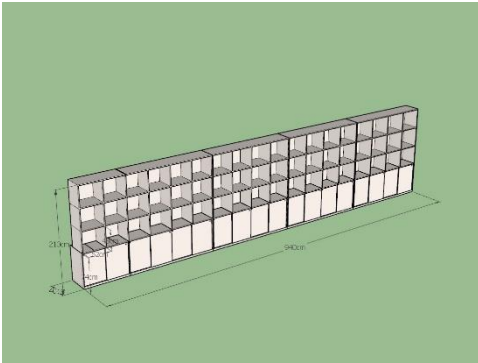

The shelf is composed by these elements:

-Bottom part:

- a) One box with upper and bottom and internal divisions
- b) 18 shutters with dimensions 520 mm

-Upper part:

- c) 1 shelter without shutters hanged on bottom part and on vertical wall

The shelf is designed in laminated M.D.F. in 16 mm width. The back is composed by 4mm width fiber with the same color as the shelf.

The connection of elements will be done with “L” profiles. The mounting of shutters will be done in sliding rails. The contact of shelf with the floor will be done with plastic tapes in order to protect the shelf from the humidity and damages.

The hangs will be hole type.

The color will be laminate cream. The colors will be chosen by the client authority person.

Manufacturing, Supply and Installation.

## Kitchen nr.9

**Dimensions** : 2720 mm × 600 mm × 2180mm

pieces: 1



Kitchen is composed of:

- a) The lower part
- b) The top

Kitchen consisting of the lower and upper part, where their specifications are given as follows.

Covers and drawers are from acrylic material, where their borders are covered with P.V.C. The internal structure of the kitchen is melamine material and shall have the same color with the lidcovers. Union of elements is made with plastic or metal angles and screws. The structure carrying the lower part of the cuisine is based on 100 mm plastic legs and covered in the front. The structure of the upper part will be fixed in the walls. The other element is the kitchen bench with 40 mm thickness will be dark, to approximate the color of the tiles and make a rupture contrasts with the color of the covers.

The color of the drawer and covers will be shiny cream, the other parts will be colored as the covers. Before you start production colors and accessories will be determined by the responsible person designated by the investor.

Manufacturing, Supply and Installation.

### Shelf nr. 10

**Dimensions :** Bottom part.- 3600× 300 ×516 mm  
Upper part. - 3600× 300 ×1582 mm

pieces: 1

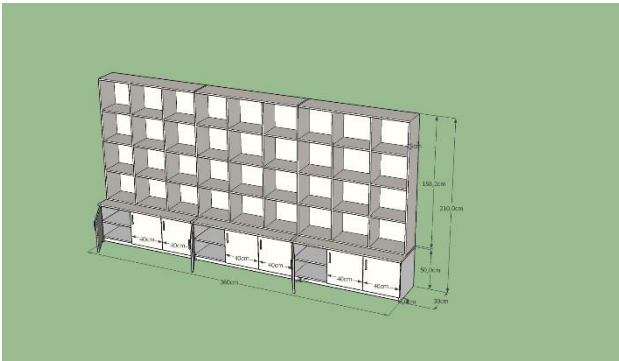

The shelf is composed by these elements:

-Bottom part:

- a) One box with upper and bottom and internal divisions
- b) 9 shutters with dimensions 400 mm

-Upper part:

- c) 1 shelter without shutters hanged on bottom part and on vertical wall

The shelf is designed in laminated M.D.F. in 16 mm width. The back is composed by 4mm width fiber with the same color as the shelf.

The connection of elements will be done with “L” profiles. The mounting of shutters will be done in sliding rails. The contact of shelf with the floor will be done with plastic tapes in order to protect the shelf from the humidity and damages.

The hangs will be hole type.

The color will be laminate cream. The colors will be chosen by the client authority person.

Manufacturing, Supply and Installation.

## Wardrobe nr.11

**Dimensions :** 1000 mm × 600 mm × 1800 mm

pieces: 1

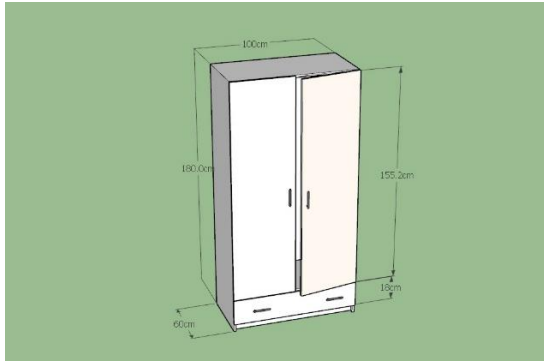

Wardrobe is composed of:

- a) 1 box
- b) 2 covers
- c) 1 Drawer

Closet type of hanger closet, a shelf and a drawer switch. This type of closet is suitable for the post of environment where it is placed and its dimensions and forms did not adhere to predetermined standards and norms. Specifications are as follows: Caps and drawer cupboard is with acrylic material. The internal structure of the material is melamine cupboard and will have the same color with the lid. Union of elements made with plastic or metal angles and screws. The structure carrying the cupboard is based on plastic corks for not damage the floor and upholstered furniture in case of relocation.

The color of the drawer cap will be shiny cream, the other parts will be colored with caps approximate. Before you start production colors and accessories will be determined by the responsible person designated by the investor.

Manufacturing, Supply and Installation.

## Wardrobe nr.12

**Dimensions :** 600 mm × 600 mm × 800 mm

pieces: 2

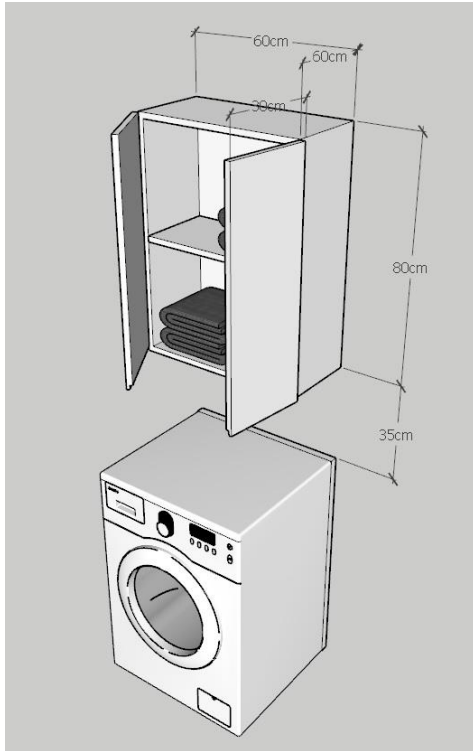

Wardrobe is composed of:

- a) 2 box
- b) 4 covers

Closet type of hanger closet, a shelf and a drawer switch. This type of closet is suitable for the post of environment where it is placed and its dimensions and forms did not adhere to predetermined standards and norms. Specifications are as follows: Caps and drawer cupboard is with acrylic material. The internal structure of the material is melamine cupboard and will have the same color with the lid. Union of elements made with plastic or metal angles and screws. The structure carrying the cupboard is based on plastic corks for not damage the floor and upholstered furniture in case of relocation.

The color of the drawer cap will be shiny cream, the other parts will be colored with caps approximate. Before you start production colors and accessories will be determined by the responsible person designated by the investor.

Manufacturing, Supply and Installation.

### Kitchen nr.13

**Dimensions :** 2720 mm × 600 mm × 2180 mm

pieces: 1

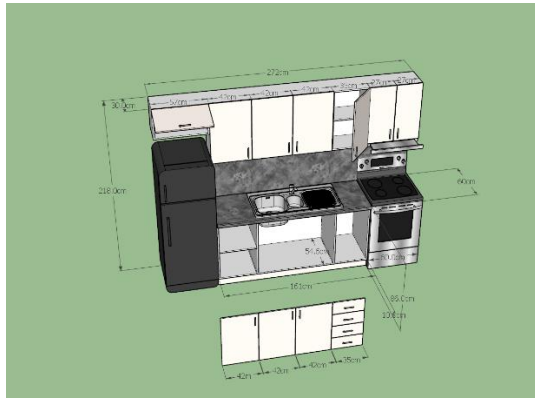

Kitchen is composed of:

- a) The lower part
- b) The top

Kitchen consisting of the lower and upper part, where their specifications are given as follows.

Covers and drawers are from acrylic material, where their borders are covered with P.V.C. The internal structure of the kitchen is melamine material and shall have the same color with the lidcovers. Union of elements is made with plastic or metal angles and screws. The structure carrying the lower part of the cuisine is based on 100 mm plastic legs and covered in the front. The structure of the upper part will be fixed in the walls. The other element is the kitchen bench with 40 mm thickness will be dark, to approximate the color of the tiles and make a rupture contrasts with the color of the covers.

The color of the drawer and covers will be shiny cream, the other parts will be colored as the covers. Before you start production colors and accessories will be determined by the responsible person designated by the investor.

Manufacturing, Supply and Installation.

## Wardrobe nr.14

**Dimensions :** 680 mm × 600 mm × 1800 mm

pieces: 1

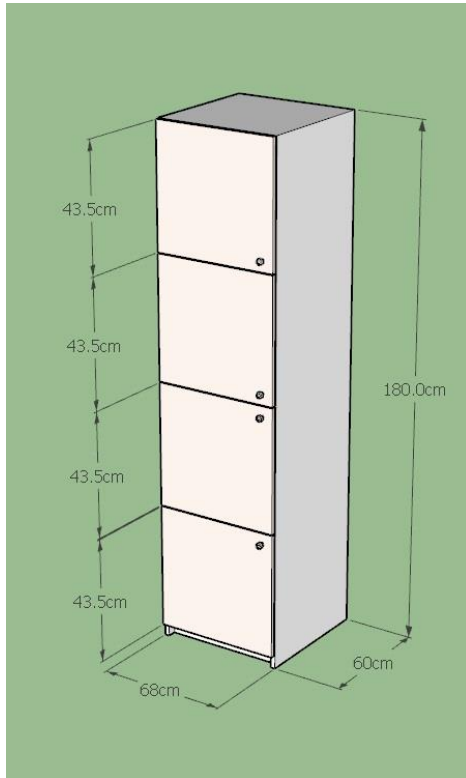

Wardrobe is composed of:

- a) 2 box
- b) 4 covers

Closet type of hanger closet, a shelf and a drawer switch. This type of closet is suitable for the post of environment where it is placed and its dimensions and forms did not adhere to predetermined standards and norms. Specifications are as follows: Caps and drawer cupboard is with acrylic material. The internal structure of the material is melamine cupboard and will have the same color with the lid. Union of elements made with plastic or metal angles and screws. The structure carrying the cupboard is based on plastic corks for not damage the floor and upholstered furniture in case of relocation.

The color of the drawer cap will be shiny cream, the other parts will be colored with caps approximate. Before you start production colors and accessories will be determined by the responsible person designated by the investor.

Manufacturing, Supply and Installation.

## Chairs nr.15/nr.16/nr.17

**Types : 3**



Chairs in 3 types :

- |  |           |
|--|-----------|
| a) Office chairs                       | pieces 6  |
| b) Service chairs with upholstery      | pieces 40 |
| c) Classroom chairs without upholstery | pieces 27 |

Office chairs are on wheels and with beige upholstery

Public chairs are simple with beige upholstery.

Classroom chairs are simple, in wood and colored with dark gray.

Classroom chairs with blue upholstery are for the grand collection class

Before you start production colors and accessories will be determined by the responsible person designated by the investor.

Manufacturing, Supply and Installation.



## Desk nr.18

**Dimensions :** 1650 mm 1000 mm × 720 mm

pieces: 2

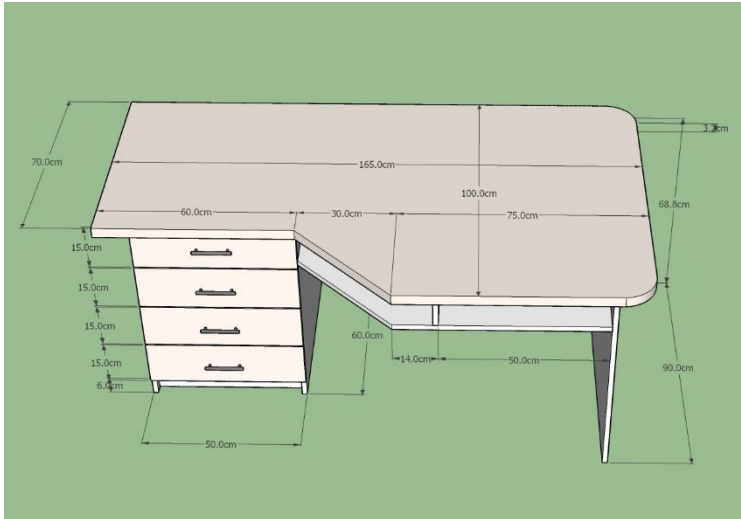

The desk is composed from:

- a) The top in rectangular shape
- b) Four drawers
- c) Shelf

The top will be in 32 mm width. The front of the top will be chamfered.

The connection of elements will be done with invisible accessories. The desk contact with the floor will be done with plastic tapes to avoid damages from humidity and strokes.

The color will be laminate cream. The colors and accessories will be chosen by the client authority person.

Manufacturing, Supply and Installation.

### Shelf nr.19

**Dimensions :** Bottom part.- 2000× 500 ×516 mm  
Upper part. - 2000× 300 ×1582 mm

pieces: 1

Etazhieri perbehet nga keto elemente:

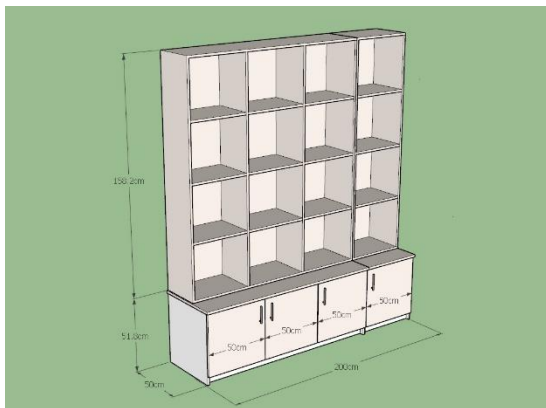

The shelf is composed by these elements:

-Bottom part:

- a) One box with upper and bottom and internal divisions
- b) 4 shutters with dimensions 500 mm

-Upper part:

- c) 1 shelter without shutters hanged on bottom part and on vertical wall

The shelf is designed in laminated M.D.F. in 16 mm width. The back is composed by 4mm width fiber with the same color as the shelf.

The connection of elements will be done with “L” profiles. The mounting of shutters will be done in sliding rails. The contact of shelf with the floor will be done with plastic tapes in order to protect the shelf from the humidity and damages.

The hangs will be hole type.

The color will be laminate cream. The colors will be chosen by the client authority person.

Manufacturing, Supply and Installation.

## Wardrobe nr.20

**Dimensions :** 1500 mm × 400 mm × 1800 mm

pieces: 1

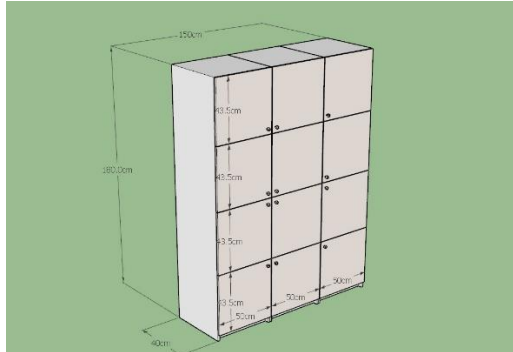

Wardrobe is composed of:

- a) 1 box
- b) 12 covers

Closet type of hanger closet, a shelf and a drawer switch. This type of closet is suitable for the post of environment where it is placed and its dimensions and forms did not adhere to predetermined standards and norms. Specifications are as follows: Caps and drawer cupboard is with acrylic material. The internal structure of the material is melamine cupboard and will have the same color with the lid. Union of elements made with plastic or metal angles and screws. The structure carrying the cupboard is based on plastic corks for not damage the floor and upholstered furniture in case of relocation.

The color of the drawer cap will be shiny cream, the other parts will be colored with caps approximate. Before you start production colors and accessories will be determined by the responsible person designated by the investor.

Manufacturing, Supply and Installation.

## Kitchen nr.21

**Dimensions :** 3780 mm × 600 mm × 2180 mm

pieces: 1



Kitchen is composed of:

- a) The lower part
- b) The top

Kitchen consisting of the lower and upper part, where their specifications are given as follows.

Covers and drawers are from acrylic material, where their borders are covered with P.V.C. The internal structure of the kitchen is melamine material and shall have the same color with the lidcovers. Union of elements is made with plastic or metal angles and screws. The structure carrying the lower part of the cuisine is based on 100 mm plastic legs and covered in the front. The structure of the upper part will be fixed in the walls. The other element is the kitchen bench with 40 mm thickness will be dark, to approximate the color of the tiles and make a rupture contrasts with the color of the covers.

The color of the drawer and covers will be shiny cream, the other parts will be colored as the covers. Before you start production colors and accessories will be determined by the responsible person designated by the investor.

Manufacturing, Supply and Installation.

## Kitchen nr.22

**Dimensions :** 2900 mm × 600 mm × 1020 mm

pieces: 1

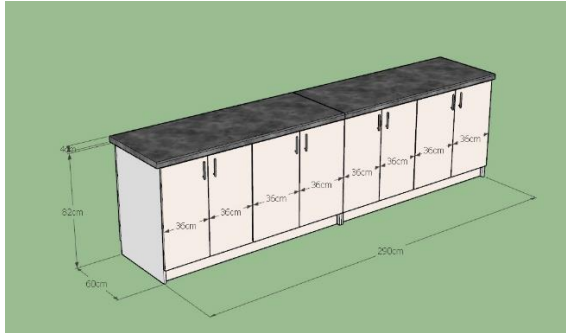

Kitchen is composed of:

a) The lower part

Kitchen consisting of the lower , where their specifications are given as follows. Covers and drawers are from acrylic material, where their borders are covered with P.V.C. The internal structure of the kitchen is melamine material and shall have the same color with the lidcovers. Union of elements is made with plastic or metal angles and screws. The structure carrying the lower part of the cuisine is based on 100 mm plastic legs and covered in the front. The other element is the kitchen bench with 40 mm thickness will be dark, to approximate the color of the tiles and make a rupture contrasts with the color of the covers.

The color of the drawer and covers will be shiny cream, the other parts will be colored as the covers. Before you start production colors and accessories will be determined by the responsible person designated by the investor.

Manufacturing, Supply and Installation.

### Shelf nr.23

**Dimensions :** Bottom part.- 2550× 400 ×516 mm  
Upper part. - 2550× 300 ×1582 mm

pieces: 1

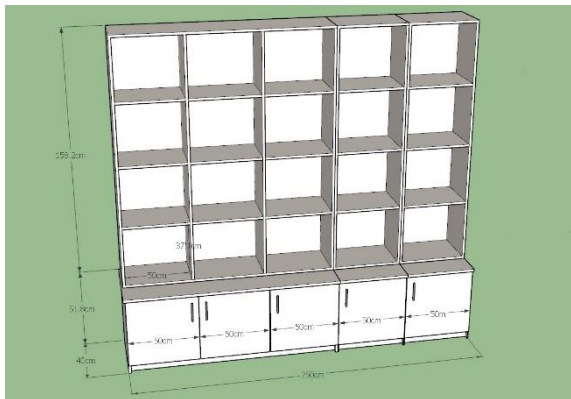

The shelf is composed by these elements:

-Bottom part:

- a) One box with upper and bottom and internal divisions
- b) 5 shutters with dimensions 500 mm

-Upper part:

- c) 1 shelter without shutters hanged on bottom part and on vertical wall

The shelf is designed in laminated M.D.F. in 16 mm width. The back is composed by 4mm width fiber with the same color as the shelf.

The connection of elements will be done with “L” profiles. The mounting of shutters will be done in sliding rails. The contact of shelf with the floor will be done with plastic tapes in order to protect the shelf from the humidity and damages.

The hangs will be hole type.

The color will be laminate cream. The colors will be chosen by the client authority person.

Manufacturing, Supply and Installation.

### Shelf nr.24

**Dimensions :** Bottom part.- 3600× 300 ×516 mm  
Upper part. - 3600× 300 ×1582 mm

pieces: 1

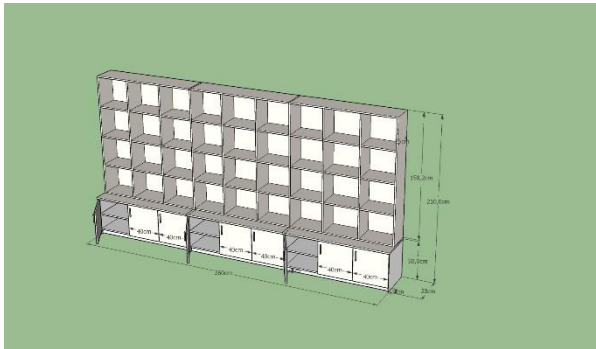

The shelf is composed by these elements:

-Bottom part:

- a) One box with upper and bottom and internal divisions
- b) 9 shutters with dimensions 400 mm

-Upper part:

- c) 1 shelter without shutters hanged on bottom part and on vertical wall

The shelf is designed in laminated M.D.F. in 16 mm width. The back is composed by 4mm width fiber with the same color as the shelf.

The connection of elements will be done with “L” profiles. The mounting of shutters will be done in sliding rails. The contact of shelf with the floor will be done with plastic tapes in order to protect the shelf from the humidity and damages.

The hangs will be hole type.

The color will be laminate cream. The colors will be chosen by the client authority person.

Manufacturing, Supply and Installation.

### Shelf nr.25

**Dimensions :** Bottom part.- 780× 300 ×516 mm  
Upper part. - 780× 300 ×1582 mm

pieces:1

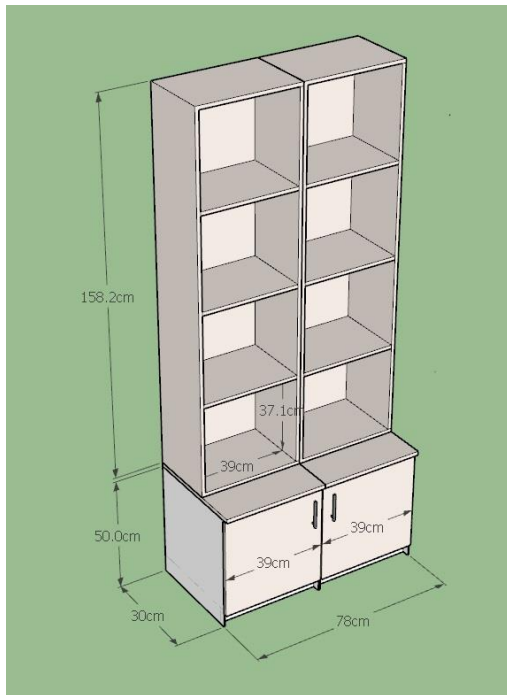

The shelf is composed by these elements:

-Bottom part:

- a) One box with upper and bottom and internal divisions
- b) 2 shutters with dimensions 390 mm

-Upper part:

- c) 1 shelter without shutters hanged on bottom part and on vertical wall

The shelf is designed in laminated M.D.F. in 16 mm width. The back is composed by 4mm width fiber with the same color as the shelf.

The connection of elements will be done with “L” profiles. The mounting of shutters will be done in sliding rails. The contact of shelf with the floor will be done with plastic tapes in order to protect the shelf from the humidity and damages.

The hangs will be hole type.

The color will be laminate cream. The colors will be chosen by the client authority person.

Manufacturing, Supply and Installation.



## Wardrobe nr.26

**Dimensions :** 1290 mm × 000 mm × 1800 mm

pieces:1

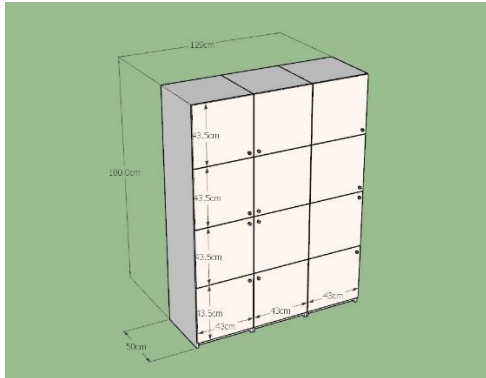

Wardrobe is composed of:

- a) 1 box
- b) 12 covers

Closet type of hanger closet, a shelf and a drawer switch. This type of closet is suitable for the post of environment where it is placed and its dimensions and forms did not adhere to predetermined standards and norms. Specifications are as follows: Caps and drawer cupboard is with acrylic material. The internal structure of the material is melamine cupboard and will have the same color with the lid. Union of elements made with plastic or metal angles and screws. The structure carrying the cupboard is based on plastic corks for not damage the floor and upholstered furniture in case of relocation.

The color of the drawer cap will be shiny cream, the other parts will be colored with caps approximate. Before you start production colors and accessories will be determined by the responsible person designated by the investor.

Manufacturing, Supply and Installation.