

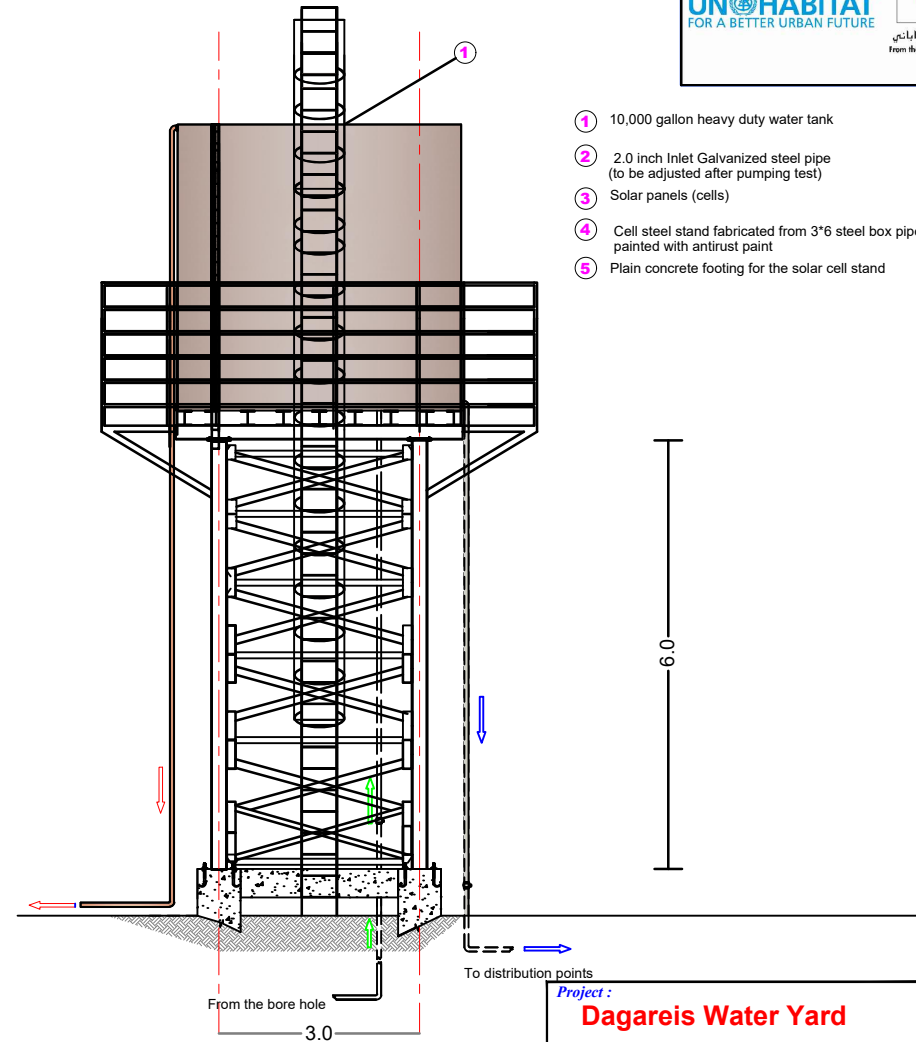

## Notes:

- The solar cell shall be mounted on steel / aluminum stands
- The total output of the solar cells shall decided after pumping test  
but should not be less 3.5KVA
- The solar cell be properly installed to manufacturers directions
- All electrical cables shall be through electrical pipes protected and trenched

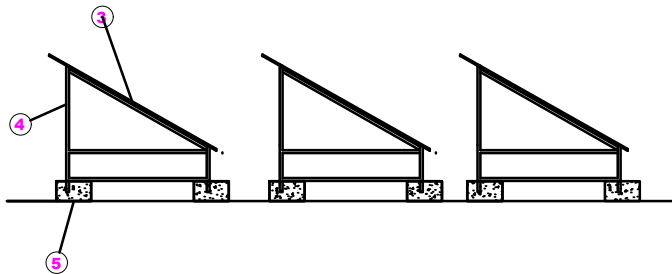

UNO HABITAT  
FOR A BETTER URBAN FUTURE



- 1 10,000 gallon heavy duty water tank
- 2 2.0 inch Inlet Galvanized steel pipe  
(to be adjusted after pumping test)
- 3 Solar panels (cells)
- 4 Cell steel stand fabricated from 3\*6 steel box pipes  
painted with antirust paint
- 5 Plain concrete footing for the solar cell stand

Project :

**Dagareis Water Yard**

Content :

**Water tank drawings**

drawn By:

March  
2019

**08**