

4mm x 25mm wrought iron

iron clamp

12mm square bar

2mm metal infill sheet

15mm x 15mm trim to both sides

30mm x 30mm box section main frame

**DETAIL**  
**Scale 1:5**

0 0.25 0.5

**SCALE BAR 1:5**

All measurements on this drawing sheet are in meters.



Archive Photo Of wrought iron gate of the narthex

















**Project Title:**  
Sourp Magar Monastery - Rehabilitation Plan and Conservation Designs

Design:	Name:	Surname:	Licence no.:
Architect:	Zoe	Lordos	10907
Civil Engineer:	Andreas	Antoniou	71696

**Designer Team:** Senior Architect: Andreas Lordos  
Architects: Ioanna Anastasiadou, Enver Eronen, Christina Kleanthous Papademetriou, Constantina Hadjicosta  
Civil Engineer: Rogiros Illampas  
Archaeologist: Anna Marangou

Date:	28/02/2019	Scale:	1:10 @ A2
Revision Date:	27/03/2019 24/06/2019		

<p>Drawing Name:  Proposed Interventions  Block F- Wrought Iron Gate of the  Narthex - Final</p>	<p>Drawing no.:  A-Pr 21</p>
--------------------------------------------------------------------------------------------------------------	----------------------------------

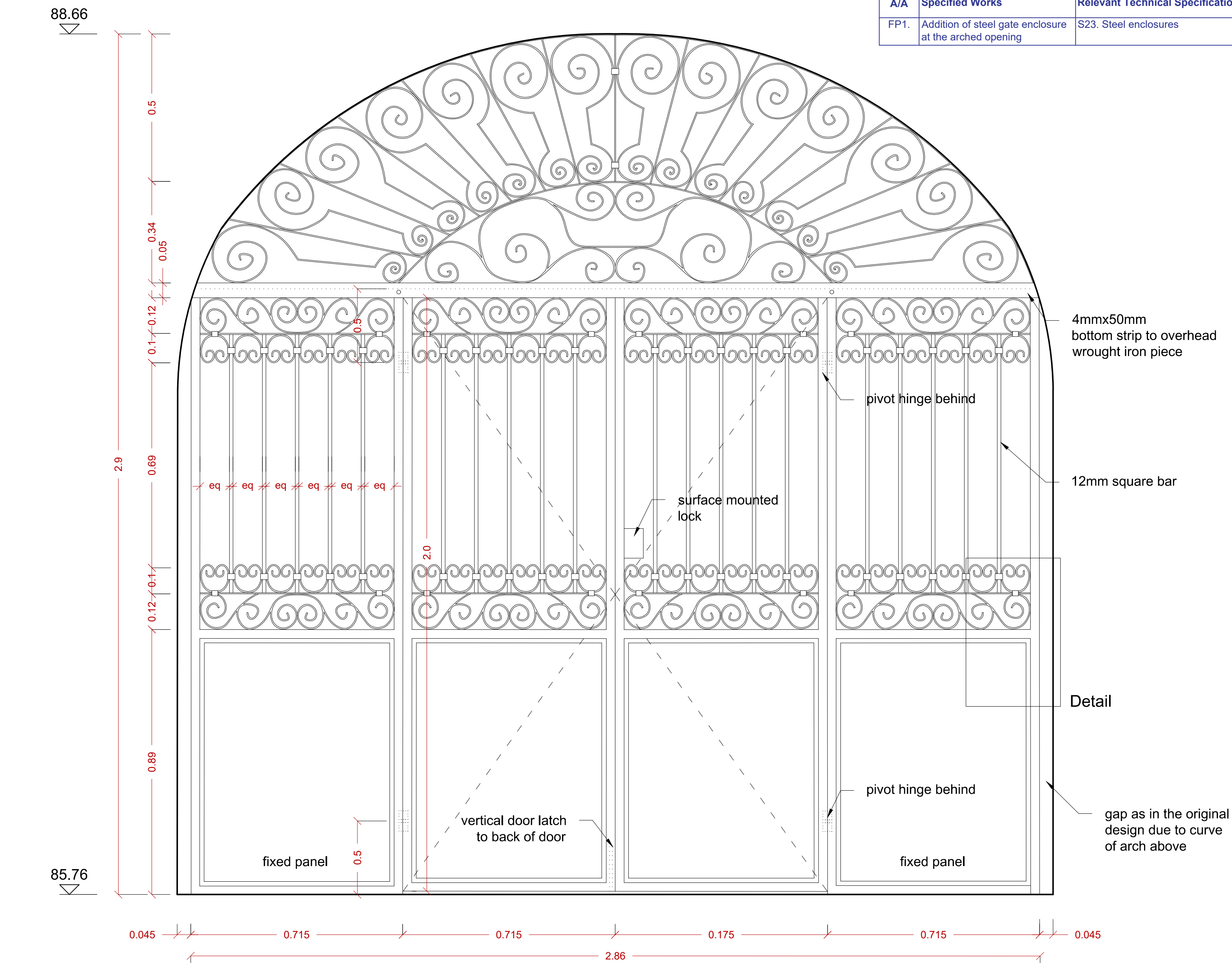

SCALE BAR 1:10  
All measurements on this drawing sheet are in meters.

ELEVATION  
Scale 1:10

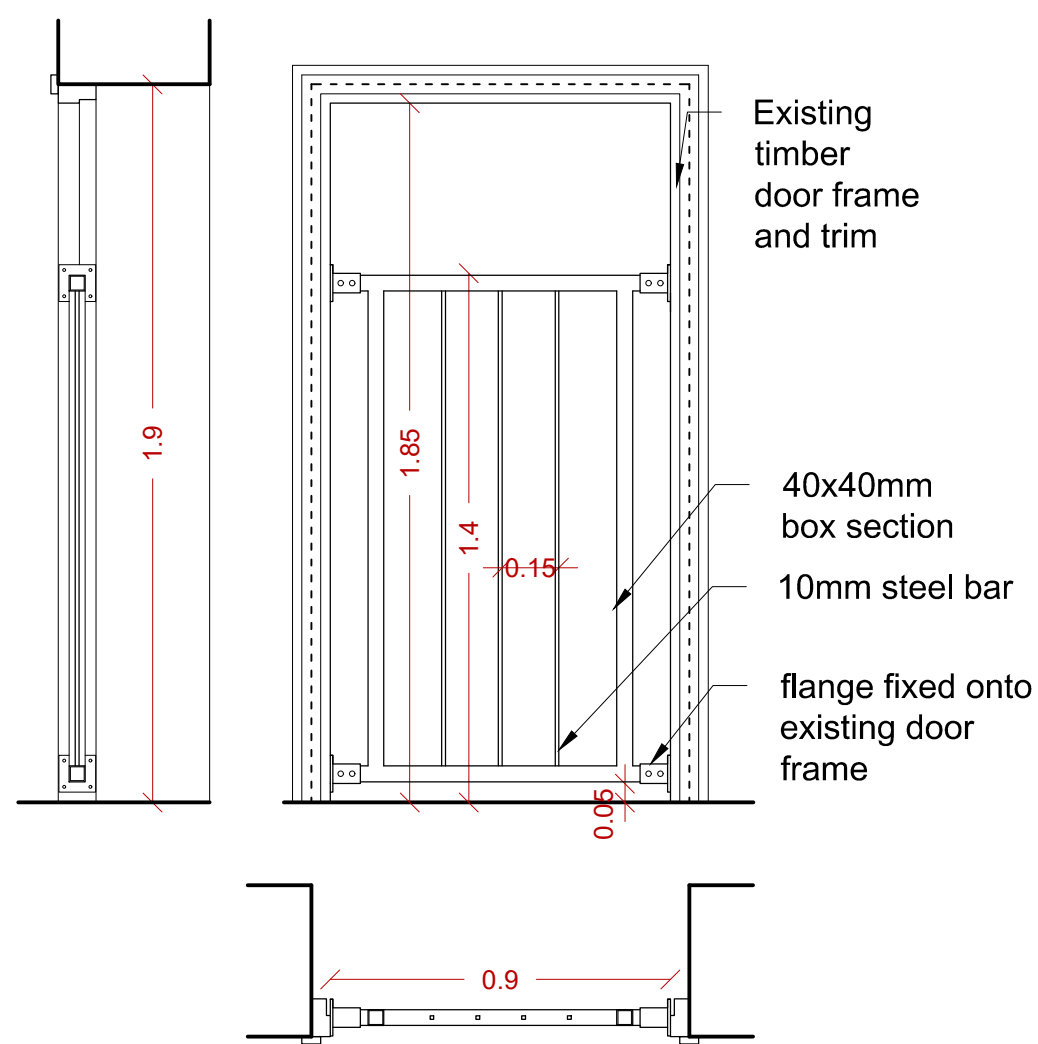

D.C 06 METAL PARTITION  
Scale: 1:20

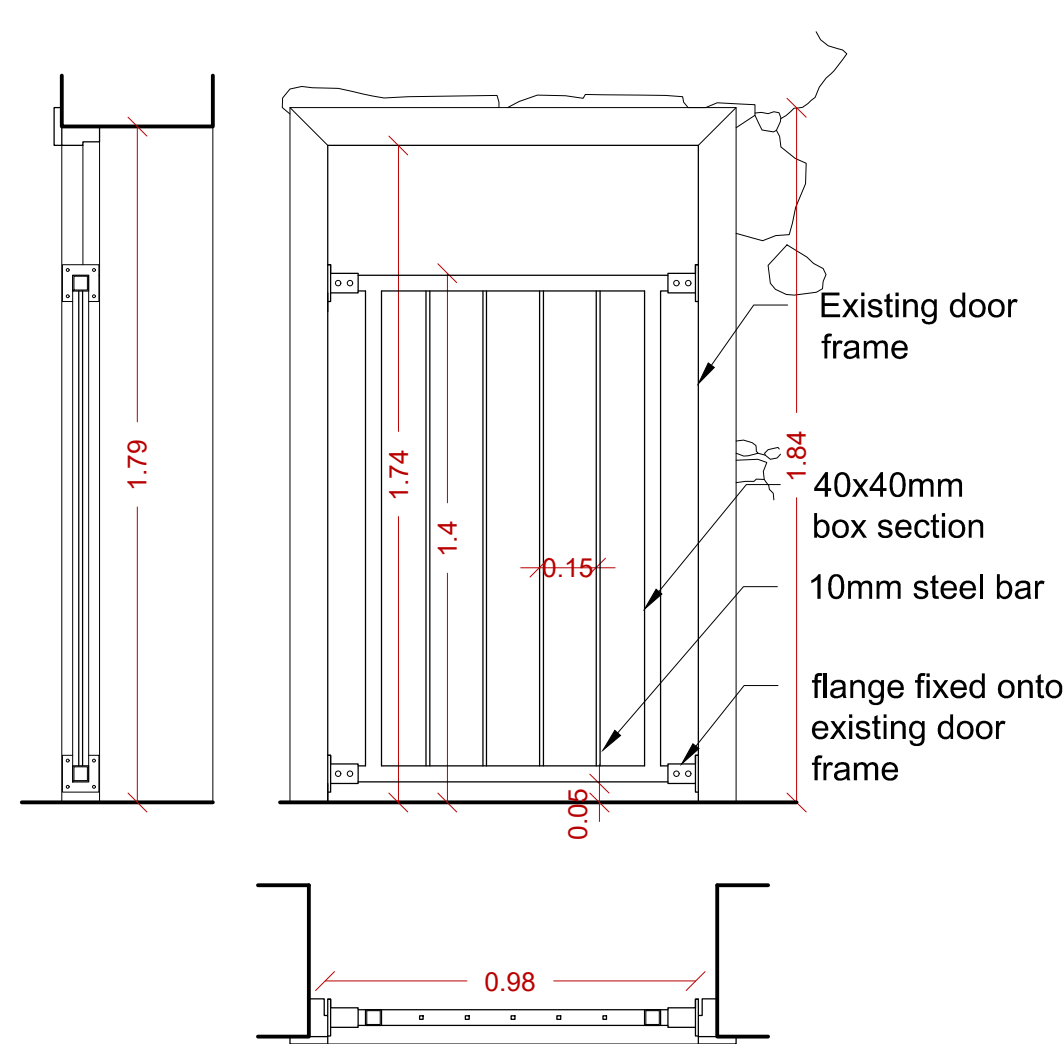

D.C 24 METAL PARTITION  
Scale: 1:20

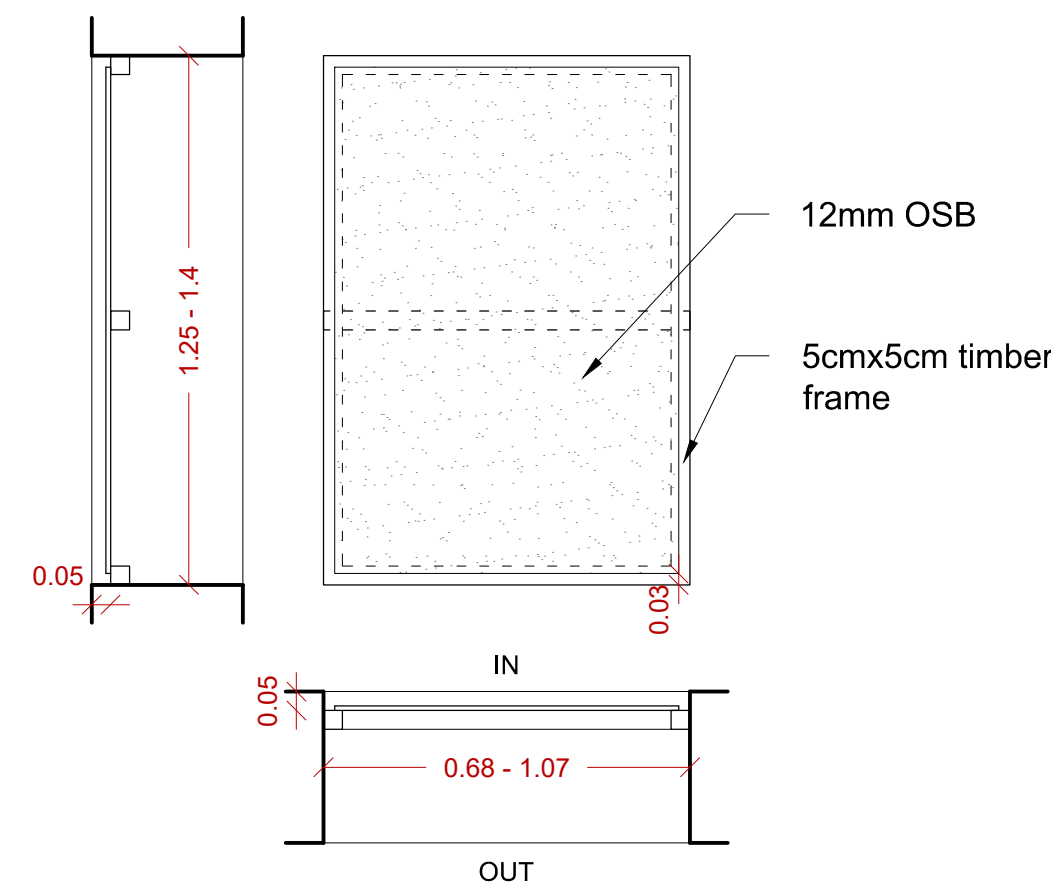

OSB WINDOW BLOCK  
BLOCK A (5no.)  
Scale: 1:20

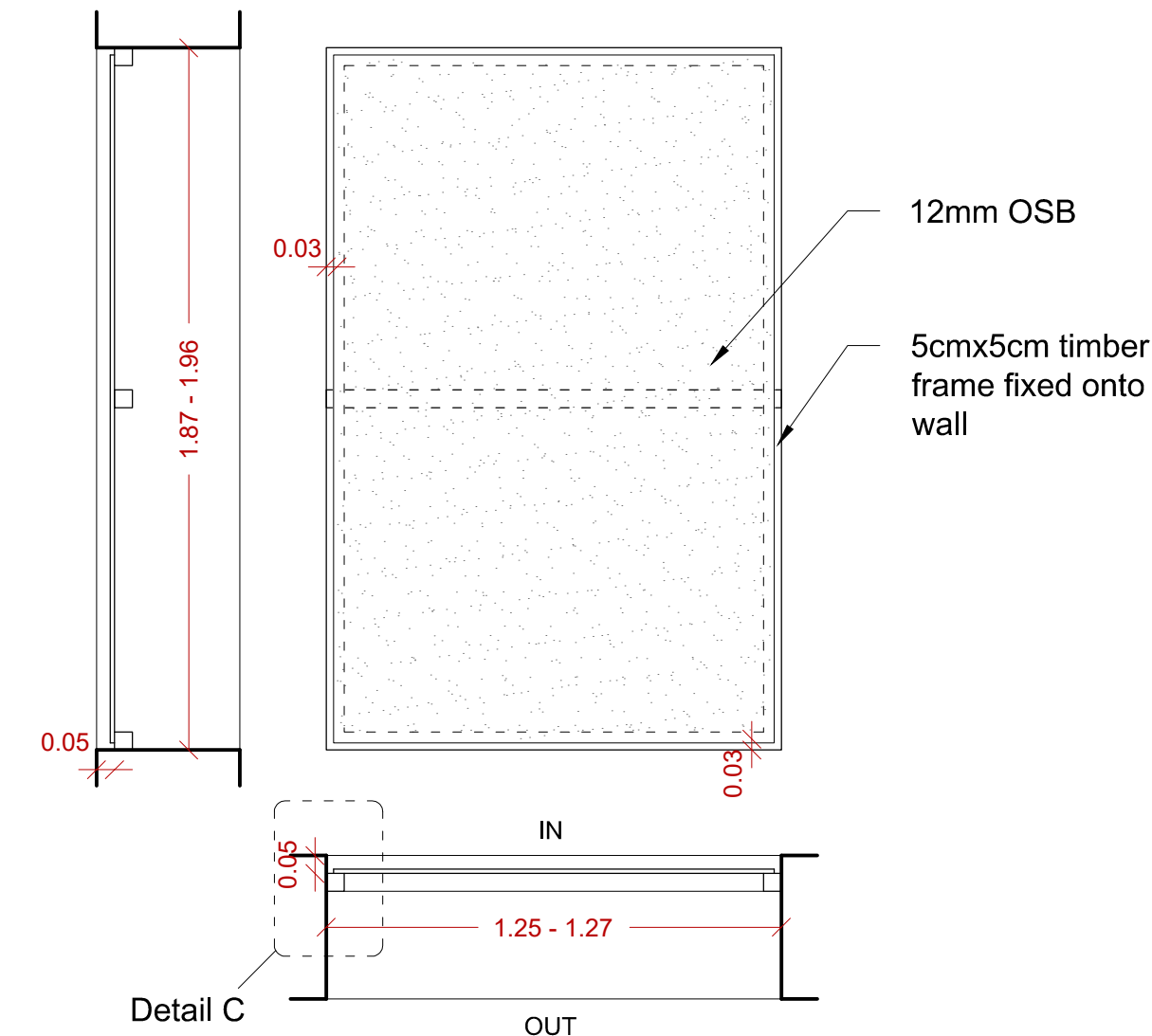

OSB WINDOW BLOCK  
BLOCK C (2no.)  
Scale: 1:20

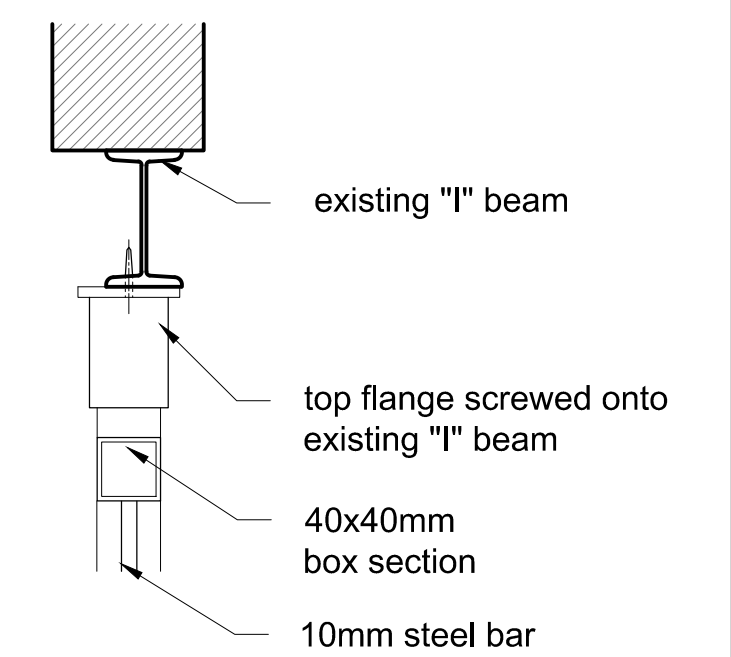

DETAIL A  
"I" BEAM  
FIXING DETAIL  
Scale: 1:5

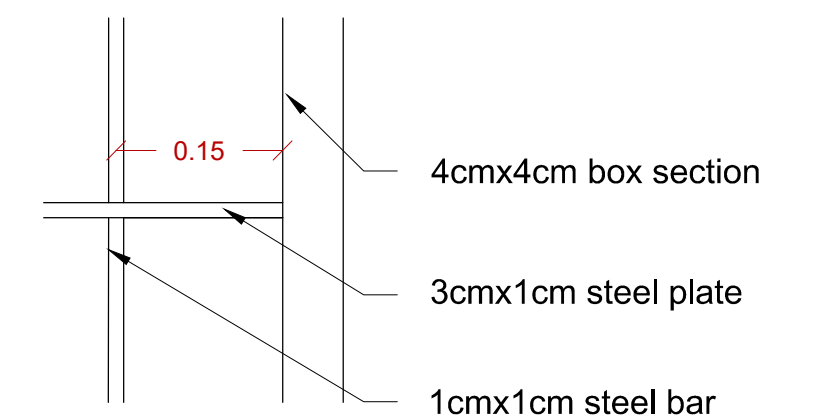

DETAIL B  
ARCH SCREEN DETAIL  
Scale: 1:5

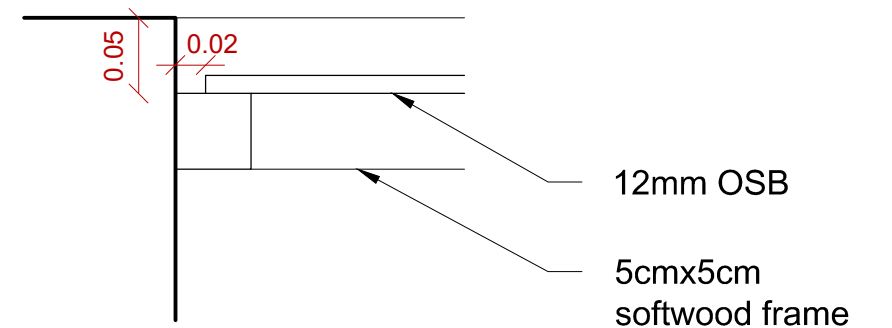

DETAIL C  
OSB SCREEN  
Scale: 1:5

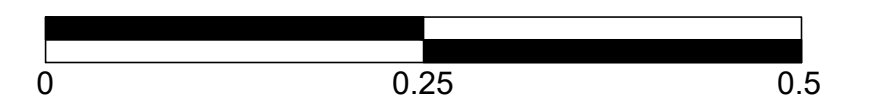

SCALE BAR 1:5  
All measurements on this drawing sheet are in meters.

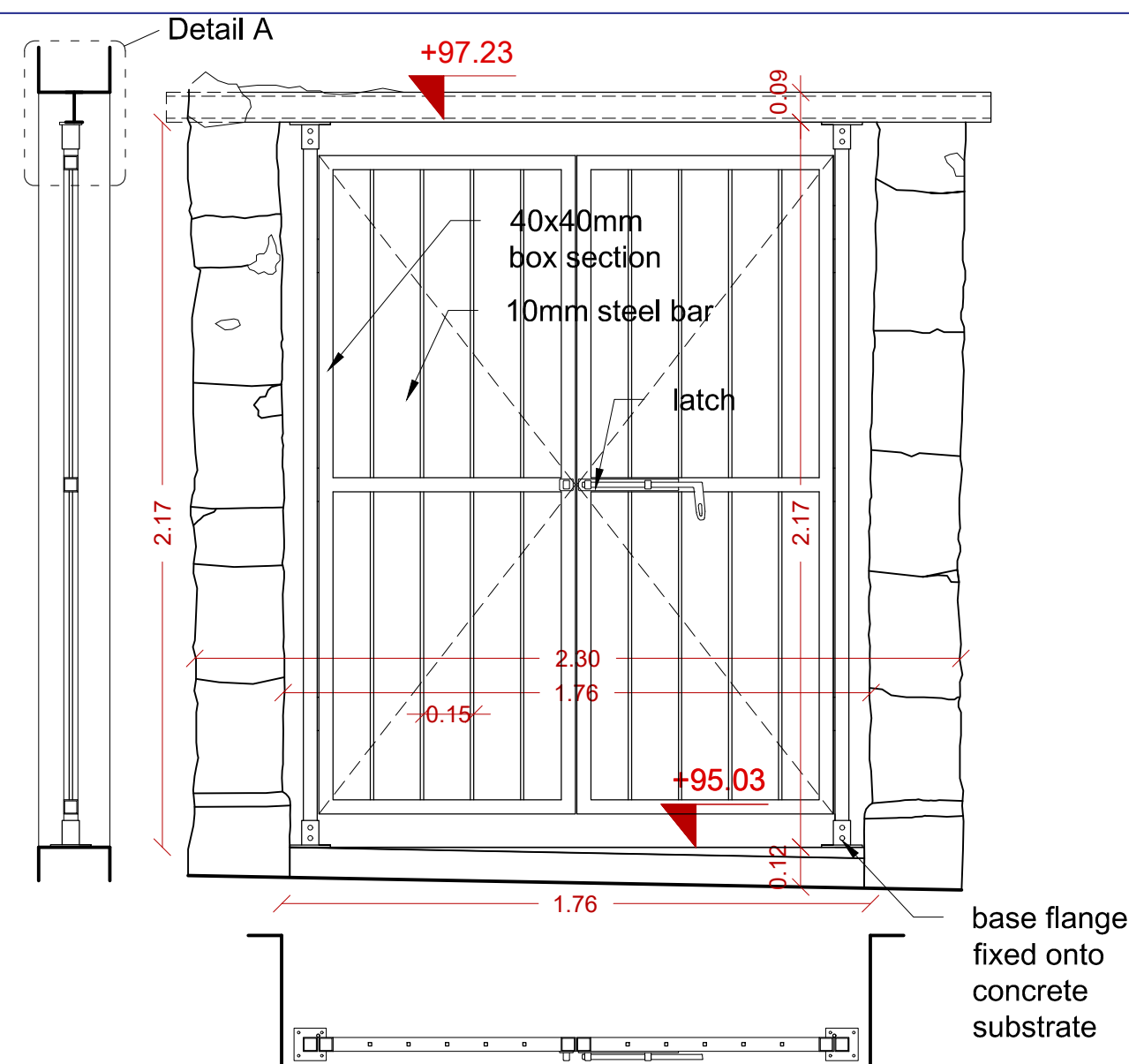

WEST ENTRANCE GATE, Scale 1:20

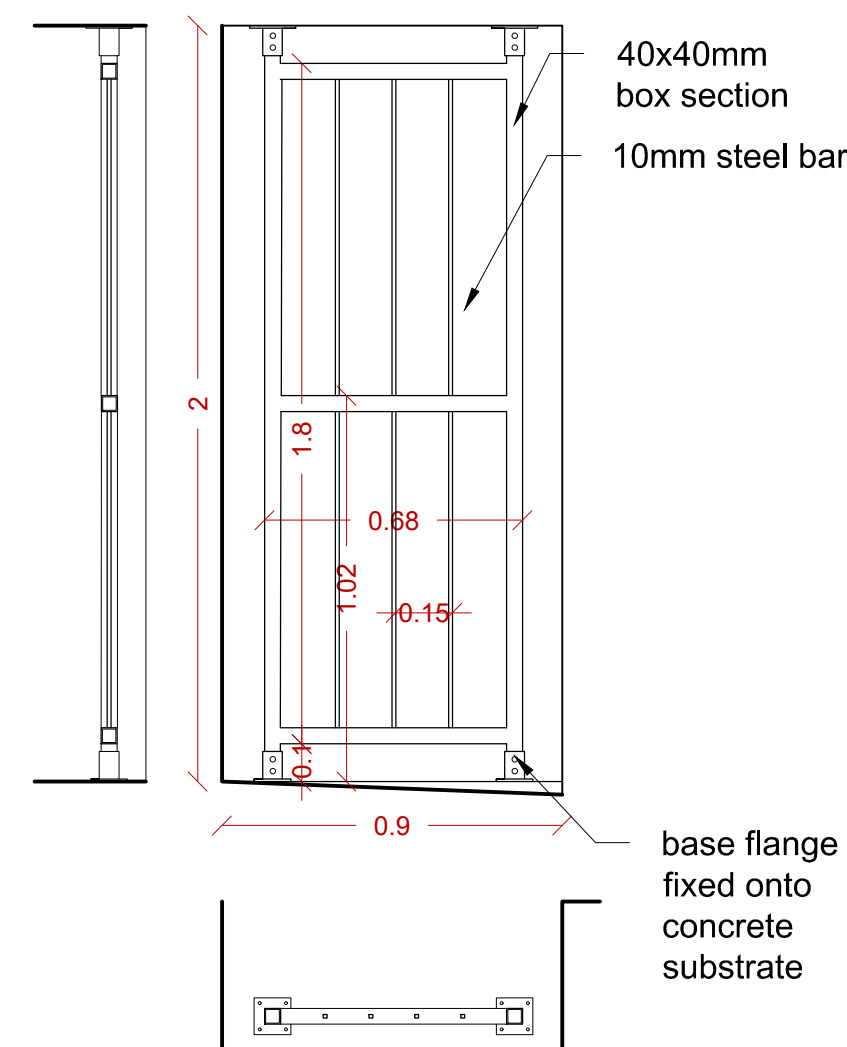

SOUTH DOOR OPENING GATE  
Scale 1:20

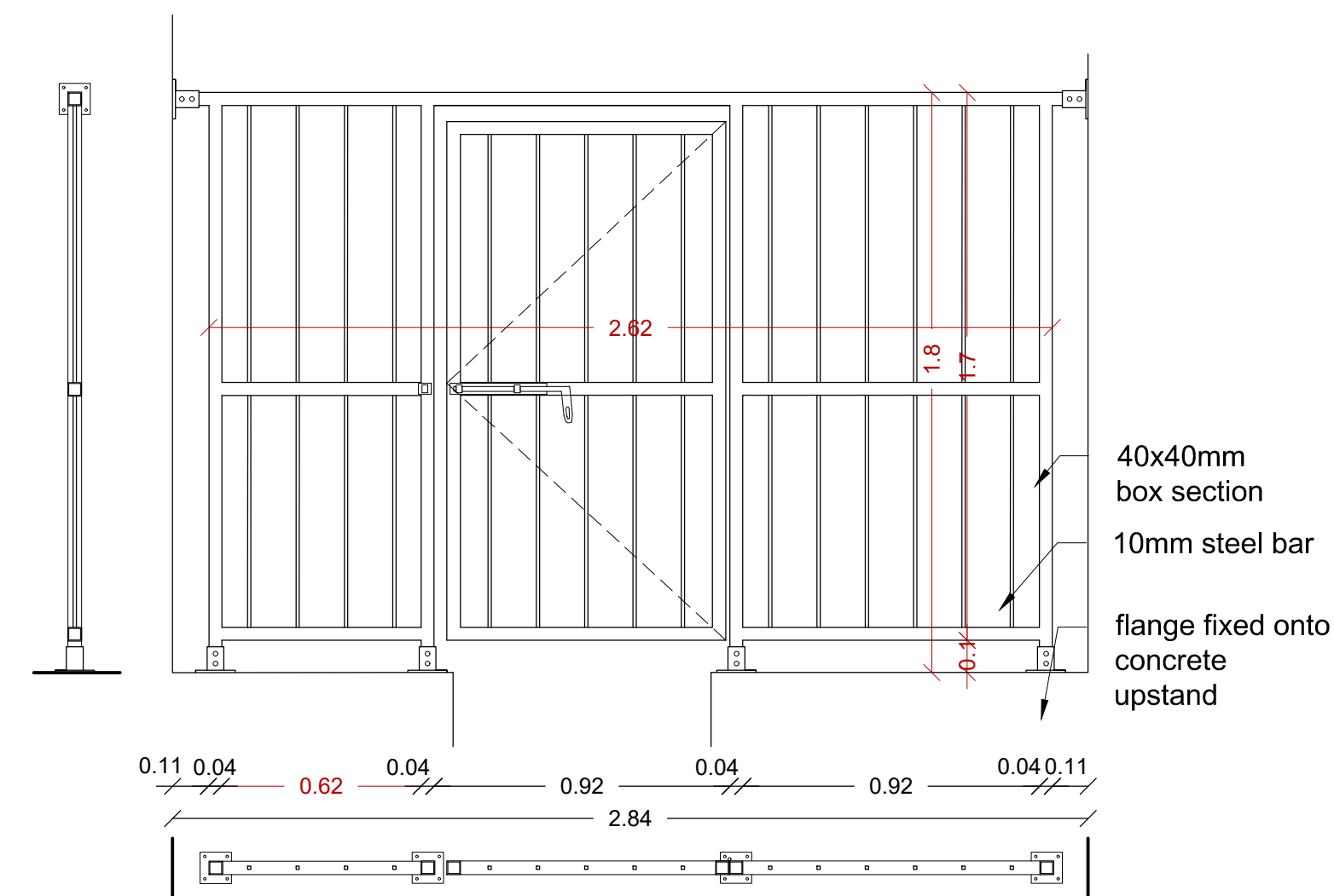

CORRIDOR ACCESS GATE  
Scale 1:20

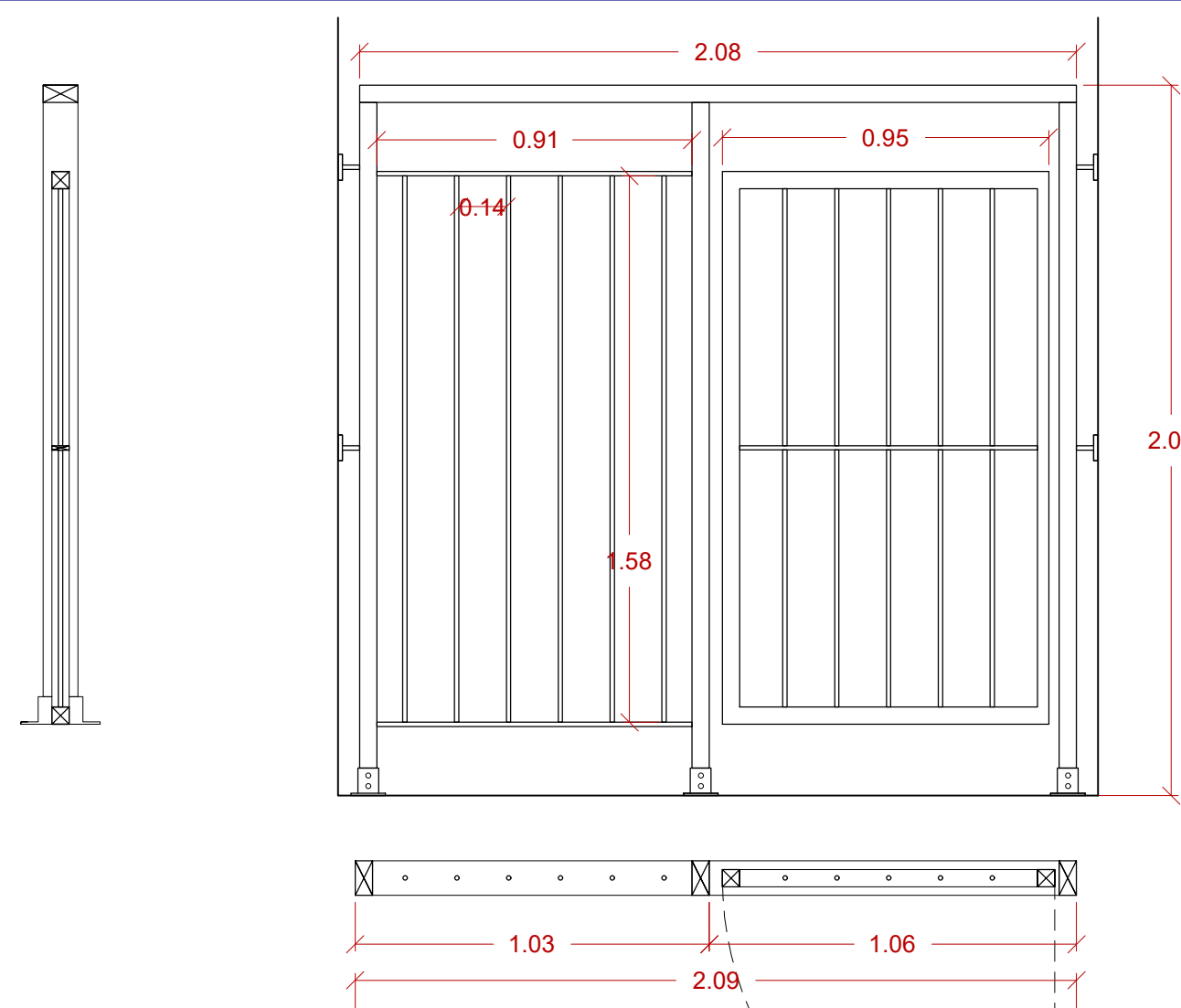

EAST ENTRANCE GATE, Scale 1:20  
(Detail of the east gate to be agreed on a later stage)

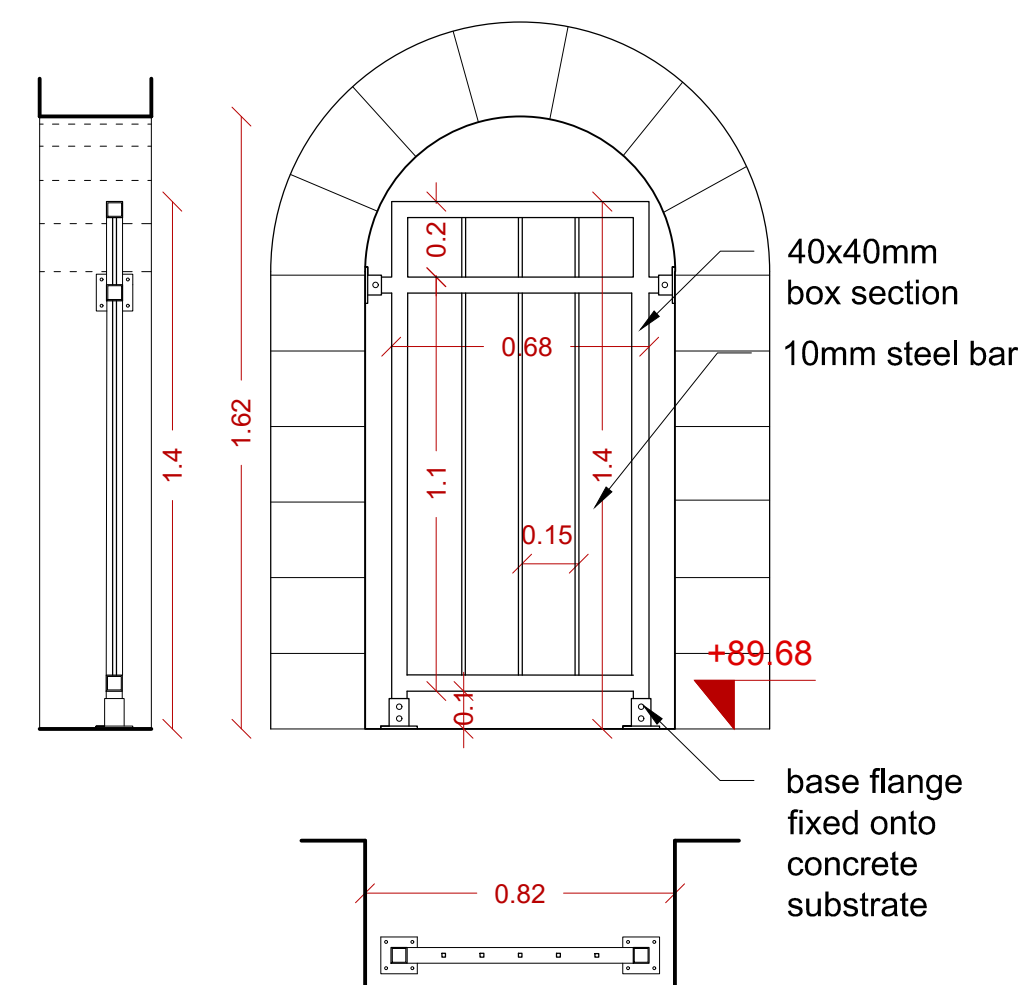

NORTH ENTRANCE GATE  
Scale 1:20

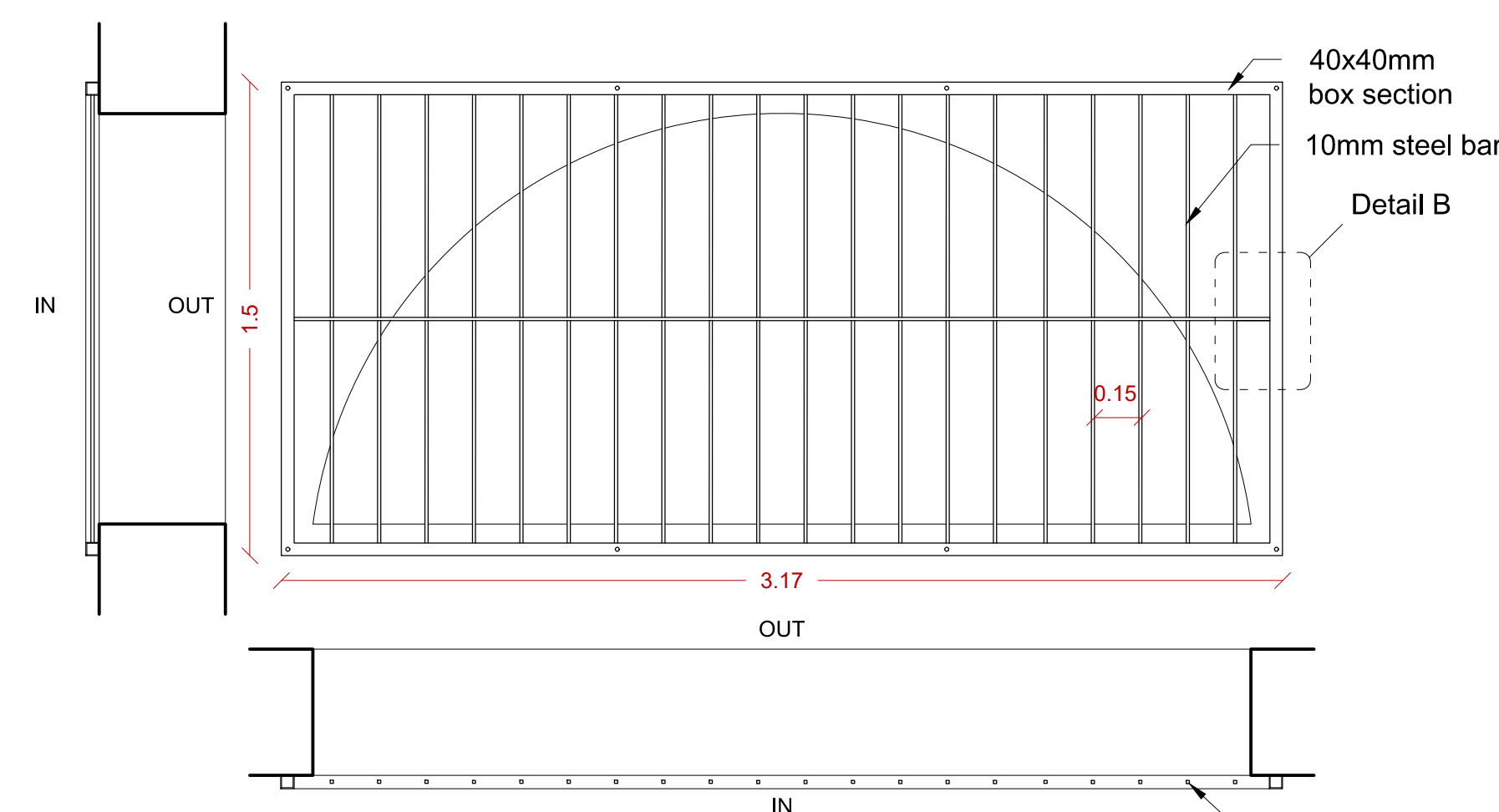

TYPICAL ARCH COVER SCREEN  
Scale 1:20

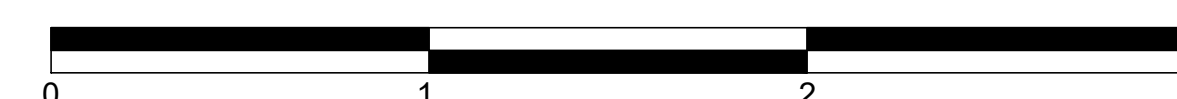

SCALE BAR 1:20  
All measurements on this drawing sheet are in meters.

Relevant Technical Specifications

S23. Steel enclosures

S24. Timber enclosures



United Nations Development Programme



This is a Project of the Technical Committee on Cultural Heritage funded by the European Union.

Project Title:

Sourp Magar Monastery - Rehabilitation Plan and Conservation Designs

Design:	Name:	Surname:	Licence no.:
Architect:	Zoe	Lordos	10907
Civil Engineer:	Andreas	Antoniou	71696

Designer Team: Senior Architect: Andreas Lordos  
Architects: Ioanna Anastasiadou, Enver Eronen, Christina Kleanthous Papademetriou, Constantina Hadjicosta  
Civil Engineer: Rogiros Illampas  
Archaeologist: Anna Marangou

Date:	28/02/2019	Scale:	1:20 & 1:5 @ A1
Revision Date:	06/03/2019 27/03/2019 24/06/2019		

Drawing Name: Proposed Interventions West, North, South Entrance & Door and window Partitions - Final	Drawing no.: A-Pr 22
----------------------------------------------------------------------------------------------------------------	-------------------------



Ø42mm galvanised tube railing

6.25

2.05

4.6

4.65

2.07

operable gate with latch

0 5 10

SCALE BAR 1:50  
All measurements on this drawing sheet are in meters.

Plan  
Scale 1:50

Elevation  
Scale 1:20

Technical drawing of a railing system, showing side and end views with dimensions and labels.

**Labels:**

- latch
- Butt Hinge
- Ø42mm galvanised tube railing
- 10x10mm galvanised steel bar
- base flange fixed onto concrete substrate

**Dimensions (in meters):**

- Overall height: 1.1
- Overall width: 0.94
- Vertical spacing between bars: 0.1
- Horizontal spacing between bars: 0.1
- Maximum horizontal distance between supports: max 1m
- End view width: 0.2
- End view height: 0.9

**Scale Bar:** 0 1 2

**SCALE BAR 1:20**

**All measurements on this drawing sheet are in meters.**

Courtyard			
A/A	Specified Works	Relevant Technical Specification	
YS6.	Installation of steel balustrading for guiding and limiting visitors' accessibility	S18. Construction of steel structures	
<div>   </div> <div> United Nations Development Programme </div> <div>  </div> <div> Empowered lives. Resilient nations. </div> <div> This is a Project of the Technical Committee on Cultural Heritage funded by the European Union </div>			
<b>Project Title:</b> Sourp Magar Monastery - Rehabilitation Plan and Conservation Designs			
<b>Design:</b>	<b>Name:</b>	<b>Surname:</b>	<b>Licence no.:</b>
<b>Architect:</b>	Zoe	Lordos	10907
<b>Civil Engineer:</b>	Andreas	Antoniou	71696
<b>Designer Team:</b> Senior Architect: Andreas Lordos Architects: Ioanna Anastasiadou, Enver Eronen, Christina Kleanthous Papademetriou, Constantina Hadjicosta Civil Engineer: Rogiros Illampas Archaeologist: Anna Marangou			
<b>Date:</b>	28/02/2019	<b>Scale:</b>	1:20 & 1:5 @ A2
<b>Revision Date:</b>	27/03/2019 24/06/2019		
<b>Drawing Name:</b> Proposed Interventions Balustrading Detail - Final		<b>Drawing no.:</b> A-Pr 23	

COURTYARD BALUSTRADE, Sc. 1:20

CLIFF BALUSTRADE, Sc. 1:50  
TOTAL LENGTH OF BALUSTRADE 33 m (until the plot boundary) .

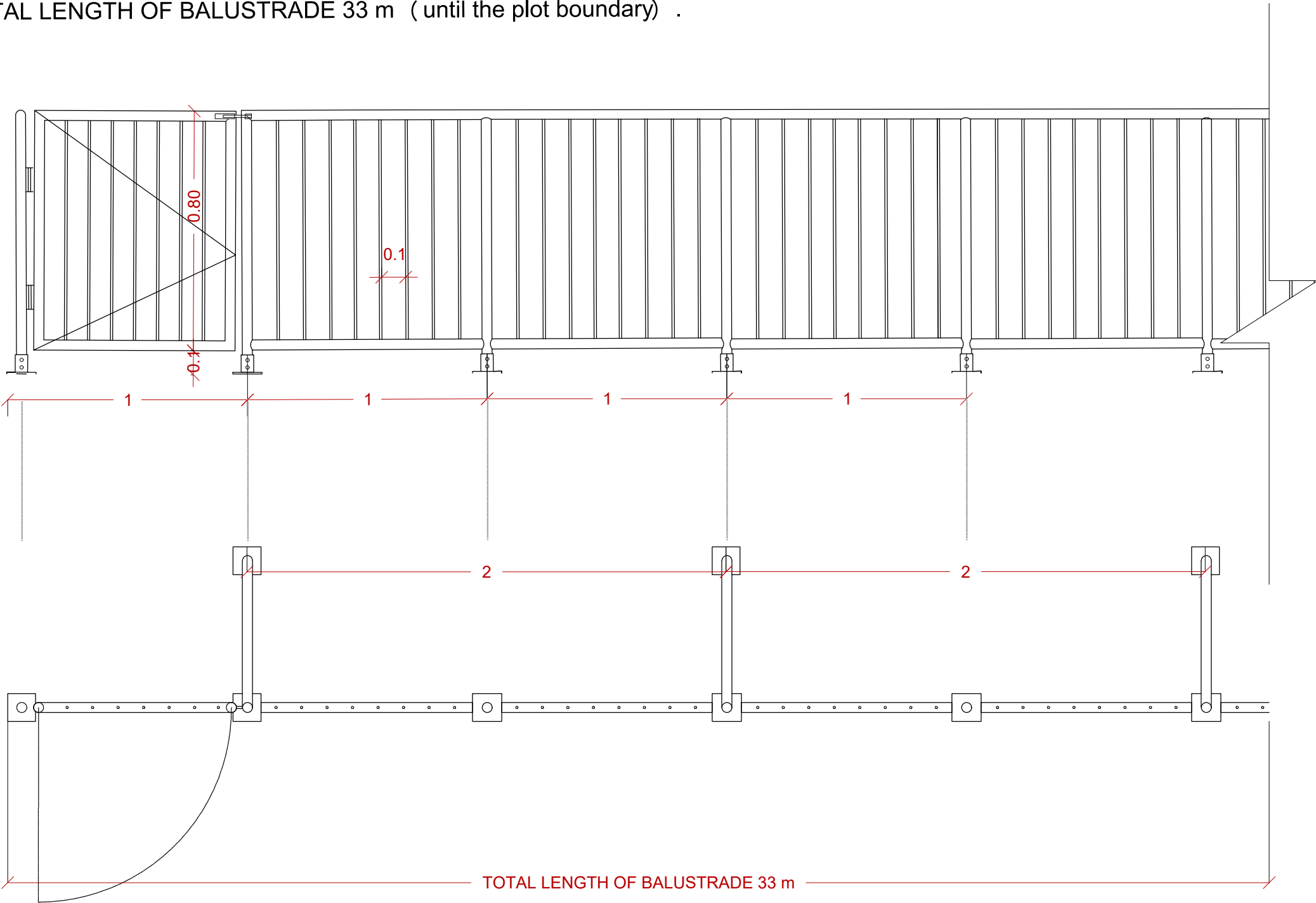

ENTRANCE BALUSTRADE, Sc. 1:20

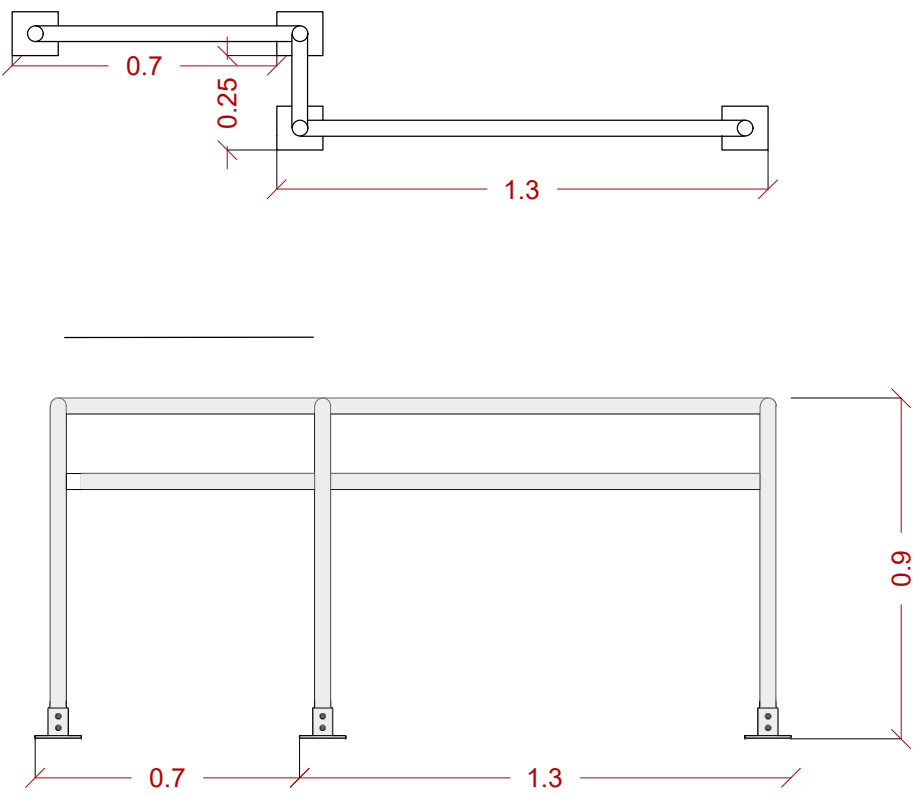

Courtyard			
A/A	Specified Works	Relevant Technical Specification	
YS6.	Installation of steel balustrading for guiding and limiting visitors' accessibility	S18. Construction of steel structures	
<div><div><div>United Nations Development Programme</div><div>Empowered lives. Resilient nations.</div></div><div><div>This is a Project of the Technical Committee on Cultural Heritage funded by the European Union</div></div></div>			
Project Title: Sourp Magar Monastery - Rehabilitation Plan and Conservation Designs			
Design:	Name:	Surname:	Licence no.:
Architect:	Zoe	Lordos	10907
Civil Engineer:	Andreas	Antoniou	71696
Designer Team: Senior Architect: Andreas Lordos Architects: Ioanna Anastasiadou, Enver Eronen, Christina Kleanthous Papademetriou, Constantina Hadjicosta Civil Engineer: Rogiros Illampas Archaeologist: Anna Marangou			
Date:	12/04/2019	Scale:	1:20 @ A2
Revision Date:	24/06/2019		
Drawing Name: Proposed Interventions Balustrading Detail - Final			Drawing no.: A-Pr 23A







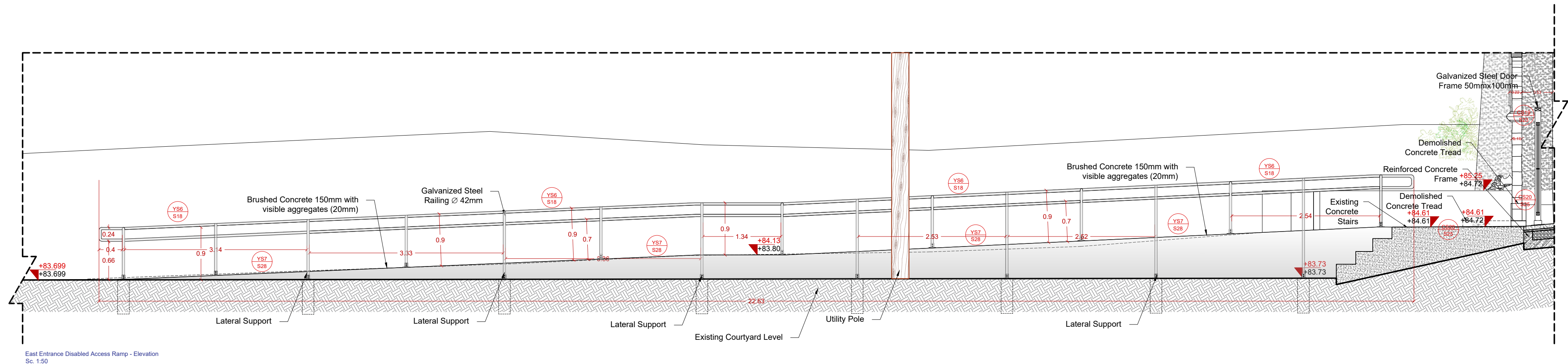

East Entrance Disabled Access Ramp - Elevation  
Sc. 1:50

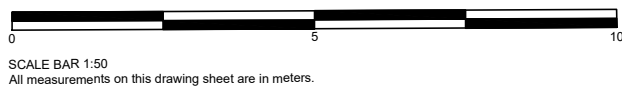

Courtyard		
A/A	Specified Works	Relevant Technical Specification
YS6.	Installation of steel balustrade	S18. Construction of steel structures
YS7.	Addition of ramp at the south boundary of the plot for disabled access.	S28. Concrete Work
The details of the drainage channel and the east entrance gate to be agreed on a later stage.		

<div><div><div>United Nations Development Programme</div><div>Empowered lives. Resilient nations.</div></div><div><div>2008</div></div><div></div></div> <div>This is a Project of the Technical Committee on Cultural Heritage funded by the European Union</div>			
Project Title: Sourp Magar Monastery - Rehabilitation Plan and Conservation Designs			
Design:	Name:	Surname:	Licence no.:
Architect:	Zoe	Lordos	10907
Civil Engineer:	Andreas	Antoniou	71696
Designer Team: Senior Architect: Andreas Lordos Architects: Ioanna Anastasiadou, Enver Eronen, Christina Kleanthous Papademetriou, Constantina Hadjicosta Civil Engineer: Rogiros Illampas Archaeologist: Anna Marangou			
Date:	10/04/2019	Scale:	1:50 & 1:20
Revision Date:	24/06/2019		
Drawing Name: East Entrance Disabled Access Ramp Detail - Final			Drawing no.: A-Pr 24A



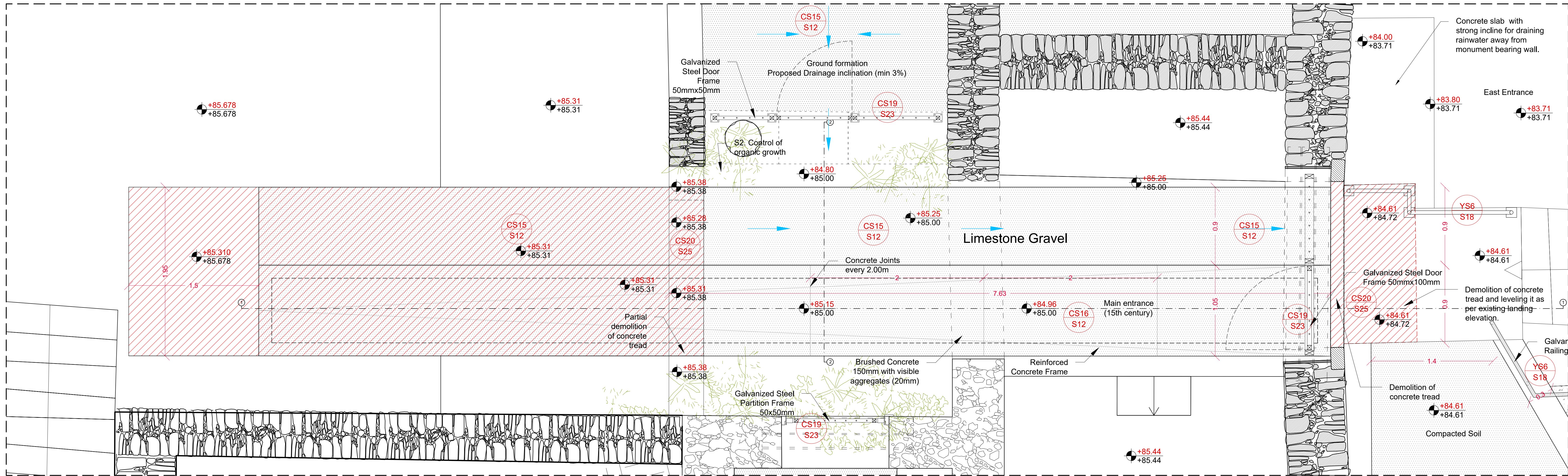

Plan

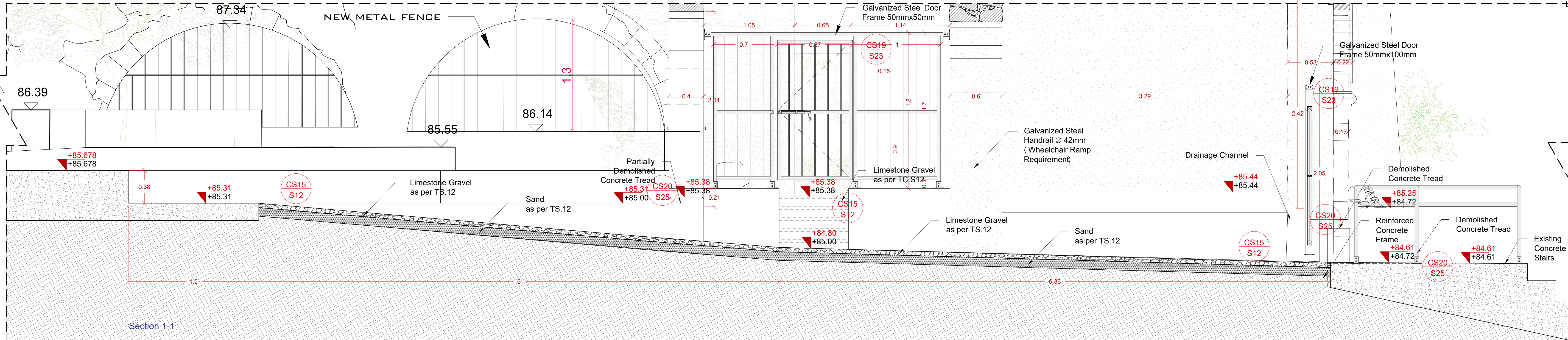

Section 1-1

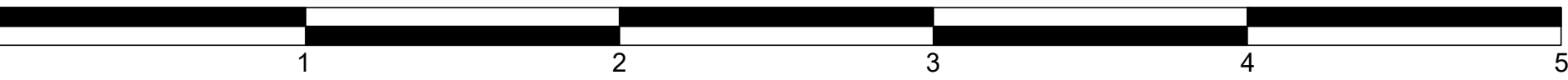

SCALE BAR 1:20  
All measurements on this drawing sheet are in meters.

Block C		
A/A	Specified Works	Relevant Technical Specification
CS15.	Complete covering of floors with layers of granular materials and formation of ground drainage inclinations	S12. Covering of floors with granular material
CS16.	Addition of ramp on the entrance for disabled access	S12. Covering of floors with granular material
CS19.	Addition of steel enclosures	S23. Steel enclosures
CS20.	Removal of concrete tread	S25. Removal of existing concrete sections

Courtyard		
A/A	Specified Works	Relevant Technical Specification
YS6.	Installation of steel balustrade	S18. Construction of steel structures
YS7.	Addition of ramp at the south boundary of the plot for disabled access.	S28. Concrete Work

The details of the drainage channel and the east entrance gate to be agreed on a later stage.

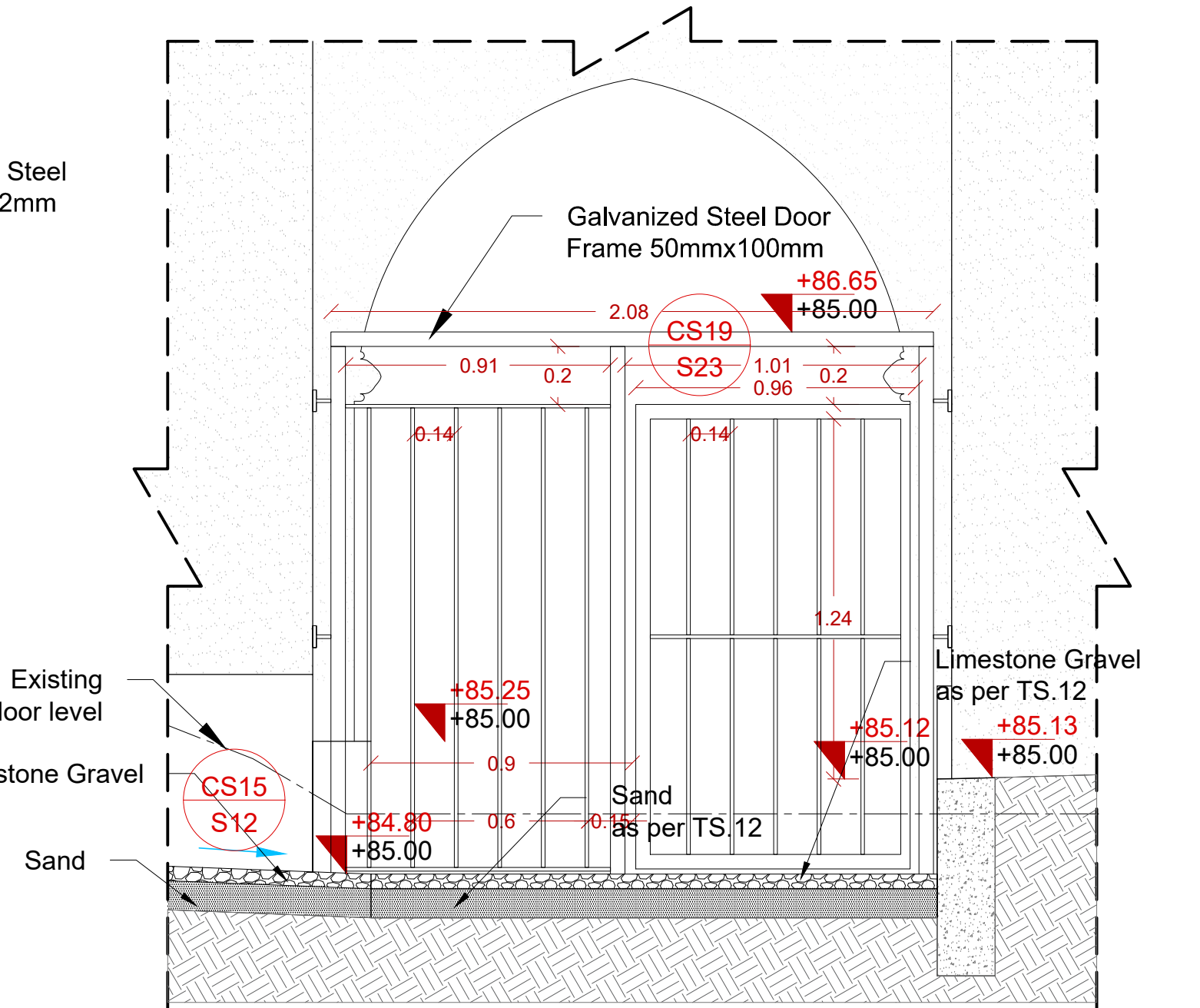

Section 2-2

<div><div></div><div></div></div>			
Project Title: Sourp Magar Monastery - Rehabilitation Plan and Conservation Designs			
Design:	Name:	Surname:	Licence no.:
Architect:	Zoe	Lordos	10907
Civil Engineer:	Andreas	Antoniou	71696
Designer Team: Senior Architect: Andreas Lordos Architects: Ioanna Anastasiadou, Enver Erenen, Christina Kleanthous Papademetriou, Constantina Hadjicosta Civil Engineer: Rezaivos Illampas Archaeologist: Anna Marangou			
Date:	28/02/2019	Scale:	1:20
Revision Date:	27/03/2019 08/04/2019 11/04/2019	24/06/2019	
Drawing Name: East Entrance: Disabled Access Ramp To Courtyard Detail - Final			Drawing no.: A-Pr 25