

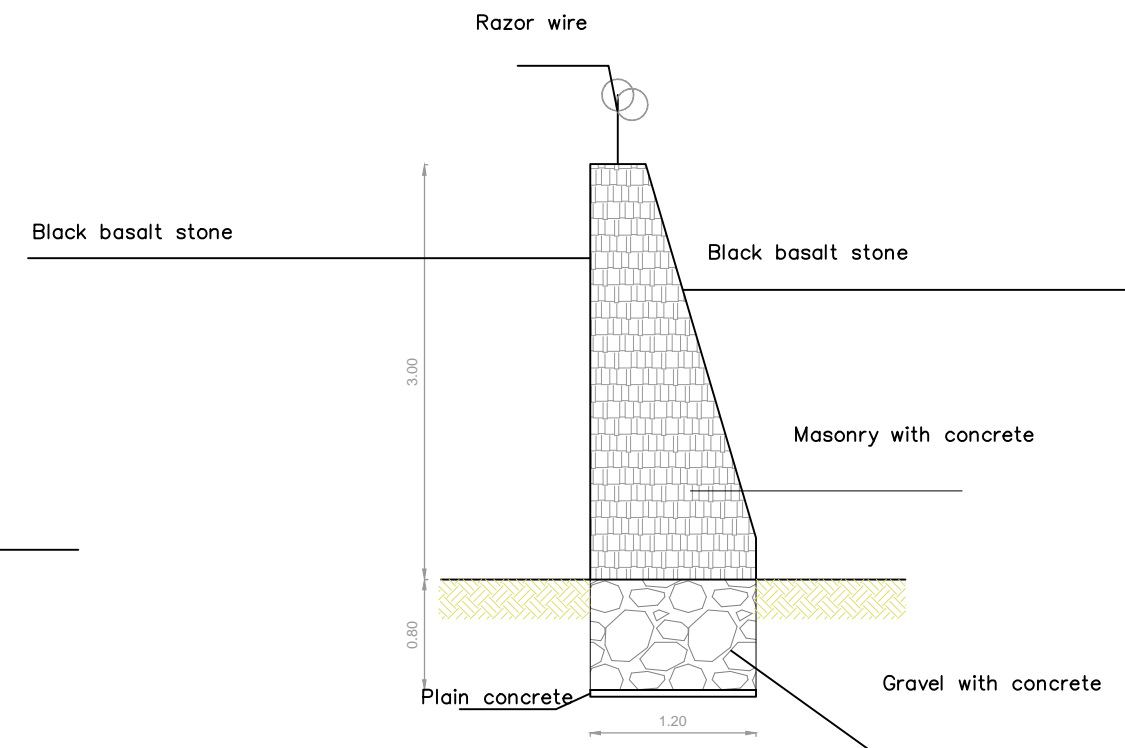

protection wall interfaces

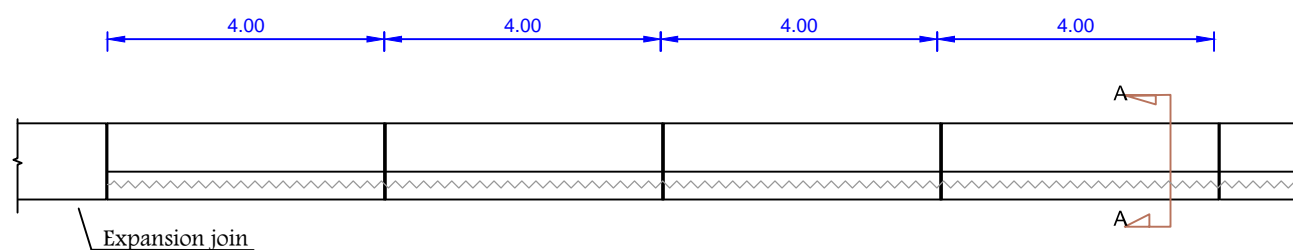

Section A-A



			
United Nations Development Programme			
		Studies and Design	
Project Name	New Outer Perimeter Entrance & Exit Arrangements		
Owner	UNDP		
Location			
Scale	1-100	NO DWG	1-1

Instructions

- 1—Building basalt stone resistor wall build a first class according to the technical specifications and instructions of the supervising engineer.
- 2— Implement expansion joints every 4 meters length and made 2 cm

