

Notes

1. GENERAL
- a. All dimensions given are approximate only, based on existing building. Contractor to verify dimensions on site and liaise with Architect when setting out.
- b. This drawing is to be read in conjunction with relevant structural, architectural and service engineering drawings.

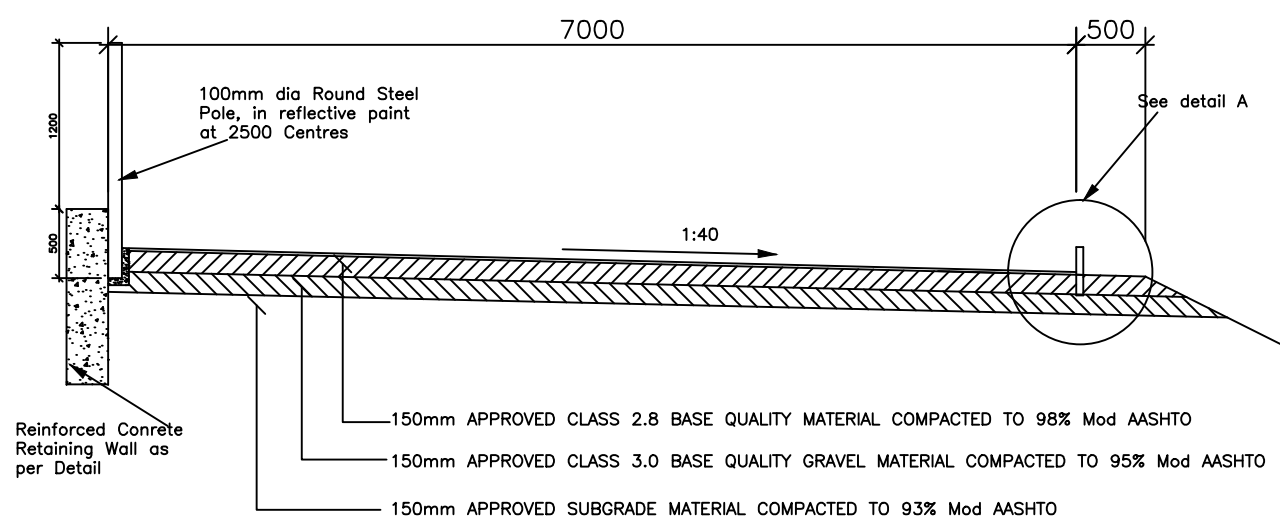

MAIN ACCESS ROAD FOR TRUCKS
CROSS SECTION
Scale 1:50

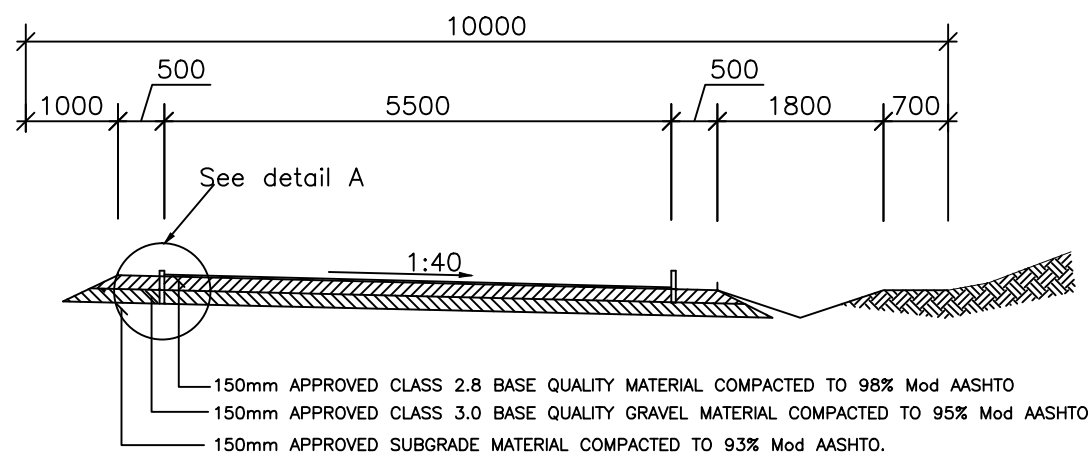

LIGHT VEHICLE ACCESS ROAD CROSS SECTION
Scale 1:50

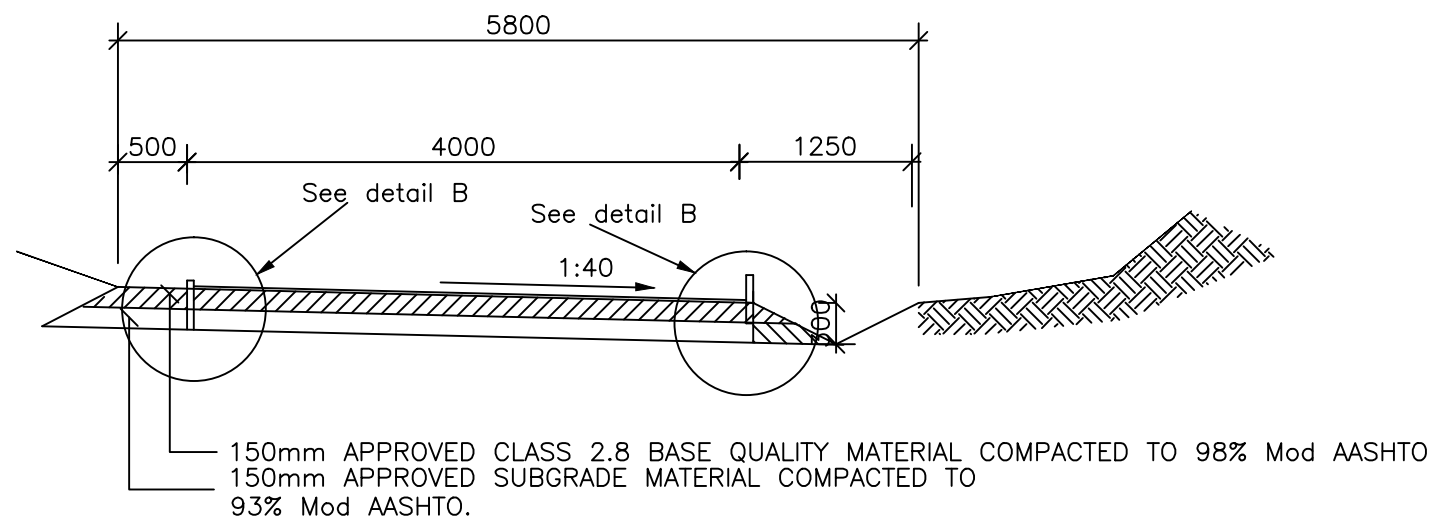

TYPICAL 4M LINK ROAD CROSS SECTION
Scale 1:50

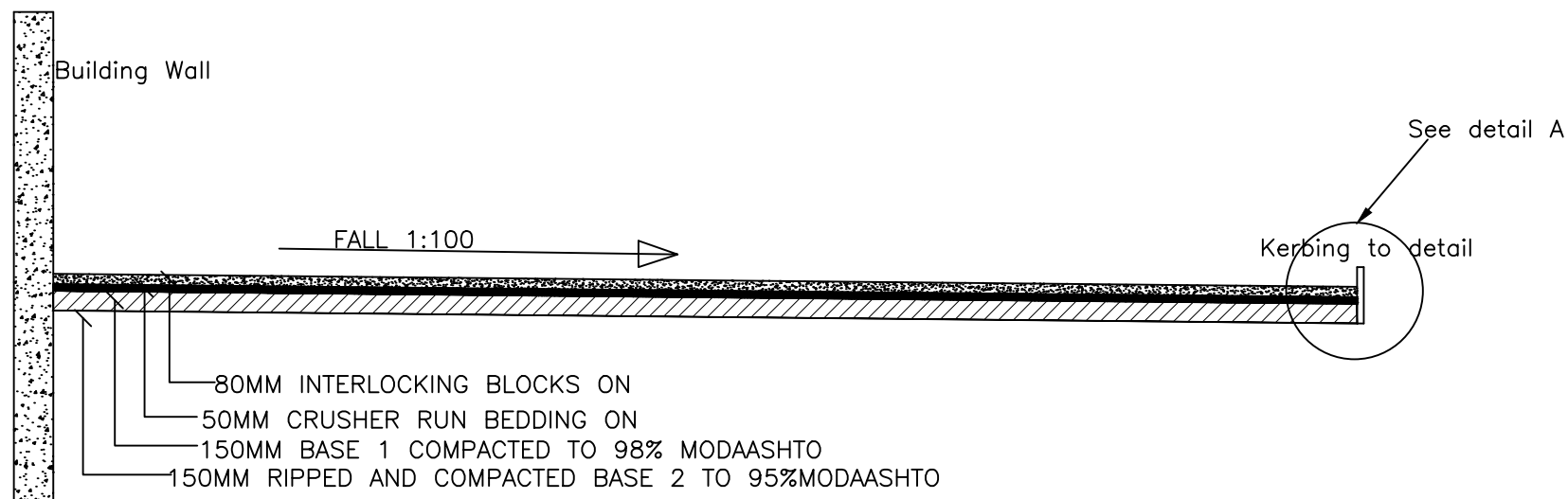

TYPICAL HARD STAND CROSS SECTION
Scale 1:50

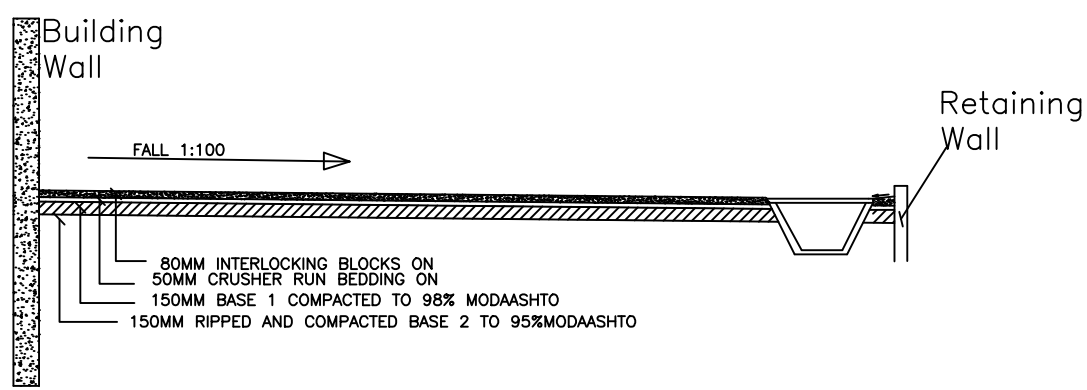

CROSS SECTION A-A
Scale 1:50

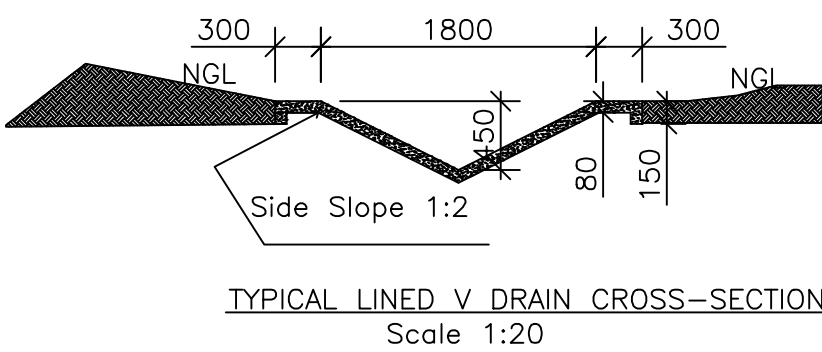
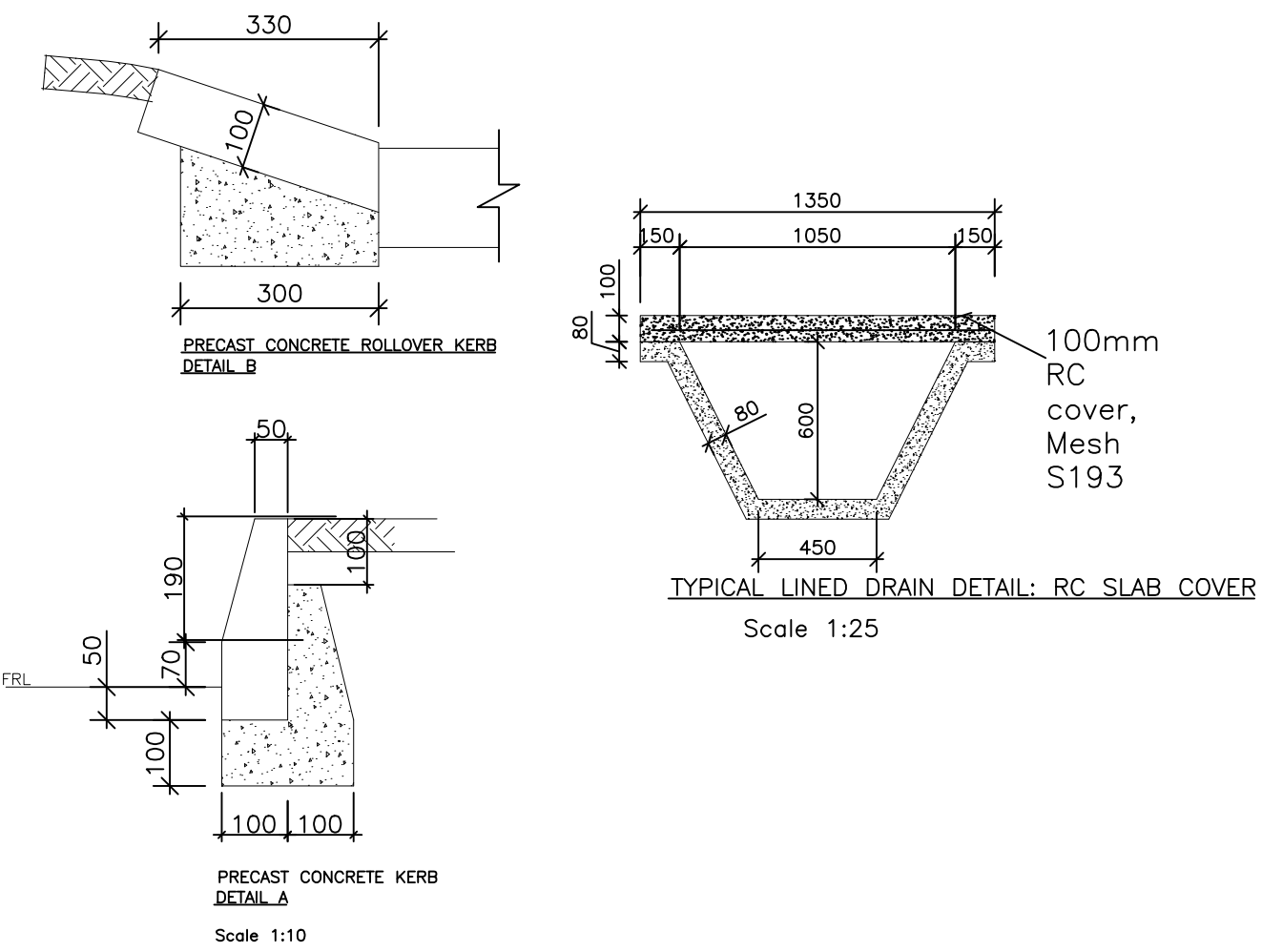

TYPICAL LINED V DRAIN CROSS-SECTION
Scale 1:20

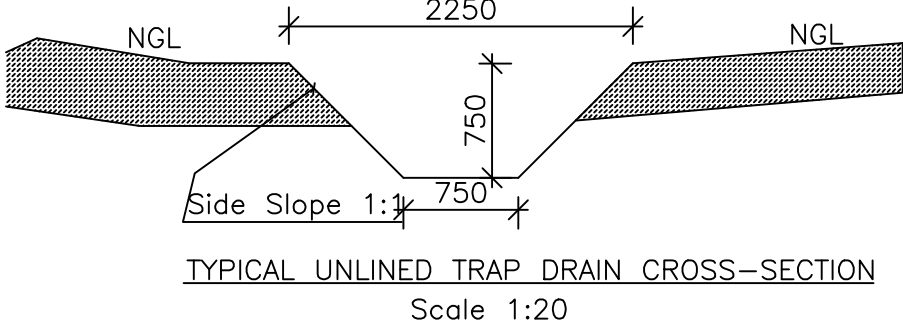

TYPICAL UNLINED TRAP DRAIN CROSS-SECTION
Scale 1:20

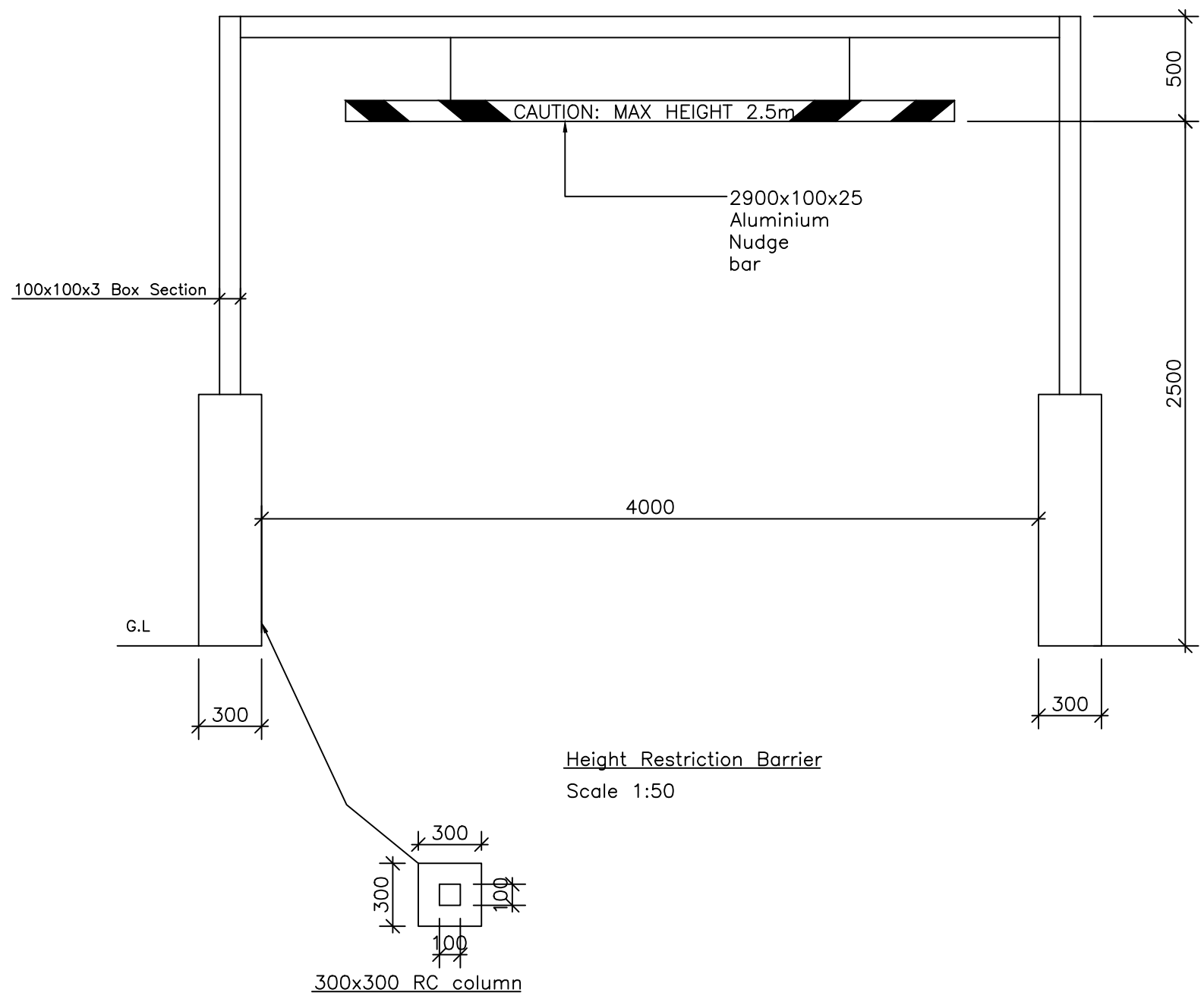

Height Restriction Barrier
Scale 1:50

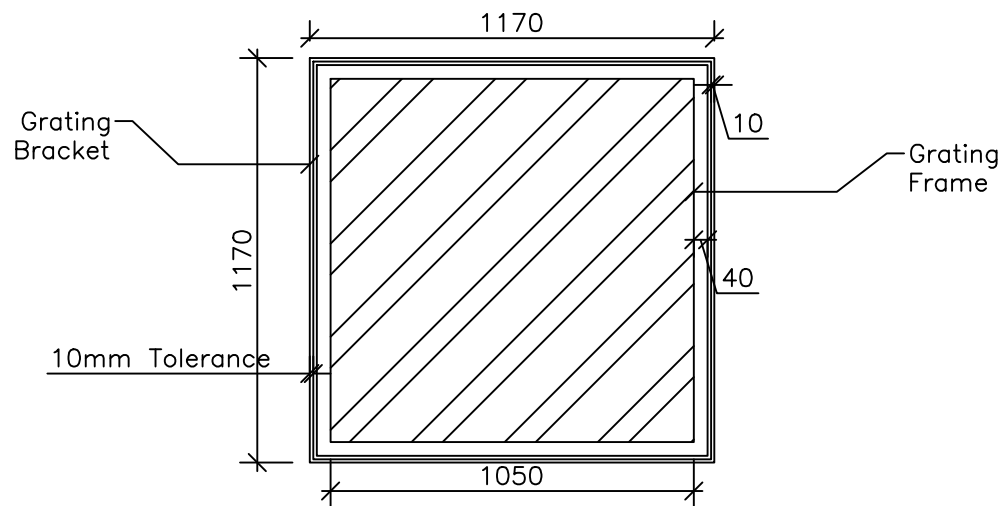

Plan Of Grating And Bracket
1:20

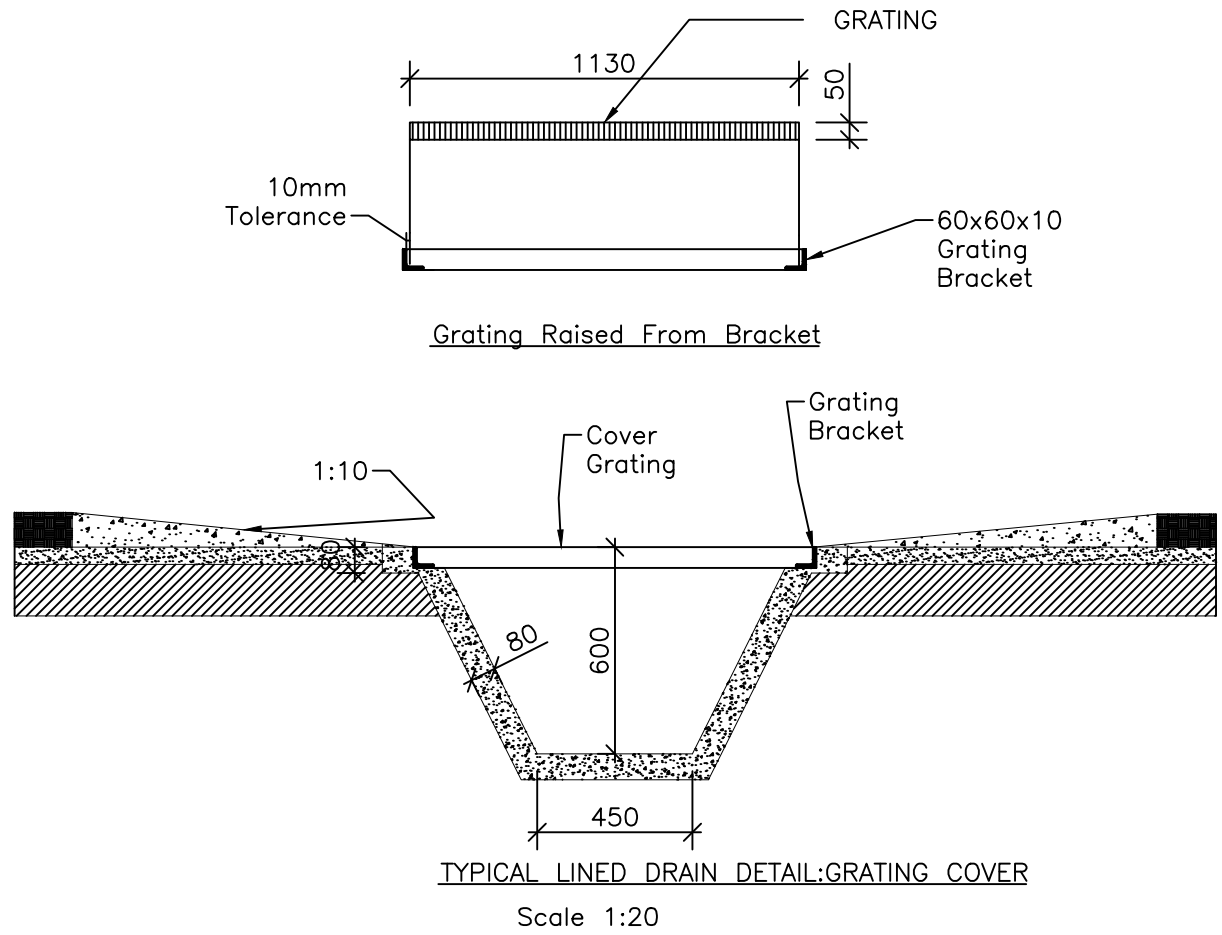

TYPICAL LINED DRAIN DETAIL: GRATING COVER
Scale 1:20

No. 14 Fereday Drive
Eastlea, HARARE
P O Box 187 Union Avenue
HARARE
Zimbabwe



Tel: +263-4-74712/255,78801
Fax: +263-4-747824
Cell: 0772 545883 / 0774 164140
admin@cgmenigneers.co.zw

Drawing No.
1601 C102-2
Revision

Amendment			Description
Ltr.	Date	Init.	

Micro-Film
Drg. No.

Client:



MINISTRY OF LOCAL
GOVERNMENT, PUBLIC
WORKS AND NATIONAL
HOUSING, MAKOMBE
BUILDING, PRIVATE BAG
1705, CAUSEWAY,
HARARE



Engineer	CGM	Branch Head	Mr. Njome
Designed	CGM	Scale	1:500 on A1
Drawn	CGM	Date	February 2016
Checked		File Ref.	
TELEPHONE 704561			

Department	Health and Child Care	Centre	Harare
Project	Proposed NatPharm Distribution Centre on Stand 3163, Southerton, Lobengula Road		
Description	Roads and Stormwater Standard Details		
Stock Dwg. No.		G.P. No.	
Proj. No.		Amidt Ltr.	