

FRONT ELEVATION

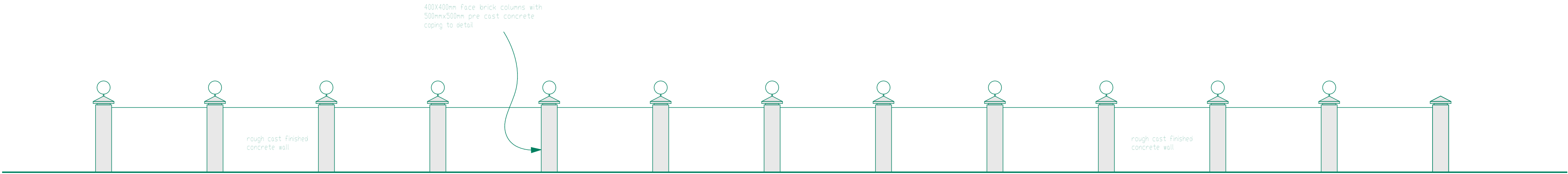

REAR ELEVATION

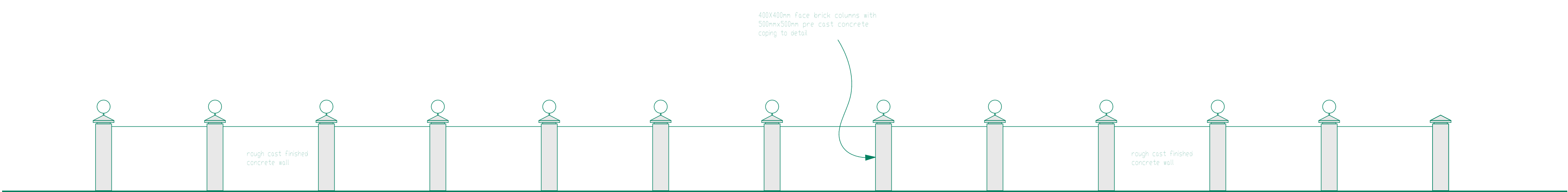

RIGHT SIDE ELEVATION

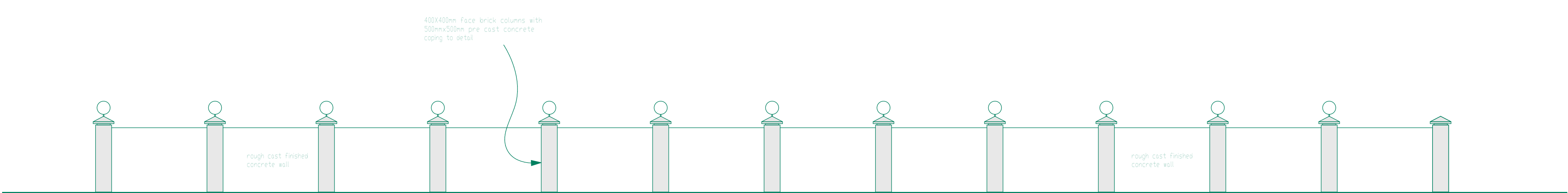

LEFT SIDE ELEVATION

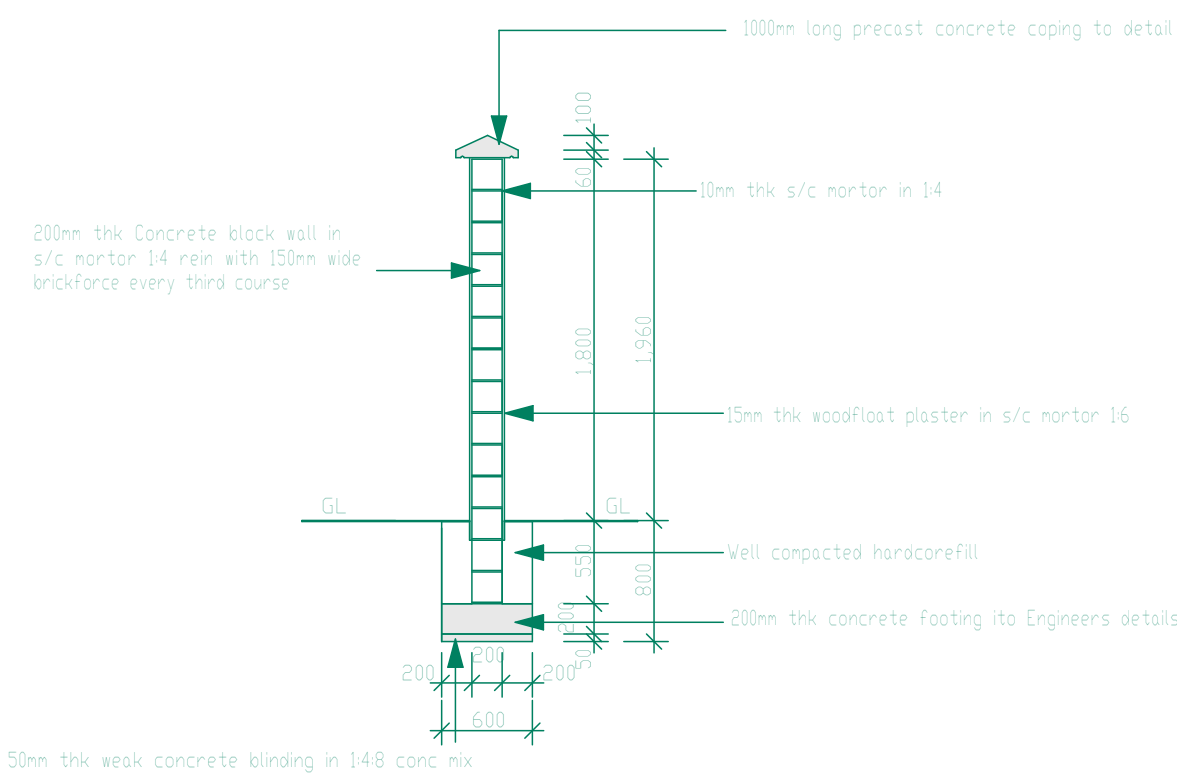

SECTION ACROSS BOUNDARY WALL PANEL

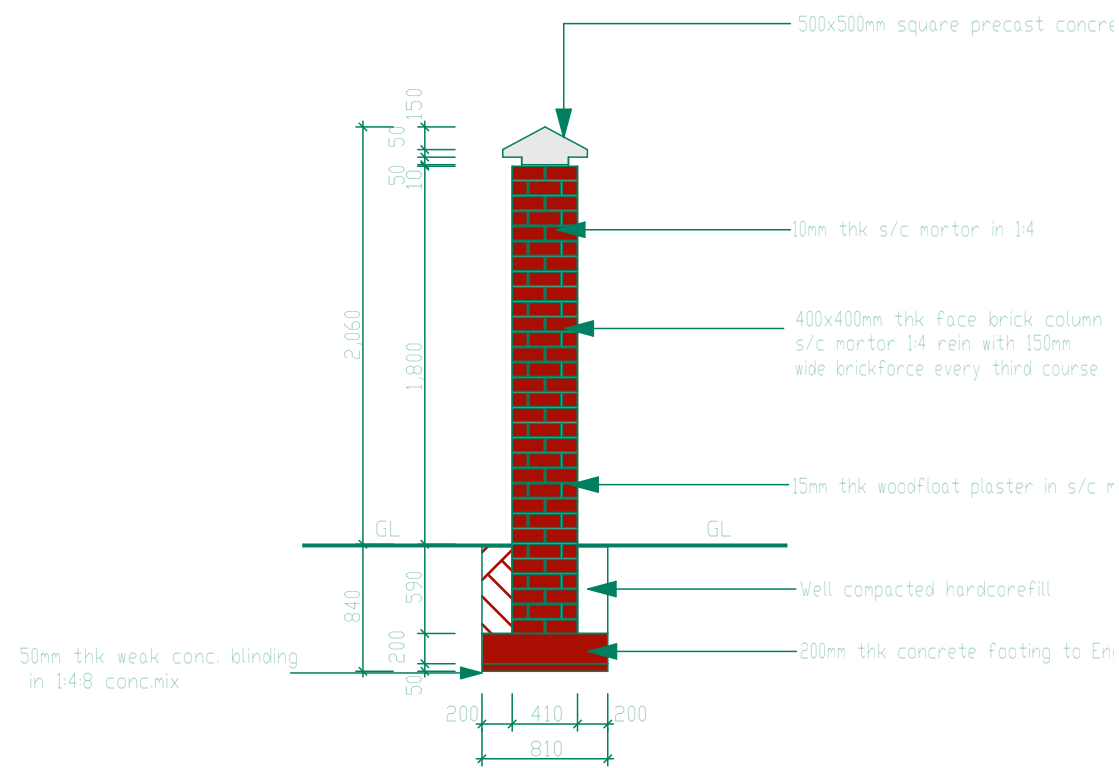

SECTION ACROSS COLUMN

THIS DRAWING IS COPYRIGHT

1. ALL LEVELS AND DIMENSIONS TO BE CHECKED ON SITE
2. THIS DRAWING TO BE READ IN CONJUNCTION WITH SPECIFICATIONS AND ALL OTHER CONSULTANTS DRAWINGS
3. ALL ROOMS WITH EXTERNAL WALLS TO HAVE AIR BRICK VENTS
4. DRAWINGS SHOULD NOT BE SCALED, WORK TO FIGURED DIMENSIONS ONLY
5. ALL DIMENSIONS AND LEVELS ARE TO BE VERIFIED ON SITE BY THE CONTRACTOR BEFORE COMMENCING ANY WORK

Rev.No	Description	

Professor Albert Malama

LUSAKA
6th Floor Godfrey House,
Kabelanga Road,
P.O Box 33976,
Lusaka.
Tel: +260211238150 | Fax: +260 211238102

KITWE
2nd Floor, Suite 330
Mukuba Pensions House
Cnr President Ave & Katanta St.
P. O. Box 21144
Tel +260-212-222302

Project

PROPOSED INCINERATOR FOR UNDP

Client

UNDP LUSAKA ZAMBIA

Drawing

**BOUNDARY WALL –
ELEVATIONS AND SECTIONS**

Purpose

**FOR
APPROVAL**

Scale: 1:750	Date: MAY 2016
Drawn by: T.M.	
Checked By: KK	
Project No:	
Drawing No:	