



THIS DRAWING IS A COPYRIGHT. DO NOT SCALE FROM THE DRAWING. THE CONTRACTOR AND HIS SUB-CONTRACTORS ARE TO VERIFY ALL DIMENSIONS ON SITE BEFORE MAKING SHOP DRAWINGS OR COMMENCING MANUFACTURE.

United Nation Development Programme
UNDP Lebanon
Social and Local Development Program
P.O.Box: 11-3216 Beirut, Lebanon
Tel: 961 1 962491

PROGRAMME:
Lebanese Host Communities
Support Programme
Support to Integrated Services
Provision at the Local Level

PROJECT NAME:

GHAZIEH PUBLIC GARDEN

LEGEND

NOTES:

REV	BY	Date	Description	App
0	---	--	GENERAL REVISION	--

PROJECT PHASE	EXECUTION
DISCIPLINE	CIVIL ENGINEERING
SECTOR	

DESIGNED	--
DRAWN	--
CHECKED	--
APPROVED	
DATE	29 JUNE 2016

GHAZIEH PUBLIC GARDEN
GENERAL STRUCTURAL DETAILS

Sheet 1 OF 1

GP-TD-ST-01-REV.0

Project Number	Phase	Type	Drawing Number	Revision
----------------	-------	------	----------------	----------

- [illegible]

[illegible]

- [illegible]

- [illegible]

5- CONCRETE

- | QUESTION | ANSWER |
|---|--|
| 1. What is the primary purpose of a business plan? | To provide a clear picture of the business and its future, to guide decision-making, and to attract investors or lenders. |
| 2. What are the key components of a business plan? | Executive Summary, Company Description, Market Analysis, Organization & Management, Products & Services, Marketing & Sales Strategy, Financial Projections, and Appendix. |
| 3. Why is market research important in a business plan? | It helps identify the target market, understand customer needs, and assess the competitive landscape, which is crucial for developing a viable business strategy. |
| 4. How should financial projections be presented? | They should be presented clearly and honestly, showing both potential and risks. Key metrics like revenue, expenses, and profit should be detailed over a 3-5 year period. |
| 5. What is the role of the executive summary? | It provides a concise overview of the entire business plan, highlighting the most important points to catch the reader's attention. |
| 6. How can a business plan be used to secure funding? | It serves as a tool to communicate the business's value and growth potential to potential investors or lenders, helping them make informed decisions. |
| 7. What are some common mistakes to avoid when writing a business plan? | Lack of research, unrealistic financial projections, vague descriptions, and neglecting to update the plan as the business evolves. |
| 8. How often should a business plan be updated? | It should be reviewed and updated annually or whenever there are significant changes in the business environment or internal operations. |
| 9. What is the importance of a clear vision and mission statement? | They provide a sense of direction and purpose for the business, guiding all strategic decisions and actions. |
| 10. How can a business plan help in managing the business? | It acts as a roadmap, allowing the owner to track progress, identify areas for improvement, and make data-driven decisions. |

3- REINFORCING STEEL

- [illegible]

FOR STANDARD END HOOKS

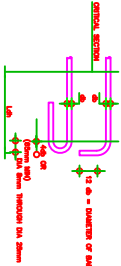

7- STRUCTURAL SOLID SLABS

1. ALL REINFORCEMENT (BOTH TOP AND BOTTOM) SHALL BE SUPPORTED BY THE RAIRS AND CHAIRS AT PROPER HEIGHT AT A MINIMUM SPACING OF 800mm EACH WAY.

8- RETAINING AND BASEMENT WALLS

1. THE BALL IS PLACED AGAINST THE BALLS LATER IN THE ROLL AND ALL PLAYERS TO WHOM SUCH BALLS BELONG HAVE ATTACHED SUFFICIENT EVIDENCE.
2. WHEN A BALL IS PLACED TO PROVE SUCH BALLS BELONG TO A PLAYER, THE BALLS MUST BE PLACED TO PROVE SUCH BALLS BELONG TO A PLAYER.
3. WHEN A BALL IS PLACED TO PROVE SUCH BALLS BELONG TO A PLAYER, THE BALLS MUST BE PLACED TO PROVE SUCH BALLS BELONG TO A PLAYER.
4. ALL BALLS SHALL BE PLACED TO PROVE SUCH BALLS BELONG TO A PLAYER, THE BALLS MUST BE PLACED TO PROVE SUCH BALLS BELONG TO A PLAYER.
5. ALL BALLS SHALL BE PLACED TO PROVE SUCH BALLS BELONG TO A PLAYER, THE BALLS MUST BE PLACED TO PROVE SUCH BALLS BELONG TO A PLAYER.

9- WATERPROOFING SYSTEM

THE EXISTING REINFORCEMENT WATERPROOFING OF THE BASEMENT WALLS SHALL BE REMOVED AND PROTECTED IN ACCORDANCE WITH THE MANUFACTURER'S INSTRUCTIONS. THE WATERPROOFING OF CONCRETE ROOFS AND DOWNSPUTS SHALL BE IN ACCORDANCE WITH THE ARCHITECTURAL DETAILS AND THE TECHNICAL SPECIFICATIONS. THE TYPE OF REINFORCEMENT WATERPROOFING, THE MATERIAL COMPOSITION, THE NUMBER OF PLIES, AND THE METHOD OF APPLICATION AND PROTECTION, SHALL BE APPROVED BY THE TECHNICAL SUPERVISOR. THE PROTECTION SHALL BE INSTALLED IN ACCORDANCE WITH THE TECHNICAL SPECIFICATIONS, AND SHALL BE APPROVED BY THE SUPERVISOR BEFORE CONSTRUCTION.

11- CONSTRUCTION JOINTS

1. THE CONTRACTOR SHALL MARK HIS PROPOSED LOCATION OF THE CONCRETE PILING WITH STAKES AND CHAINS. THE LOCATION OF THE CONCRETE PILING SHALL BE LOCATED AS FAR AWAY AS POSSIBLE FROM THE EXISTING PILING AND SHALL BE LOCATED IN THE CENTER OF THE OLD COSE, AND AS APPROVED OR DIRECTED BY THE ENGINEER.
 2. THE CONTRACTOR SHALL PROVIDE 18"X18"X30" CONSTRUCTION DOWELS FOR THE BRIDGE SLAB AND CONCRETE SKEWERS WITH 1/2"X12"X12" NUTS AND WELLS.
- REMARKS: THE VERTICAL CONSTRUCTION DOWEL SHALL BE LOCATED AS APPROVED BY THE ENGINEER. THE CONTRACTOR SHALL PROVIDE 18"X18"X30" CONSTRUCTION DOWELS FOR THE BRIDGE SLAB AND CONCRETE SKEWERS WITH 1/2"X12"X12" NUTS AND WELLS.
- PURPOSE TO OBTAIN CONCRETE. ALL DOWEL SHALL BE TIED WITH A STEELWIRE TIE AND PROTECTED FROM CORROSION BY COATING WITH AN OIL. THE REQUIRED TENSION WAREHOUSE SHALL NOT LESS THAN 3000 PSI SHALL BE EXTENDED TO PROVIDE THE REQUIRED TENSION WAREHOUSE SHALL NOT LESS THAN 3000 PSI SHALL BE EXTENDED.

12- SHOP DRAWINGS

- [illegible]

13- STRIPPING TIME

1. PILES SHALL BE STRUCK ONLY UPON THE DIRECTION OF THE ENGINEER.
2. PILES SHALL RESULT IN A FULL STRUCTURE THAT CONFORMS TO FULL GRADE, LINE AND DIMENSIONS OF THE EMBANKMENT AS REQUIRED BY THE DESIGN DRAWINGS AND SPECIFICATIONS.