

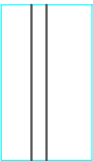

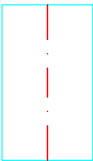



SHTRIMI I DYSHEMEVE DHE VESHJA E MUREVE  
FLOORS PAVING AND WALL COATINGS

LEGENDA / LEGEND

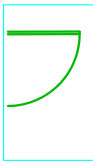
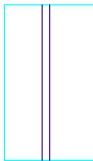
	Tuneli ekzistues Existed tunnel
	Aksi i Tunelit Tunnel ax
	Kuotat e matura Quantified quotes
	Dimensionet Dimensions
	Porte metalike Metalic gate
	Fuga Dilatacioni Distention joint
	Shenime Teknike Technical notes
	Zgare hekuri Lattice

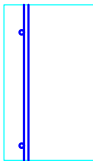
Titull i Projektit The Project	
PROVISION OF THE PROJECT DESIGN FOR THE UPGRADE OF PHYSICAL SECURITY OF THE MINISTRY OF INTERIOR (MoI) SMALL ARMS LIGHT WEAPONS (SALW) AND AMMUNITION STORAGE LOCATION MAIN SUPPLE CENTRE "MULLET" NEAR TIRANA	
Faza Phase	
PROJEKT ZBATIM DETAILED DESIGN	
Titull i Kapitullit Title Chapter	

"PROJEKTI NDERTIMOR" "CONSTRUCTION PROJECT"		
Grupi i Projektimit / Design group		
PUNOI	Ing./ Eng	YLLI KARAPICI
PUNOI	Ing./ Eng	ARMOND KURTI
PUNOI	Ing./ Eng	KUJTIM PROSEKU
JANAR 2019/ JANUARY 2019		
Numri i Pjeses Sheet Designation		
FLETA I - 00		

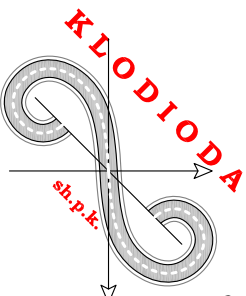
Porositës Request		Vula Seal	
		Autor Author	
U.N.D.P. "Skenderbej" Street, Gurten Building, 2nd Floor. Tirana - Albania Tel.: +355 (4) 2250 205, 2250 224, 2250 234 Fax: +355 (4) 2250 286, 2250 289		Vula Seal	
			
		"KLODIODA" SH.P.K. Rr.Barrikadave P.118 Katë III, Zyra Nr.2 Tiranë - Shqipëri klodioda@gmail.com klodioda@yahoo.com	
		Vula Seal	

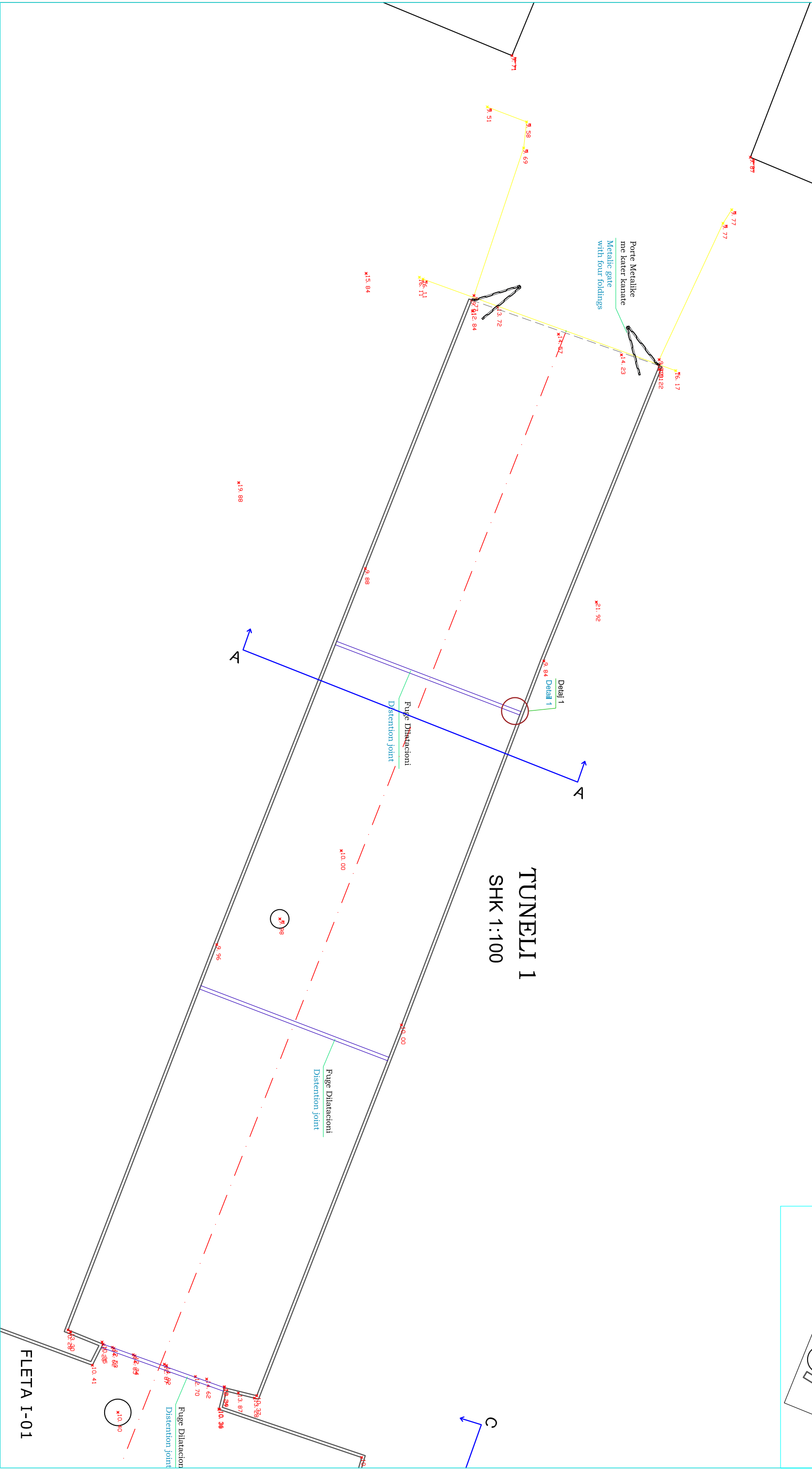
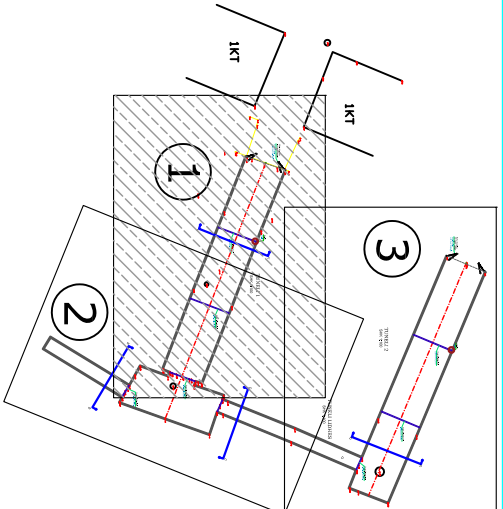

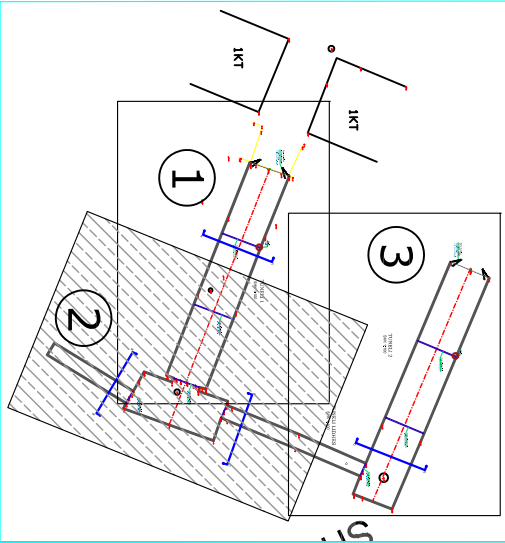

TUNNEL 1  
SHK 1:100

TUNNEL LIDGES  
SHK 1:100

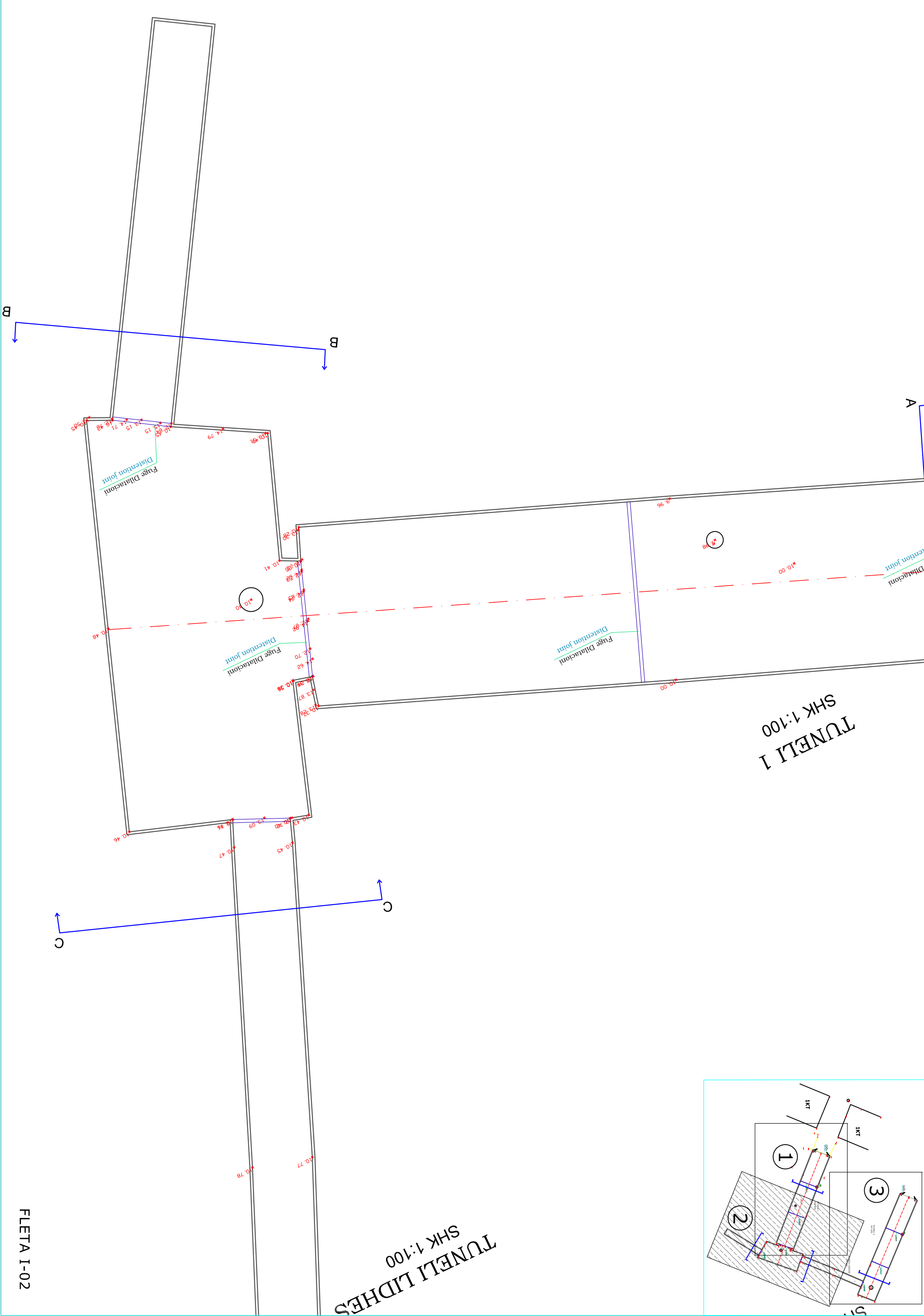

# PRERJA A-A

## SHK 1:100

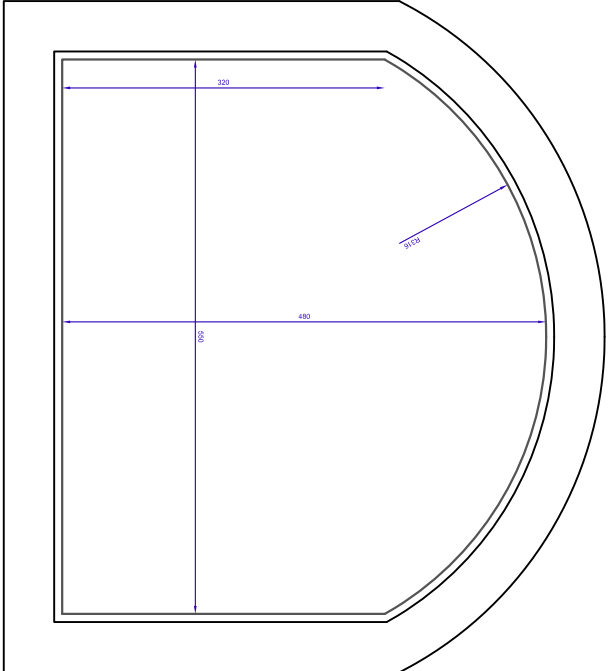

Shtetimi 1:  
**Shtetimi i dymshemese:**  
Fillimisht do te behet pastirimi i dymshemese dhe heqja e pjeseve te demtuara te betonit. Me pas te behet shtirimi i dymshemese me Beton C7/10 per nivelimin e saj. Pas nivelimit te vendoset zgara metalike me hektor periodik Ø8mm 15x15cm. Ne dy anet e tunelit dhe prane fugave, shufrat e zgares te kthehen 15cm. Xhunitimi i shufrave te zgares te behet me gjatesi 40cm. Me pas do te behet betoni i dymshemese. Dymshemja do te shtrohet me beton C25/30 me trashesi 8cm. Siperfaqja pas nivelimit do te trajtohet me kreher. Ne zonat e fugave dhe konturet anesore, siperfaqja do te behet e lenuar.

Shtetimi 2:  
**Ndetyrjet ne mure dhe tavanere:**  
Fillimisht do te behet heqja e tere suvatimit ekzistues ne mure dhe tavan. Me pas do te behet pastirimi i siperfaqes se betonit te tunelit me kompresor ajri. Pas pastirimit ne pjesen e tavanit (zona harkore e tunelit) do te vendoset rjeta e telit. Rjeta do te fiksohet ne beton me gozhde betoni 6cm dhe me rondele me diameter 3-4cm. Me pas do te behet sprucimi i siperfaqes me llac cimento 1:1. Pas sprucimit do te behet suvatimi i siperfaqes me llac i perzier M25. Pas suvatimit do te behet lyerja me boje hidromat me ngjyre te bardhe.

Note 1:  
**Floor paving:**  
Initially, it will be done the floor cleaning and removal of damaged parts of concrete. After that the floor will be paved with Concrete C7/10 for its leveling. After the floor leveling will be installed the steel hoop with periodic steel Ø8mm 15x15cm. In both sides of the tunnel and near the joints, steel rods have to be turned 15cm. Rods connection will be done in 40cm length. After those it will be done the floor concrete. The floor will be paved with concrete C25/30 with a thickness of 8cm. The surface after leveling will be treated with komb. In the joints zones and side countours, the surface will be smoothed.

Note 2:  
**Interventions in walls and ceilings:**  
Initially it will be done the total removal of existing plaster in walls and ceilings. To be continued with the cleaning of concrete surface of the tunnel with air compressor. After the cleaning in the ceiling zone (arched area of the tunnel) it will be put the lattice. Metal mesh will be fixed in concrete with concrete nail 6cm and with steel ring with diameter 3-4cm. After those it will be the surface spraying with plaster-cement 1:1. After the spraying it comes the surface plastering with mixed plaster M25. After plastering it will be done the painting with white hidromat paint.

# PRERJA B-B

## SHK 1:100

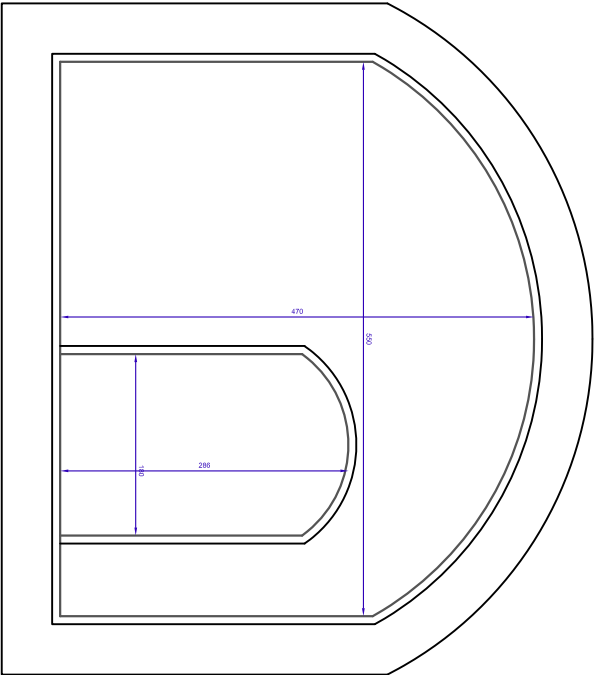

# PRERJA C-C

## SHK 1:100

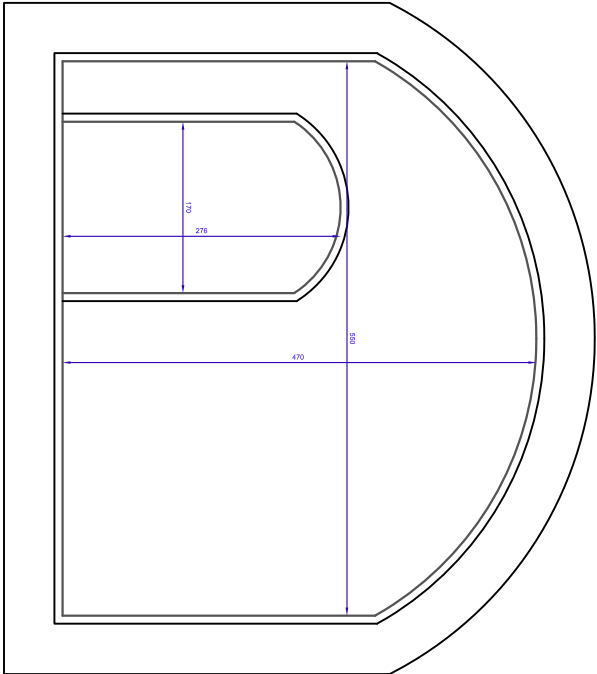

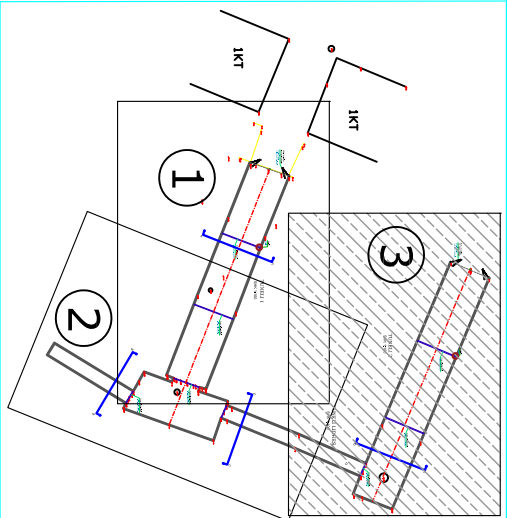

Porte Metallike  
me kater kanate  
Metallike gate  
with four foldings

\*10.25 62

\*1.80

\*13.79

Detail 1

Panel 1

Fuge Diftacioni  
Distention joint

TUNNEL 2  
SHK 1:100

Fuge Diftacioni  
Distention joint

\*11.12

\*11.14

\*11.28

\*19.21

\*13.65

\*15.40

\*11.943

\*15.52

\*14.32

TUNNEL LIDHES  
SHK 1:100

\*10.77

\*10.78

# PRERJA D-D

SHK 1:75

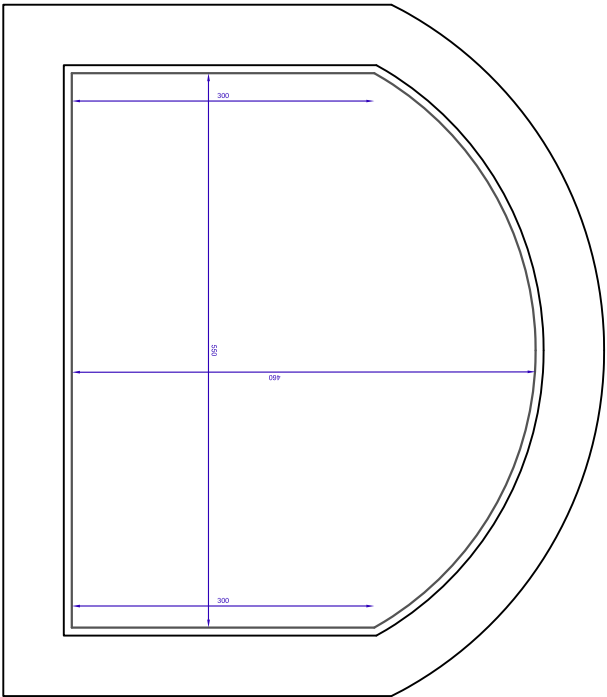

# ARMIMI I PRERJES D-D

SHK 1:75

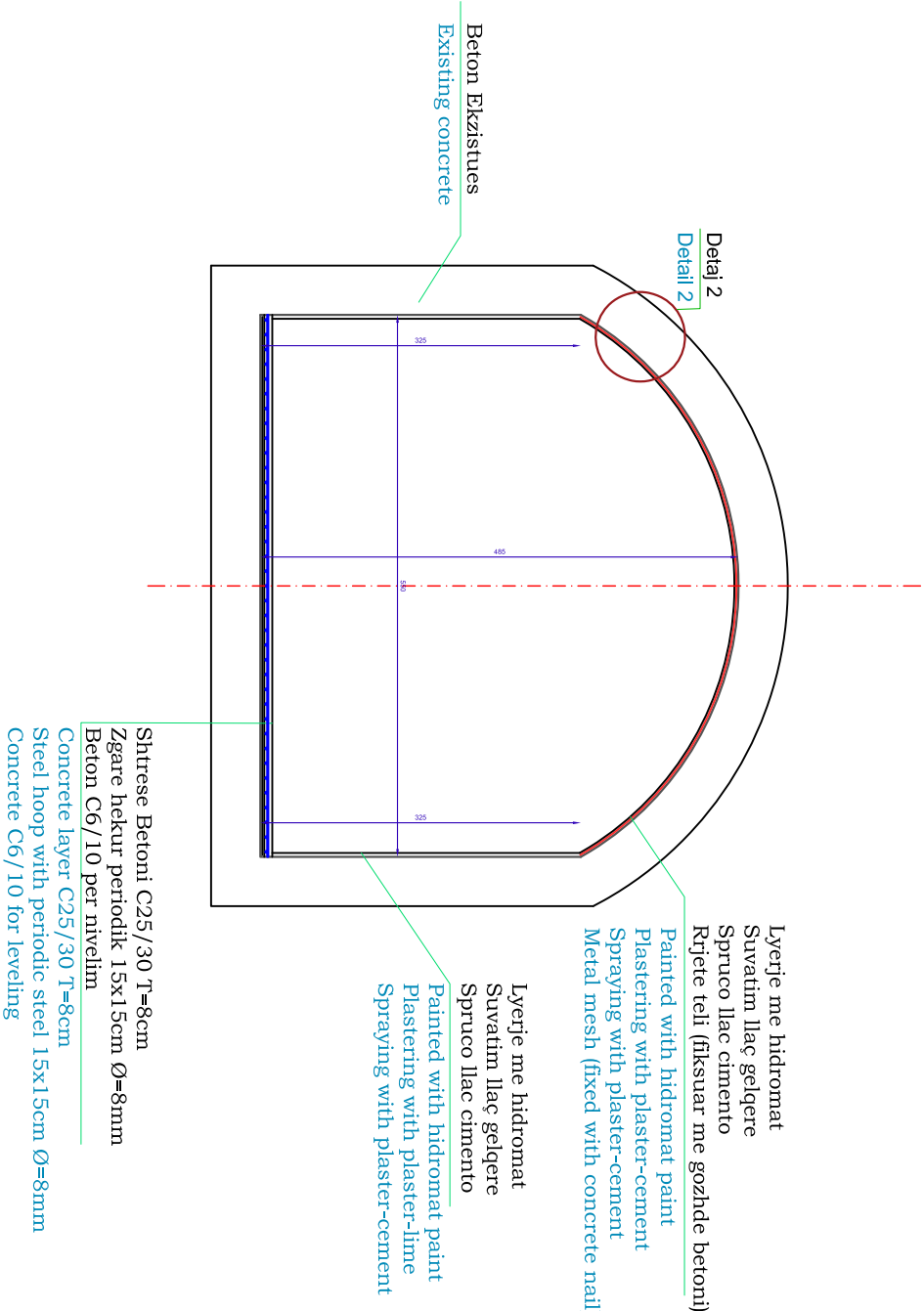

PAMJA BALLORE E PORTES  
SHK 1:30

GATE FRONT VIEW  
SC 1:30

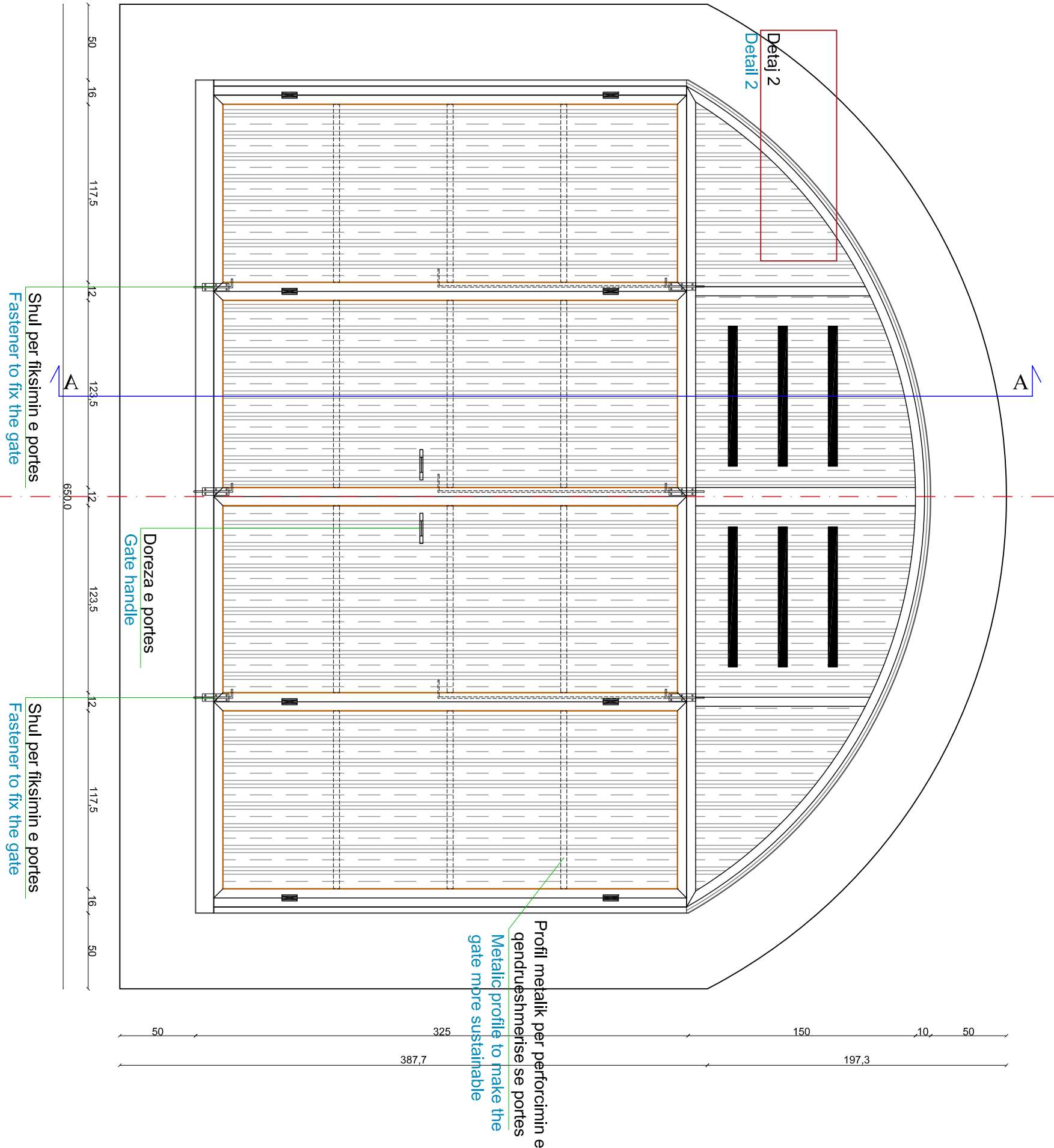

PRERJA A-A  
SHK 1:30

SECTION A-A  
SC 1:30

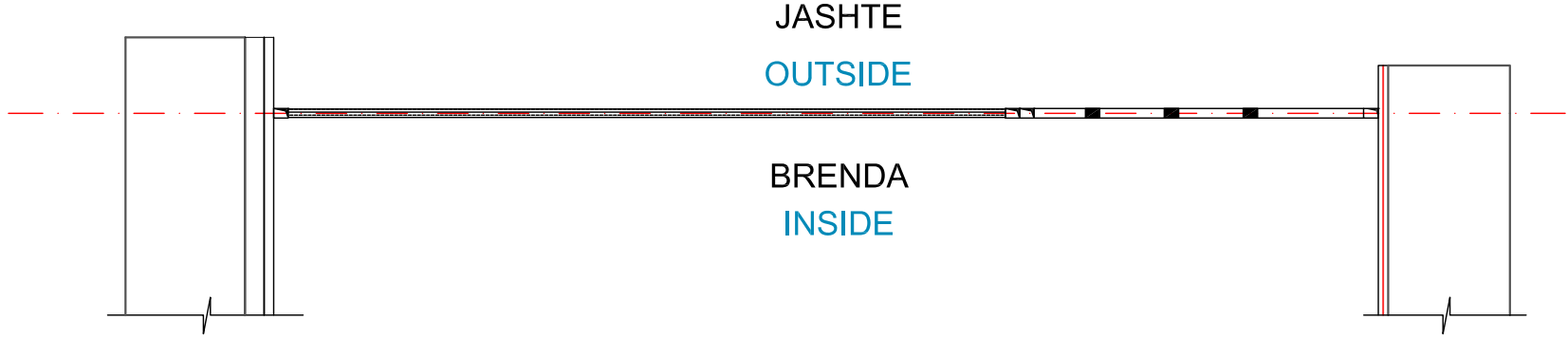

PLAN I PORTES  
SHK 1:30

GATE PLAN  
SC 1:30

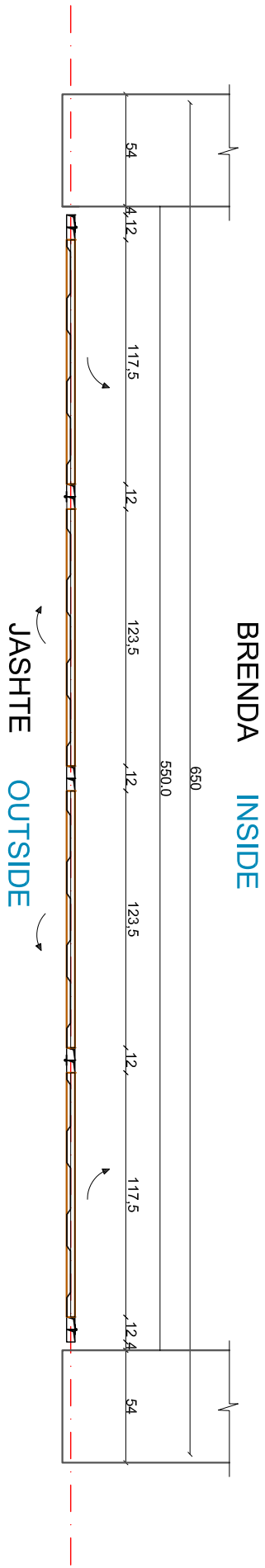

DETAIL I HAPJES SE PORTES  
SHK 1:30

DETAIL OF GATE OPEN WAY  
SC 1:30

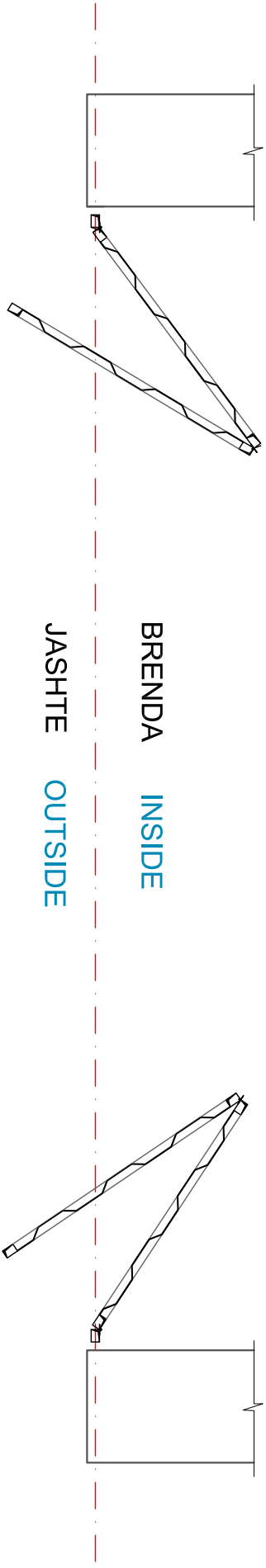



DETAILJ 1  
DETAILJ I DYSHEMESE SE BETONIT  
SHK 1:20

DETAIL 1  
DETAIL OF CONCRETE FLOOR PAVING  
SC 1:20

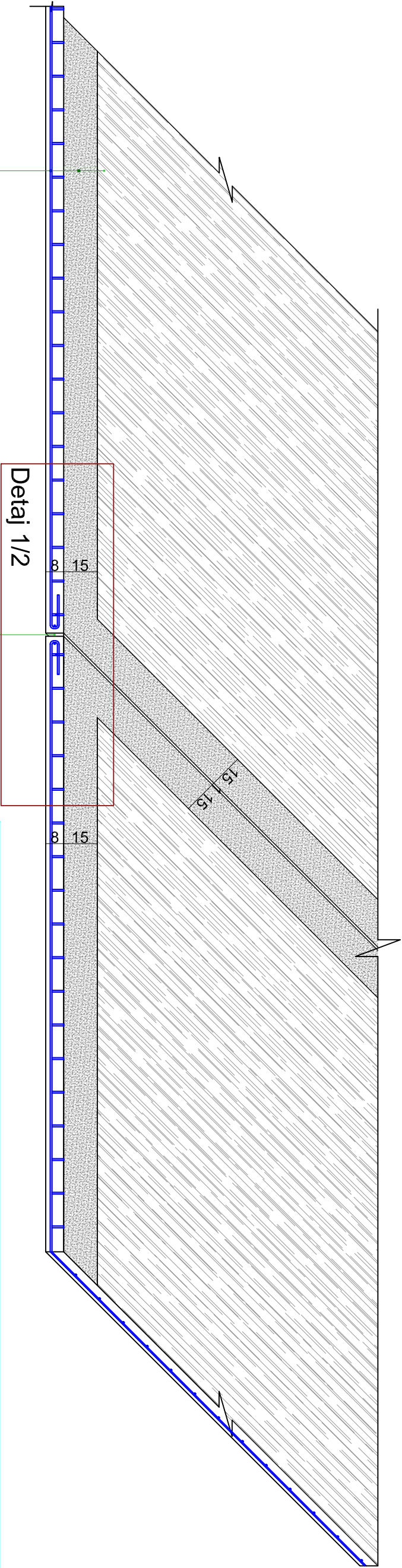

- Shtrese betoni e trajtuar me kreher
- Concrete layer treated with raker
- Shtrese betoni e lemuar
- Smoothed concrete layer
- Zgare metalike Ø8, 15x15 cm
- Lattice Ø8, 15x15 cm

Fuge 1cm  
Joint 1cm

DETAIL 1/2  
ZGARE METALIKE 15X15 CM-HEKUR Ø8 mm  
SHK 1:10

DETAIL 1/2  
LATTICE 15X15 CM-STEEL Ø8 MM  
SC 1:10

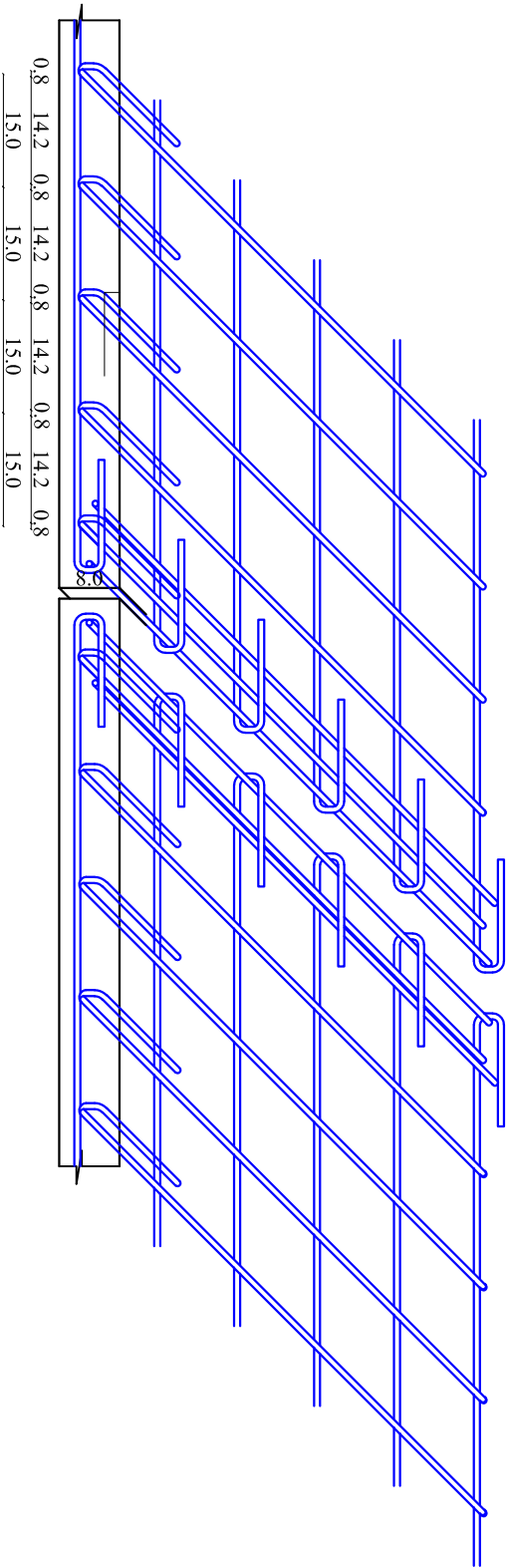

Imazh reference:Rrjete metalike  
Referenc image:Metal mesh



Imazh reference:Rrjete metalike dhe aplikimi i saj  
Referenc image:Metal mesh and its application



DETAJ 2  
DETAIL I SOLETES SE TUNELIT  
SHK 1:20

DETAIL 2  
DETAIL OF TUNNEL SLAB  
SC 1:20

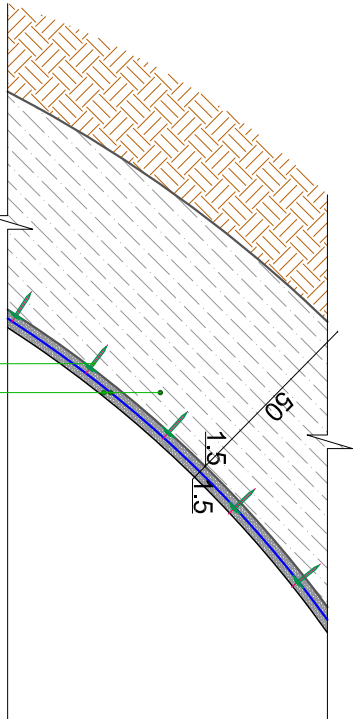

Tavani ekzistues i tunelit  
Tunnel existed ceil  
Rrjete metalike  
Metal mesh  
Shtrese suvatimi 3 cm  
Plaster layer 3 cm  
Gozhde betoni per fiksimin e rrjetes metalike  
Concrete nail for fixing the metal mesh

DETAJ 3  
DETAIL I MURIT TE TUNELIT  
SHK 1:20

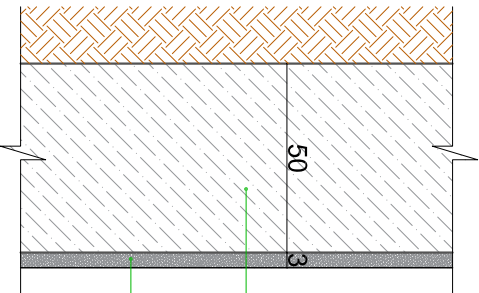

DETAIL 3  
DETAIL OF TUNNEL WALL  
SC 1:20

Muri ekzistues i tunelit  
Tunnel existed wall  
Shtrese suvatimi 3 cm  
Plaster layer 3 cm

Kendore  
Angular wall detail

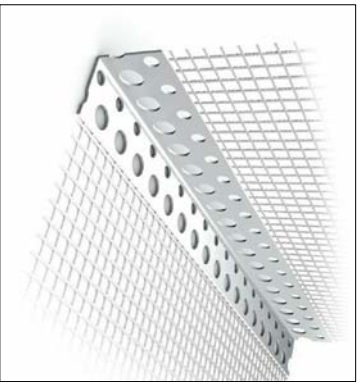

DETAJ 4  
PROFIL METALIK  
SHK 1:20

DETAIL 4  
METAL PROFILE  
SC 1:20

