

Annex B: Set of Drawings for Millet Earth Dam Rehabilitation

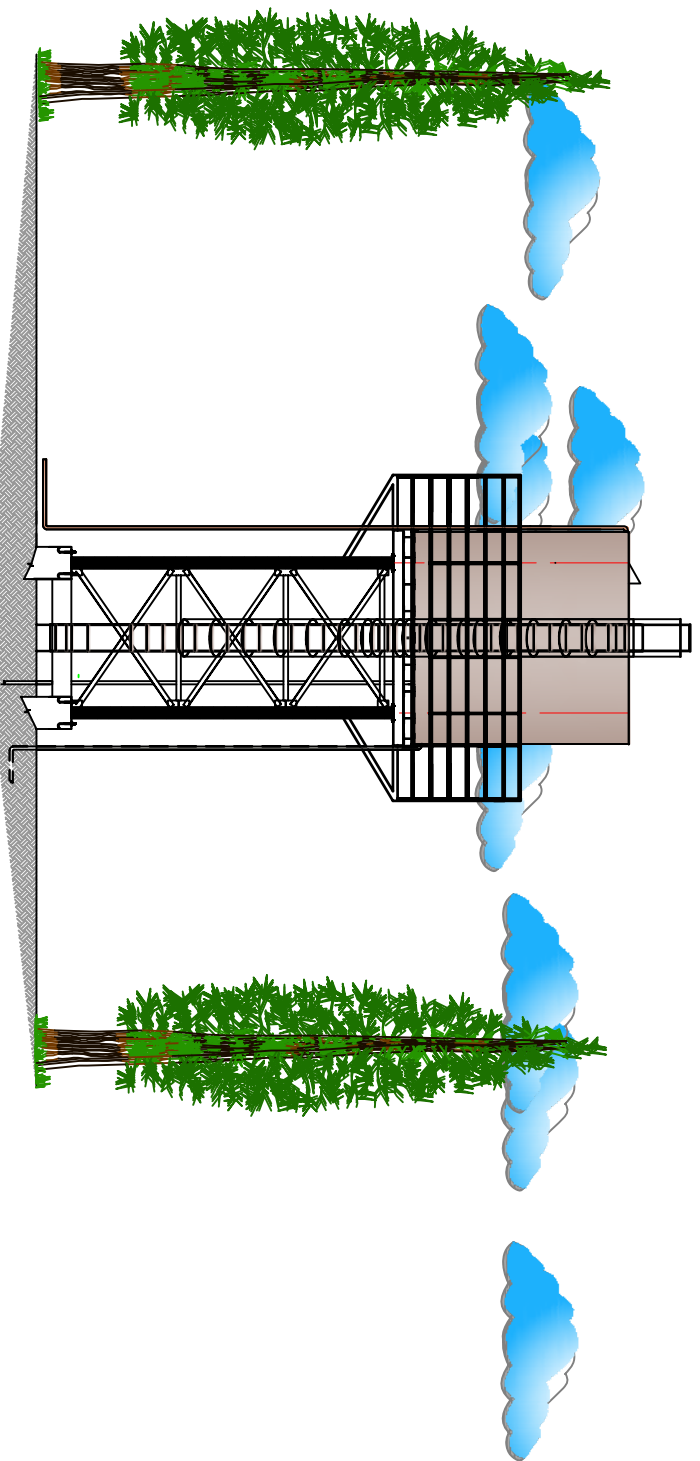

Millet Locality-North Darfur State

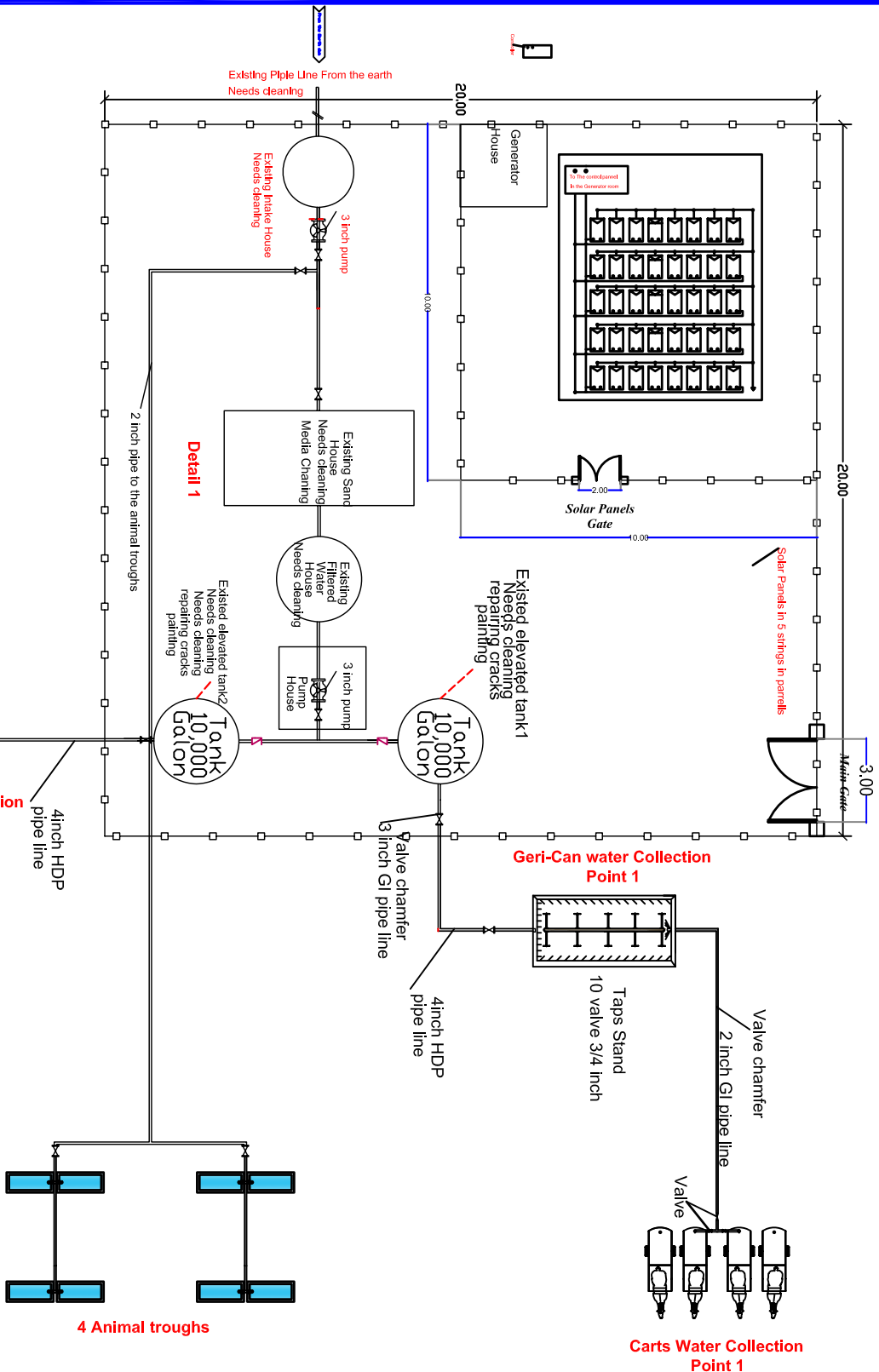

Legend

Valve 3/4 inch	
Valve 3 inch	
Pump 3 inch	
Non-return Valve	

Project :

Millet Earth Dam Rehabilitation

Content :

Water Tank Drawings

drawn By:

UNDP

May

2020

01

Gate Valve @500 meter from the water tank

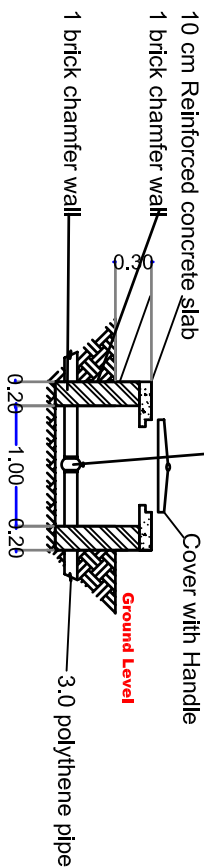

1.2m*1.2m Gate valve chamfer

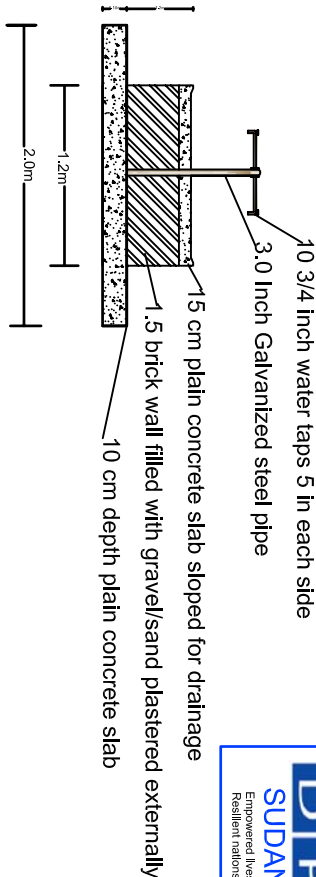

**WATER POINT
SECTIONAL VIEW**

3.0 inch High Density polythene pipe (HDPE)

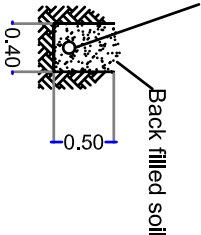

Main pipe trench and pipe

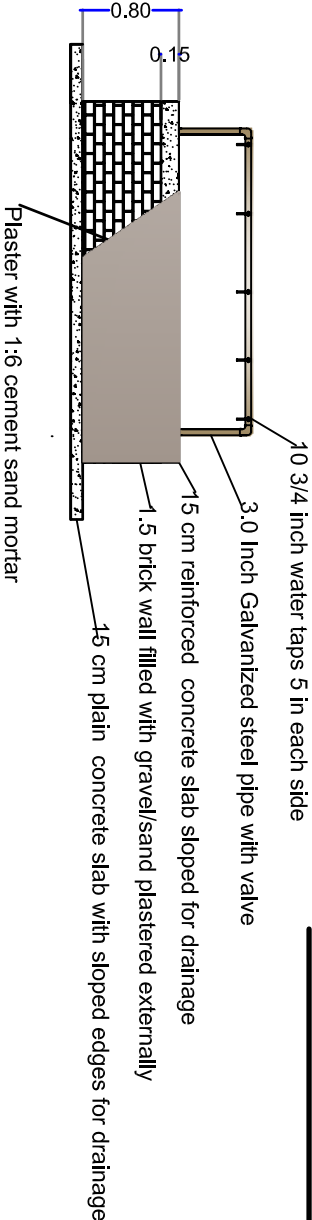

**WATER POINT
PLAN VIEW**

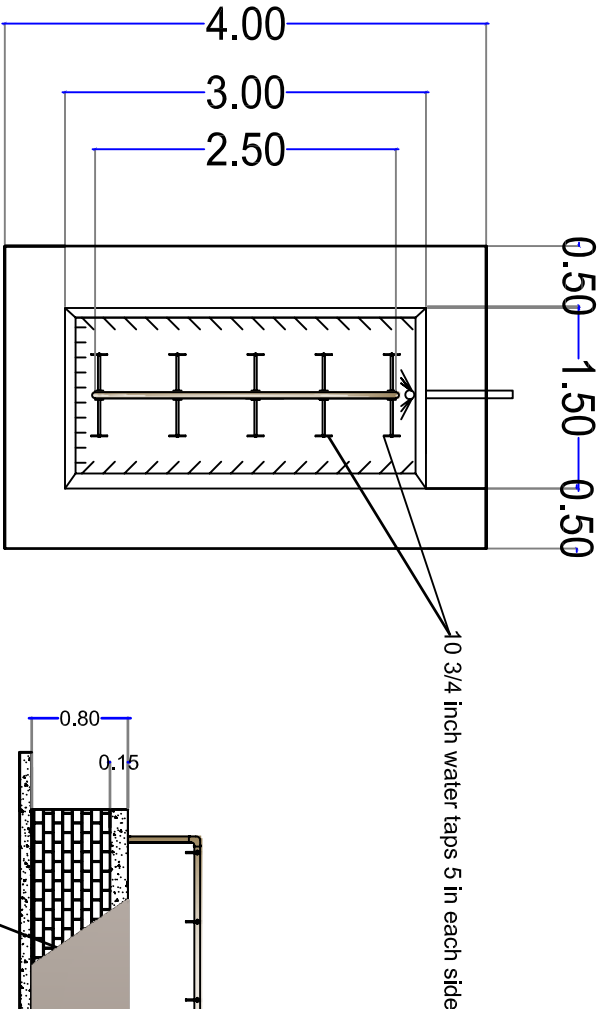

**WATER POINT
SECTIONAL VIEW**

Solar Panels in 5 strings in parrells

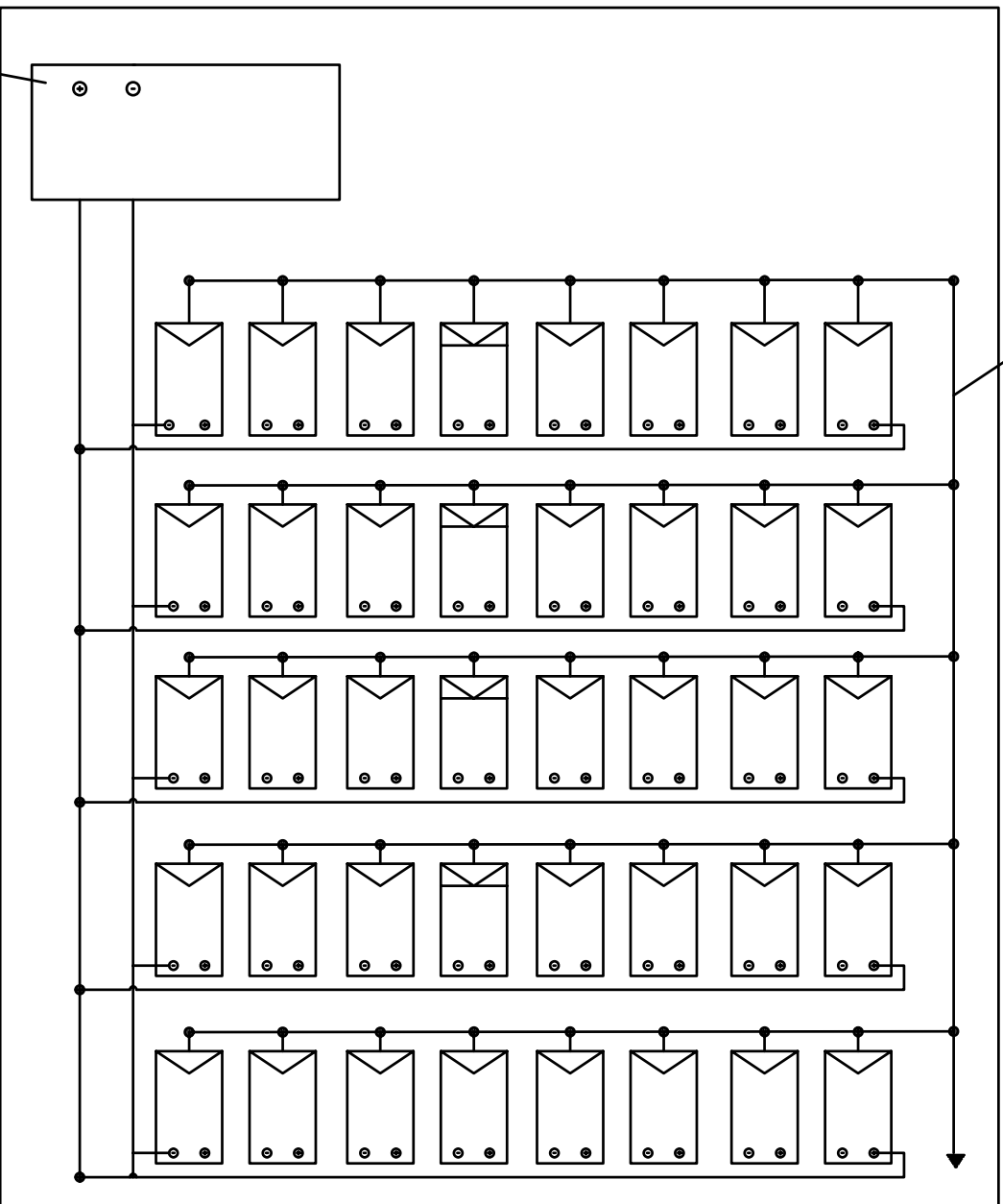

Controller

Note:

- The solar cell shall be mounted on galvanized stands
- The total output of the solar cells shall decided based on loads but should not be less 8 KVA
- The solar stands shall be fixed with plain concrete footings
- The solar cell be properly installed to manufacturers directions
- All electrical cables shall be through electrical pipes protected and trenched
- Bidder quoting for different arrangement or design has to state so and should provide all necessary information for evaluation
- the solar panels shall be attached to the frame properly in a manner to prevent being removed

Project :

Tura Earth Dam Rehabilitation

Content :

Solar Cells Wiring

drawn By:

Ahmed.M.Adam

May

2020

03



Note:

- The solar cell shall be mounted on steel / aluminum stands
- The total output of the solar cells shall be decided after pumping test but should not be less 3.5KW
- The solar cell be properly installed to manufacturers directions
- All electrical cables shall be through electrical pipes protected and trenched

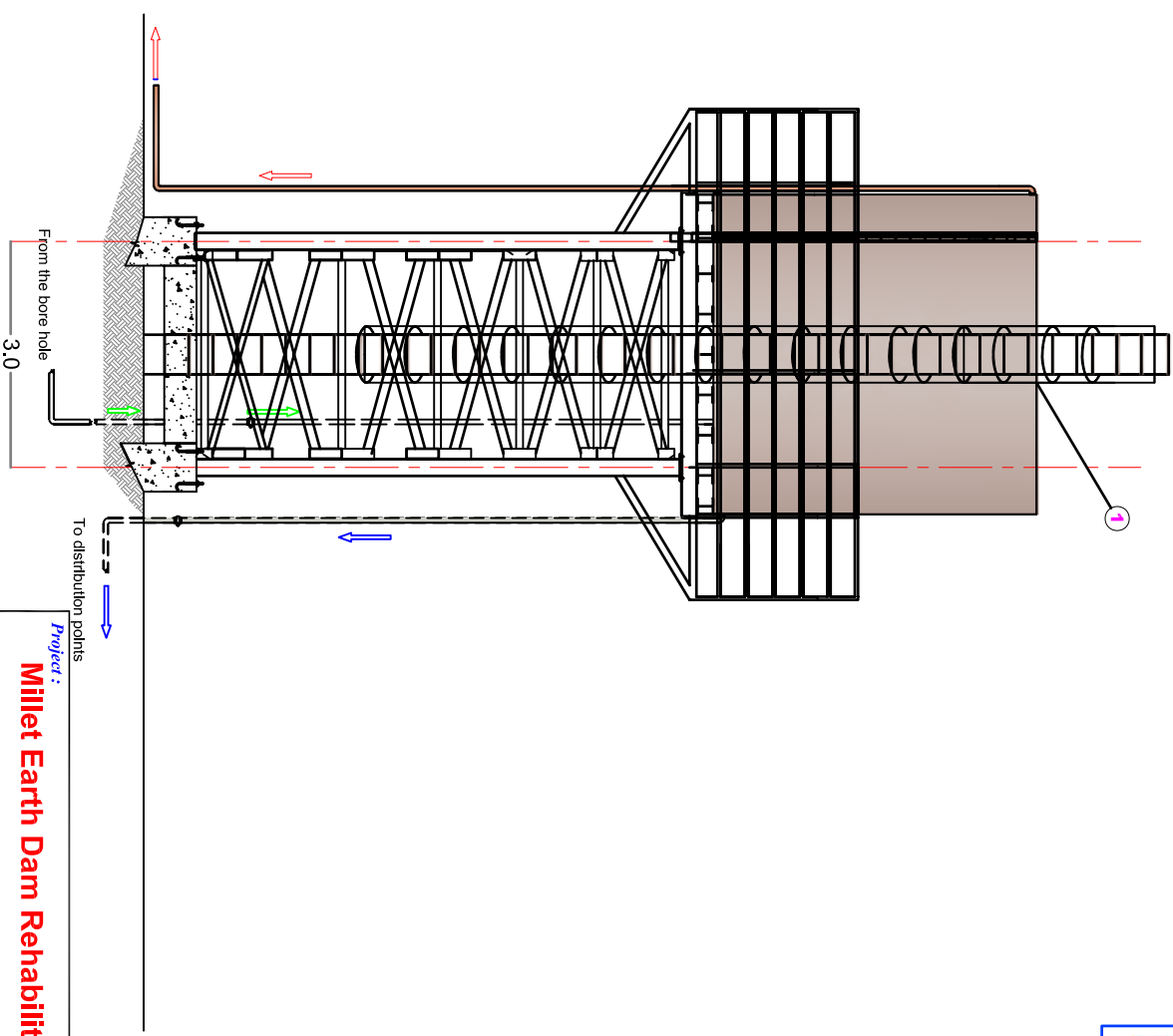
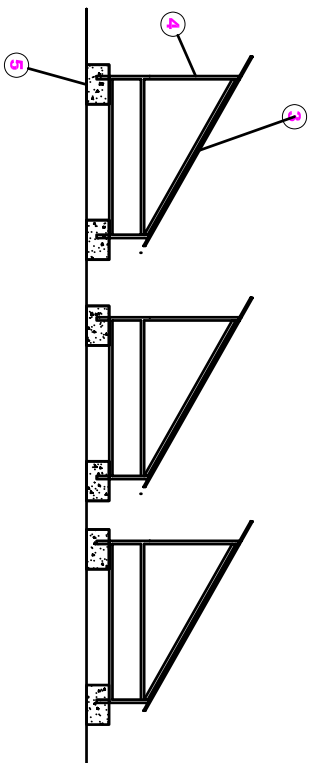

Project :
Millet Earth Dam Rehabilitation

Content :

Water tank drawings

drawn By:

UNDP

May
2020

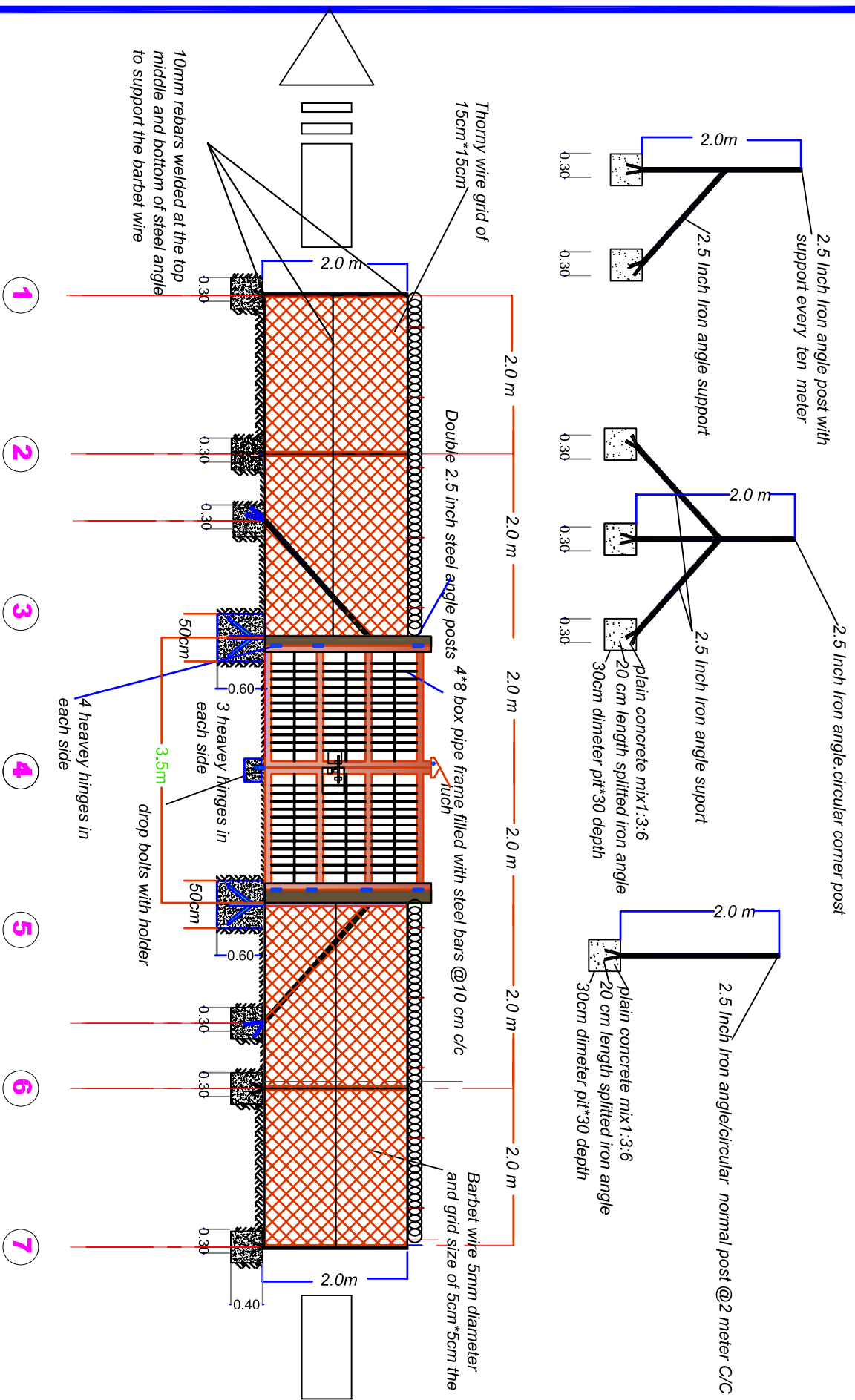

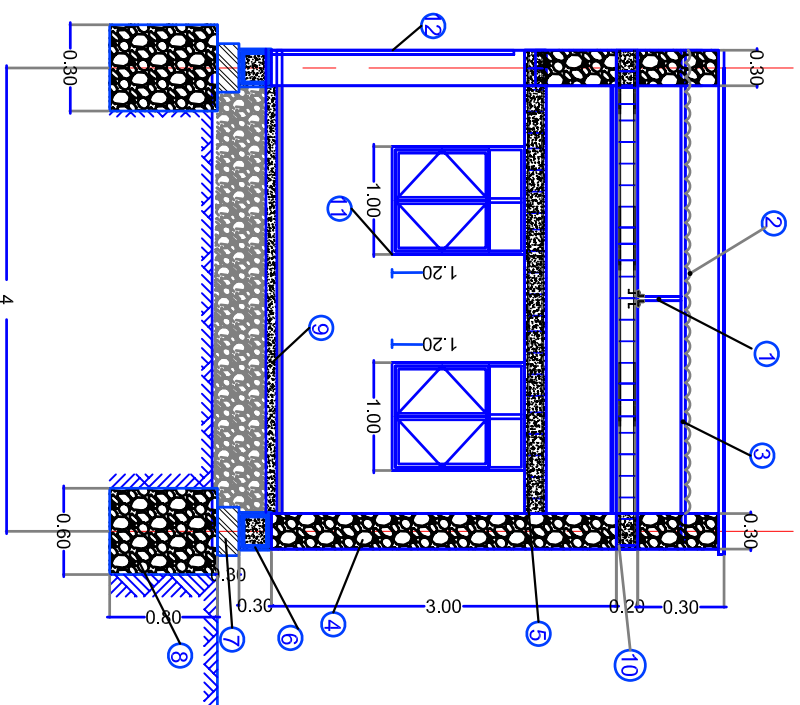
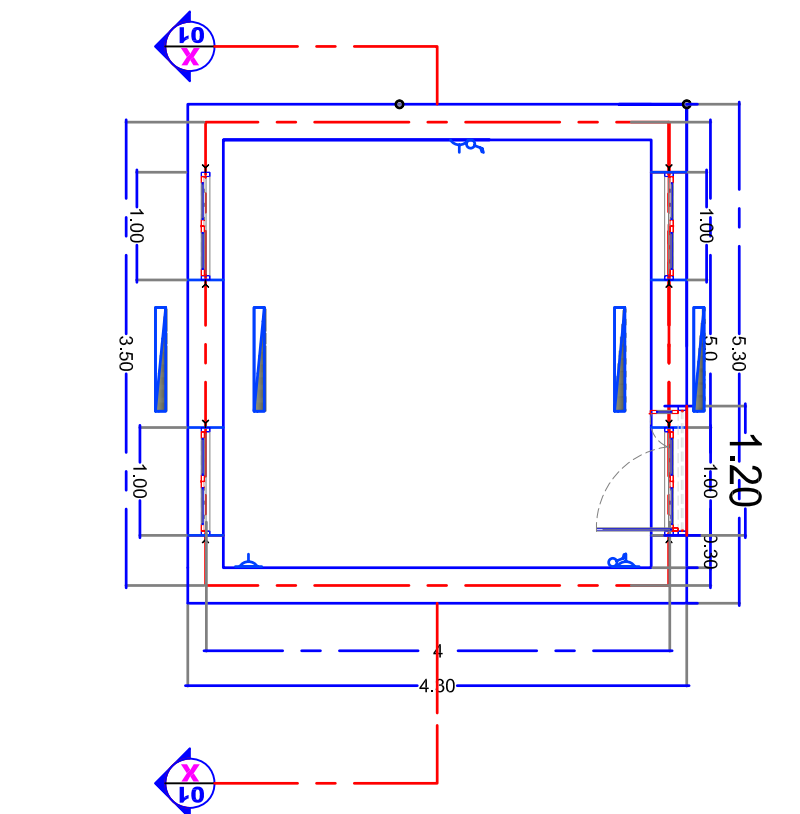

- ① 4cm 8cm steel box truss
- ② Normal Zink sheet attached to 4cm 8cm steel box purlins via self-lap bolts
- ③ 4cm 8cm steel box purlins 75cm C/C attached to the truss via 2.5 cm iron angle brackets
- ④ 30cm stone-hick wall
Cement sand mortar properly finished
- ⑤ 20cm 30cm Re-Concrete lintel beam
4T16 linked with R8 @ 20cm c/c
- ⑥ 30cm 30cm Re-Concrete great beam
6T12 linked with R8 @ 20cm c/c
- ⑦ 30cm 40cm stone wall above the above the strip foundation with good quality cement sand mortar mix 1:5
- ⑧ 60cm 80cm strip foundation with good quality stone and cement sand mortar mix 1:8
- ⑨ plain concrete mix 1:3:6 of 10cm depth
- ⑩ 20cm 30cm Re-Concrete tie beam
4T16 linked with R8 @ 20cm c/c
- ⑪ Steel window of 1.0 meter 1.2 mm
Fabricated from good quality steel box 4x8 for main frame and 3x6 leaves frames
- ⑫ Steel door of 1.0 meter 2.0 m
Fabricated from good quality steel box 4x8 for main frame and 3x6 leaves frames

Plan View

Section 1-1 View

Project:
Millet Earth dam Rehabilitation

Content:
Security /Generator Room Details

Drawn By:
UNDP-DDR

Mayo
2020

7

Note:

- The steel frame and the steel sheet shall be of good quality
- The steel frame and the sheet shall be painted with antirust and final coats
- The contractor shall properly write and draw as indicated in the BoQ

Side Elevation View

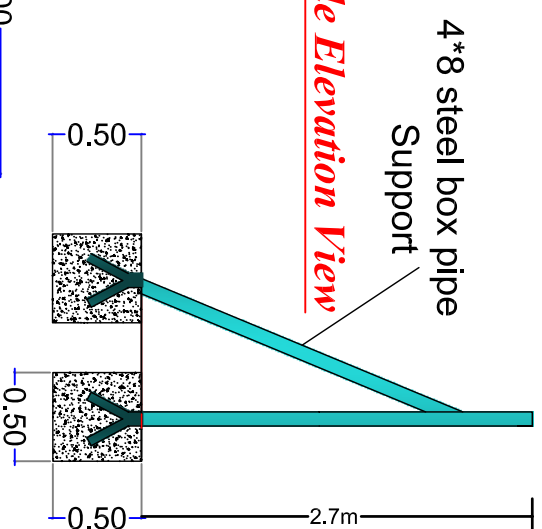

Heavy steel sheet fully welded to
4*8 steel box pie frame

4*8 steel box pipe
frame painted with
antirust paint

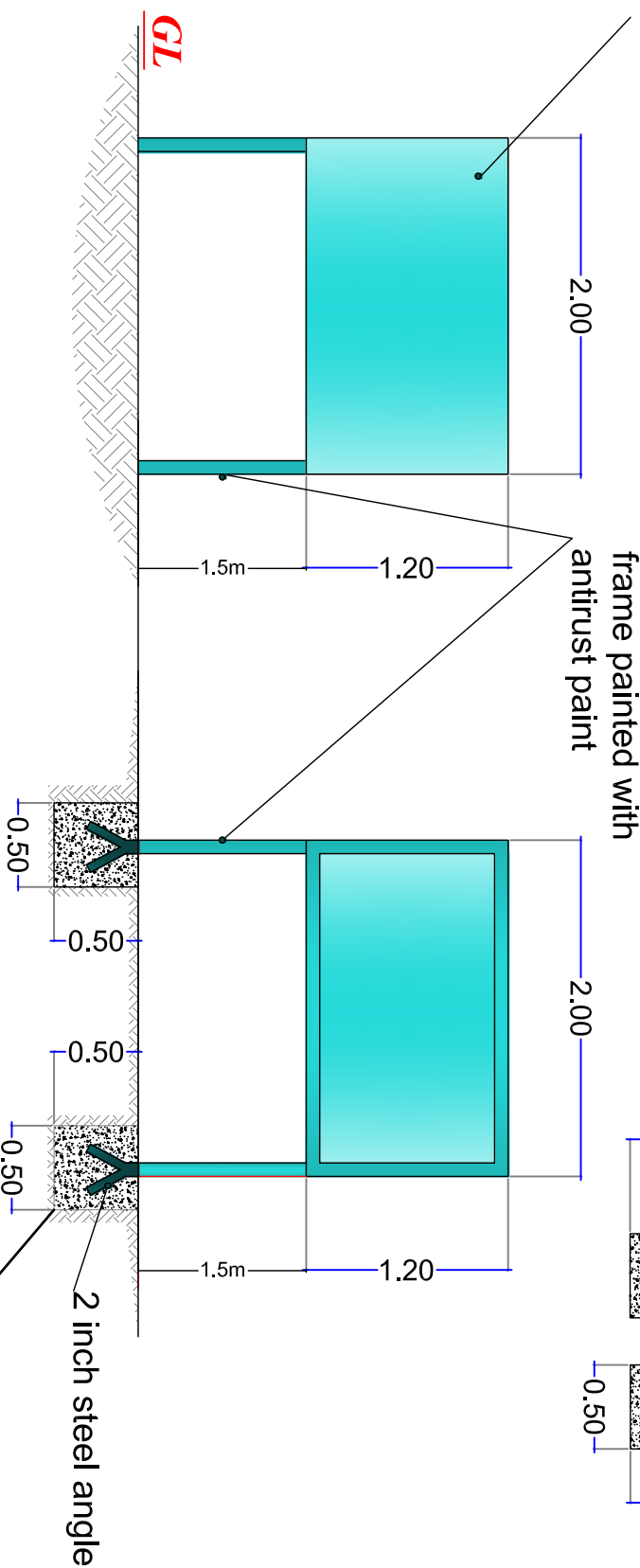

Front Elevation View

Rear Elevation View

Plan concrete

2 inch steel angle

GENERAL:

- 1- All steel members shall be are of good quality heavy steel (Black type).
- 2- all steel remembars shall be painted with antirust paints and final coats
- 3-the plain concrete is of 1:2:6 mix and shall be treated properly with water
- 4-All dimensions are in meter unless otherwise stated

Project Name:

Miller Earth Dam Rehabilitation

Content:

Sign Broad Details

Designed by:

UNDP-ODR

Drawn By:

Ahmed M. Adam

MAY
2020

08



All steel work shall be painted with antirust paint

Project :	
Millet Earth Dam Rehabilitation	
Content:	<i>May</i> 2020
<i>Animal Troughs</i>	
Drawn By:	
U/NDP/DDR	09