

REQUEST FOR QUOTATION (RFQ) (Works)

Rehabilitation of Cold Chain Refrigerator Building in Sirte, Libya.	DATE: May 21, 2020
	REFERENCE: RFQ/LBY/SFL/2020/046

We kindly request you to submit your quotation for the following works, as detailed in Annex 1 of this RFQ. Quotations may be submitted on or before **10th June 2020 at 14:00 hours** Tunis, Tunisia time, ref. www.greenwichmeantime.com and via email at tenders.ly@undp.org.

An organized site visit, subject to government movement restrictions, is arranged on 3rd June 2020, at 11:00 hours, Libya time, at below mentioned place.

Cold Chain Refrigerator Building, Sirte , Libya

Focal Person(s):

1. Mustafa Abougharsa: Tel: +218 917919276
2. Algaddafi Khalifa Alpotte: Tel: +218 913788452

Quotations submitted by email must be limited to a maximum of 10 MB, transmissions. They must be free from any form of virus or corrupted contents, or the quotations shall be rejected.

It shall remain your responsibility to ensure that your quotation will reach the address above on or before the deadline. Quotations that are received by UNDP after the deadline indicated above, for whatever reason, shall not be considered for evaluation. If you are submitting your quotation by email, kindly ensure that they are signed and in the .pdf format, and free from any virus or corrupted files.

Please take note of the following requirements and conditions pertaining to the supply of the abovementioned works:

Place of contract	Cold Chain Refrigerator Building, Sirte, Libya
Preferred Currency of Quotation	United States Dollars (US \$)
Site visit	An organized site visit, subject to government movement restrictions, is arranged on 3 rd June 2020, at 11:00 hours, Libya time, at below mentioned place. Cold Chain refrigerator Building, Sirte , Libya Focal Person(s): Mustafa Abougharsa: Tel: +218 917919276 Algaddafi Khalifa Alpotte: Tel: +218 913788452
Period of Validity of Quotes	120 days - commencing on the submission date In exceptional circumstances, UNDP may request the Offeror to extend the validity of the Quotation beyond what has been initially indicated in this RFQ. The Offeror shall then confirm the extension in writing, without any modification whatsoever on the Quotation.
Advanced Payment upon signing of contract	Except when the interests of UNDP so require, it is the UNDP's preference to make no advanced payment(s) on contracts (i.e., payments without having received any outputs). In the event that the Bidder requires an advanced payment upon contract signature, and if such request is duly accepted by UNDP, and the said advanced payment exceeds 20% of the total Bid price or exceed the amount of USD 30,000.00 UNDP shall require the Bidder to submit a Bank Guarantee in the same amount as the advanced payment.
Liquidated Damages	Will be imposed under the following conditions: Percentage of contract price per day of delay up to maximum duration of 01 calendar month: 0.5% per day Max. limit of delay: 10%

Performance Security	<p>Required: In lieu of Performance security, contract will be subject to a deduction of 10 % (TEN) percent of the amount accepted for the payment as security deposit from all progressive payments.</p> <p>This amount will be kept as Retention to cover the Defect Liability period* of 6 months after Contract completion date. Retention amount could be replaced with the Bank Guarantee issued by reputable International Bank.</p> <p>a. The proceeds of the Performance Security shall be payable to UNDP as a compensation for any loss resulting from the Contractor's failure to complete its obligations under the contract.</p> <p>b. Upon successful completion of Defect Liability Period of 6 months and upon issuance of completion certificate, UNDP will release retention money to the Bidder.</p> <p>* Retention Defect Liability is instrument to cover any defects that are discovered or raised in the normal course of usage within 6 months after the works/goods have been put into the service</p>
Quotation shall include the following:	<p>a. <u>General Information and Experience</u>: Include a description of the firm/company's history and experience to demonstrate that the firm/company has the capacity to undertake the works including the list and value of similar projects performed in past, plus client's contact details who may be contacted for further information on those contracts.</p> <p>b. <u>Business Licenses</u>: Valid business license in general construction works. Interested bidders must have appropriate permission/registration from relevant Government body to operate in Libya (copy must be provided with the quote). The evidence (documents) must be translated into English language.</p> <p>c. <u>Copies of Contracts and Completion Certificate</u> of two similar contracts as prime contractor.</p> <p>d. <u>List of proposed personnel with CV's</u> showing relevant experience and qualification.</p> <p>e. <u>Project Schedule</u>: An outline of the firm/company's proposed timeline reflecting start and completion dates of works including</p> <p>f. <u>Signed/stamped Annex 2 & 2A</u> (FORM FOR SUBMITTING SUPPLIER'S QUOTATION – Annex 2) and (BILL OF QUANTITIES – Annex 2A)</p>
Evaluation method to be used in selecting the most responsive Bid	Lowest priced offer of technically qualified/responsive quotation

Evaluation Criteria	<p>1. Minimum no. of years of experience in (civil works) general construction work: 3 (three)</p> <p>2. The company should have completed at least two similar in nature contracts with the contract value of USD 80,000.00 for each contract. (Copies of contracts and completion certificates (handover of work) to be provided. The supporting documents must be translated into English language.</p> <p>3. Qualification and suitability of the key personnel proposed for the contract including their previous experience with same type of assignment:</p> <ul style="list-style-type: none"> • Civil Engineer/Project Manager - shall have a Degree in Civil engineering and minimum of 3 years of experience of work. • Electrician - with a minimum of 3 years of experience of work. • Plumber - with a minimum of 3 years of experience of work. <p>4. Submission of Implementation Timeline/Meeting the works completion deadline of 120 days.</p> <p>5. Acceptance of General Terms & Conditions for Civil Works</p>
Maximum Expected duration of contract	The successful vendor shall complete the works within 120 days from the award of contract. Offeror's technical approach shall fully comply with the specifications, drawings and BOQ.
All documentations, including catalogs, instructions and operating manuals, shall be in this language	<p>English</p> <p>Documents provided in other languages must be translated into English</p>
Deadline for the Submission of Quotation	On or before 10 th June 2020 at 14:00 hours Tunis, Tunisia time, ref. www.greenwichmeantime.com
Partial Quotes	Not permitted
UNDP will award to	One and only one Vendor
Type of Contract to be Signed	Contract for works
Conditions for Release of Payment	Submission of invoice and acceptance/certification by UNDP Engineer
Annexes to this RFQ	<p>Scope of Works (Annex 1)</p> <p>Form for Submission of Quotation including the BOQ (Annex 2 & 2 A)</p> <p>Specifications (Annex 3)</p> <p>General Terms and Conditions for Civil Works (Annex 4).</p> <p>Non-acceptance of the terms of the General Terms and Conditions (GTC) shall be grounds for disqualification from this procurement process.</p>
Request for clarification	<p>Offerors requesting clarification of any of the items, technical requirements or conditions stipulated in this RFQ shall communicate in writing with UNDP office to procurement.ly@undp.org stating the RFQ reference number: RFQ/LBY/SFL/2020/046</p> <p>All the enquiries should be made five days prior to deadline. Any delay in UNDP's response shall be not used as a reason for extending the deadline for submission, unless UNDP determines that such an extension is necessary and communicates a new deadline to the offerors.</p>

Other Information Related to the RFQ	UNDP has zero tolerance for fraud and corruption, meaning that UNDP vendors are not to engage in fraud or corruption. Vendors engaged in fraud and corruption will be subject to sanctions. Fraud includes the submission of fraudulent or misrepresented documents, such as bid securities and financial statements.
--------------------------------------	---

The quotation that complies with all of the specifications, requirements and offers the lowest price, as well as all other evaluation criteria indicated, shall be selected. Any offer that does not meet the requirements shall be rejected.

Any discrepancy between the unit price and the total price (obtained by multiplying the unit price and quantity) shall be re-computed by UNDP. The unit price shall prevail, and the total price shall be corrected. If the supplier does not accept the final price based on UNDP's re-computation and correction of errors, its quotation will be rejected.

At any time during the validity of the quotation, no price variation due to escalation, inflation, fluctuation in exchange rates, or any other market factors shall be accepted by UNDP after it has received the quotation. At the time of award of Contract or Purchase Order, UNDP reserves the right to vary (increase or decrease) the quantity of services and/or goods, by up to a maximum twenty-five per cent (25%) of the total offer, without any change in the unit price or other terms and conditions.

Any Contract/Purchase Order that will be issued as a result of this RFQ shall be subject to the General Terms and Conditions attached hereto. The mere act of submission of a quotation implies that the vendor accepts without question the General Terms and Conditions of UNDP herein attached as Annex 4.

UNDP is not bound to accept any quotation, nor award a Contract/Purchase Order, nor be responsible for any costs associated with a Supplier's preparation and submission of a quotation, regardless of the outcome or the manner of conducting the selection process.

Please be advised that UNDP's vendor protest procedure is intended to afford an opportunity to appeal for persons or firms not awarded a purchase order or contract in a competitive procurement process.

In the event that you believe you have not been fairly treated, you can find detailed information about vendor protest procedures in the following link:

<http://www.undp.org/content/undp/en/home/procurement/business/protest-and-sanctions.html>

UNDP encourages every prospective Vendor to avoid and prevent conflicts of interest, by disclosing to UNDP if you, or any of your affiliates or personnel, were involved in the preparation of the requirements, design, specifications, cost estimates, and other information used in this RFQ.

UNDP implements a zero tolerance on fraud and other proscribed practices and is committed to identifying and addressing all such acts and practices against UNDP, as well as third parties involved in UNDP activities. UNDP expects its suppliers to adhere to the UN Supplier Code of Conduct found in this link:

http://www.un.org/depts/ptd/pdf/conduct_english.pdf

Thank you and we look forward to receiving your quotation.

Yours sincerely,

Atiqullah Said
Head of Service Centre
UNDP Libya

Rehabilitation of Cold Chain refrigerator Building, Sirte , Libya

Cold Chain refrigerator Building Description

The Cold Chain Refrigerator Buildings was built in 2001, the last comprehensively maintenance and rehabilitation of the building was in 2012. Cold chain refrigerator building close to the Ibn Sina Hospital compound with coordinates (31°11'02.3"N 16°34'55.1"E).



The one-story RCC frame Structure (reinforced concrete skeleton structure)building consists of:

- a- Three Cold storage Area
- b- One walk-in cold room (WIC).

The Total covered Area is 523.25m².

The layout plan of the Cold Chain refrigerator building.

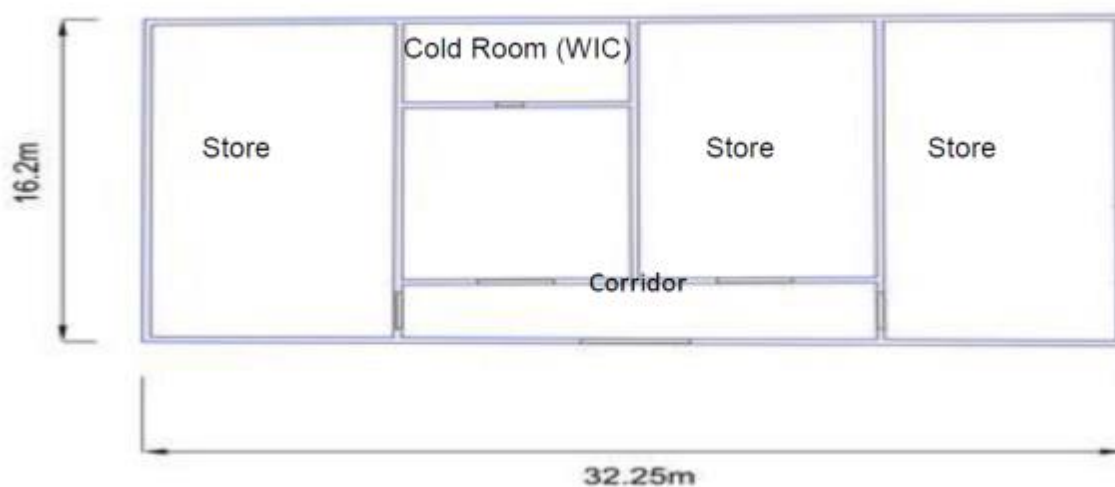

Required work:

- A - Demolishing , Site Cleaning and Preparing of site for new rehabilitation works
- B - Concrete Works/ Concrete Repairs of all the damaged/defective structurally affected members in the building
- C - Block Works – CMU
- D - Plastering Works
- E - Painting Works
- F - Tiling and Marble Works
- G - Doors, Windows and Metals Works
- H- Plumbing & Sanitary Works
- I-Air Conditioner Works
- J-Electrical Works
- K- Supply and installation of 63 KVA Generator System
- L- Supply and installation walk-in Cold Room (WIC)

FORM FOR SUBMITTING SUPPLIER'S QUOTATION

We, the undersigned, hereby accept in full the **UNDP General Terms and Conditions**, and hereby offer to perform the works as per the summary provided below and attached priced BoQ in conformity with the specification and requirements of UNDP as per RFQ Reference No. **RFQ/LBY/SFL/2020/046 - Rehabilitation of Cold Chain Refrigerator Building, Sirte , Libya.**

Description:	Total (US\$)
Subtotal Civil Works	
Subtotal Plumbing and Sanitary Works	
Subtotal Air Conditioner Works	
Subtotal Electrical Works	
Subtotal Generator System	
Subtotal Walk-in Cold room	
Grand Total	

Currency: United States Dollars

All other information that we have not provided automatically implies our full compliance with the requirements, terms and conditions of the RFQ.

We declare that the firm/company or individuals employed by the firm/company are not included in the UN Security Council 1267/1989 list, UN Procurement Division List or other UN Ineligibility List.

Company Name: _____

Contact Person: _____

Position: _____

Email: _____

Mobile Number: _____

Address: _____

Authorised Signature & Stamp: _____ Date: _____

BILL OF QUANTITIES

Description: Rehabilitation of Cold Chain Refrigerator Building, Sirte , Libya.

RFQ Reference Number: RFQ/LBY/SFL/2020/043

Item	Description	Unit	Qty	Unit rate in USD	Amount in USD
	A - Demolishing and Preparing				
	The work shall include and comply with the following: a. Removing of demolished material off site to authorized dumping sites. b. The dismantled material are the sole properties of the client (in case those material is required by the Client). c. The contractor shall coordinate implementation of his daily work activities, working hours, throughout the construction period with the client and the supervising engineer. d. The contractor shall protect and safeguard the existing facilities and building finishes, including the painting, the floor tiles, ...etc. e. The contractor shall make the necessary temporary water, electrical power connections. Etc. to prevent interruption of the power and water supply for the existing functioning building. f. The contractor shall take all necessary measures to protect and minimize environmental hazards including pollution, noise and dust.				
A1	Demolish and remove damaged/defective concrete including some unfixed parts of columns, beams, windows' beams, lintels, decorators and roofs, including preparing surfaces for new concrete works as directed by Engineer.	Lump sum	1		
A2	Demolish and remove plain concrete works for floors, including preparing surfaces for new plain concrete works, as directed by Engineer.	CU.M	2		
A3	Stripping off damaged/defective plastering, including preparing surfaces for new plastering and removal of surplus as directed by Engineer.	SQ.M	355		
A4	Cleaning up the site from Removing the demolished material off site to authorized dumping sites, the rate includes removal works of surplus and useless plant.	Lump sum	1		
	B - Concrete Works				
	Concrete works/repair works shall include: - 1. Shoring to protect safety of the structure and shuttering in any form, shape and size. 2. Approved grouting material, filling material and additives. 3. Supplying and fixing of the required steel reinforcement as per the existing dowels or as required.				
B1	Repair and Rehabilitate all the damaged/defective structurally affected members in the building, the work include supply and cast reinforced concrete grade C30 for damaged columns, beams, slabs, lintels, fascia's, and decorators. The rat includes, cleaning of concrete surfaces, preparing reinforcing steel, formworks, the required high steel reinforcement, (400 Newton / SQ.M) same as existing steel with adequate laps and proper bonding of old and new concrete using special approved bonding material according to the technical specification and engineer instructions .	Lump sum	1		

B2	Supply and cast plain concrete B (200) kg/cm ² for supports, anchor blocks, benching, floorings, slopes or likes. The Rate shall include all required works items (Formworks, surface levelling, curing) in accordance of the technical specifications and Engineer Instructions.	CU.M	2		
	C - Block Works				
C1	Supply & build hollow concrete blocks grade 35 size 40x20x25cm, built with cement sand mortar (1:3) mix according to technical specification and instruction of Engineer.	SQ.M	5		
	D - Plastering Works				
D1	Supply and make 2 coats 15 mm cement sand plaster on the internal walls and ceilings, including surface preparation. The work shall include fixing of metal mesh at the joints, all according to the specification and the Engineer's approval.	SQ.M	330		
D2	Supply and make 2 coats 20 mm cement sand plaster on the external walls and ceilings, including surface preparation and water proofing additive. The work shall include fixing of metal mesh at the joints, filling holes, and all required works to render painted surfaces matching the existing textures and finishes. all according to the specification and the Engineer's approval.	SQ.M	25		
D3	Repair cracks in the existing walls and ceilings. The work shall include stripping off 15 cm wide plaster along the cracks, widen and make V shaped cracks, clean and fill cracks with approved filling material and plastering to match the existing finishing; according to technical specification and Engineer instruction.	L.M	92		
	E - Painting Works				
E1	Supply & paint minimum 2 coats of colored emulsion paint (Supercryle) of high-quality approved product, on the existing internal walls and ceilings. The work shall also include removing the damaged of flocking paint, cleaning, surface preparation, filling fine cracks, applying putty as needed and all required works and as directed and approved by the Engineer.	SQ.M	970		
E2	Supply & paint internal walls and ceilings, with one under coat primer and min. 2 coats colored emulsion paint (Supercryle). The work shall also include cleaning, surface preparation, filling fine cracks and puttying, and all required works according to specification and the engineer approval.	SQ.M	325		
E3	Ditto, But hygiene anti- bacteria emulsion paint of high-quality approved product, on the existing ceiling of refrigerator room.	SQ.M	30		
E4	Supply & paint two coat colored weather shield paint on the external walls and fascia. The work shall also include removing the old paints, cleaning, surface preparation, puttying, repairing damaged plaster up to 25 X 25 cm, and rendering coats to match the existing paint finishing; all in accordance with specification and the Engineer's instructions.	SQ.M	510		
	F - Tiling and Marble Works				
	The work shall include surface preparation for tiling works, sand cement mortar, finish to falls, special tile pieces, grouting and cleaning; all as per specifications and the Engineer's approval.				
F1	Supply and install marble (grade A) think 30 mm with width 250 mm for the windows like existing. The price including final polishing, water drip groove as per specifications and supervisor engineer instructions.	L.M	105		
F2	Supply and install wall skirting made of white Carrara marble (grade A), like the existing, 10mm thick and 100mm height, including all required works.	L.M	35		

F3	Supply and install Mosaic tiles, size 200mm X 200mm X 25mm, like the existing tiles. The price shall include cement sand mortars below tiles, cement sand filling, backfilling; all according to specification and as directed by Engineer.	SQ.M	6		
F4	Supply and install two-layer 4mm thick approved waterproofing bituminous membrane -rolls on the roof surface according to the specification and Engineer instructions. The work shall include surface preparation, cleaning, priming, skirting and fixing the ends of bituminous membrane rolls skirting inside concrete grooving and testing; all in accordance with specifications and the Engineer's instructions.	SQ.M	650		
	G - Doors, Windows and Metals Works				
	<p>The work shall include supply, fabricate and installation of doors, windows, made out of grade 1 timber to be finish as per relevant applicable Standards.</p> <p>Work shall include for 4 mm thick clear float glass/ wired glass /tinted glass /translucent glass as appropriate to suit the respective doors and windows as similar to the existing doors and windows, where required. Rates shall include fixing frame, door sash / window casement brass fixing screws, lock sets with 3 keys.</p> <p>Preservative treatment for back of door & door frame in contact with masonry or concrete.</p> <p>Painting / Final Finish</p> <p>Unless otherwise stated all surface of timber doors & windows and casements and door sashes shall be applied with two coat of wood preservative, two coats of prime, two coats of approved pain.</p>				
G1	Repair, conduct maintenance and adjustment on the external galvanized sliding steel gate, overall size 3.85 m x 3.75 m complete with frame, 2 moving leaf constructed of 2 panel made of 2 mm double galvanized steel plates, including door lock, all iron monger and hardware, repairing damaged parts, painting with approved paints with all necessary supporting .. etc. As per specifications and supervisor engineer instructions.	No	1		
G2	Repair, conduct maintenance and adjustment on the steel doors with size 1.95 m x 2.4 m, including approved paints, door lock, replace the damaged accessories, complete as directed by Engineer.	No	4		
G3	Supply & install galvanized steel ladder 60cm width 500cm length for standby generator consist of 40x40x3mm G.S Box section include fixation to wall by G.S plate 4mm thickness. With all needed fitting, welding, painting with at least two coats oil paint over one coat polyzoic primer & the needed accessories to complete the job as specifications and drawing of engineer's instructions.	Lump sum	1		
G4	Repair and maintenance steel protection grill size 0.95 m x 2.0 m for the windows, including, repairing damaged parts, brushing and painting, as specifications and the engineer's instructions.	No	20		
G5	Supply and install PVC windows with size 0.95 m x 2.0 m, including al accessories and hardware of high quality, removing the old one, complete as directed and approved by the Engineer.	No	20		
G6	Supply and install Exterior PS doors overall size 3.0 m X 3.4 m, including all accessories and hardware of high quality, removing the old one, complete as directed and approved by the Engineer.	No	1		
	Total for Civil works. carried to summary				
	I- Plumbing & Sanitary Works				

	<p>Plasticized polyvinyl chloride (UPVC) pipes shall be used in the plumbing installation and they must conform in every respect to the requirements of BS 4514.</p> <p>All fittings and pipe specials used in the plumbing installation shall be suitable and compatible with all respects to the pipeline to which fittings and specials are fixed.</p> <p><u>Rates for plumbing work shall include for:-</u></p> <p>All fittings such as elbows, bends, tees, junctions, plugs, etc..</p> <p>Connecting pipes to sanitary fixtures and appliances.</p> <p>Necessary screws, nails sockets, connection back nuts standard pipe fixing or supporting clips, saddles, brackets, holder bats, straps</p> <p>Connecting of different types of pipes.</p> <p>Testing and disinfection after completion.</p> <p>Excavation, backfilling, disposal of surplus soil for items which were specifically mentioned.</p> <p><u>Rates for sanitary fittings shall include for:-</u></p> <p>Fittings such as taps, wastewater outlet, internal overflows etc. and supporting brackets, incidental materials for fixing, unless otherwise measured separately.</p> <p>Assembling, jointing together fixing components parts, and jointing to pipes including necessary coupling and for leaving perfectly clean and in perfect working order on completion.</p> <p>Jointing and connecting of pipes to sanitary fittings.</p> <p>Testing and commissioning of the installation.</p> <p><u>Rates for drainage work shall include for :-</u></p> <p>Excavation, backfilling, disposal of surplus soil</p> <p>All pipe specials such as bends, junctions, elbows, tees etc.</p> <p>Connection to sides of manholes.</p> <p>Giving notices, obtaining permits, paying fees, fixing, testing and commissioning.</p>				
H1	Supply and install UPVC pipes 90mm and 10 bar pressure, for rainwater drainage. The work includes with removing old one, all tees, bends, and all related work, accessories and fittings.	L.M	35		
	Total Sanitary and Plumbing Works... Carried to Summary				
	I-Air Conditioner Works:				
I1	<p>Supply install wall mounted invertor split air-conditioners. The price shall include one-year Warranty, wiring, electrical connections, drainpipes to the nearest drain points, waterproof on-off switch on the external units, galvanized steel holders/stands, opening in walls by scoring machine, closing holes with sika sealant, gas and oil charging. The units shall be according to below specifications and the applicable Standards, and as per the following specifications: Capacity-24 000 BTU</p> <p>Pre charged with Eco. Friendly R 410A.</p> <p>Washable screen anti-bacterial filtration</p> <p>Low Ambient Heating Temp.</p> <p>Power supply source-V/Ph/Hz-220-240V-1-50 Hz</p> <p>Air flow volume-CU.M/h-985</p> <p>Noise level in door d/B-47</p> <p>Noise level outdoor d/B- 53</p> <p>Ai circulation-(H/M/L) -CU.M/h 850/680/540</p> <p>Digital, Multi-function LCD Remote Control</p>	No	13		
	Total Air Conditioner Works. Carried to Summary				
	J-Electrical Works:				

J1	Supply and install lighting fixture (globe) as existing with 100-watt lamp.	No	18		
J2	Supply and install fluorescent lighting fixture 2 X 40 watt with plastic cover grade A, including 120 cm day light lamps, 3 X 1.5 mSQ.mm wires, conduits, chock coils, starters, capacitors, clamps, bolts, removing the old one, and all needed accessories. All complete as per specification, and engineer instructions.	No	20		
J3	Supply and replace the old fluorescent 120 cm day light lamps, including starters, and all needed accessories.	No	14		
J4	Supply and install double pole 16 A, 220V, lighting switch, the work includes removal of old ones as directed by Engineer.	No	9		
J5	Ditto but single pole switch.	No	2		
J6	Supply and install single pole 16 A, 220V, socket outlet. The work includes the earthing cable and removal of old ones as directed by Engineer.	No	22		
J7	Supply and install 400-watt spotlight, including PVC conduits inside walls and wiring, connection to sub-boards and all needed cables, Day Night Switch and accessories. all complete as per specification, and engineer instructions.	No	6		
J8	Maintenance with Testing and commissioning of the electrical network of the cold chain refrigerator buildings. The work includes wires 2,4,6 mm, cables, switches, sub-distribution boards, and replace the damaged ones. And ensure the quality of the connections and everything necessary to finish the work according to the instructions of the Engineer.	Lump sum	1		
	Total for Electrical works. carried to summary				
	K-Generator System				
K1	Supply, installation and commissioning Caterpillar, Perkins, Olympian or equivalent approved standby power supply diesel generating set and connect it to the storage fuel tank, the item shall include automatic start and stop exhaust system, fuel pump and control, with automatic float control, protection and digital control panel, sensors for heat, speed, under voltage, over voltage, oil pressure, phase sequence and phase failure, measuring instruments, air duct, build in 8 hours fuel consumption day tank altimeter, diesel engine, exciter, automatic charger, main circuit breaker, sound attenuated enclosure (original) as recommended by the manufacture. All fittings and fixing materials and control needed are included in the price. The generator shall be rated 63 KVA standby rating,1500 RPM,3 phase, 50Hz. The price shall include also Auto Transfer Switched, the supply and construct concrete pad earthing and civil & cabling works and fitting to be done, the item includes the supply of all recommended spare parts by the manufacturer for 2 years period. Generator Set Should be complete with Canopy, and all works associated as described in the Specifications and as directed by the Engineer	Lump sum	1		
	Total for Generator System. carried to summary				
	L- walk-in Cold Room				

L1	Supply, installation and commissioning Comprehensive onsite warranty for 3 Years of Walk-In Cold Room (WIC) Equipment similar to the existing consist with coolers and matching air cooled condensing units ,Evaporator indoor units, air curtains, Refrigeration fittings, Supply and Charging of R-404A refrigerant gas, drain line, Controller and display system, temperature/humidity recorders ,Voltage Stabilizers, Alarms ,Switch Board, electrical, control wiring for whole system of Cold room unit, Lighting must be ceiling mounted tungsten filament light fitting with external switch ,removing the old equipment's ...etc. and all works associated as described in the Specifications and as directed by the Engineer.The following performance specifications should be met:Upper and lower temperature limits - 40C to + 50C.Accuracy +/- 1 C.Resolution +/- 0.5 C.Power source 220/240 volts 50 Hz mains operated with rechargeable and replaceable battery backup with 48hrs charge capacity.	Lump sum	1		
	Total for Walk-in cold room. carried to summary				
Summary					
1	Total Civil Works				
2	Total Plumbing and Sanitary Works				
3	Total Air Conditioner Works				
4	Total Electrical Works				
5	Total Generator System				
6	Total Walk-in Cold room				
7	Grand Total. \$				
8	Grand total in words USD				
9	Name of the contractor:				
10	Contact Person:				
11	Position:				
12	Email:				
13	Mobile Number:				
14	Address				
15	Signature and stamp of the contractor				
16	Date:				

Specifications

Attached



Annex 4

UNDP General Conditions of Contract for Civil Works

Attached