

Annex B: Set of Drawings for Diling Integrated Farm Rehabilitation

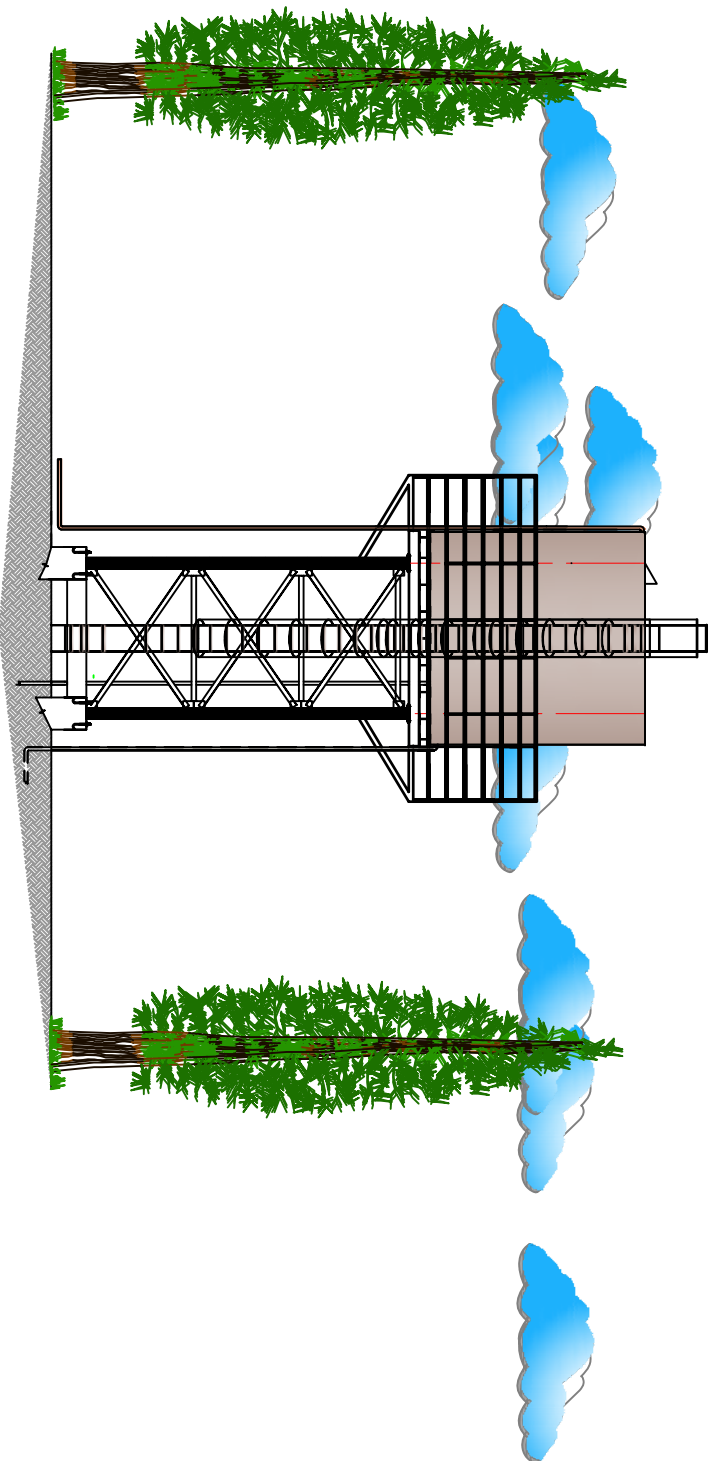

Hai-Elmak-Diling Locality-South Kordofan State

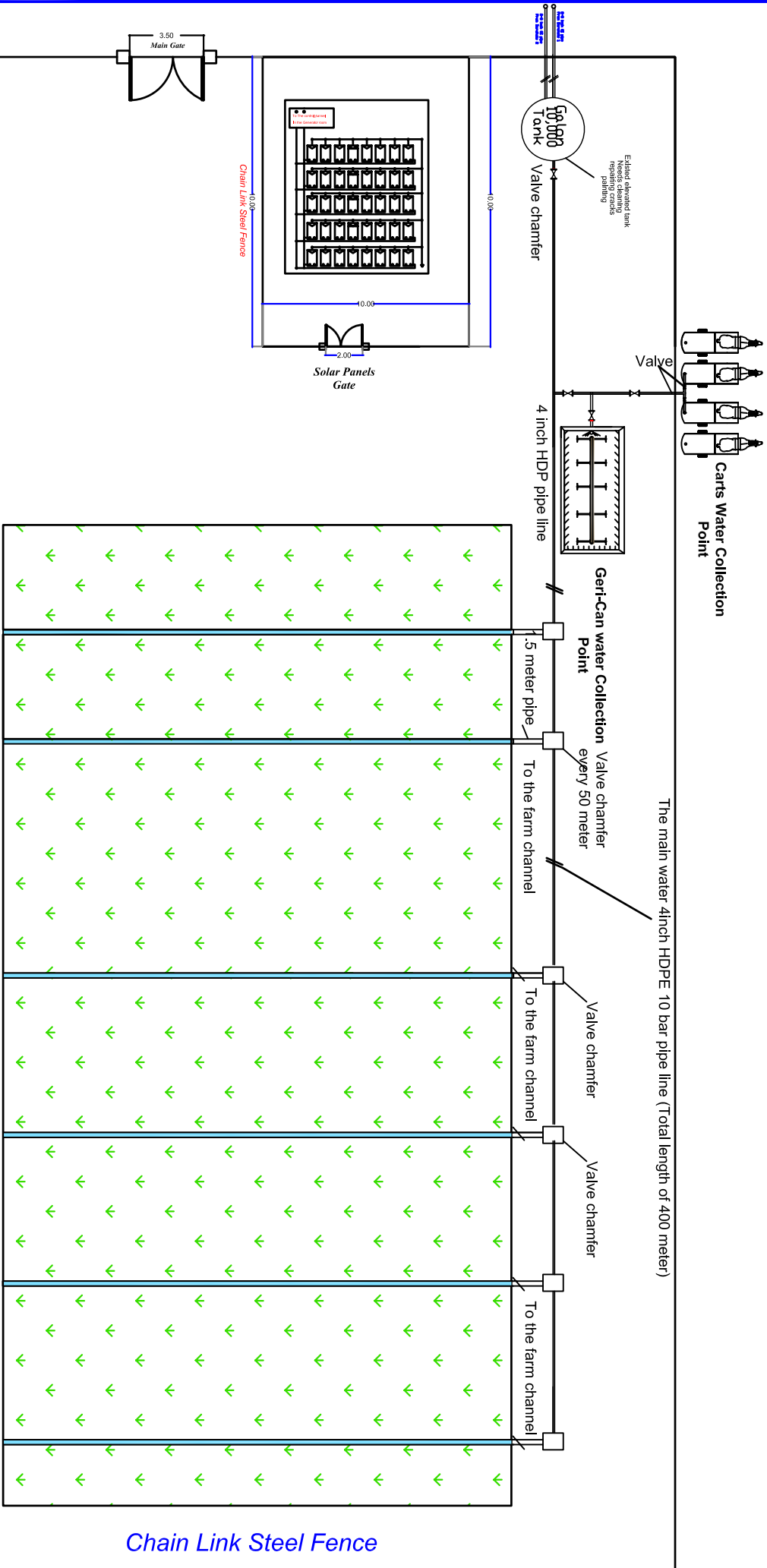

Chain Link Steel Fence

Chain Link Steel Fence

Project :

Dilling Integrated Farm Rehabilitation

Content :

Main Plan Drawings

drawn By:

UNDP

July
2020

01

Gate Valve @500 meter from the water tank

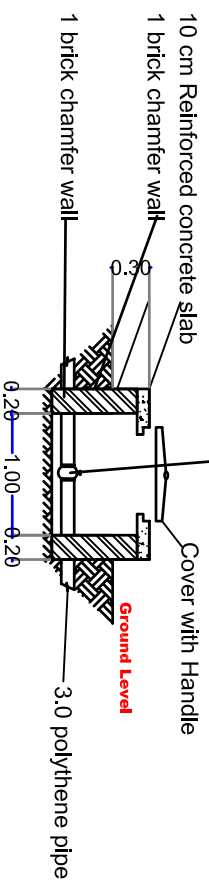

1.2m*1.2m Gate valve chamfer

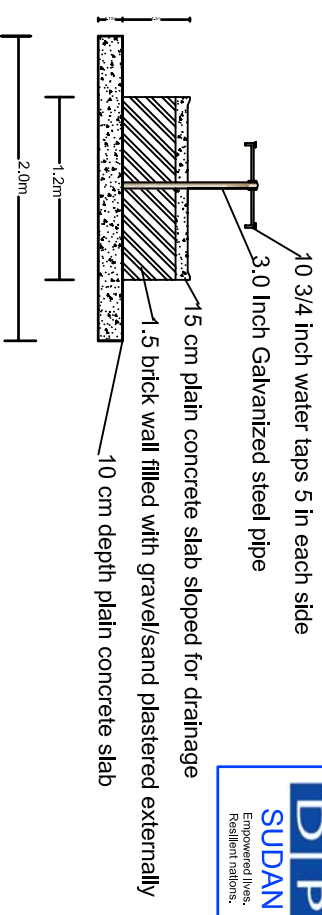

WATER POINT **SECTIONAL VIEW**

3.0 inch High Density polythene pipe (HDPE)

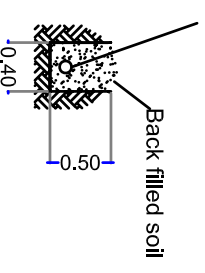

Main pipe trench and pipe

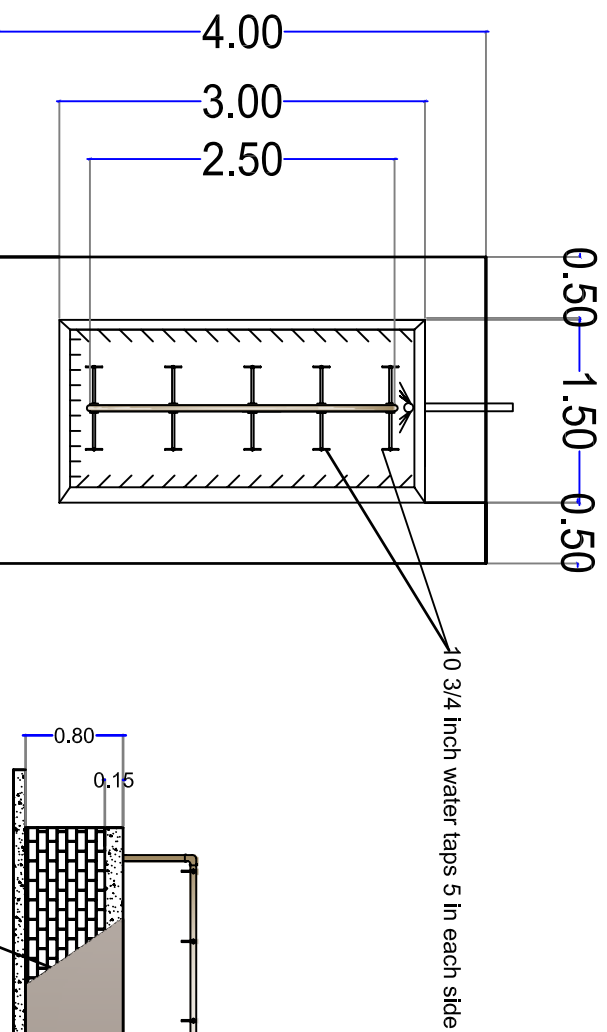

WATER POINT **PLAN VIEW**

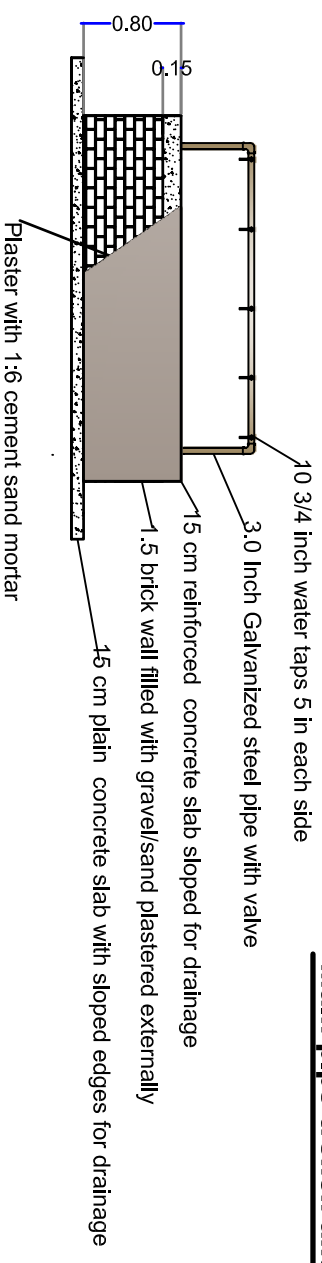

WATER POINT **SECTIONAL VIEW**

Solar Panels in 5 strings in parrells

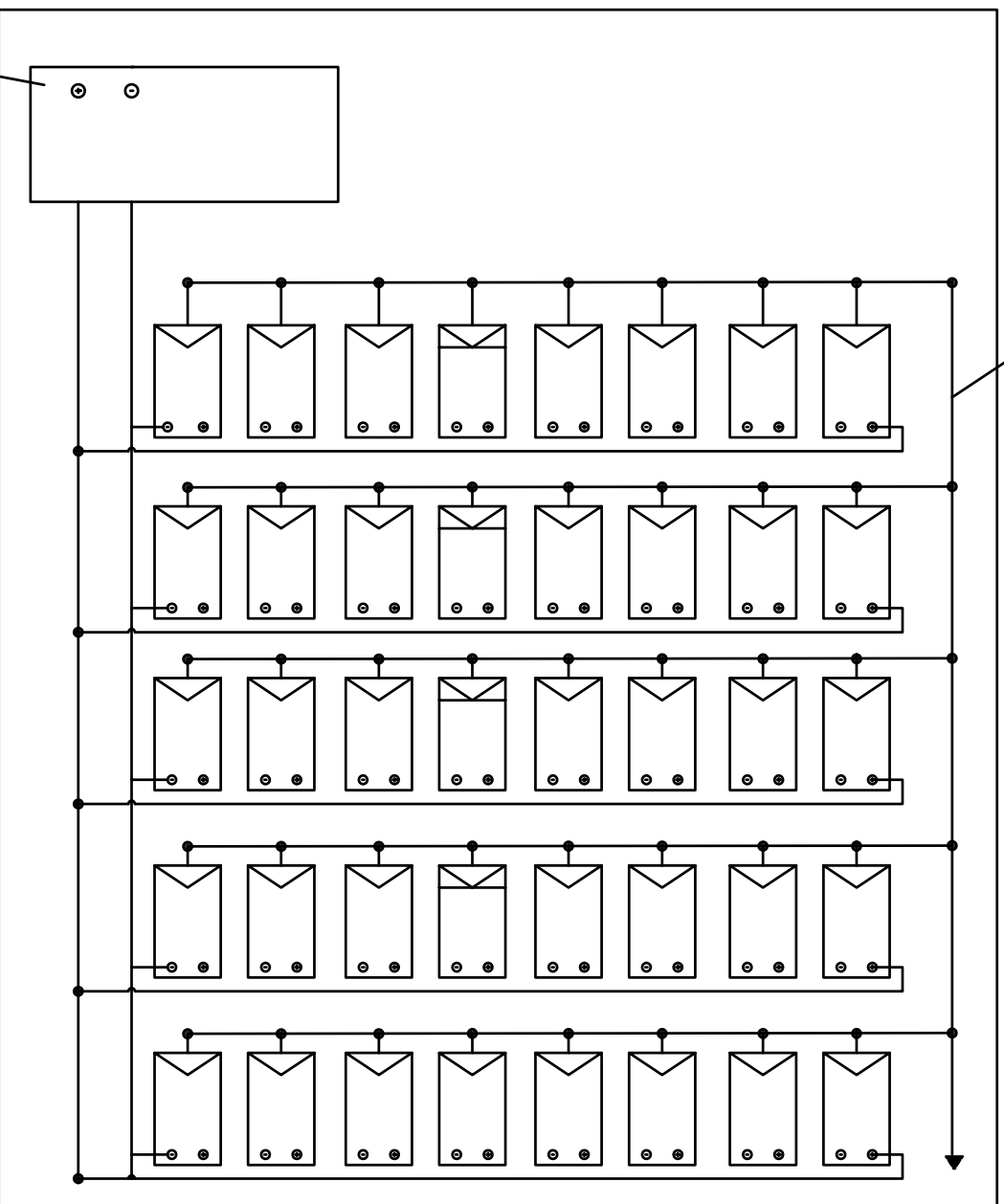

Controller

Note:

- The solar cell shall be mounted on galvanized stands
- The total output of the solar cells shall decided based on loads of the pumps and other devices but should not be less 10 KVA
- The solar stands shall be fixed with plain concrete footings
- The solar cell be properly installed to manufacturers directions
- All electrical cables shall be through electrical pipes protected and trenched
- Bidder quoting for different arrangement or design has to state so and should provide all necessary information for evaluation
- the solar panels shall be attached to the frame properly in a manner to prevent being removed



Note:

- The solar cell shall be mounted on steel / aluminum stands
- The total output of the solar cells shall decided after pumping test and selection of the pumps the capacity of the solar panels shall cover the loads of 2 pumps but should not be less 10 KVA
- The solar cell be properly installed to manufacturers directions
- All electrical cables shall not be less than 6mm².
- All electrical cables shall be through electrical pipes ,properly protected and trenched.

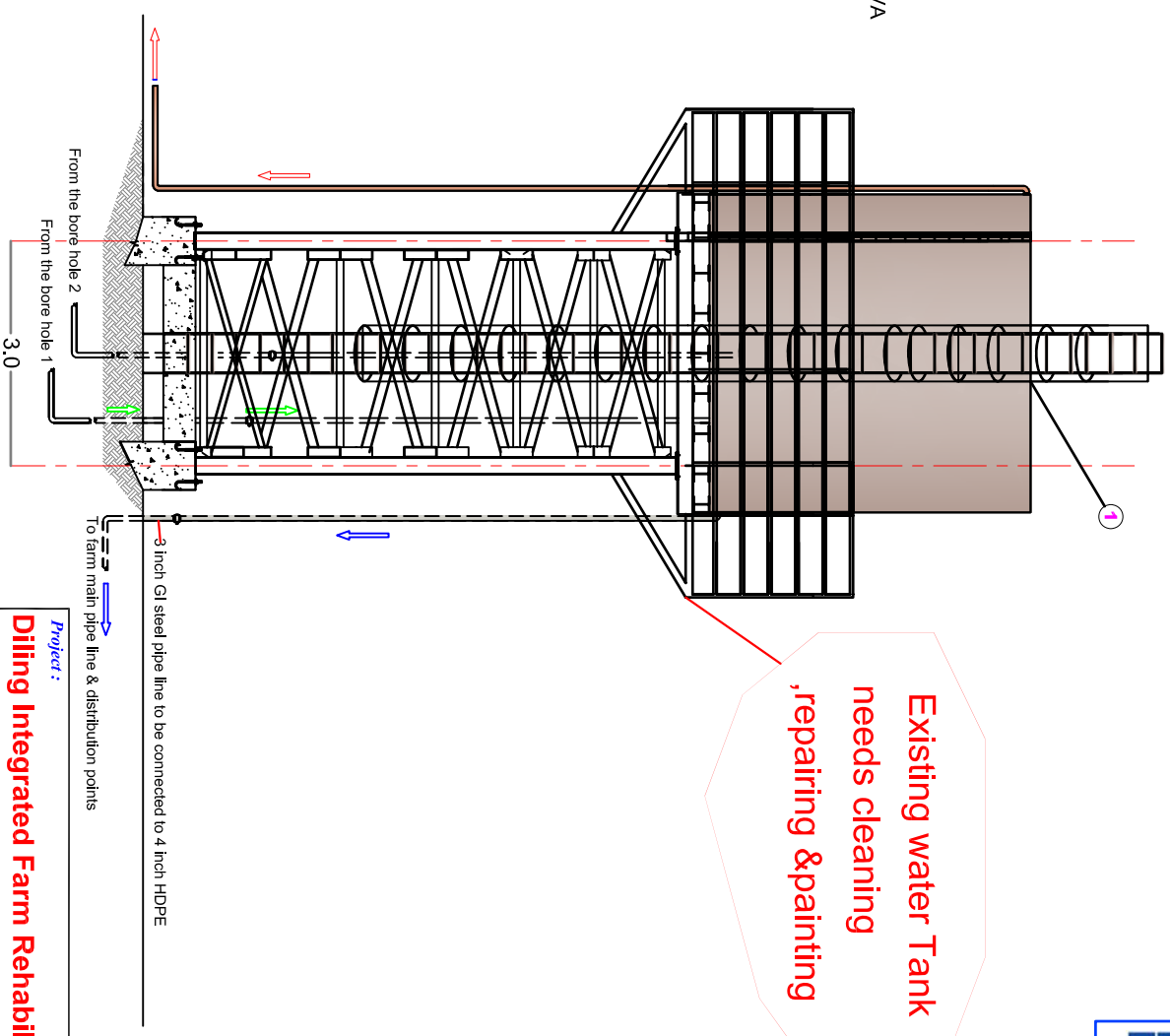
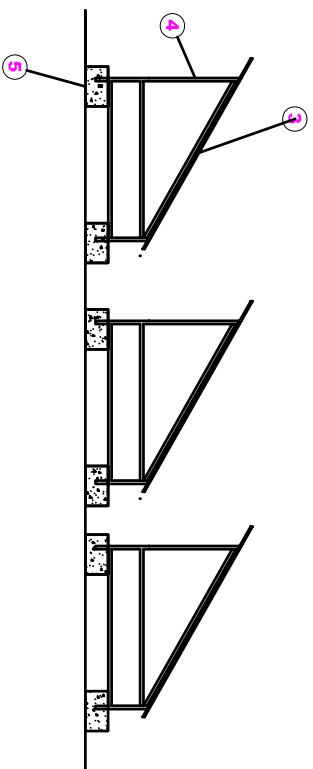

Project :
Dilling Integrated Farm Rehabilitation

Content :
Water tank drawings

drawn By:
UNDP

July
2020

04



All steel frames shall be painted with anti-rust paints



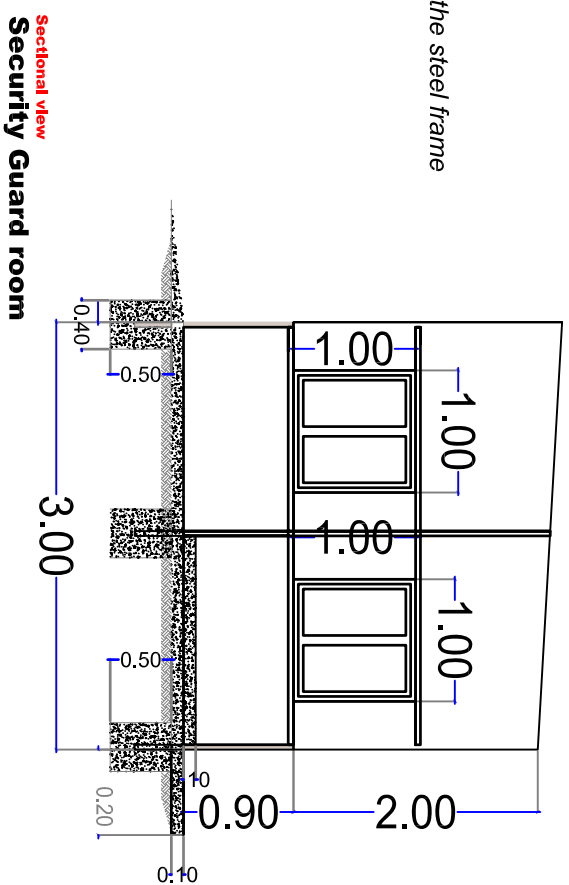
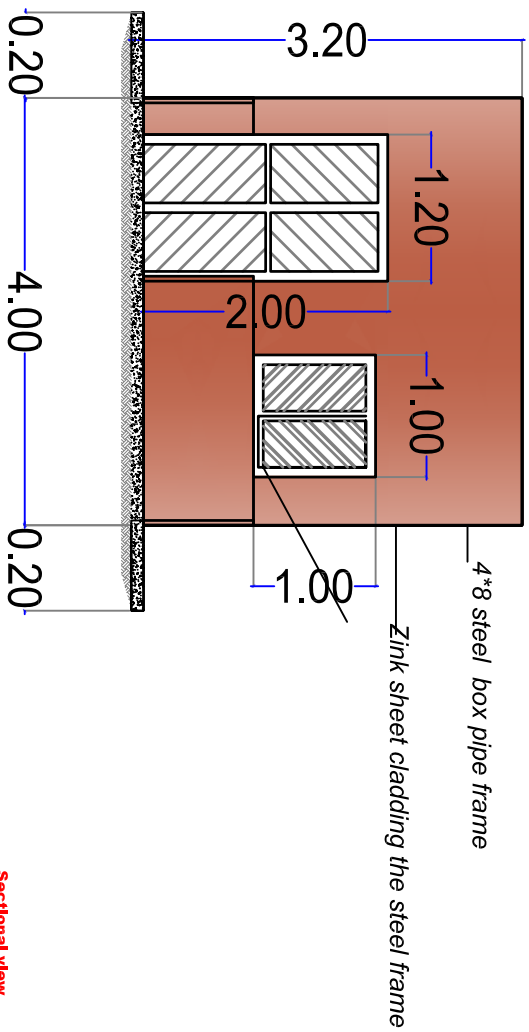

10 cm depth platform of plain concrete

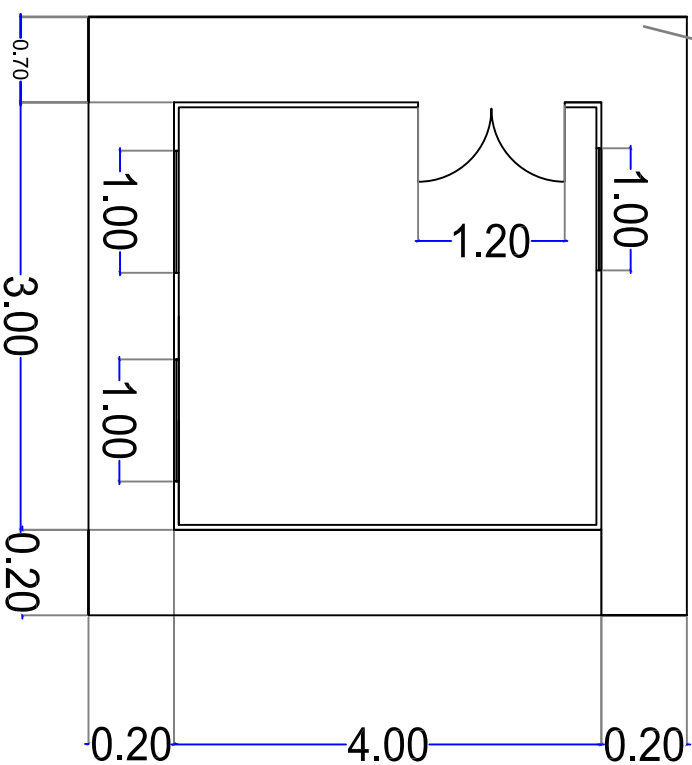

Note:

- The steel frame and the steel sheet shall be of good quality
- The steel frame and the sheet shall be painted with antirust and final coats
- The the contractor shall properly write and draw as indicated in the BoQ

Side Elevation View

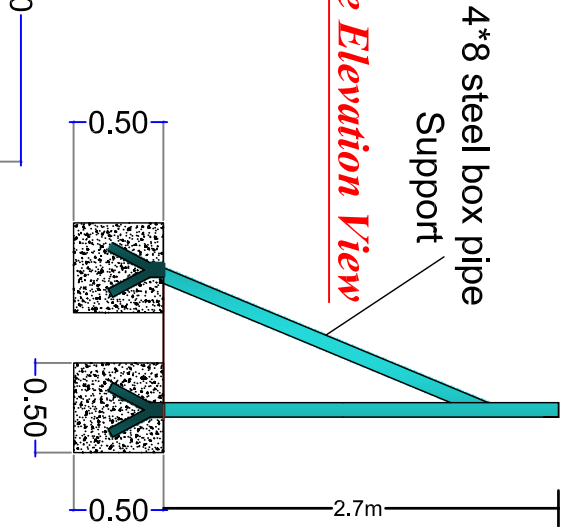

Heavy steel sheet fully welded to
4*8 steel box pie frame

4*8 steel box pipe
frame painted with
antirust paint

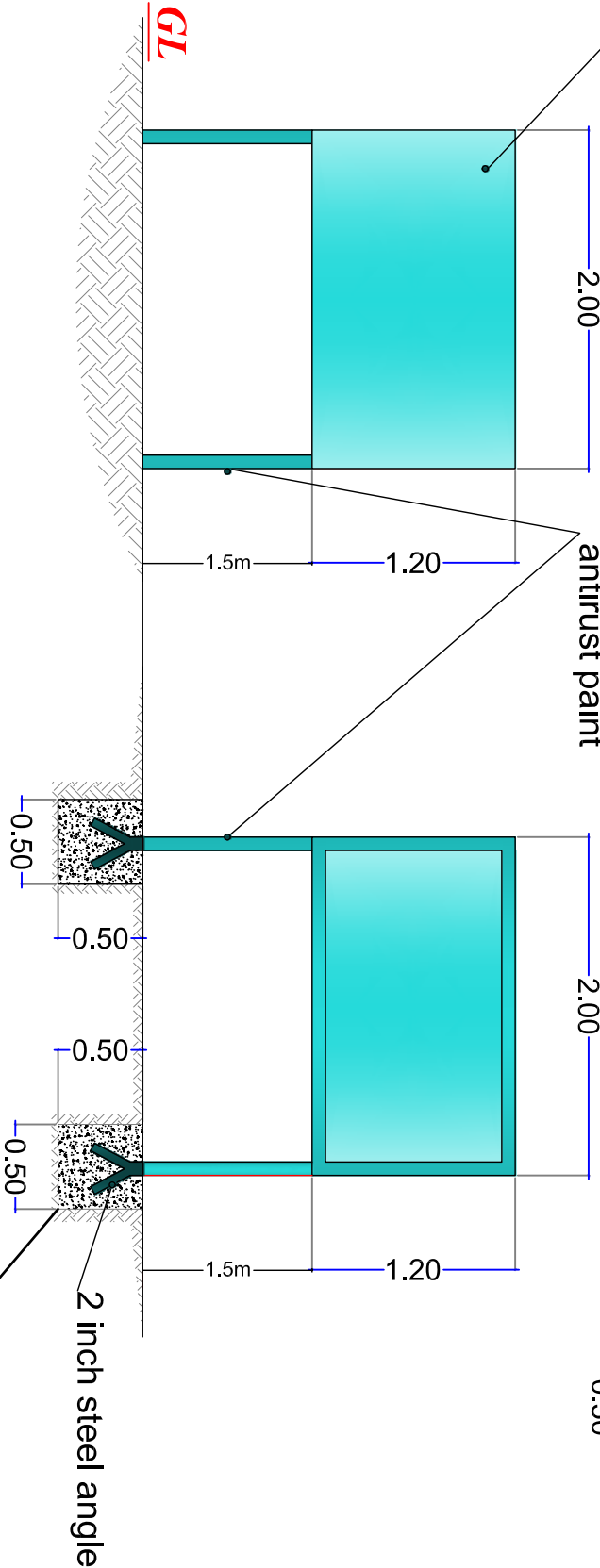

Front Elevation View

Rear Elevation View

GENERAL:
1- All steel members shall be are of good quality heavy steel (Black type).
2- all steel remembers shall be painted with antirust paints and final coats
3- the plan concrete is of 1:3:6 mix and shall be treated properly with water
4- All dimensions are in meter unless otherwise stated

Project Name:

Dilling Integrated Farm Rehabilitation

Content:
Sign Broad Details

Designed by:
UNDP-DDR
July 2020

Drawn By:
Ahmed M. Adam



SIDE VIEW



Project :	Dilling Integrated Farm Rehabilitation
Content:	Animal Troughs
Drawn By:	LUNDP/DDK
Date:	July 2020
Page No.	09