

GENERAL NOTES

- DO NOT SCALE THIS DRAWINGS (DIMENSIONS SHOULD BE CALCULATED NEVER SCALED).
- ALL DIMENSIONS ARE IN MILLIMETER UNLESS OTHERWISE INDICATED.
- ALL LEVELS ARE IN METERS UNLESS OTHERWISE INDICATED.
- ARCHITECTURE LEVEL ± 0.00 IS EQUIVALENT TO ROAD LEVEL.
- THIS DWG. IS TO BE READ IN CONJUNCTION WITH ALL OTHER ARCHITECTURAL, STRUCTURAL, ELECTRICAL, MECHANICAL, LANDSCAPING, GEOTECHNICAL, RE DWG & SPECIFICATIONS & B.O.Q.
- CONCRETE & STEEL LEVELS ON ARCHITECTURAL DRAWINGS ARE FOR INFORMATION ONLY. FOR CONCRETE & STEEL LEVELS, REFER TO STRUCTURAL DRAWINGS. THE FINISH FLOOR LEVEL (F.F.L) IN THE ARCHITECTURAL DRAWINGS IS THE BASIS OF ALL LEVELS IN ALL OTHER TRADES (STRUCTURAL, ELECTRICAL, MECHANICAL...)
- IF ANY DISCREPANCIES ARE FOUND, IT IS CONTRACTOR'S RESPONSIBILITY TO INFORM SITE ENGINEER AND PROPOSE SOLUTIONS.
- CONTRACTOR SHOULD VERIFY PLANS IN ACCORDANCE WITH SITE CONSTRAINTS & SITE SURVEY BEFORE EXECUTING THE DRAWINGS & REPORT TO ENGINEER IN CASE OF ANY DISCREPANCIES.
- CONTRACTOR'S RESPONSIBILITY TO COORDINATE EFFECTIVE DIMENSIONS OF STEEL STRUCTURE TO ACCOMMODATE ARCH HEIGHTS UPON FINALIZING STEEL STRUCTURE DRAWINGS AS PER SUPPLIER OR MANUFACTURE.
- CONCRETE PADS LOCATIONS & DIMENSIONS ARE TO BE COORDINATED WITH ELECTROMECHANICAL EQUIPMENT DIMENSIONS & REQUIREMENTS.
- SLAB OPENINGS ON ARCH DRAWINGS ARE DUCT WORK MORE THAN 20 CM. FOR ANY SMALLER SLEEVES, CONTRACTOR SHALL COORDINATE WITH STRUCTURE AND ELECTROMECHANICAL DRAWINGS.
- FOR EXACT LOCATIONS AND DIMENSIONS FOR SLAB OPENINGS REFER TO MEP/ST. DRAWINGS.
- FOR ALL ELECTROMECHANICAL FIXTURES AND EQUIPMENT LIKE (FIRE ALARM, INDIVIDUAL SECURITY AND IT REFER TO ELECTROMECHANICAL DOCUMENTS).
- CONTRACTOR TO COORDINATE ALL ELECTROMECHANICAL CEILING FIXTURES IN CONJUNCTION WITH SELECTED FIXTURES AND EXACT STEEL STRUCTURE AND ELECTROMECHANICAL DRAWINGS.

Warehouse F.F.L $\pm 0.00 = 1125.135$

| | | | | | | | |
|--|---------|--|-----------|--|--|--|--|
| <p>D01 ELEVATION SCALE 1:25</p> <p>D01 SEC. 1-1 SCALE 1:25</p> <p>D01 SEC. 2-2 SCALE 1:25</p> | | <p>D02 ELEVATION SCALE 1:25</p> <p>D02 SEC. 1-1 SCALE 1:25</p> <p>D02 SEC. 2-2 SCALE 1:25</p> | | <p>D03 ELEVATION SCALE 1:25</p> <p>D03 SEC. 1-1 SCALE 1:25</p> <p>D03 SEC. 2-2 SCALE 1:25</p> | | <p>D04 ELEVATION SCALE 1:25</p> <p>D04 SEC. 1-1 SCALE 1:25</p> <p>D04 SEC. 2-2 SCALE 1:25</p> | |
| TYPE | WIDTH | HEIGHT | FIRE RATE | SINGLE LEAF WOOD HINGED DOOR | | | |
| D01 | 950 mm | 2200 mm | - | | | | |
| TYPE | WIDTH | HEIGHT | FIRE RATE | SINGLE LEAF WOOD HINGED DOOR | | | |
| D02 | 800 mm | 2200 mm | - | | | | |
| TYPE | WIDTH | HEIGHT | FIRE RATE | SINGLE LEAF WOOD HINGED DOOR | | | |
| D03 | 700 mm | 2200 mm | - | | | | |
| TYPE | WIDTH | HEIGHT | FIRE RATE | DOUBLE LEAF WOODEN HINGED DOOR | | | |
| D04 | 1700 mm | 2200 mm | - | | | | |
| <p>D05 ELEVATION SCALE 1:25</p> <p>D05 SEC. 1-1 SCALE 1:25</p> <p>D05 SEC. 2-2 SCALE 1:25</p> | | <p>D06 ELEVATION SCALE 1:25</p> <p>D06 SEC. 1-1 SCALE 1:25</p> <p>D06 SEC. 2-2 SCALE 1:25</p> | | <p>D07 ELEVATION SCALE 1:25</p> <p>D07 SEC. 1-1 SCALE 1:25</p> <p>D07 SEC. 2-2 SCALE 1:25</p> | | <p>D08 ELEVATION SCALE 1:25</p> <p>D08 SEC. 1-1 SCALE 1:25</p> <p>D08 SEC. 2-2 SCALE 1:25</p> | |
| TYPE | WIDTH | HEIGHT | FIRE RATE | DOUBLE LEAF ALUMINUM SLIDING DOOR | | | |
| D05 | 1600 mm | 2200 mm | 90 MIN. | | | | |
| TYPE | WIDTH | HEIGHT | FIRE RATE | SINGLE LEAF WOOD HINGED DOOR | | | |
| D06 | 950 mm | 2200 mm | 90 MIN. | | | | |
| TYPE | WIDTH | HEIGHT | FIRE RATE | SINGLE LEAF WOOD HINGED DOOR | | | |
| D07 | 800 mm | 2200 mm | 90 MIN. | | | | |
| TYPE | WIDTH | HEIGHT | FIRE RATE | SHUTTER DOOR AT HAZARD STORE | | | |
| D08 | 3000 mm | 3000 mm | 90 MIN. | | | | |

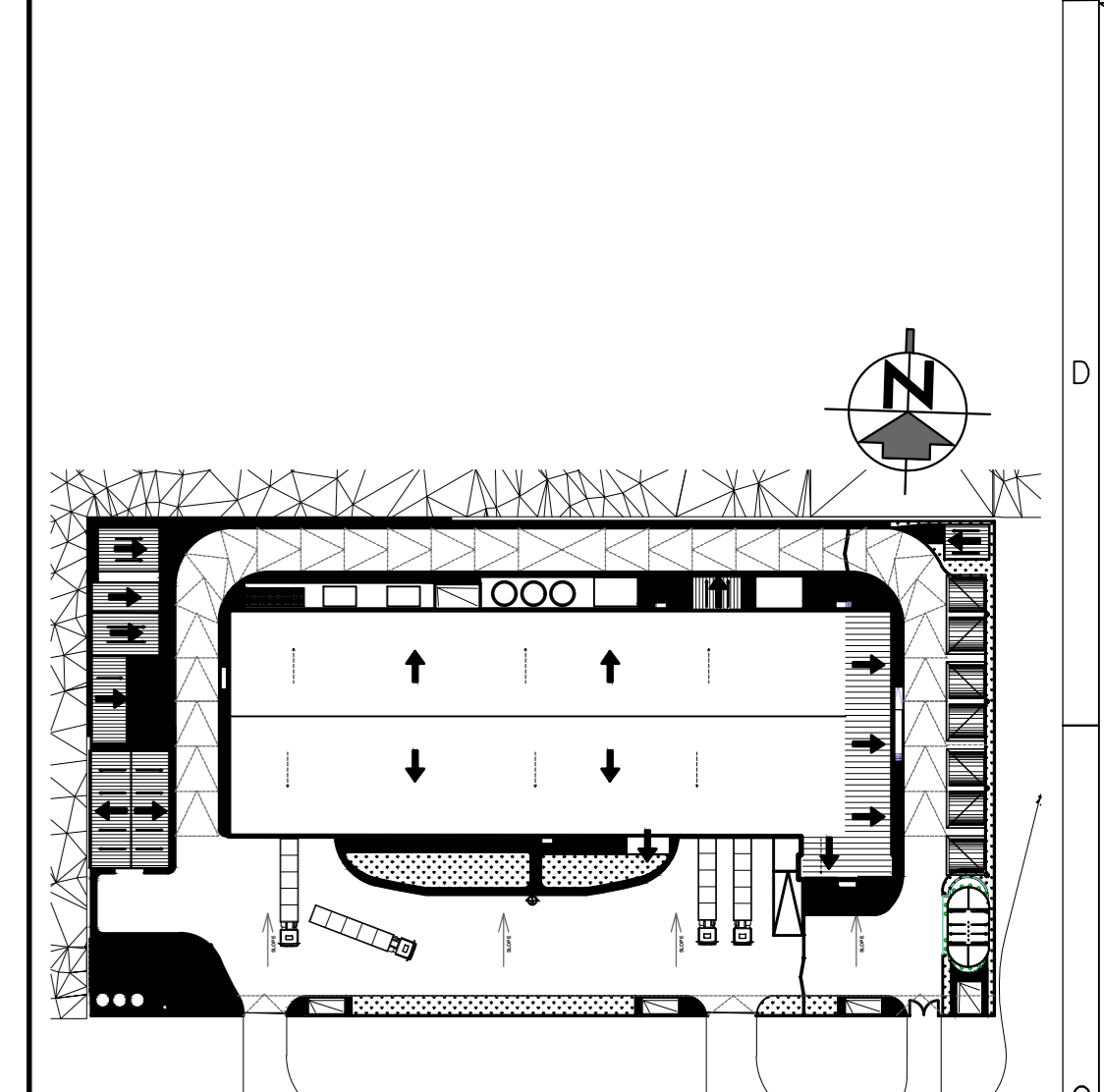

| NO. | DATE | ISSUE FOR DETAILED DESIGN | DESIGNED BY | CHECKED BY | APPROVED BY |
|-------|------------|---------------------------|-------------|------------|-------------|
| NO 01 | 2021-01-16 | ISSUE FOR DETAILED DESIGN | A.YASER | H.ASHER | M.ASHER |

THIS DRAWING IS THE PROPERTY OF COSMOS-E AND MUST NOT BE REPRODUCED OR ITS CONTENTS DRAGGED WITHOUT WRITTEN PERMISSION

CLIENT

NatPharm
Access to Affordable Quality Medicines

MAIN CONSULTANT

COSMOS-E
ENGINEERS & CONSULTANTS

LOCAL CONSULTANT

NYKA ENGINEERING & TECHNICAL SERVICES (PVT) LTD

PROJECT TITLE
ZIMBABWE (MUTARE) MEDICAL WAREHOUSE PROJECT

DRAWING TITLE
DOOR TYPES

PROJECT NO. Z2016 SCALE: 1:25

DRAWING NO. Z210116-01010-1A1E-01016-010-01

1 DOOR TYPES
1:25