

DOOR FRAME REPLACEMENT IN BANK BUILDING

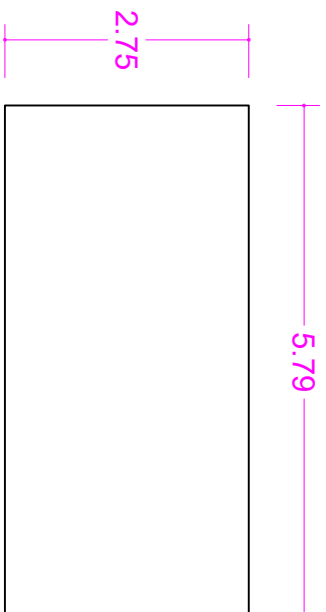

WATER PROOFING IN TERRACE OF BANK BUILDING

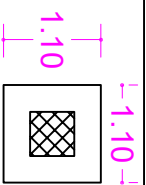

MANHOLE COVER REPLACE IN BACK SIDE OF MAIN BUILDING (6 NOS)

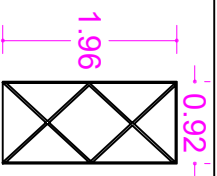

WOODEN DOOR FRAME REPLACE BY METAL DOOR IN TRANSFORMER HOUSE