

## BOREHOLE PROFILE

*Luckson Ngaiu*  
UNDP Engineer

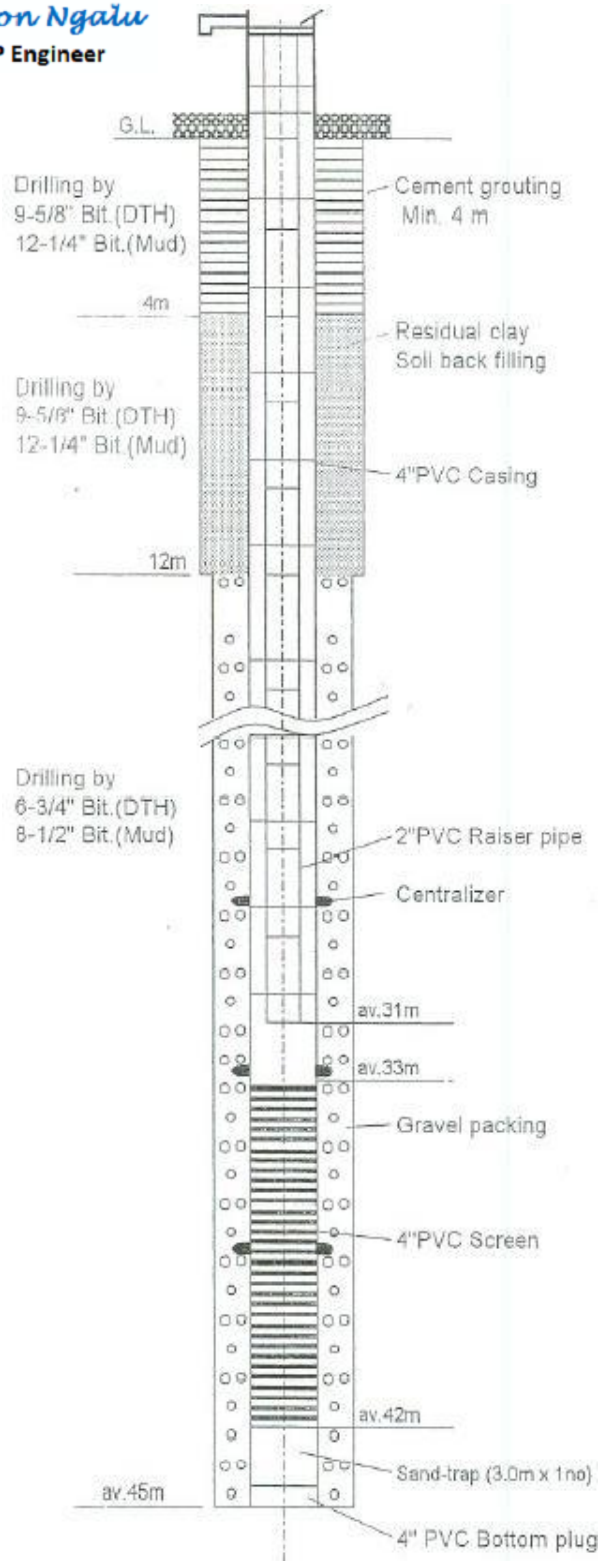



Luckson Ngali  
UNDP Engineer

## BOREHOLE HAND PUMP ASSEMBLY

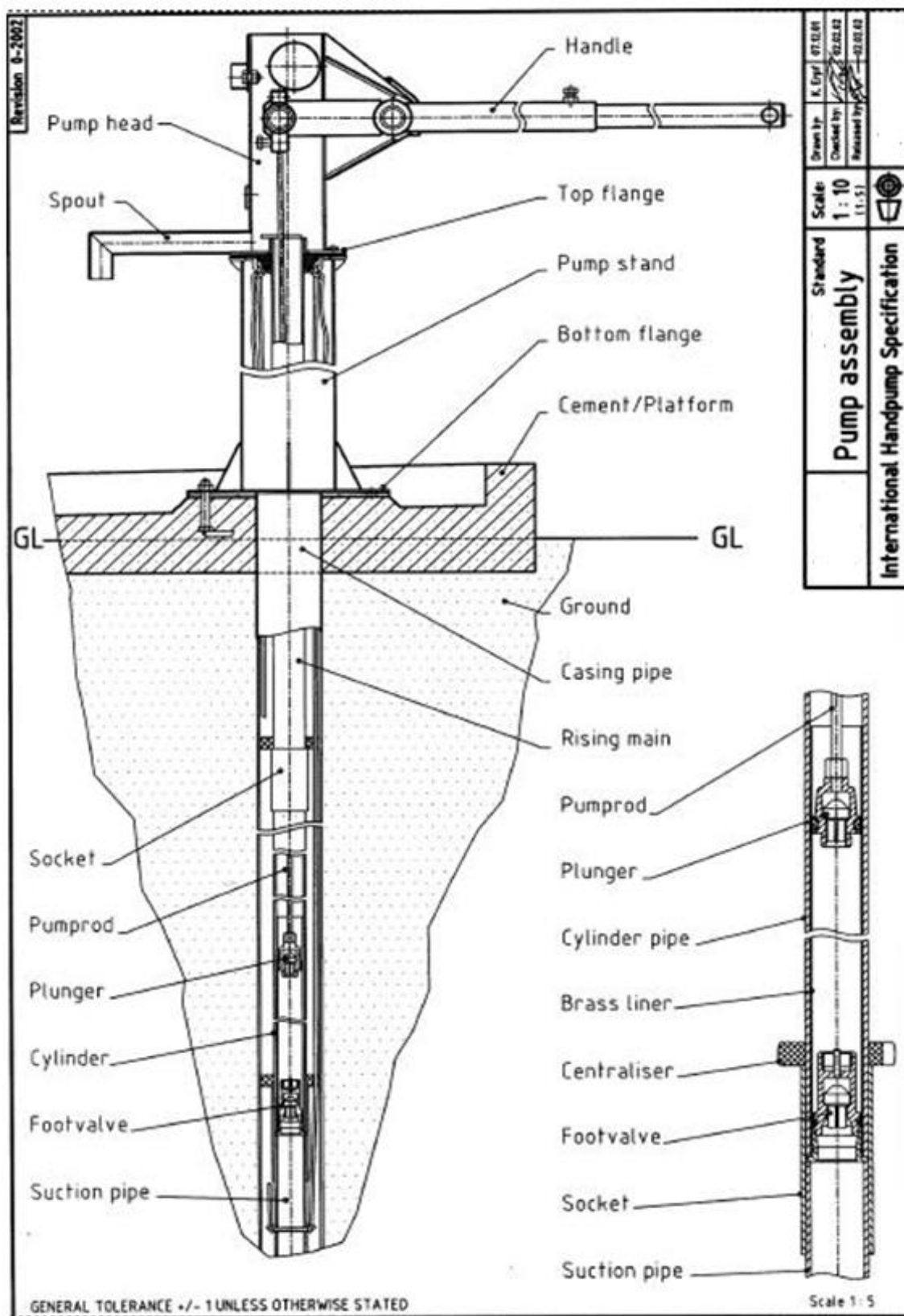



**Luckson Ngali**  
UNDP Engineer

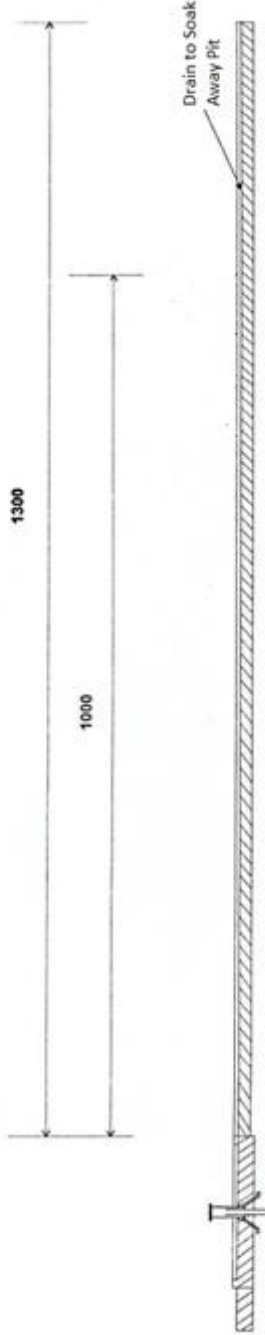

### SECTION A-A

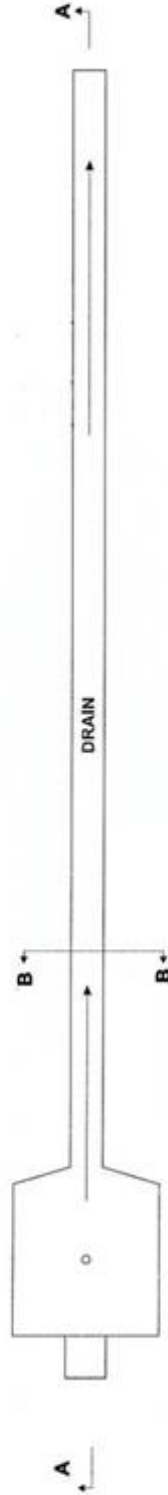

### PLAN

ALL DIMENSIONS ARE IN CENTIMETRES

## UNDP MALAWI

SUSTAINABLE DEVELOPMENT GOALS  
HOTSPOT ACCELERATION INIATIVE

DRILLING OF BOREHOLES IN GVH GUNDA,  
PHALOMBE AND GVH TIZOLA, NSANJE

### CIVIL WORKS LAYOUT

NOT TO SCALE

JUNE 2021



### SECTION B - B

CONCRETE VOLUME FOR DRAIN = 0.91 CuM

1:2:4 MIX  
CEMENT 328kg (6.6 bags)  
SAND 0.455 CuM  
STONE 0.91 CuM



**Luckson Ngulu**  
UNDP Engineer

**SECTION A-A**

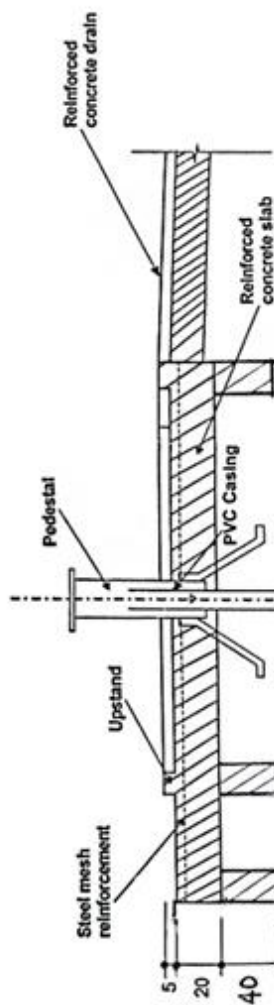

ALL DIMENSIONS ARE IN CENTIMETRES

CONCRETE VOLUME = 0.781CuM

1:2:4 MIX  
CEMENT 281kg (5.61 bags)  
SAND 0.391CuM  
STONE 0.781CuM

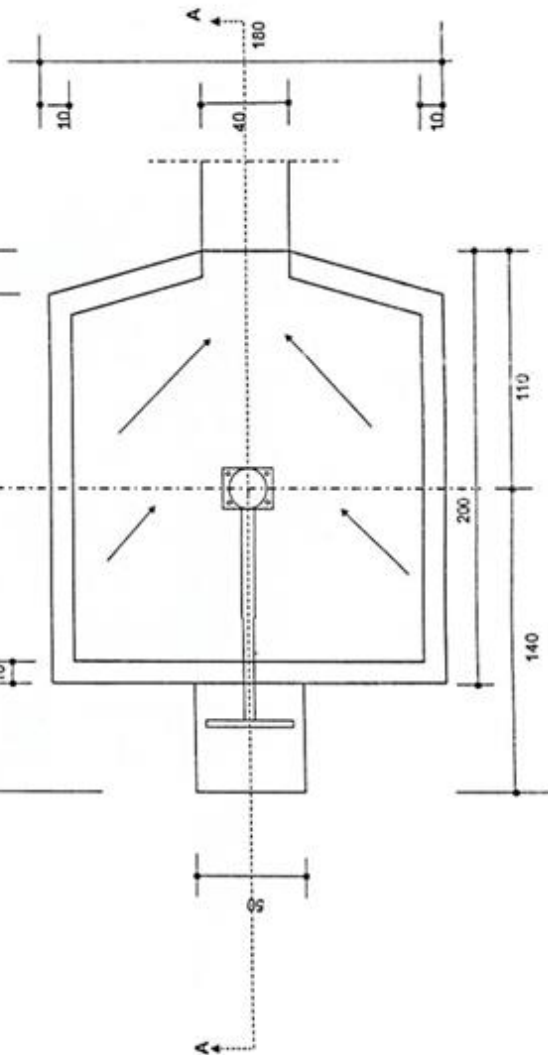

**PLAN**

**UNDP MALAWI**

**SUSTAINABLE DEVELOPMENT GOALS  
HOTSPOTS ACCELERATION INITIATIVE  
(SHAI)**

**DRILLING OF BOREHOLES IN GVH GUNDA,  
PHALOMBE AND GVH TIZOLA, NSANJE**

**PUMP SLAB**

**NOT TO SCALE** **JUNE 2021**



**Luckson Ngali**  
UNDP Engineer

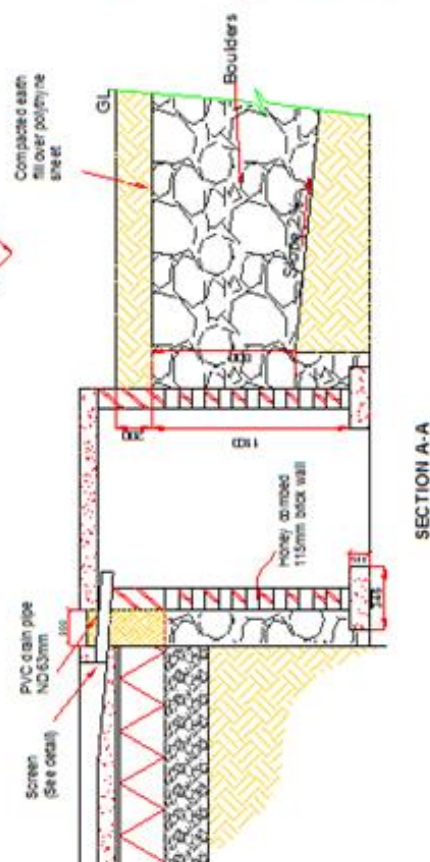
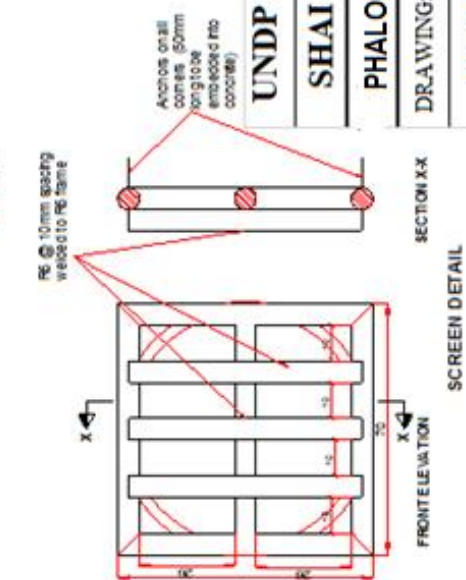
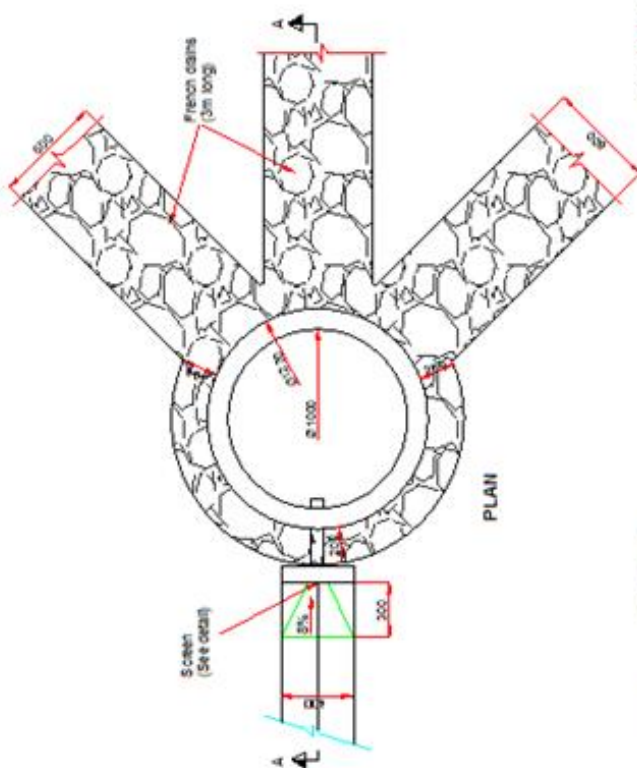
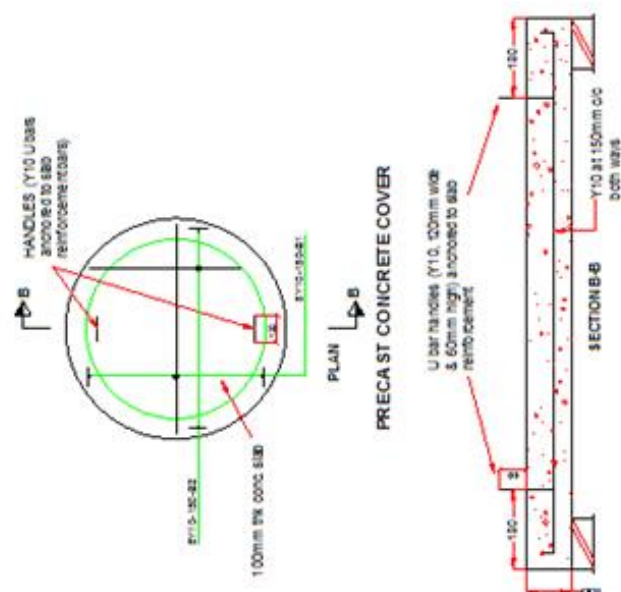

UNDP MALAWI

SHAI PROJECT

PHALOMBE &amp; NSANJE

DRAWING: SOAK AWAY PIT

**JUNE 2021**